

STATE CORPORATION COMMISSION OF KANSAS
OIL & GAS CONSERVATION DIVISION

WELL COMPLETION OR RECOMPLETION FORM
ACO-1 WELL HISTORY

DESCRIPTION OF WELL AND LEASE

Operator: License # 9232
Name Timberline Oil & Gas Corporation
Address 105 E. 8th Street
City/State/Zip Pratt, Kansas 67124

Purchaser Permian

Operator Contact Person Brant C. Grote
Phone 316-672-9476

Contractor: License # 9421
Name Boger Brothers Drilling

Wellsite Geologist
Phone

Designate Type of Completion
 New Well Re-Entry Workover
 Oil SWD Temp Abd
 Gas Inj Delayed Comp.
 Dry Other (Core, Water Supply etc.)

If OWMO: old well info as follows:
Operator
Well Name
Comp. Date Old Total Depth

WELL HISTORY

Drilling Method:
 Mud Rotary Air Rotary Cable
2/28/85 3/7/85 3/8/85
Spud Date Date Reached TD Completion Date
4551'
Total Depth PBTD
Amount of Surface Pipe Set and Cemented at 391 feet
Multiple Stage Cementing Collar Used? Yes No
If yes, show depth set 3070 feet
If alternate 2 completion, cement circulated from feet depth to w/ SX cmt

API NO. 15-151-21-579-6D-6B
County Pratt
E/2 E/2 NE/4 Sec. 33 Twp. 26 Rge. 13 East West
3960 Ft North from Southeast Corner of Section
330 Ft West from Southeast Corner of Section
(Note: Locate well in section plat below)
Lease Name Becker Well # 3
Field Name Chance
Producing Formation Lansing-Kansas City
Elevation: Ground 1947 KB 1952

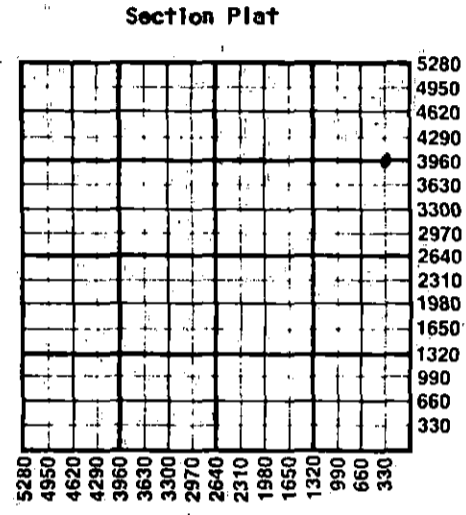

Section Plat
WATER SUPPLY INFORMATION
Disposition of Produced Water: Disposal Repressuring
Docket #

Questions on this portion of the ACO-1 call:
Water Resources Board (913) 296-3717
Source of Water:
Division of Water Resources Permit # T85-206
 Groundwater Ft North from Southeast Corner (Well) Ft West from Southeast Corner of Sec Twp Rge East West
 Surface Water Ft North from Southeast Corner (Stream, pond etc) Ft West from Southeast Corner Sec Twp Rge East West
 Other (explain) (purchased from city, R.W.D. #)

INSTRUCTIONS: This form shall be completed in duplicate and filed with the Kansas Corporation Commission, 200 Colorado Derby Building, Wichita, Kansas 67202, within 90 days after completion or recompletion of any well. Rule 82-3-130 and 82-3-107 apply.
Information on side two of this form will be held confidential for a period of 12 months if requested in writing and submitted with the form. See rule 82-3-107 for confidentiality in excess of 12 months.
One copy of all wireline logs and drillers time log shall be attached with this form. Submit CP-4 form with all plugged wells. Submit CP-111 form with all temporarily abandoned wells.

All requirements of the statutes, rules and regulations promulgated to regulate the oil and gas industry have been fully complied with and the statements herein are complete and correct to the best of my knowledge.

Signature [Signature]
Title VICE President Date 9/15/85
Subscribed and sworn to before me this 15th day of August 1985
Notary Public Norma Kennedy
Date Commission Expires December 21, 1986

K.C.C. OFFICE USE ONLY
 Letter of Confidentiality Attached
 Wireline Log Received
 Drillers Timelog Received
Distribution
 KCC SWD/Rep NGPA
 KGS Plug Other (Specify)

Operator Name Timberline Oil & Gas Corporation Lease Name Becker Well # 3

Sec. 33 Twp. 26S Rge. 13 East West County Pratt

WELL LOG

INSTRUCTIONS: Show important tops and base of formations penetrated. Detail all cores. Report all drill stem tests giving interval tested, time tool open and closed, flowing and shut-in pressures, whether shut-in pressure reached static level, hydrostatic pressures, bottom hole temperature, fluid recovery, and flow rates if gas to surface during test. Attach extra sheet if more space is needed. Attach copy of log.

Drill Stem Tests Taken Yes No
 Samples Sent to Geological Survey Yes No
 Cores Taken Yes No

Formation Description
 Log Sample

Sand & red bed 0-398'
 Red bed, shale and lime 398-1350'
 Salt, anhydrite & lime 1350-1990'
 Shale & lime 1990-4400'
 Dolomite 4400-4550'
 Rotary total depth 4550'

Name	Top	Bottom
Topeka	3205'	
Heebner	3586'	
L-KC	3756'	
Arbuckle	4396'	

CASING RECORD <input checked="" type="checkbox"/> New <input type="checkbox"/> Used							
Report all strings set-conductor, surface, intermediate, production, etc.							
Purpose of String	Size Hole Drilled	Size Casing Set (in O.D.)	Weight Lbs/Ft.	Setting Depth	Type of Cement	#Sacks Used	Type and Percent Additives
surface	12 1/4"	8 5/8"	24#	391'	posmix	250	2% gel, 3% c.c.
production	7 7/8"	5 1/2"	14#	4550'	ASC	375	2% gel, 2% gils.

PERFORATION RECORD		Acid, Fracture, Shot, Cement Squeeze Record	
Shots Per Foot	Specify Footage of Each Interval Perforated	(Amount and Kind of Material Used)	Depth
2	3922-24'	none	

TUBING RECORD	Size	Set At	Packer at	Liner Run	<input type="checkbox"/> Yes <input checked="" type="checkbox"/> No
	2 7/8"	3992'			

Date of First Production	Producing Method
4/16/85	<input type="checkbox"/> Flowing <input checked="" type="checkbox"/> Pumping <input type="checkbox"/> Gas Lift <input type="checkbox"/> Other (explain).....

Estimated Production Per 24 Hours	Oil	Gas	Water	Gas-Oil Ratio	Gravity
	3 to 5 Bbls	TSTM MCF	20 Bbls		38°

METHOD OF COMPLETION

Disposition of gas: Vented Open Hole Perforation
 Sold Other (Specify)
 Used on Lease Dually Completed Commingled

To small to measure

