

STATE CORPORATION COMMISSION OF KANSAS  
OIL & GAS CONSERVATION DIVISION

WELL COMPLETION OR RECOMPLETION FORM  
ACO-1 WELL HISTORY

DESCRIPTION OF WELL AND LEASE

Operator: License # 5010  
Name Knighton Oil Company, Inc.  
Address 207 Petroleum Building  
City/State/Zip Wichita, Kansas 67202

Purchaser

Operator Contact Person Earl M. Knighton, Jr.  
Phone (316) 264-7918

Contractor: License # 5122  
Name Woodman-Iannitti Drilling Company

Wellsite Geologist Bob Douglass  
Phone (316) 263-7135

Designate Type of Completion  
 New Well  Re-Entry  Workover  
 Oil  SWD  Temp Abd  
 Gas  Inj  Delayed Comp.  
 Dry  Other (Core, Water Supply etc.)

If OWWO: old well info as follows:  
Operator  
Well Name  
Comp. Date Old Total Depth

WELL HISTORY

Drilling Method:  
 Mud Rotary  Air Rotary  Cable  
6-06-85 6-14-85 6-14-85  
Spud Date Date Reached TD Completion Date  
4,400' PBDT  
Total Depth

Amount of Surface Pipe Set and Cemented at 282 feet  
Multiple Stage Cementing Collar Used?  Yes  No  
If yes, show depth set feet  
If alternate 2 completion, cement circulated from feet depth to w/SX cmt

API NO. 15-151-21,621-00-00

County Pratt  
100' NE  East  
S2 NE SE Sec. 2 Twp. 26S Rge. 14  West

1,680 Ft North from Southeast Corner of Section  
630 Ft West from Southeast Corner of Section  
(Note: Locate well in section plat below)

Lease Name Webster Well # 3

Field Name Moore

Producing Formation

Elevation: Ground 1,975 KB 1,980  
Section Plat

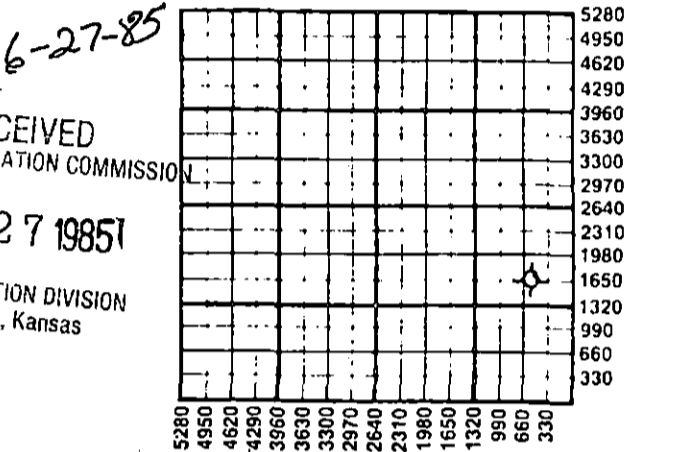

WATER SUPPLY INFORMATION  
Disposition of Produced Water:  Disposal  Repressuring  
Docket #

Questions on this portion of the ACO-1 call:  
Water Resources Board (913) 296-3717  
Source of Water:  
Division of Water Resources Permit # T 85-535  
 Groundwater 1,320 Ft North from Southeast Corner (Well) 660 Ft West from Southeast Corner of Sec 2 Twp 26S Rge 14  East  West  
 Surface Water Ft North from Southeast Corner (Stream, pond etc.) Ft West from Southeast Corner Sec Twp Rge  East  West  
 Other (explain) (purchased from city, R.W.D. #)

INSTRUCTIONS: This form shall be completed in duplicate and filed with the Kansas Corporation Commission, 200 Colorado Derby Building, Wichita, Kansas 67202, within 90 days after completion or recompletion of any well. Rule 82-3-130 and 82-3-107 apply. Information on side two of this form will be held confidential for a period of 12 months if requested in writing and submitted with the form. See rule 82-3-107 for confidentiality in excess of 12 months. One copy of all wireline logs and drillers time log shall be attached with this form. Submit CP-4 form with all plugged wells. Submit CP-111 form with all temporarily abandoned wells.

All requirements of the statutes, rules and regulations promulgated to regulate the oil and gas industry have been fully complied with and the statements herein are complete and correct to the best of my knowledge.

Signature Earl M. Knighton, Jr.  
Title President Date 6-26-85

Subscribed and sworn to before me this 26th day of June 1985  
Notary Public Sarah A. McGehee  
Date Commission Expires December 11, 1985

K.C.C. OFFICE USE ONLY  
 Letter of Confidentiality Attached  
 Wireline Log Received  
 Drillers Timelog Received  
Distribution  
 KCC  SWD/Rep  NGPA  
 KGS  Plug  Other (Specify)

