

ORIGINAL RECORDED

SIDE ONE

STATE CORPORATION COMMISSION OF KANSAS
OIL & GAS CONSERVATION DIVISION
WELL COMPLETION FORM
ACO-1 WELL HISTORY
DESCRIPTION OF WELL AND LEASE

CONFIDENTIAL

Operator: License # 3180

Name: Deutsch Oil Company

Address 107 N. Market - Suite 1115

City/State/Zip Wichita, KS 67202

Purchaser: Texaco

Operator Contact Persons: Kent Deutsch

Phone (316) 267-7551

Contractor: Name: Duke Drilling Co., Inc.

License: 5929

Wellsite Geologist: Kent A. Deutsch

Designate Type of Completion
 New Well Re-Entry Workover

Oil SVD Temp. Abd.
 Gas Inj Delayed Comp.
 Dry Other (Core, Water Supply, etc.)

If OWO: old well info as follows:

Operator: _____

Well Name: _____

Comp. Date _____ Old Total Depth _____

Drilling Method:
 Mud Rotary Air Rotary Cable

08-26-91 08-31-91 9-21-91
Spud Date Date Reached TD Completion Date

API NO. 15- 151-22,057 ^{DD DD}

County Pratt

SE SE NE Sec. 5 Twp. 26 Rge. 11 East West

330 Ft. North from Southeast Corner of Section

2970 Ft. West from Southeast Corner of Section
(NOTE: Locate well in section plat below.)

Lease Name Rundell Well # 3-5

Field Name Bauman

Producing Formation Mississippi

Elevation: Ground 1838 KB 1846

Total Depth 4200 PBTD _____

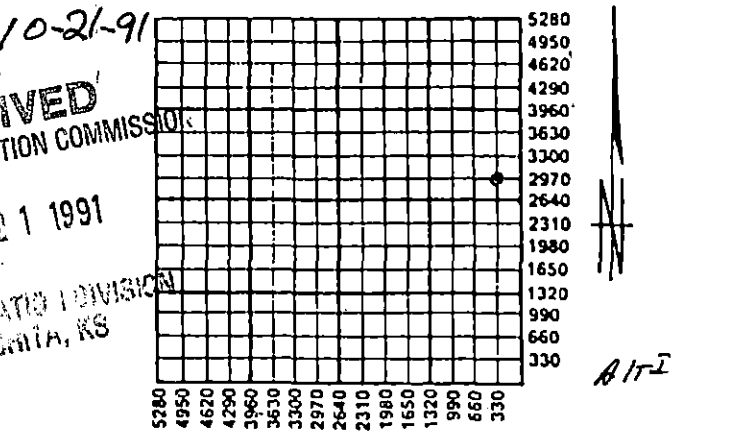

Amount of Surface Pipe Set and Cemented at 262 Feet

Multiple Stage Cementing Collar Used? Yes No

If yes, show depth set _____ Feet

If Alternate II completion, cement circulated from _____

feet depth to _____ w/ _____ sx cmt.

INSTRUCTIONS: This form shall be completed in triplicate and filed with the Kansas Corporation Commission, 200 Colorado Derby Building, Wichita, Kansas 67202, within 120 days of the spud date of any well. Rule 82-3-130, 82-3-107 and 82-3-106 apply. Information on side two of this form will be held confidential for a period of 12 months if requested in writing and submitted with the form. See rule 82-3-107 for confidentiality in excess of 12 months. One copy of all wireline logs and drillers time log shall be attached with this form. ALL CEMENTING TICKETS MUST BE ATTACHED. Submit CP-4 form with all plugged wells. Submit CP-111 form with all temporarily abandoned wells. Any recompletion, workover or conversion of a well requires filing of ACO-2 within 120 days from commencement date of such work.

All requirements of the statutes, rules and regulations promulgated to regulate the oil and gas industry have been fully complied with and the statements herein are complete and correct to the best of my knowledge.

Signature Kent A. Deutsch
Title Owner Date 10-15-91

Subscribed and sworn to before me this 15th day of October, 19 91

Notary Public D. D. Davis

Date Commission Expires 10-1-93

K.C.C. OFFICE USE ONLY
F Letter of Confidentiality Attached
C Wireline Log Received
C Drillers Timelog Received

Distribution
 KCC SWD/Rep NGPA
 KGS Plug Other (Specify)

SIDE TWO

WARRANTY

Operator Name Deutsch Oil Company Lease Name Rundell Well # 3-5
 Sec. 5 Twp. 26 Rge. 11 East West
 County Pratt

INSTRUCTIONS: Show important tops and base of formations penetrated. Detail all cores. Report all drill stem tests giving interval tested, time tool open and closed, flowing and shut-in pressures, whether shut-in pressure reached static level, hydrostatic pressures, bottom hole temperature, fluid recovery, and flow rates if gas to surface during test. Attach extra sheet if more space is needed. Attach copy of log.

Drill Stem Tests Taken <input type="checkbox"/> Yes <input checked="" type="checkbox"/> No (Attach Additional Sheets.) Samples Sent to Geological Survey <input checked="" type="checkbox"/> Yes <input type="checkbox"/> No Cores Taken <input type="checkbox"/> Yes <input checked="" type="checkbox"/> No Electric Log Run <input checked="" type="checkbox"/> Yes <input type="checkbox"/> No (Submit Copy.)	<table border="1" style="width:100%; border-collapse: collapse;"> <thead> <tr> <th colspan="3" style="text-align: center;">Formation Description</th> </tr> <tr> <th style="width:60%;"></th> <th style="width:20%; text-align: center;">Top</th> <th style="width:20%; text-align: center;">Bottom</th> </tr> </thead> <tbody> <tr> <td>Heebner Sh.</td> <td style="text-align: center;">3426</td> <td style="text-align: center;">-1580</td> </tr> <tr> <td>Douglas Sh.</td> <td style="text-align: center;">3459</td> <td style="text-align: center;">-1613</td> </tr> <tr> <td>Brown Lime</td> <td style="text-align: center;">3606</td> <td style="text-align: center;">-1760</td> </tr> <tr> <td>Lansing</td> <td style="text-align: center;">3634</td> <td style="text-align: center;">-1788</td> </tr> <tr> <td>Base K.C.</td> <td style="text-align: center;">3961</td> <td style="text-align: center;">-2115</td> </tr> <tr> <td>Mississippi</td> <td style="text-align: center;">4054</td> <td style="text-align: center;">-2208</td> </tr> <tr> <td>Kinderhook</td> <td style="text-align: center;">4160</td> <td style="text-align: center;">-2314</td> </tr> </tbody> </table>	Formation Description				Top	Bottom	Heebner Sh.	3426	-1580	Douglas Sh.	3459	-1613	Brown Lime	3606	-1760	Lansing	3634	-1788	Base K.C.	3961	-2115	Mississippi	4054	-2208	Kinderhook	4160	-2314
Formation Description																												
	Top	Bottom																										
Heebner Sh.	3426	-1580																										
Douglas Sh.	3459	-1613																										
Brown Lime	3606	-1760																										
Lansing	3634	-1788																										
Base K.C.	3961	-2115																										
Mississippi	4054	-2208																										
Kinderhook	4160	-2314																										

CASING RECORD <input checked="" type="checkbox"/> New <input checked="" type="checkbox"/> Used							
Report all strings set-conductor, surface, intermediate, production, etc.							
Purpose of String	Size Hole Drilled	Size Casing Set (in O.D.)	Weight Lbs./Ft.	Setting Depth	Type of Cement	# Sacks Used	Type and Percent Additives
Surface	12 1/2"	8-5/8"	20#	262'	60/40poz	160	2% gel 3% cc.
Production	7-7/8"	4 1/2"	10.5#	4180'	Lite	25	10% salt
					50/50poz	125	

Shots Per Foot	Specify Footage of Each Interval Perforated	Acid, Fracture, Shot, Cement Squeeze Record (Amount and Kind of Material Used) Depth
2	4058-4114	2000 gal. 7 1/2% MCA 21000# 100 mesh sd. 60000# 20/40 sd. 117000# 12/20 sd. 100000 gals. 40# gelled water

TUBING RECORD	Size <u>2 3/8"</u>	Set At <u>4124'</u>	Packer At	Line Run <input type="checkbox"/> Yes <input checked="" type="checkbox"/> No
---------------	--------------------	---------------------	-----------	--

Date of First Production <u>9-23-91</u>	Producing Method <input type="checkbox"/> Flowing <input checked="" type="checkbox"/> Pumping <input type="checkbox"/> Gas Lift <input type="checkbox"/> Other (Explain)
---	--

Estimated Production Per 24 Hours	Oil <u>50</u> Bbls.	Gas <u>40</u> Mcf	Water <u>120</u> Bbls.	Gas-Oil Ratio	Gravity <u>41</u>
-----------------------------------	---------------------	-------------------	------------------------	---------------	-------------------

Disposition of Gas: Vented Sold Used on Lease (If vented, submit ACO-18.)

METHOD OF COMPLETION: Open Hole Perforation Dually Completed Commingled Other (Specify) _____

Production Interval 4058-4114