

FOR KCC USE:

EFFECTIVE DATE: 1-22-95
DISTRICT # 1
SEAL Yes No

State of Kansas
NOTICE OF INTENTION TO DRILL

FORM C-1 7/94
FORM MUST BE TYPED
FORM MUST BE SIGNED
ALL BLANKS MUST BE FILLED

Must be approved by the K.C.C. five (5) days prior to commencing well

Expected Spud Date January 20, 1995
month day year

Spot NW NE SW Sec 5 Twp 26 S Rg 11 XX East

OPERATOR: License # 30128
Name: KENNETH S. WHITE
Address: 200 E. First, Suite 405
City/State/Zip: Wichita, Kansas 67202
Contact Person: Kenneth S. White
Phone: (316) 263-4007

2310 feet from South/North line of Section
1650 feet from East/West line of Section
IS SECTION REGULAR XX IRREGULAR?

(NOTE: Locate well on the Section Plat on Reverse Side)

County: Pratt
Lease Name: Long Well #: 3
Field Name: Stark Northeast

CONTRACTOR: License # 5420
Name: White & Ellis Drilling, Inc.

Is this a Prorated/Spaced Field? yes XXX no
Target Formation(s): Mississippi

Well Drilled For: Well Class: Type Equipment:
XX Oil ... Enh Rec XX Infield XX Mud Rotary
... Gas ... Storage ... Pool Ext. ... Air Rotary
... OUVO ... Disposal ... Wildcat ... Cable
... Seismic: ... # of Holes ... Other
... Other

Nearest lease or unit boundary: 330
Ground Surface Elevation: 1852 feet MSL

Water well within one-quarter mile: yes XX no
Public water supply well within one mile: yes XX no

If OUVO, old well information as follows:
Operator:
Well Name:
Comp. Date: Old Total Depth

Depth to bottom of fresh water: 180
Depth to bottom of usable water: 230

Surface Pipe by Alternate: XX 1 2
Length of Surface Pipe Planned to be set: 250

Length of Conductor pipe required: none
Projected Total Depth: 4200

Formation at Total Depth: Viola
Water Source for Drilling Operations:

Directional, Deviated or Horizontal wellbore? yes XX no
If yes, true vertical depth:
Bottom Hole Location:

Apply to DWR for Permit if well: not known at this time
DWR Permit #:
Will Cores be Taken? yes XX no

If yes, proposed zone:

AFFIDAVIT

The undersigned hereby affirms that the drilling, completion and eventual plugging of this well will comply with K.S.A. 55-101, et. seq.

It is agreed that the following minimum requirements will be met:

- 1. Notify the appropriate district office prior to spudding of well;
- 2. A copy of the approved notice of intent to drill shall be posted on each drilling-rig;
- 3. The minimum amount of surface pipe as specified below shall be set by circulating cement to the top; in all cases surface pipe shall be set through all unconsolidated materials plus a minimum of 20 feet into the underlying formation;
- 4. If the well is dry hole, an agreement between the operator and the district office on plug length and placement is necessary prior to plugging;
- 5. The appropriate district office will be notified before well is either plugged or production casing is cemented in;
- 6. IF AN ALTERNATE IS COMPLETION, PRODUCTION PIPE SHALL BE CEMENTED FROM BELOW ANY USABLE WATER TO SURFACE WITHIN 120 DAYS OF SPUD DATE. IN ALL CASES, NOTIFY DISTRICT OFFICE PRIOR TO ANY CEMENTING.

I hereby certify that the statements made herein are true and to the best of my knowledge and belief.

Date: 1/13/95 Signature of Operator or Agent: Kenneth S. White Title: Operator

*API # WAS:
15-151-221350000
API # IS:
15-151-221340000

FOR KCC USE:
API # 15-151-221340000
Conductor pipe required NONE feet
Minimum surface pipe required 250 feet per Alt. 1X
Approved by: DPW 1-17-95
This authorization expires: 7-17-95
(This authorization void if drilling not started within 6 months of effective date.)
Spud date: Agent:

Rec'd.
1-13-95
5
24
1/13

REMEMBER TO:

- File Drill Pit Application (form GDP-1) with Intent to Drill;
- File Completion Form ACO-1 within 120 days of spud date;
- File acreage attribution plat according to field proration orders;
- Notify appropriate district office 48 hours prior to workover or re-entry;
- Submit plugging report (CP-4) after plugging is completed;
- Obtain written approval before disposing or injecting salt water.

Mail to: Conservation Division, 200 Colorado Derby Building, 202 W. First St., Wichita, Kansas 67202-1286.

IN ALL CASES PLOT THE INTENDED WELL ON THE PLAT BELOW

PLAT OF ACREAGE ATTRIBUTABLE TO A WELL IN A PRORATED OR SPACED FIELD

If the intended well is in a prorated or spaced field, please fully complete this side of the form. If the intended well is in a prorated or spaced field complete the plat below showing that the well will be properly located in relationship to other wells producing from the common source of supply. Please show all the wells within 1 mile of the boundaries of the proposed acreage attribution unit for gas wells and within 1/2 mile of the boundaries of the proposed acreage attribution unit for oil wells.

API NO. 15- _____
 OPERATOR Kenneth S. White
 LEASE Long
 WELL NUMBER 3
 FIELD Stark Northeast

LOCATION OF WELL: COUNTY Pratt
 _____ feet from south/north line of section
2310
 _____ feet from east/west line of section
1650
 SECTION 5 TWP 26 RG 11 W

NUMBER OF ACRES ATTRIBUTABLE TO WELL _____
 QTR/QTR/QTR OF ACREAGE _____

IS SECTION _____ REGULAR or xx IRREGULAR
 IF SECTION IS IRREGULAR, LOCATE WELL FROM NEAREST
 CORNER BOUNDARY.

Section corner used: _____ NE _____ NW _____ SE xx SW
 PLAT

(Show location of the well and shade attributable acreage for prorated or spaced wells.)
 (Show footage to the nearest lease or unit boundary line.)

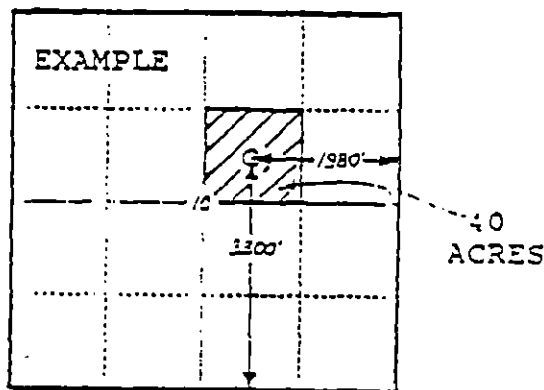
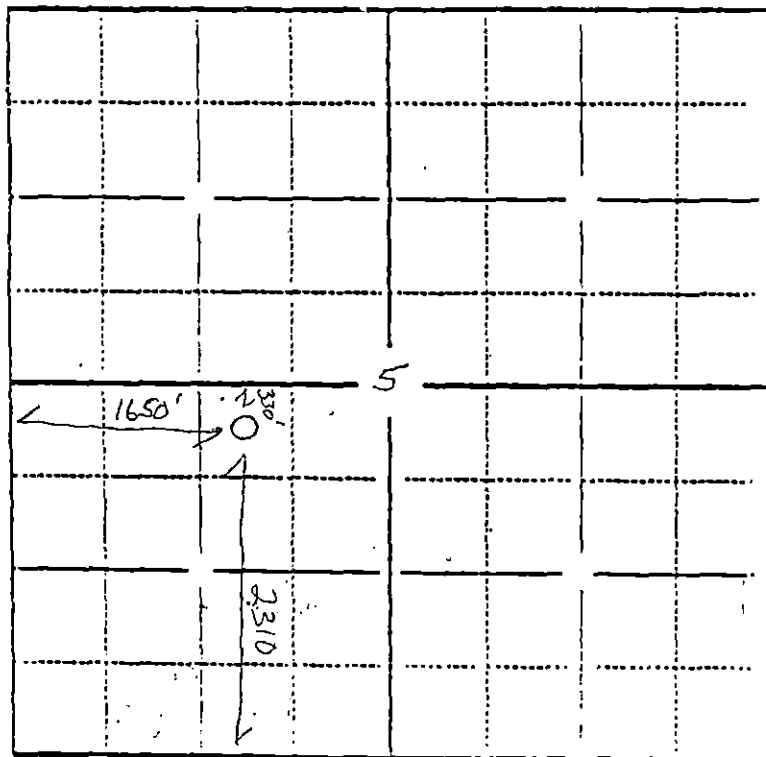

SEWARD CO.

RECEIVED
 KANSAS CORPORATION COMMISSION

JAN 13 1995

2100
 CONSERVATION DIVISION
 WICHITA, KS

In plotting the proposed location of the well, you must show:

- 1) The manner in which you are using the depicted plat by identifying section lines, i.e. 1 section, 1 section with 8 surrounding sections, 4 sections, etc.;
- 2) the distance of the proposed drilling location from the section's south/north and east/west lines; and
- 3) the distance to the nearest lease or unit boundary line.