

FOR KCC USE:

FORM C-1 7/91

EFFECTIVE DATE: 11-23-91

FORM MUST BE TYPED

DISTRICT # 1

State of Kansas
NOTICE OF INTENTION TO DRILL

FORM MUST BE SIGNED

55A7, X Yes, No

Must be approved by the K.C.C. five (5) days prior to commencing well

ALL BLANKS MUST BE FILLED

Expected Spud Date 12 month 10 day 91 year

Spot SE - NW - NE Sec 5 Twp 26 S Rg 11 West

OPERATOR: License # 5046
Name: Raymond Oil Company Inc.
Address: P.O. Box 48788
City/State/Zip: Wichita, Kansas 67201
Contact Person: Pat Raymond
Phone: (316) 267-4214

990 feet from South / North line of Section
1650 feet from East / West line of Section

IS SECTION REGULAR X IRREGULAR?

(NOTE: Locate well on the Section Plat on Reverse Side)

County: Pratt
Lease Name: Rundell Well #: 7
Field Name: Bauman

CONTRACTOR: License #: 5929
Name: Duke Drilling

* Is this a Prorated/Spaced Field? yes X no

Target Formation(s): LKC-Simpson

Nearest lease or unit boundary: 990

Ground Surface Elevation: 1844 est feet MSL

Water well within one-quarter mile: yes X no

Public water supply well within one mile: yes X no

Depth to bottom of fresh water: 180

Depth to bottom of usable water: 200

Surface Pipe by Alternate: X 1 2

Length of Surface Pipe Planned to be set: 230 ft

Length of Conductor pipe required: N/A

Projected Total Depth: 4450

Formation at Total Depth: Simpson

Water Source for Drilling Operations:

... well ... farm pond X other

DWR Permit #: _____

Will Cores Be Taken?: yes X no

If yes, proposed zone: _____

Well Drilled For:	Well Class:	Type Equipment:
X. Oil	... Enh Rec	X. Infield
... Gas	... Storage	... Pool Ext.
... OWD	... Disposal	... Wildcat
... Seismic	... # of Holes	... Other
... Other		

If OWD: old well information as follows:

Operator: _____

Well Name: _____

Comp. Date: _____ Old Total Depth _____

Directional, Deviated or Horizontal wellbore? yes X no

If yes, true vertical depth: _____

Bottom Hole Location: _____

* Spaced & Prorated on Viola

AFFIDAVIT

The undersigned hereby affirms that the drilling, completion and eventual plugging of this well will comply with K.S.A. 55-101, et. seq.

It is agreed that the following minimum requirements will be met:

1. Notify the appropriate district office prior to spudding of well;
2. A copy of the approved notice of intent to drill shall be posted on each drilling rig;
3. The minimum amount of surface pipe as specified below shall be set by circulating cement to the top; in all cases surface pipe shall be set through all unconsolidated materials plus a minimum of 20 feet into the underlying formation;
4. If the well is dry hole, an agreement between the operator and the district office on plug length and placement is necessary prior to plugging;
5. The appropriate district office will be notified before well is either plugged or production casing is cemented in;
6. IF AN ALTERNATE II COMPLETION, PRODUCTION PIPE SHALL BE CEMENTED FROM BELOW ANY USABLE WATER TO SURFACE WITHIN 120 DAYS OF SPUD DATE. IN ALL CASES, NOTIFY DISTRICT OFFICE PRIOR TO ANY CEMENTING.

I hereby certify that the statements made herein are true and to the best of my knowledge and belief.

Date: 11-14-91 Signature of Operator or Agent: Pat R. Raymond Title: Vice President

RECEIVED
STATE COMMISSION
11-18-91
NOV 18 1991
CONSERVATION DIVISION
Wichita, Kansas

FOR KCC USE:
API # 15-151-22073-00-00
Conductor pipe required None feet
Minimum surface pipe required 220 feet per Alt. X
Approved by: [Signature] 11-18-91
This authorization expires: 5-18-92
(This authorization void if drilling not started within 6 months of effective date.)
Spud date: _____ Agent: _____

REMEMBER TO:

- File Drill Pit Application (form CDP-1) with Intent to Drill;
- File Completion Form ACO-1 within 120 days of spud date;
- File acreage attribution plat according to field proration orders;
- Notify appropriate district office 48 hours prior to workover or re-entry;
- Submit plugging report (CP-4) after plugging is completed;
- Obtain written approval before disposing or injecting salt water.

Mail to: Conservation Division, 200 Colorado Derby Building, 202 W. First St., Wichita, Kansas 67202-1286.

5
26
11/4

IN ALL CASES PLOT THE INTENDED WELL ON THE PLAT BELOW

PLAT OF ACREAGE ATTRIBUTABLE TO A WELL IN A PRORATED OR SPACED FIELD

If the intended well is in a prorated or spaced field, please fully complete this side of the form. If the intended well is in a prorated or spaced field complete the plat below showing that the well will be properly located in relationship to other wells producing from the common source of supply. Please show all the wells within 1 mile of the boundaries of the proposed acreage attribution unit for gas wells and within 1/2 mile of the boundaries of the proposed acreage attribution unit for oil wells.

API NO. 15- _____
 OPERATOR Raymond Oil Company Inc.
 LEASE Rundell
 WELL NUMBER #7
 FIELD Bauman

LOCATION OF WELL: COUNTY Pratt
 _____ 990 feet from south/north line of section
 _____ 1650 feet from east/west line of section
 SECTION 5 TWP 26s RG 11w

NUMBER OF ACRES ATTRIBUTABLE TO WELL 10
 QTR/QTR/QTR OF ACREAGE SE - NW - NE

IS SECTION _____ REGULAR or x IRREGULAR
IF SECTION IS IRREGULAR, LOCATE WELL FROM NEAREST CORNER BOUNDARY.

Section corner used: x NE _____ NW _____ SE _____ SW

PLAT

(Show location of the well and shade attributable acreage for prorated or spaced wells.)
 (Show footage to the nearest lease or unit boundary line.)

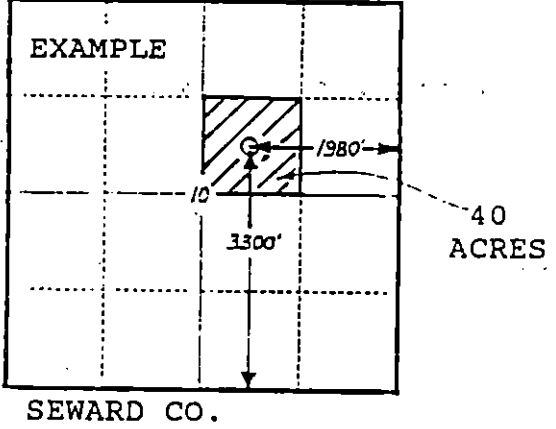
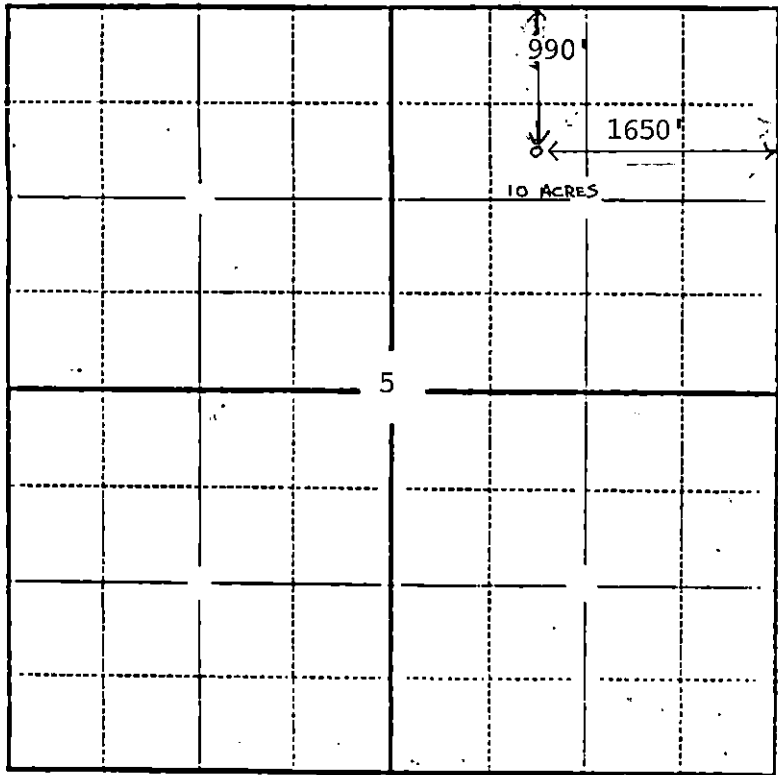

In plotting the proposed location of the well, you must show:

- 1) The manner in which you are using the depicted plat by identifying section lines, i.e. 1 section, 1 section with 8 surrounding sections, 4 sections, etc.;
- 2) the distance of the proposed drilling location from the section's south/north and east/west lines; and
- 3) the distance to the nearest lease or unit boundary line.