

FOR KCC USE:

FORM C-1 7/91

EFFECTIVE DATE: 12-8-92

FORM MUST BE TYPED

DISTRICT #

State of Kansas
NOTICE OF INTENTION TO DRILL

FORM MUST BE SIGNED

SEAT Yes No

Must be approved by the K.C.C. five (5) days prior to commencing well

ALL BLANKS MUST BE FILLED

Expected Spud Date 12 15 92
month day year

Spot NW NE NE Sec 5 Twp 26 S Rg 11 East West

OPERATOR: License # 5046
Name: Raymond Oil Company Inc.
Address: P.O. Box 48788
City/State/Zip: Wichita, Kansas 67201
Contact Person: Pat Raymond
Phone: (316) 267-4214

330 feet from ~~3000~~ North line of Section
990 feet from ~~9000~~ East line of Section
IS SECTION REGULAR X IRREGULAR

CONTRACTOR: License # 5929
Name: Duke Drilling Co.

(NOTE: Locate well on the Section Plat on Reverse Side)
County: Pratt
Lease Name: Rundell Well #: 10
Field Name: Bauman Prafford

Well Drilled For: Well Class: Type Equipment:
X Oil ... Enh Rec X Infield X Mud Rotary
... Gas ... Storage ... Pool Ext. ... Air Rotary
... OWMO ... Disposal ... Wildcat ... Cable
... Seismic; ... # of Holes ... Other
... Other

Is this a Prorated/Spaced Field? yes X no
Target Formation(s): Mississippi
Nearest lease or unit boundary: 330
Ground Surface Elevation: 1843 feet MSL

If OWMO: old well information as follows:
Operator:
Well Name:
Comp. Date: Old Total Depth

Water well within one-quarter mile: yes X no
Public water supply well within one mile: yes X no
Depth to bottom of fresh water: 195/180
Depth to bottom of usable water: 200/180

Directional, Deviated or Horizontal wellbore? yes X no
If yes, true vertical depth:
Bottom Hole Location:

Surface Pipe by Alternate: X 1 2
Length of Surface Pipe Planned to be set: 230+ 200
Length of Conductor pipe required: N/A
Projected Total Depth: 4300

Formation at Total Depth: Kinderhook Shale
Water Source for Drilling Operations:
... well ... farm pond X other

DWR Permit #:
Will Cores Be Taken? yes X no
If yes, proposed zone:

AFFIDAVIT

The undersigned hereby affirms that the drilling, completion and eventual plugging of this well will comply with K.S.A. 55-101, et. seq.
It is agreed that the following minimum requirements will be met:

- 1. Notify the appropriate district office prior to spudding of well;
- 2. A copy of the approved notice of intent to drill shall be posted on each drilling rig;
- 3. The minimum amount of surface pipe as specified below shall be set by circulating cement to the top; in all cases surface pipe shall be set through all unconsolidated materials plus a minimum of 20 feet into the underlying formation;
- 4. If the well is dry hole, an agreement between the operator and the district office on plug length and placement is necessary prior to plugging;
- 5. The appropriate district office will be notified before well is either plugged or production casing is cemented in;
- 6. IF AN ALTERNATE IS COMPLETION, PRODUCTION PIPE SHALL BE CEMENTED FROM BELOW ANY USABLE WATER TO SURFACE WITHIN 120 DAYS OF SPUD DATE. IN ALL CASES, NOTIFY DISTRICT OFFICE PRIOR TO ANY CEMENTING.

I hereby certify that the statements made herein are true and to the best of my knowledge and belief.
Date: 11-30-92 Signature of Operator or Agent: Pat Raymond Title: Vice-President

FOR KCC USE:
API # 15-151-22,094-00-00
Conductor pipe required None feet
Minimum surface pipe required 200 feet per Alt. 1X
Approved by: CB 12-3-92
This authorization expires: 5-3-93
(This authorization void if drilling not started within 6 months of effective date.)
Spud date: Agent:

RECEIVED
STATE CORPORATION COMMISSION
DEC 1 1992
12-1-92

REMEMBER TO:

- File Drill Pit Application (form CDP-1) with Intent to Drill;
- File Completion Form ACD-1 within 120 days of spud date;
- File acreage attribution plat according to field proration orders;
- Notify appropriate district office 48 hours prior to workover or re-entry;
- Submit plugging report (CP-4) after plugging is completed;
- Obtain written approval before disposing or injecting salt water.

Mail to: Conservation Division, 200 Colorado Derby Building, 202 W. First St., Wichita, Kansas 67202-1286.

IN ALL CASES PLOT THE INTENDED WELL ON THE PLAT BELOW

PLAT OF ACREAGE ATTRIBUTABLE TO A WELL IN A PRORATED OR SPACED FIELD

If the intended well is in a prorated or spaced field, please fully complete this side of the form. If the intended well is in a prorated or spaced field complete the plat below showing that the well will be properly located in relationship to other wells producing from the common source of supply. Please show all the wells within 1 mile of the boundaries of the proposed acreage attribution unit for gas wells and within 1/2 mile of the boundaries of the proposed acreage attribution unit for oil wells.

API NO. 15- _____
 OPERATOR Raymond Oil Company, Inc.
 LEASE Rundell
 WELL NUMBER #10
 FIELD Bauman

LOCATION OF WELL: COUNTY Pratt
330 feet from ~~south~~/north line of section
990 feet from east/~~west~~ line of section
 SECTION 5 TWP 26S RG 11W

NUMBER OF ACRES ATTRIBUTABLE TO WELL 10
 QTR/QTR/QTR OF ACREAGE NW - NE - NE

IS SECTION _____ REGULAR or X IRREGULAR
IF SECTION IS IRREGULAR, LOCATE WELL FROM NEAREST CORNER BOUNDARY.

Section corner used: X NE _____ NW _____ SE _____ SW

PLAT

(Show location of the well and shade attributable acreage for prorated or spaced wells.)
 (Show footage to the nearest lease or unit boundary line.)

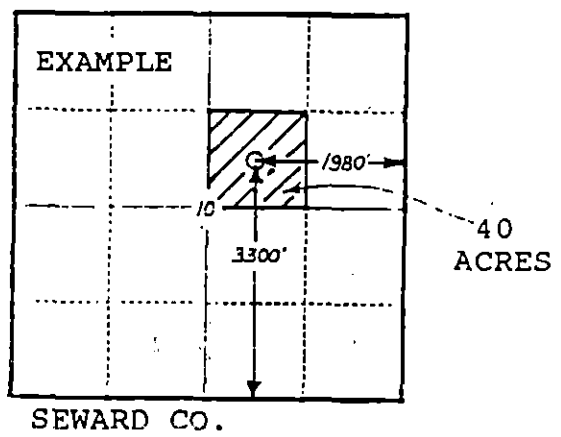
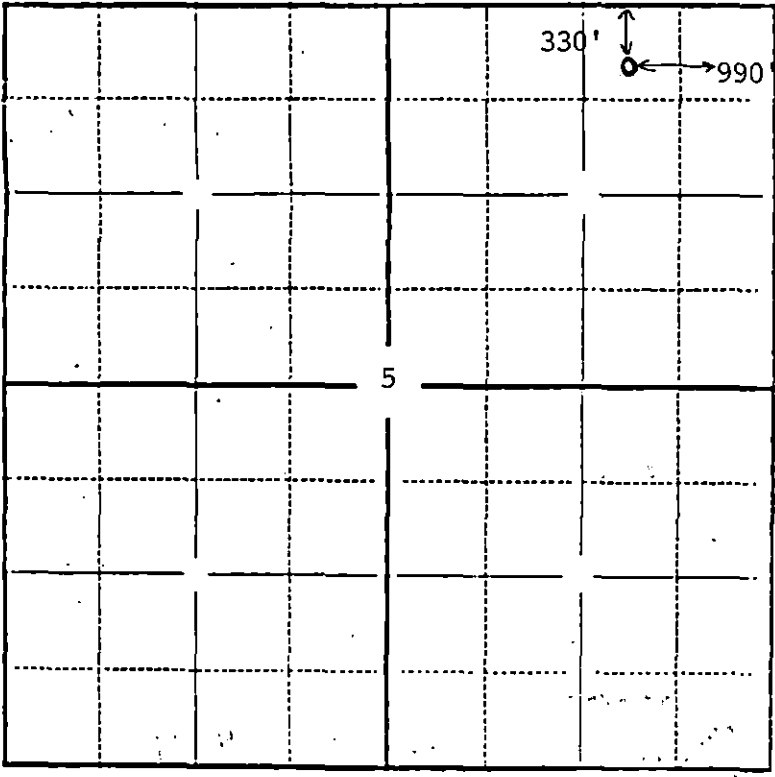

In plotting the proposed location of the well, you must show:

- 1) The manner in which you are using the depicted plat by identifying section lines, i.e. 1 section, 1 section with 8 surrounding sections, 4 sections, etc.;
- 2) the distance of the proposed drilling location from the section's south/north and east/west lines; and
- 3) the distance to the nearest lease or unit boundary line.