

FOR KCC USE:

FORM C-1 7/91

EFFECTIVE DATE: 6-15-97
DISTRICT # 2
SGA? X Yes...No

State of Kansas
NOTICE OF INTENTION TO DRILL

FORM MUST BE TYPED
FORM MUST BE SIGNED
ALL BLANKS MUST BE FILLED

Must be approved by the K.C.C. five (5) days prior to commencing well.

Expected Spud Date July 8 1997
month day year

spot APPROX. E/2 - N/4 - N/4 Sec 30 Twp 27 S, Rg 10 East X West

OPERATOR: License # 5278
Name: Northern Natural Gas
Address: PO Box 178
City/State/Zip: Cunningham, KS 67035
Contact Person: Dan Dobbins
Phone: 316-257-5146

660 feet from South North line of Section
1010 feet from East West line of Section
IS SECTION X REGULAR IRREGULAR?

(NOTE: Locate well on the Section Plat on Reverse Side)

CONTRACTOR: License # 5893
Name: Pratt Well Service

County: Kingman

Lease Name: Prentice Well #: 30-11

Field Name: Cunningham

Is this a Prorated/Spaced Field? ... yes X... no

Target Formation(s): Simpson

Nearest lease or unit boundary: 200 ft

Ground Surface Elevation: 1699 feet MSL

Water well within one-quarter mile: X yes ... no

Public water supply well within one mile: X yes X... no

Depth to bottom of fresh water: 100 ft

Depth to bottom of usable water: 450 ft

Surface Pipe by Alternate: X 1 2 1395

Length of Surface Pipe Planned to be set: 102

Length of Conductor pipe required: 4150

Projected Total Depth: Simpson

Formation at Total Depth: Simpson

Water Source for Drilling Operations:

X well ... farm pond ... other

Well Drilled For: Well Class: Type Equipment:
X Oil X Enh Rec X Infield ... Mud Rotary
X Gas X Storage X Pool Ext. ... Air Rotary
X O/W/O ... Disposal ... Wildcat ... Cable
X Seismic: # of Holes Other
X Other Deepen well to Simpson
If O/W/O: old well information as follows:
Operator: Northern Natural Gas
Well Name: 30-11 API 15-095-20933
Comp. Date: 4-9-80 Old Total Depth 4070

Directional, Deviated or Horizontal wellbore? ... yes X... no
If yes, true vertical depth:
Bottom Hole Location:

Will Cores Be Taken?: ... yes X... no
If yes, proposed zone:

AFFIDAVIT

The undersigned hereby affirms that the drilling, completion and eventual plugging of this well will comply with K.S.A. 55-101, et. seq.
It is agreed that the following minimum requirements will be met:

1. Notify the appropriate district office prior to spudding of well;
2. A copy of the approved notice of intent to drill shall be posted on each drilling rig;
3. The minimum amount of surface pipe as specified below shall be set by circulating cement to the top; in all cases surface pipe shall be set through all unconsolidated materials plus a minimum of 20 feet into the underlying formation;
4. If the well is dry hole, an agreement between the operator and the district office on plug length and placement is necessary prior to plugging;
5. The appropriate district office will be notified before well is either plugged or production casing is cemented in;
6. IF AN ALTERNATE II COMPLETION, PRODUCTION PIPE SHALL BE CEMENTED FROM BELOW ANY USABLE WATER TO SURFACE WITHIN 120 DAYS OF SPUD DATE. IN ALL CASES, NOTIFY DISTRICT OFFICE PRIOR TO ANY CEMENTING.

I hereby certify that the statements made herein are true and to the best of my knowledge and belief.

Date: 5/2/97 Signature of Operator or Agent: Dan Dobbins Title: Sr. Reservoir Analyst

FOR KCC USE:
API # 15- 095-209330001
Conductor pipe required NONE feet
Minimum surface pipe required 1395 feet per Alt. (1) X
Approved by: JK 6-10-97

This authorization expires: 12-10-97
(This authorization void if drilling not started within 6 months of effective date.)

Spud date: _____ Agent: _____

RECEIVED
KANSAS CORPORATION COMMISSION
MAY 05 1997
5-5-97
CONSERVATION DIVISION
WICHITA, KS

REMEMBER TO:

- File Drill Pit Application (form CDP-1) with Intent to Drill;
- File Completion Form ACO-1 within 120 days of spud date;
- File acreage attribution plat according to field proration orders;
- Notify appropriate district office 48 hours prior to workover or re-entry;
- Submit plugging report (CP-4) after plugging is completed;
- Obtain written approval before disposing or injecting salt water.

Mail to: KCC - Conservation Division, 130 S. Market - Room 2078, Wichita, Kansas 67202.

IN ALL CASES PLOT THE INTENDED WELL ON THE PLAT BELOW

PLAT OF ACREAGE ATTRIBUTABLE TO A WELL IN A PRORATED OR SPACED FIELD

If the intended well is in a prorated or spaced field, please fully complete this side of the form. If the intended well is in a prorated or spaced field complete the plat below showing that the well will be properly located in relationship to other wells producing from the common source of supply. Please show all the wells within 1 mile of the boundaries of the proposed acreage attribution unit for gas wells and within 1/2 mile of the boundaries of the proposed acreage attribution unit for oil wells.

API NO. 15- _____
 OPERATOR _____ LOCATION OF WELL: COUNTY _____
 LEASE _____ feet from south/north line of section
 WELL NUMBER _____ feet from east/west line of section
 FIELD _____ SECTION _____ TWP _____ RG _____

NUMBER OF ACRES ATTRIBUTABLE TO WELL _____ IS SECTION _____ REGULAR or _____ IRREGULAR
 QTR/QTR/QTR OF ACREAGE _____ IF SECTION IS IRREGULAR, LOCATE WELL FROM NEAREST
 CORNER BOUNDARY.
 Section corner used: _____ NE _____ NW _____ SE _____ SW

PLAT

(Show location of the well and shade attributable acreage for prorated or spaced wells.)
 (Show footage to the nearest lease or unit boundary line.)

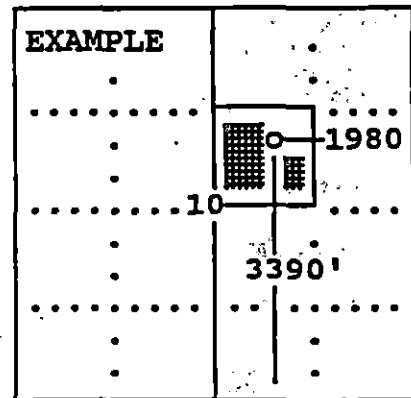
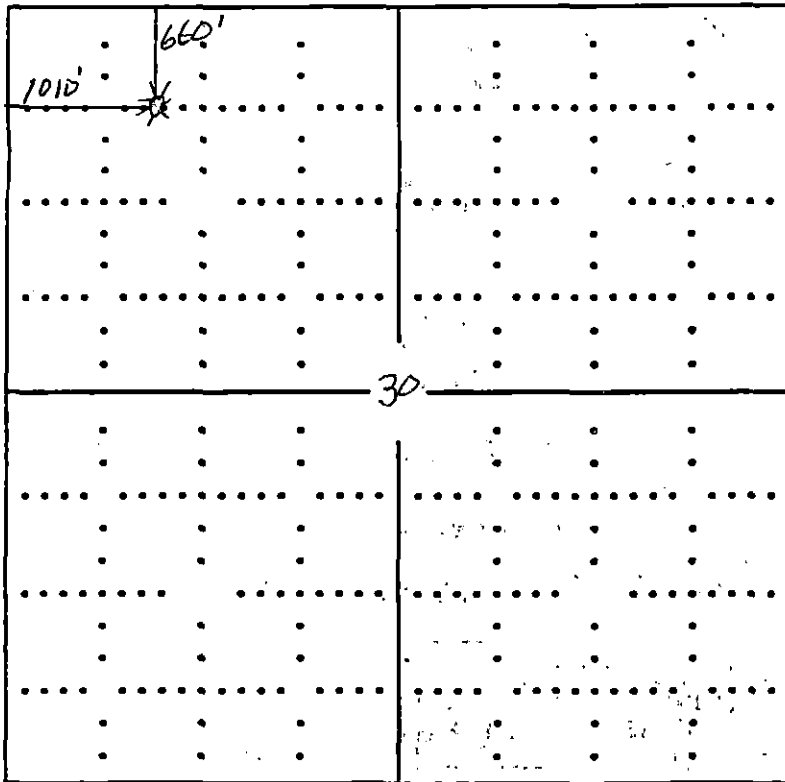

SEWARD CO.

KINGMAN CO.

In plotting the proposed location of the well, you must show:

- 1) The manner in which you are using the depicted plat by identifying section lines, i.e. 1 section, 1 section with 8 surrounding sections, 4 sections, etc.;
- 2) the distance of the proposed drilling location from the section's south/north and east/west; and
- 3) the distance to the nearest lease or unit boundary line.