

FOR KCC USE:

FORM C-1 7/91

FORM MUST BE TYPED

FORM MUST BE SIGNED

ALL BLANKS MUST BE FILLED

EFFECTIVE DATE: 8-8-98

State of Kansas

DISTRICT # 2

NOTICE OF INTENTION TO DRILL

SGA?  Yes...  No

Must be approved by the K.C.C. five (5) days prior to commencing well.

Expected Spud Date pending approval  
month day year

Spot S NE SW Sec 20 Twp 27 S, Rg 10  East  West

OPERATOR: License # 32119  
Name: Northern Natural Gas  
Address: P.O. Box 178  
City/State/Zip: Cunningham, KS 67035  
Contact Person: Dan Dobbins  
Phone: (316) 298-6117

1427 feet from South / North line of Section  
1973 feet from East / West line of Section  
IS SECTION  REGULAR  IRREGULAR?

CONTRACTOR: License # 5893  
Name: Pratt Well Service

(NOTE: Locate well on the Section Plat on Reverse Side)  
County: Kingman  
Lease Name: Rohlman-Meyers Well # 20-43  
Field Name: Cunningham  
Is this a Prorated/Spaced Field?  yes  no  
Target Formation(s): Viola  
Nearest lease or unit boundary: 1427  
Ground Surface Elevation: 1692 feet MSL  
Water well within one-quarter mile:  yes  no  
Public water supply well within one mile:  yes  no  
Depth to bottom of fresh water: 120 ft  
Depth to bottom of usable water: 200 ft  
Surface Pipe by Alternates:  1  2  
Length of Surface Pipe Planned to be set: 1413  
Length of Conductor pipe required: 90  
Projected Total Depth: 4032  
Formation at Total Depth: Viola  
Water Source for Drilling Operations:  
 well  farm pond  other

Well Drilled For: Well Class: Type Equipment:  
... Oil ... Enh Rec  Infield ... Mud Rotary  
... Gas  Storage ... Pool Ext. ... Air Rotary  
 OWWO ... Disposal ... Wildcat ... Cable  
... Seismic; ... # of Holes ... Other  
... Other

If OWWO: old well information as follows:  
Operator: Northern Natural Gas  
Well Name: Rohlman-Meyers 20-43  
Comp. Date: 12-4-78 Old Total Depth 4032

Directional, Deviated or Horizontal wellbore?  yes  no  
If yes, true vertical depth: 3984 at end of lateral  
Bottom Hole Location: 780 FWL 150 FSL  
Sec. 20-T27S-R10W

Will Cores Be Taken?  yes  no  
If yes, proposed zone:

HOR. DOCKET NO. 195,109-C (C-28,358)

AFFIDAVIT

The undersigned hereby affirms that the drilling, completion and eventual plugging of this well will comply with K.S.A. 55-101, et. seq.

It is agreed that the following minimum requirements will be met:

- 1. Notify the appropriate district office prior to spudding of well;
- 2. A copy of the approved notice of intent to drill shall be posted on each drilling rig;
- 3. The minimum amount of surface pipe as specified below shall be set by circulating cement to the top; in all cases surface pipe shall be set through all unconsolidated materials plus a minimum of 20 feet into the underlying formation;
- 4. If the well is dry hole, an agreement between the operator and the district office on plug length and placement is necessary prior to plugging;
- 5. The appropriate district office will be notified before well is either plugged or production casing is cemented in;
- 6. IF AN ALTERNATE II COMPLETION, PRODUCTION PIPE SHALL BE CEMENTED FROM BELOW ANY USABLE WATER TO SURFACE WITHIN 120 DAYS OF SPUD DATE. IN ALL CASES, NOTIFY DISTRICT OFFICE PRIOR TO ANY CEMENTING.

I hereby certify that the statements made herein are true and to the best of my knowledge and belief.

Date: 7-23-98 Signature of Operator or Agent: Dan Dobbins Title: Sr. Reservoir Analyst

FOR KCC USE:  
API # 15- 095-207810101  
Conductor pipe required NONE feet  
Minimum surface pipe required 1413 feet per Alt.   
Approved by: JK 8-3-98  
This authorization expires: 7-3-99  
(This authorization void if drilling not started within 6 months of effective date.)  
Spud date: \_\_\_\_\_ Agent: \_\_\_\_\_

*Rec'd 8-3-98*

20  
27  
10W

REMEMBER TO:

- File Drill Pit Application (form CDP-1) with Intent to Drill;
- File Completion Form ACO-1 within 120 days of spud date;
- File acreage attribution plat according to field proration orders;
- Notify appropriate district office 48 hours prior to workover or re-entry;
- Submit plugging report (CP-4) after plugging is completed;
- Obtain written approval before disposing or injecting salt water.

Mail to: KCC - Conservation Division, 130 S. Market - Room 2078, Wichita, Kansas 67202.

Exhibit A

**IN ALL CASES PLOT THE INTENDED WELL ON THE PLAT BELOW**

**PLAT OF ACREAGE ATTRIBUTABLE TO A WELL IN A PRORATED OR SPACED FIELD**

If the intended well is in a prorated or spaced field, please fully complete this side of the form. If the intended well is in a prorated or spaced field complete the plat below showing that the well will be properly located in relationship to other wells producing from the common source of supply. Please show all the wells within 1 mile of the boundaries of the proposed acreage attribution unit for gas wells and within 1/2 mile of the boundaries of the proposed acreage attribution unit for oil wells.

API NO. 15- \_\_\_\_\_  
 OPERATOR \_\_\_\_\_  
 LEASE \_\_\_\_\_  
 WELL NUMBER \_\_\_\_\_  
 FIELD \_\_\_\_\_

LOCATION OF WELL: COUNTY \_\_\_\_\_  
 \_\_\_\_\_ feet from south/north line of section  
 \_\_\_\_\_ feet from east/west line of section  
 SECTION \_\_\_\_\_ TWP \_\_\_\_\_ RG \_\_\_\_\_

NUMBER OF ACRES ATTRIBUTABLE TO WELL \_\_\_\_\_  
 OTR/OTR/OTR OF ACREAGE \_\_\_\_\_

IS SECTION \_\_\_\_\_ REGULAR or \_\_\_\_\_ IRREGULAR  
IF SECTION IS IRREGULAR, LOCATE WELL FROM NEAREST CORNER BOUNDARY.

Section corner used: \_\_\_\_\_ NE \_\_\_\_\_ NW \_\_\_\_\_ SE \_\_\_\_\_ SW

**PLAT**

(Show location of the well and shade attributable acreage for prorated or spaced wells.)  
 (Show footage to the nearest lease or unit boundary line.)

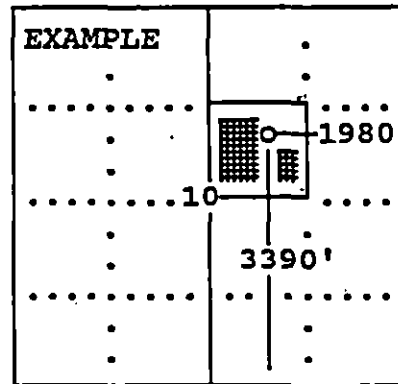
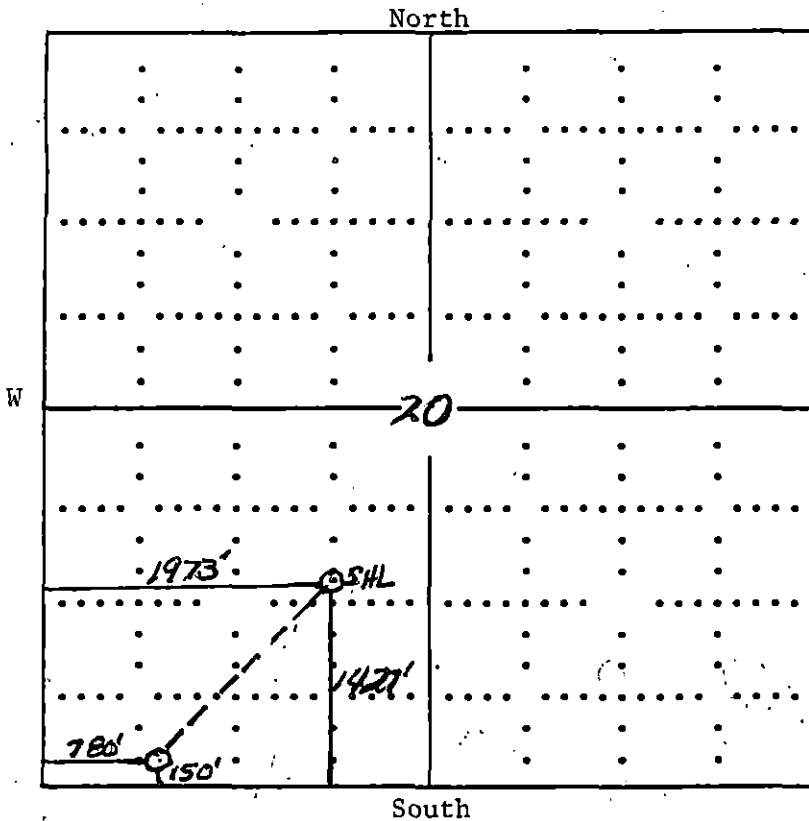

SEWARD CO.

**In plotting the proposed location of the well, you must show:**

- 1) The manner in which you are using the depicted plat by identifying section lines, i.e. 1 section, 1 section with 8 surrounding sections, 4 sections, etc.;
- 2) the distance of the proposed drilling location from the section's south/north and east/west; and
- 3) the distance to the nearest lease or unit boundary line.