

15-185-20357-0000

4

STATE OF KANSAS
STATE CORPORATION COMMISSION

Form CP-4

Give All Information Completely
Make Required Affidavit
Mail or Deliver Report to:
Conservation Division
State Corporation Commission
212 No. Market
Wichita, Kansas 67202

WELL PLUGGING RECORD

STAFFORD County. Sec. 10 Twp. 24S Rge. 13 (E)X(W)
Location as "NE/CNW/SW" or footage from lines APP. NW SE SW

Lease Owner PETROLEUM, INC.,

Lease Name STOHR Well No. 1

Office Address R.R. #2, GREAT BEND, KANSAS

Character of Well (completed as Oil, Gas or Dry Hole) DRY HOLE

Date well completed JUNE 1 19 71

Application for plugging filed JUNE 1 19 71

Application for plugging approved JUNE 1 19 71

Plugging commenced JUNE 1 19 71

Plugging completed JUNE 1 19 71

Reason for abandonment of well or producing formation NO COMMERCIAL ZONE

If a producing well is abandoned, date of last production NONE 19

Was permission obtained from the Conservation Division or its agents before plugging was commenced? YES

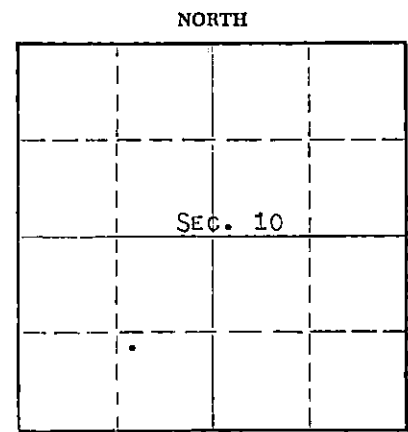

Locate well correctly on above Section Plat

Name of Conservation Agent who supervised plugging of this well G. R. RIBERSTEIN

Producing formation _____ Depth to top _____ Bottom _____ Total Depth of Well 3556' Feet

Show depth and thickness of all water, oil and gas formations.

OIL, GAS OR WATER RECORDS

CASING RECORD

FORMATION	CONTENT	FROM	TO	SIZE	PUT IN	PULLED OUT
				8-5/8"	285'	NONE

Describe in detail the manner in which the well was plugged, indicating where the mud fluid was placed and the method or methods used in introducing it into the hole. If cement or other plugs were used, state the character of same and depth placed, from _____ feet to _____ feet for each plug set.

HEAVY MUD TO 600', WOODEN PLUG, PLACED 25 SACKS CEMENT ON TOP OF PLUG. HEAVY MUD TO 240', WOODEN PLUG, PLACED 25 SACKS CEMENT ON TOP OF PLUG. HEAVY MUD TO 40', WOODEN PLUG, 1/2 SACK HULLS, 10 SACKS OF CEMENT ON TOP OF PLUG TO BASE OF WELL CELLAR.

RECEIVED
STATE CORPORATION COMMISSION
JUN 7 1971
CONSERVATION DIVISION
Wichita, Kansas

(If additional description is necessary, use BACK of this sheet)

Name of Plugging Contractor GARVEY DRILLING COMPANY

Address ROUTE 2, GREAT BEND, KANSAS

STATE OF KANSAS, COUNTY OF BARTON, ss.

MONTE CHADD, DIST. PROD. SUPT. (employee of owner) or (owner or operator) of the above-described

well, being first duly sworn on oath, says: That I have knowledge of the facts, statements, and matters herein contained and the log of the above-described well as filed and that the same are true and correct. So help me God. MONTE CHADD, DIST. PROD. SUPT.

(Signature) Monte Chadd

R.R. #2, GREAT BEND, KANSAS 67530

(Address)

Subscribed and Sworn to before me this 4 day of JUNE, 19 71

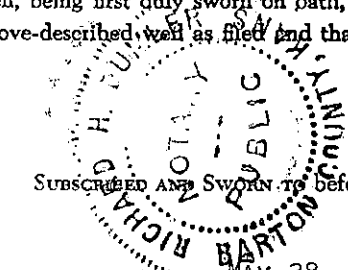

commission expires MAY 28, 1973

Richard H. Runkles

Notary Public.

15-185-20357 - 0000

WELL LOG

COMPANY Petroleum, Inc.

SEC. 10 T. 24S R. 13W

FARM Stoehr NO. 1

LOC. NW SE SW

TOTAL DEPTH 3557'

COUNTY Stafford, Kansas

COMM. 5-28-71 COMP. 6-1-71

CONTRACTOR Garvey Drilling Company

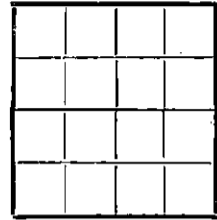

CASING
8 5/8" @ 285' w/225sx

ELEVATION 1914' KB

PRODUCTION D & A

FIGURES INDICATE BOTTOM OF FORMATIONS

- 135' Sand
- 285' Red Bed & Shale
- 767' Red Bed
- 795' Anhydrite
- 1565' Shale & Shells
- 1685' Shale
- 1865' Lime & Shale
- 2048' Lime, Shale, & Sand
- 2380' Lime
- 2670' Shale & Lime
- 2865' Lime & Shale
- 3150' Lime
- 3272' Lime & Shale
- 3557' Shale & Lime
- 3557' RTD

RECEIVED
STATE CORPORATION COMMISSION
JUN 7 1971
CONSERVATION DIVISION
Wichita, Kansas

State of Kansas }
County of Barton } SS

I, Charlene Marker of Garvey Drilling Company

upon oath state the above and foregoing is a true and correct copy of the log of the Stoehr No. 1 well.



Charlene Marker

Subscribed and sworn to before me this 3rd day of June 19 71

My Commission Expires: May 28, 1973

Richard H. Dunker
NOTARY PUBLIC