

STATE OF KANSAS
STATE CORPORATION COMMISSION

Give All Information Completely
Make Required Affidavit
Mail or Deliver Report to:
Conservation Division
State Corporation Commission
211 No. Broadway
Wichita, Kansas

WELL PLUGGING RECORD

STAFFORD County, Sec. 29 Twp. 24s Rge. 13 (X) (W)

Location as "NE/CNWxSWx" or footage from lines E/2 SW SW

Lease Owner PETROLEUM, INC.

Lease Name TOLAND "G" Well No. 1

Office Address ROUTE #2, GREAT BEND, KANSAS

Character of Well (completed as Oil, Gas or Dry Hole) DRY HOLE

Date well completed AUG. 6 19 65

Application for plugging filed AUG. 6 19 65

Application for plugging approved AUG. 6 19 65

Plugging commenced AUG. 6 19 65

Plugging completed AUG. 6 19 65

Reason for abandonment of well or producing formation NO PRODUCIBLE ZONE

If a producing well is abandoned, date of last production NONE 19

Was permission obtained from the Conservation Division or its agents before plugging was commenced? YES

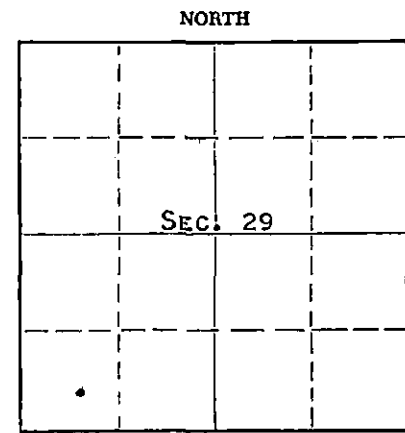

Locate well correctly on above Section Plat

Name of Conservation Agent who supervised plugging of this well ARCHIE ELVING

Producing formation _____ Depth to top _____ Bottom _____ Total Depth of Well 4243 Feet

Show depth and thickness of all water, oil and gas formations.

OIL, GAS OR WATER RECORDS

CASING RECORD

FORMATION	CONTENT	FROM	TO	SIZE	PUT IN	PULLED OUT
				8-5/8"	249'	NONE

Describe in detail the manner in which the well was plugged, indicating where the mud fluid was placed and the method or methods used in introducing it into the hole. If cement or other plugs were used, state the character of same and depth placed, from _____ feet to _____ feet for each plug set.

MUDDED UP WITH HEAVY MUD TO 230', FOLLOWED BY WOODEN PLUG, PLACED 1/2 SACK HULLS AND 20 SACKS CEMENT THROUGH DRILL PIPE ON TOP OF PLUG. MUDDED UP WITH HEAVY MUD TO 40', FOLLOWED BY WOODEN PLUG, PLACED 1/2 SACK HULLS AND 10 SACKS CEMENT ON TOP PLUG TO BASE OF WELL CELLAR.

[Handwritten notes and stamps]

8-12-65

(If additional description is necessary, use BACK of this sheet)

Name of Plugging Contractor GARVEY DRILLING CO.

Address R.R. #2, GREAT BEND, KANSAS

STATE OF KANSAS COUNTY OF BARTON, ss. LAWRENCE PROFFITT

(employee of owner) or (~~owner~~) of the above-described well, being first duly sworn on oath, says: That I have knowledge of the facts, statements, and matters herein contained and the log of the above-described well as filed and that the same are true and correct. So help me God. LAWRENCE PROFFITT, DIST. PROD. FOREMAN

(Signature) *[Signature]*

R.R. #2, GREAT BEND, KANSAS
(Address)

SUBSCRIBED AND SWORN TO before me this 11 day of AUGUST, 19 65

My commission expires MAY 28, 1969

[Signature]
Notary Public.

15-185-30086-0000
WELL LOG

COMPANY Petroleum, Inc.

SEC. 29 T.24S R. 13W

FARM Toland

NO. G-1

LOC. E/2 SW SW

TOTAL DEPTH 4243'

COUNTY Stafford

COMM. 7-25-65

COMP. 8-6-65

CONTRACTOR Garvey Drilling Company

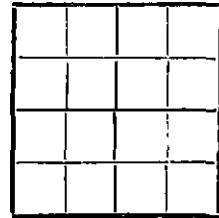

CASING

ELEVATION 1937' DF

PRODUCTION D & A

FIGURES INDICATE BOTTOM OF FORMATIONS

- 130' Sand and Shale
- 250' Blue Shale
- 838' Red Bed and Shale
- 880' Anhydrite
- 990' Shale and Shells
- 1900' Shale and Lime
- 2020' Lime and Shale
- 2340' Lime
- 3808' Lime and Shale
- 3992' Lime
- 4145' Lime and Chert
- 4243' Lime and Shale
- 4243' RTD

RECEIVED
STATE GEOLOGICAL SURVEY
AUG 19 1965
CORRELATION DIVISION
W & M, Kansas

State of Kansas }
County of Barton } ss

I, Sam N. Stephens of Garvey Drilling Company

upon oath state the above and foregoing is a true and correct copy of the log of the Toland G-1 well.

Sam N. Stephens

Subscribed and sworn to before me this 10th day of August 19 65

My Commission Expires: May 28, 1969

Richard H. Tomlinson
NOTARY PUBLIC