

STATE OF KANSAS
STATE CORPORATION COMMISSION

WELL PLUGGING RECORD

API #15-095-20711-0000

Give All Information Completely
Make Required Affidavit
Mail or Deliver Report to
Conservation Division
State Corporation Comm.
245 North Water
Wichita, KS 67202

Kingman County. Sec. 26 Twp. 27S Rge. 5 W
Location as "NE/CNW $\frac{1}{4}$ SW $\frac{1}{4}$ " or footage from lines 660' FNL & 2080' FWL of Section 26.
Lease Owner Gulf Oil Corporation
Lease Name Knoblauch Well No. 1
Office Address P.O. Box 12116, Oklahoma City, OK 73157
Character of Well (Completed as Oil, Gas or Dry Hole) Oil

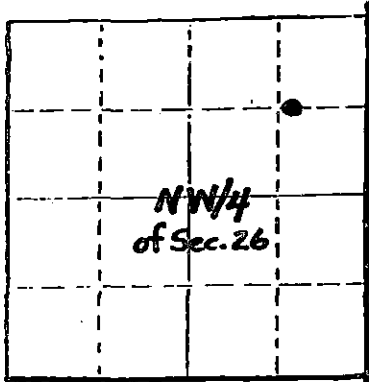

Date Well completed July 21 1978
Application for plugging filed Sept. 23 1982
Application for plugging approved Oct. 26 1982
Plugging commenced Nov. 29 1982
Plugging completed Dec. 3 1982
Reason for abandonment of well or producing formation Depleted Production

If a producing well is abandoned, date of last production September 17, 19 82

Was permission obtained from the Conservation Division or its agents before plugging was commenced? YES

Name of Conservation Agent who supervised plugging of this well Maurice Leslie
Producing formation LANSING-KC Depth to top 3362 Bottom 3386 Total Depth of Well 3822
Show depth and thickness of all water, oil and gas formations.

OIL, GAS OR WATER RECORDS

CASING RECORD

FORMATION	CONTENT	FROM	TO	SIZE	PUT IN	PULLED OUT
Lansing-Kansas City	Oil	3362	3368	8-5/8"	242	None
				5-1/2"	3818	875

Describe in detail the manner in which the well was plugged, indicating where the mud fluid was placed and the method or methods used in introducing it into the hold. If cement or other plugs were used, state the character of same and depth placed, from feet to feet for each plug set.

11-29-82 through 12-03-82: MIRU Towanda Well Service Unit, POH w/rods. Set tbq @ 3466'. MIRU HOWCO: Pump 50 sxs Class "A" cmt from 3466' to 3253'. POH w/tbq. Shot 5-1/2" csg @ 2943'. Filled well with 9 ppg mud. POH w/csg to 1017'. Pumped 400 sxs Class "A" cmt to surface. POH w/all csg. Topped off well to 5' below ground level with cmt. State Plugger Maurice Leslie on location. Cut surface csg off 5' below ground level. Capped well. ID Well. Well was P&A'd 12-03-82.

(If additional description is necessary, use BACK of this sheet)

Name of Plugging Contractor Towanda Well Service - LICENSE #5683

STATE OF OKLAHOMA COUNTY OF OKLAHOMA, ss.
Dorretta Moore (employee of ~~xxxxxx~~ operator)

of the above-described well, being first duly sworn on oath, says: That I have knowledge of the facts, statements, and matters herein contained and the log of the above-described well as filed and that the same are true and correct. So help me God.

(Signature) Dorretta Moore
(same as Operator shown above)

SUBSCRIBED AND SWORN TO before me this 9th day of February, 19 83.

My commission expires 01-31-87

Patricia A. Wonderly
PATRICIA A. WONDERLY, Notary Public.
STATE CORPORATION COMMISSION

FEB 10 1983
2-10-83
CONSERVATION DIVISION
Wichita, Kansas

IMPORTANT
Kans. Geol. Survey request
samples on this well.

Well File ~~_____~~

KANSAS DRILLERS LOG

S. 26 T. 27 R. 5 ^W
Loc. NE NW
County Kingman

API No. 15 — 095 — 20,711 ^{← 00-00}
County Number
Operator Kewanee Oil Co.
Address P. O. Box 2093 Wichita, Kansas 67201
Well No. #2 #1 Lease Name Bonjour Knoblauch
Footage Location 660 feet from (N) (X) line 2080 feet from (W) (X) line
Principal Contractor Gabbert-Jones Geologist A. W. Stude
Spud Date May 23, 1978 Total Depth 3822' G.L. P.B.T.D. 3460' G.L.
Date Completed June 10, 1978 Oil Purchaser Koch

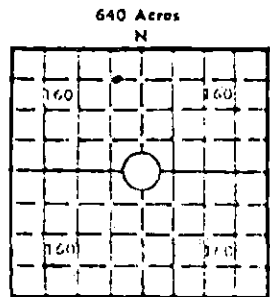

Locate well correctly
Elev.: Gr. 1482'
DF _____ KG _____

CASING RECORD **COPY**

Report of all strings set — surface, intermediate, production, etc.

Purpose of string	Size hole drilled	Size casing set (in O.D.)	Weight lbs/ft.	Setting depth	Type cement	Sacks	Type and percent additives
Surface	12-1/4"	8-5/8"	20#	242	Common	175	3% CaCl, 2% Gel 1/4" Flocele/sack
Oil String	7-7/8"	5-1/2"	14#	3818	50-50 Pozmix	150	18% Salt 2% Gel 3/4" CFR-2, 1/4" Flocele/sack

LINER RECORD

PERFORATION RECORD

Top, ft.	Bottom, ft.	Sacks cement	Shots per ft.	Size & type	Depth interval
			2	1/4" Jet	3736' - 3738'
TUBING RECORD			4	1/4" Jet	3742' - 3744'
Size	Setting depth	Packer set at	2	1/2" Perf.	3362' - 3364'

ACID, FRACTURE, SHOT, CEMENT SQUEEZE RECORD

Amount and kind of material used	Depth interval treated
250 gals. 7-1/2% HCl Acid with 1/2 gal. Pen 5	3742' - 3744'
250 gals. MCA Acid using 2% Ke 1	3362' - 3364'
Bridge Plug by Welex	3460'

INITIAL PRODUCTION

Date of first production June 10, 1978 Producing method (flowing, pumping, gas lift, etc.) Swabbed Pump Test, 7-22-78, 43.4 BO & 280 BW
 RATE OF PRODUCTION PER 24 HOURS
 Oil 108 bbls. Gas None MCF Water 405.6 bbls. Gas-oil ratio ----- CFPB
 Disposition of gas (vented, used on lease or sold) None Producing interval (s) -----

RECEIVED
STATE CORPORATION COMMISSION

INSTRUCTIONS: As provided in KCC Rule 82-2-125, within 90 days after completion of a well, one completed copy of this Drillers Log shall be transmitted to the State Geological Survey of Kansas, 4150 Monroe Street, Wichita, Kansas 67209. Copies of this form are available from the Production Division, State Corporation Commission, 3830 So. Meridian (P.O. Box 17027), Wichita, Kansas 66217. Phone AC 316-522-2206. If confidential custody is desired, please note Rule 82-2-125. Drillers Logs will be on an open file in the Oil and Gas Division, State Geological Survey of Kansas, Lawrence, Kansas 66044.

SEP 24 1978
CONSERVATION DIVISION
Wichita, Kansas
6-10-1972

Operator **Kewanee Oil Company** DESIGNATE TYPE OF COMP.: OIL, GAS, DRY HOLE, SWDOW, ETC.: **Oil**

Well No. **#1** Lease Name **Knoblauch**

s 26 T 27S R 5 ^{EX} W

WELL LOG

Show all important zones of porosity and contents thereof; cored intervals, and all drill-stem tests, including depth interval tested, cushion used, time tool open, flowing and shut-in pressures, and recoveries.

SHOW GEOLOGICAL MARKERS, LOGS RUN, OR OTHER DESCRIPTIVE INFORMATION.

FORMATION DESCRIPTION, CONTENTS, ETC.	TOP	BOTTOM	NAME	DEPTH
Clay, Sand	0	20		
Redbed, Shale	20	140		
Redbed	140	250		
Redbed, Shells	250	730		
Lime, Shale	730	2320		
Shale, Lime	2320	2915		
Lime	2915	3820		
Driller's Total Depth		3820		

FORMATION TOPS (LOGS)

Heebner	2682	-1200		
Toronto	2696	-1214		
Douglas	2714	-1232		
Brown Lime	2904	-1422		
Lansing	2946	-1464		
Stark Shale	3330	-1448		
Hushpuckney Shale	3354	-1872		
"K" Zone (Hertha)	3358	-1876		
"K" Por	3362	-1880		
Base/Kansas City	3406	-1924		
Cherokee Shale	3588	-2106		
Mississippi	3734	-2252		
Total Depth (Log)	3822	-2340		
Driller's Total Depth	3820	-2338		

COPY

RECEIVED
 OKLA. CITY AREA
 SEP 11 1978

Logs mailed
 May 9, 1978.

USE ADDITIONAL SHEETS, IF NECESSARY, TO COMPLETE WELL RECORD.

Date Received	<i>C. T. Oglesby</i> Signature
	C. T. Oglesby Production Supervisor
	August 30, 1978 Date