

RELEASED ORIGINAL

SIDE ONE

Bottom hole loc 3382 FSL
4510 FEL

STATE CORPORATION COMMISSION OF KANSAS
OIL & GAS CONSERVATION DIVISION
WELL COMPLETION FORM
ACO-1 WELL HISTORY
DESCRIPTION OF WELL AND LEASE

API NO. 15- 05520961 0100

County Finney

Approx.

NW SE NW/4 Sec. 27 Twp. 24S Rge. 33 East West

3830 Bottom hole loc. 3465' FSL & 4455
Ft. North from Southeast Corner of Section FEL

3600 Ft. West from Southeast Corner of Section
(NOTE: Locate well in section plat below.)

Lease Name Tait C Well # 9

Field Name Kansas Hugoton Gas

Producing Formation Chase

Elevation: Ground 2912' KB 2923'

Total Depth 5335' PBDT 2998'

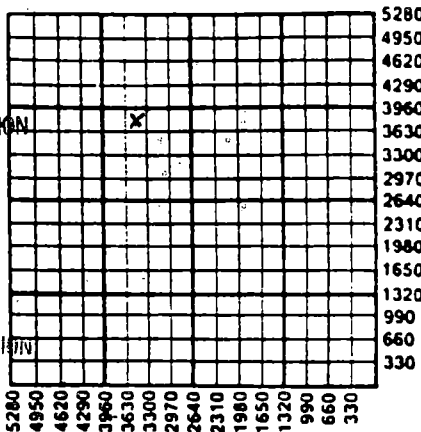

Operator: License # 5447

Name: OXY USA, Inc.

Address P.O. Box 26100

City/State/Zip Oklahoma City, OK 73126-0100

Purchaser: Northern Natural Pipeline

Operator Contact Person: Raymond Hui

Phone (405) 749-2471

Contractor: Name: Gabbert Jones Drilling Co.

License: 5842

Wellsite Geologist: Craig Corbett

Designate Type of Completion

New Well Re-Entry Workover

Oil SWD Temp. Abd.
 Gas Inj Delayed Comp.
 Dry Other (Core, Water Supply, etc.)

If CWD: old well info as follows:

Operator: _____

Well Name: _____

Comp. Date _____ Old Total Depth _____

Drilling Method:

Mud Rotary Air Rotary Cable

5/4/91 5/21/91 8/2/91
Spud Date Date Reached TD Completion Date

Amount of Surface Pipe Set and Cemented at 1944' Feet

Multiple Stage Cementing Collar Used? Yes No

If yes, show depth set _____ Feet

If Alternate II completion, cement circulated from _____
feet depth to _____ w/ _____ sx cmt.

INSTRUCTIONS: This form shall be completed in triplicate and filed with the Kansas Corporation Commission, 200 Colorado Derby Building, Wichita, Kansas 67202, within 120 days of the spud date of any well. Rule 82-3-130, 82-3-107 and 82-3-106 apply. Information on side two of this form will be held confidential for a period of 12 months if requested in writing and submitted with the form. See rule 82-3-107 for confidentiality in excess of 12 months. One copy of all wireline logs and drillers time log shall be attached with this form. ALL CEMENTING TICKETS MUST BE ATTACHED. Submit CP-4 form with all plugged wells. Submit CP-111 form with all temporarily abandoned wells. Any recompletion, workover or conversion of a well requires filing of ACO-2 within 120 days from commencement date of such work.

All requirements of the statutes, rules and regulations promulgated to regulate the oil and gas industry have been fully complied with and the statements herein are complete and correct to the best of my knowledge.

Signature Vic Tumlinson

Title Operations Drilling Manager Date 8/2/91

Subscribed and sworn to before me this 2nd day of August, 1991.

Notary Public Ray Ann Kilmer

Date Commission Expires 4-16-94

K.C.C. OFFICE USE ONLY

F Letter of Confidentiality Attached
C Wireline Log Received
C Drillers Time Log Received

Distribution
 KCC SWD/Rep NGPA
 KGS Plug Other
(Specify)

SIDE TWO

Operator Name OXY USA, Inc. Lease Name Taft C Well # 9
 Sec. 27 Twp. 24S Rge. 33 East West
 County Finney

INSTRUCTIONS: Show important tops and base of formations penetrated. Detail all cores. Report all drill stem tests giving interval tested, time tool open and closed, flowing and shut-in pressures, whether shut-in pressure reached static level, hydrostatic pressures, bottom hole temperature, fluid recovery, and flow rates if gas to surface during test. Attach extra sheet if more space is needed. Attach copy of log.

Drill Stem Tests Taken Yes No
 (Attach Additional Sheets.)

Samples Sent to Geological Survey Yes No

Cores Taken Yes No

Electric Log Run Yes No
 (Submit Copy.)

Ran DIL-SEL w/GR log.
 RIH w/ OE DP to 5120'. Set 75 sx Cl. H. cmt plug from 5120'-4930'. Pulled DP to 3230'; set 100 sx Cl. H. cmt plug from 3230'-2980'.

Formation Description

Log Sample

Name	Top	Bottom
Winfield	2590	3887
Heebner	3887	3986
Lansing	3986	4469
Marmaton	4469	4819
Morrow	4819	4966
Meramec	4966	5335
TD		5335
PBTD		5335

CASING RECORD New Used
 Report all strings set-conductor, surface, intermediate, production, etc.

Purpose of String	Size Hole Drilled	Size Casing Set (In O.D.)	Weight Lbs./Ft.	Setting Depth	Type of Cement	# Sacks Used	Type and Percent Additives
Conductor Pipe	30"	20"		63.5'	Redi-mix	150	Class H
Surface	12 1/4"	8 5/8"	24#	1944'	Class C	775	6% Gel
Production	7 5/8"	5 1/2"	14#	3043'	Class C	500	6% Gel

PERFORATION RECORD

Shots Per Foot	Specify Footage of Each Interval Perforated	Acid, Fracture, Shot, Cement Squeeze Record (Amount and Kind of Material Used)	Depth
4	2542-2546'	Acidized Chase w/5000 gal of 7 1/2% HCL.	2542-2668
	2568-2572'		
	2598-2602'		
	2664-2668'	Frac'd Chase w/ 52000 gal of 30# XL'd gel. and 175000# 12/20 Brady sand.	2542-2668

TUBING RECORD

Size	Set At	Packer At	Liner Run <input type="checkbox"/> Yes <input type="checkbox"/> No

Date of First Production Waiting for PL connection. Flowing Pumping Gas Lift Other (Explain)

Estimated Production Per 24 Hours	Oil Bbls.	Gas Mcf	Water Bbls.	Gas-Oil Ratio	Gravity
		263			

Disposition of Gas: Vented Sold Used on Lease (If vented, submit ACO-18.)

METHOD OF COMPLETION Open Hole Perforation Dually Completed Commingled Other (Specify) _____

Production Interval 2542-2668

ORIGINAL

REMIT TO:
P.O. BOX 951046
DALLAS, TX 75395-1046

INVOICE

ORIGINAL HALLIBURTON SERVICES

AUG 2



CONFIDENTIAL

INVOICE NO.	DATE
141954	05/20/1991

WELL LEASE NO./PLANT NAME		WELL/PLANT LOCATION		STATE	WELL/PLANT OWNER	
TAIT "C" 9		FLINNEY		KS	SAME	
SERVICE LOCATION		CONTRACTOR		JOB PURPOSE		TICKET DATE
LIBERAL		GABBERT & JONES #3		COMBINATION PLUG BACK & CASING		05/20/1991
ACCT. NO.	CUSTOMER AGENT	VENDOR NO.	CUSTOMER P.O. NUMBER	SHIPPED VIA	FILE NO.	
659167	TIMOTHY J. VOSS	E-26		COMPANY TRUCK	16008	

OXY USA INC.
REGIONAL OFFICE
ATT: G. I. MCFARLAND
PO BOX 26100
OKLAHOMA CITY, OK 73126-0100

DIRECT CORRESPONDENCE TO:
FIRST OKLAHOMA TOWER
210 WEST PARK AVENUE
SUITE 2050
OKLAHOMA CITY, OK 73102-5601

PRICE REF. NO.	DESCRIPTION	QUANTITY	U/M	UNIT PRICE	AMOUNT
	INVOICE SUBTOTAL				10,703.54
	DISCOUNT-(BID)				3,532.11-
	INVOICE BID AMOUNT				7,171.43
	*-KANSAS STATE SALES TAX				238.67
	*-SEWARD COUNTY SALES TAX				56.16

<p>9-1572289 x 2360.1/724 6/7 ksp</p> <p>OKLAHOMA CITY E&P</p>					
INVOICE TOTAL - PLEASE PAY THIS AMOUNT =====>					\$7,466.26

DISB. APPR.	DATE REC'D	3 7 1991	
CO-DIV-SUP	LOC-CODE	DUE DATE	SPL. RPT. CD.
327-77	1052		006
BID	ACC'TG. APPR.	CASH DISB.	

RECEIVED
STATE CORPORATION COMMISSION
SEP 19 1991
CONSERVATION DIVISION
Wichita, Kansas

AFFIX JOB TKT

TERMS INVOICES PAYABLE NET BY THE 20TH OF THE FOLLOWING MONTH AFTER DATE OF INVOICE. UPON CUSTOMER'S DEFAULT IN PAYMENT OF CUSTOMER'S ACCOUNT BY THE LAST DAY OF THE MONTH FOLLOWING THE MONTH IN WHICH THE INVOICE IS DATED. CUSTOMER AGREES TO PAY INTEREST THEREON AFTER DEFAULT AT THE HIGHEST LAWFUL CONTRACT RATE APPLICABLE BUT NEVER TO EXCEED 18% PER ANNUM. IN THE EVENT IT BECOMES NECESSARY TO EMPLOY AN ATTORNEY TO ENFORCE COLLECTION OF SAID ACCOUNT. CUSTOMER AGREES TO PAY ALL COLLECTION COSTS AND ATTORNEY FEES IN THE AMOUNT OF 20% OF THE AMOUNT OF THE UNPAID ACCOUNT

INVOICE

ORIGINAL HALLIBURTON SERVICES AUG 2

REMIT TO:
P.O. BOX 951046
DALLAS, TX 75395-1046



A Halliburton Company

SEP 19 1991

CONFIDENTIAL

INVOICE NO.	DATE
141954	05/20/1991

WELL LEASE NO./PLANT NAME		WELL/PLANT LOCATION		STATE	WELL/PLANT OWNER
TAIT "C" 9		FINNEY		KS	SAME
SERVICE LOCATION	CONTRACTOR	JOB PURPOSE		TICKET DATE	
LIBERAL	GABBERT & JONES #8	COMBINATION PLUG BACK & CASING		05/20/1991	
ACCT. NO.	CUSTOMER AGENT	VENDOR NO.	CUSTOMER P.O. NUMBER	SHIPPED VIA	FILE NO.
659167	TIMOTHY J. VOSS	E-26		COMPANY TRUCK	16008

OXY USA INC.
REGIONAL OFFICE
ATT: G. I. MCFARLAND
PO BOX 26100
OKLAHOMA CITY, OK 73126-0100

DIRECT CORRESPONDENCE TO:
FIRST OKLAHOMA TOWER
210 WEST PARK AVENUE
SUITE 2050
OKLAHOMA CITY, OK 73102-5601

PRICE REF. NO.	DESCRIPTION	QUANTITY	U/M	UNIT PRICE	AMOUNT
PRICING AREA - MID CONTINENT					
000-117	MILEAGE	60	MI	2.60	156.00
		1	UNT		
009-308	PLUG-BACK & CASING JOB COMBO	8	HR	840.00	840.00
001-016	CEMENTING CASING	3045	FT	1,185.00	1,185.00
		1	UNT		
000-119	MILEAGE FOR CREW	60	MI	1.35	81.00
		1	UNT		
030-016	CEMENTING PLUG SW ALUM TOP	5 1/2	IN	50.00	50.00
		1	EA		
218-738	CLAYFIX II	3	GAL	20.00	60.00
12A	GUIDE SHOE - 5 1/2" 8RD THD.	1	EA	105.00	105.00
825.205					
4A	FLOAT COLLAR-SSII-5-1/2 8RD	1	EA	253.00	253.00
836.07100					
40	CENTRALIZER 5-1/2" MODEL S-4	10	EA	44.00	440.00
807.93022					
350	HALLIBURTON WELD-A	1	LB	11.50	11.50
890.10802					
504-043	PREMIUM CEMENT	175	SK	6.85	1,198.75
509-406	ANHYDROUS CALCIUM CHLORIDE	2	SK	26.25	52.50
500-207	BULK SERVICE CHARGE	179	CFT	1.15	205.85
500-306	MILEAGE CMTG MAT DEL OR RETURN	498.3	TMI	.80	398.64
504-050	PREMIUM PLUS CEMENT	125	SK	7.08	885.00
506-105	POZMIX A	125	SK	3.91	488.75
506-121	HALLIBURTON-GEL 2%	4	SK	.00	N/C
504-120	HALL. LIGHT -PREMIUM PLUS	250	SK	6.29	1,572.50
507-153	CFR-3	63	LB	4.10	258.30
507-210	FLOCELE	125	LB	1.30	162.50
507-661	HALAD-4	63	LB	8.25	519.75
509-406	ANHYDROUS CALCIUM CHLORIDE	4	SK	26.25	105.00
500-207	BULK SERVICE CHARGE	516	CFT	1.15	593.40
500-306	MILEAGE CMTG MAT DEL OR RETURN	1351.380	TMI	.80	1,081.10

***** CONTINUED ON NEXT PAGE *****

AFFIX JOB TKT TERMS INVOICES PAYABLE NET BY THE 20TH OF THE FOLLOWING MONTH AFTER DATE OF INVOICE UPON CUSTOMER'S DEFAULT IN PAYMENT OF CUSTOMER'S ACCOUNT BY THE LAST DAY OF THE MONTH FOLLOWING THE MONTH IN WHICH THE INVOICE IS DATED. CUSTOMER AGREES TO PAY INTEREST THEREON AFTER DEFAULT AT THE HIGHEST LAWFUL CONTRACT RATE APPLICABLE BUT NEVER TO EXCEED 18% PER ANNUM. IN THE EVENT IT BECOMES NECESSARY TO EMPLOY AN ATTORNEY TO ENFORCE COLLECTION OF SAID ACCOUNT, CUSTOMER AGREES TO PAY ALL COLLECTION COSTS AND ATTORNEY FEES IN THE AMOUNT OF 20% OF THE AMOUNT OF THE UNPAID ACCOUNT

Correction

15-055-20961-0100
CO-7 

PLAT AND CERTIFICATION OF ACREAGE ATTRIBUTABLE TO AN OIL WELL

State Corporation Commission, Conservation Division
200 Colorado Derby Bldg. Wichita, Kansas 67202

OPERATOR OXY USA Inc.
LEASE NAME Tait C
WELL NUMBER 9
FIELD Cowgill
NUMBER OF ACRES ATTRIBUTED TO WELL _____

LOCATION OF WELL:
_____ 3830 feet north of SE corner
_____ 3600 feet west of SE corner
NW/4 Sec. 27 T. 24S R. 33W
COUNTY Finney

PLAT
(Show location of well and shade attributable acreage)
(Show footage to nearest lease or unit boundary line)

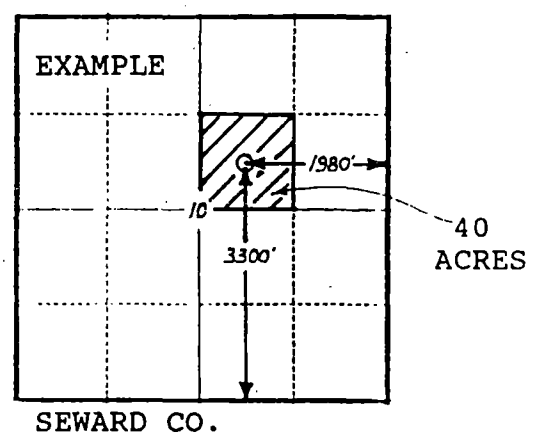
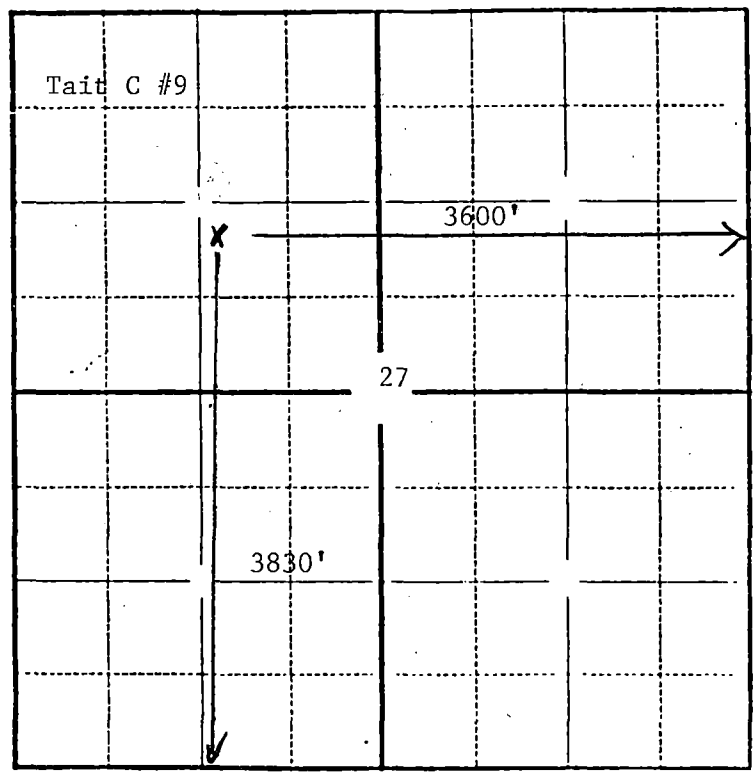

The undersigned hereby certifies that he is Raymond Hui
for OXY USA Inc. (Co.), a duly authorized agent, that all
information shown hereon is true and correct to the best of his knowledge and
belief, and that all acreage claimed as attributable to the well named herein
is held by production from that well.

Subscribed and sworn to before me on this 28th day of January, 1991.

Raymond Hui
Kay Ann Palmer
Notary Public

My Commission expires 4-16-94

(6-1989)

RECEIVED
STATE CORPORATION COMMISSION

JAN 29 1991

CONSERVATION DIVISION
Wichita, Kansas

AP

CG-8

PLAT AND CERTIFICATION OF ACREAGE ATTRIBUTABLE TO A GAS WELL

State Corporation Commission, Conservation Division
200 Colorado Derby Bldg. Wichita, Kansas 67202

OPERATOR OXY USA, INC.
LEASE Tait C
WELL NUMBER 9
FIELD Cowgill

LOCATION OF WELL:
4210 feet north of SE corner
3880 feet west of SE corner
NW/4 Sec. 27 T. 24S R. 33W
COUNTY Finney

ORDER GRANTING ALLOWABLE ENTERED IN DOCKET NO. 172, 20 4-C (C-25531)

NUMBER OF ACRES
ATTRIBUTABLE TO WELL 640

DESCRIPTION OF ACREAGE:

PLAT

(Show location of well and shade attributable acreage)
(Show footage to nearest lease or unit boundary line)

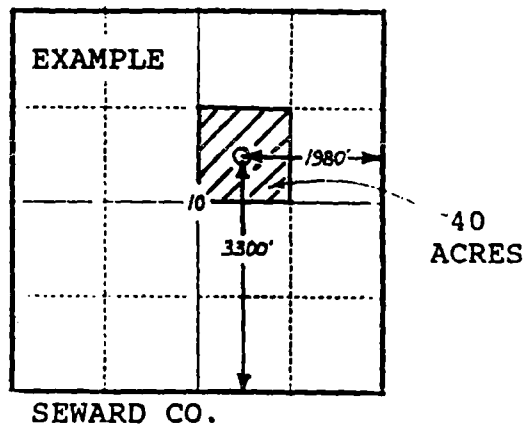
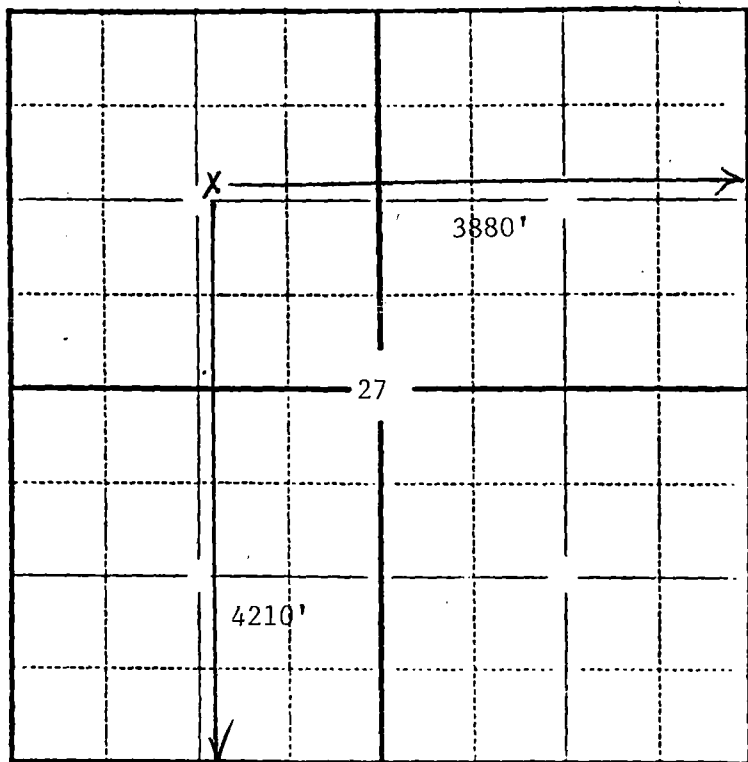

The undersigned hereby certifies as Sr. Acct. Controls Analyst (title) for OXY USA, INC. (Co.), a duly authorized agent, that all information shown hereon is true and correct to the best of my knowledge and belief, and that all acreage claimed attributable to the well named herein is held by production from that well.

Subscribed and sworn to before me on this 14th day of January, 1991

Raymond Hill
Kay Ann Filmer
Notary Public

My Commission expires 4-16-94

RECEIVED
STATE CORPORATION COMMISSION
(6-1989)
JAN 16 1991
CONSERVATION DIVISION
Wichita, Kansas

15-055-20921-0000

Cowgill deleted

NP

CO-7

PLAT AND CERTIFICATION OF ACREAGE ATTRIBUTABLE TO AN OIL WELL

State Corporation Commission, Conservation Division
200 Colorado Derby Bldg. Wichita, Kansas 67202

OPERATOR OXY USA Inc.
LEASE NAME Tait C
WELL NUMBER 9
FIELD Cowgill
NUMBER OF ACRES ATTRIBUTED TO WELL _____

LOCATION OF WELL:
4210 feet north of SE corner
3880 feet west of SE corner
NW/4 Sec. 27 T. 24S R. 33W
COUNTY Finney

PLAT
(Show location of well and shade attributable acreage)
(Show footage to nearest lease or unit boundary line)

RECEIVED
STATE CORPORATION COMMISSION

JAN 18 1991

CONSERVATION DIVISION
Wichita, Kansas

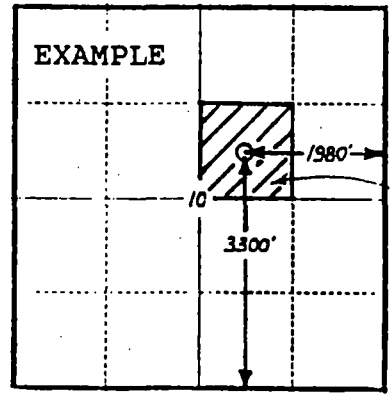
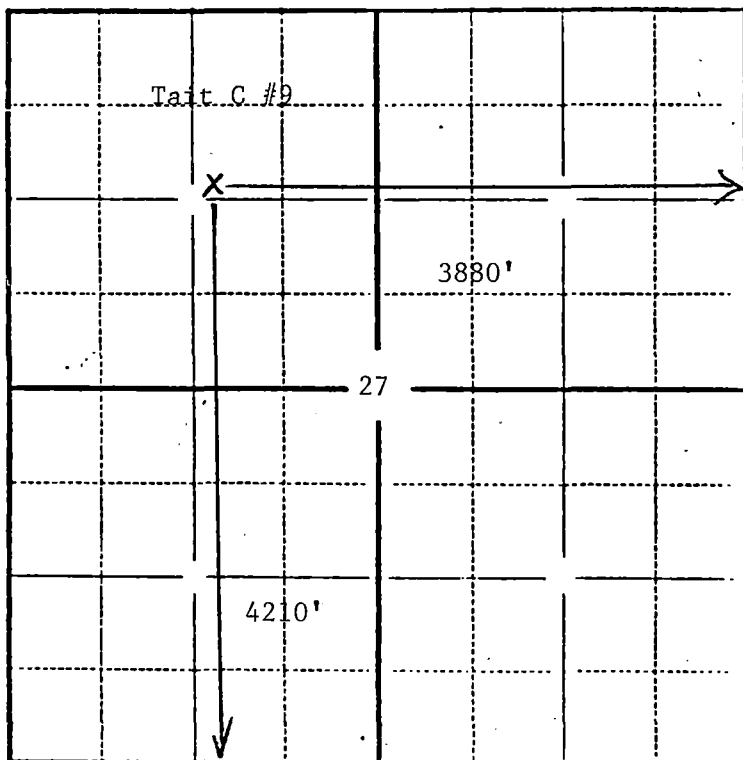

The undersigned hereby certifies that he is Raymond Hui
for OXY USA Inc. (Co.), a duly authorized agent, that all
information shown hereon is true and correct to the best of his knowledge and
belief, and that all acreage claimed as attributable to the well named herein
is held by production from that well.

Subscribed and sworn to before me on this 16th day of January, 19 91

Raymond Hui
Kay Ann Pilmer
Notary Public

My Commission expires 4-11-94

(6-1989)