

STATE CORPORATION COMMISSION OF KANSAS  
OIL & GAS CONSERVATION DIVISION  
WELL COMPLETION OR RECOMPLETION FORM  
ACO-1 WELL HISTORY  
DESCRIPTION OF WELL AND LEASE

API NO. 15-185-22-519-0000

County Stafford

app. SW. SW. NE. Sec. 2 Twp 24 Rge 14 East X West

3060 Ft North from Southeast Corner of Section  
2310 Ft West from Southeast Corner of Section

(Note: Locate well in section plat below)

Lease Name Burke Well # 1

Field Name Rattlesnake North

Producing Formation Conglomerate

Elevation: Ground 1952' KB 1957'

Operator: License # 9324  
Name JFW INC  
Address R.R. 1 Box 26  
City/State/Zip Plevna, Kansas 67568

Purchaser Clear Creek, Inc.  
Wichita, Ks.

Operator Contact Person Elsie L. McNamee  
Phone 316/286-5318

Contractor: License # 5929  
Name Duke Drilling Co. Inc.

Wellsite Geologist Scott Alberg  
Phone 316/672-5729

Designate Type of Completion  
X New Well Re-Entry Workover

X Oil SWD Temp Abd  
Gas Inj Delayed Comp.  
Dry Other (Core, Water Supply etc.)

If OWWO: old well info as follows:  
Operator  
Well Name  
Comp. Date Old Total Depth

WELL HISTORY

Drilling Method:  
X Mud Rotary Air Rotary Cable

5-26-88 6-3-88 6/30/88  
Spud Date Date Reached TD Completion Date

4220'  
Total Depth PBTD

Amount of Surface Pipe Set and Cemented at 265' feet  
Multiple Stage Cementing Collar Used? Yes X No  
If yes, show depth set feet  
If alternate 2 completion, cement circulated from feet depth to w/ SX cmt  
Cement Company Name  
Invoice #

RECEIVED  
STATE CORPORATION COMMISSION  
AUG 29 1988  
CONSERVATION DIVISION  
Wichita, Kansas

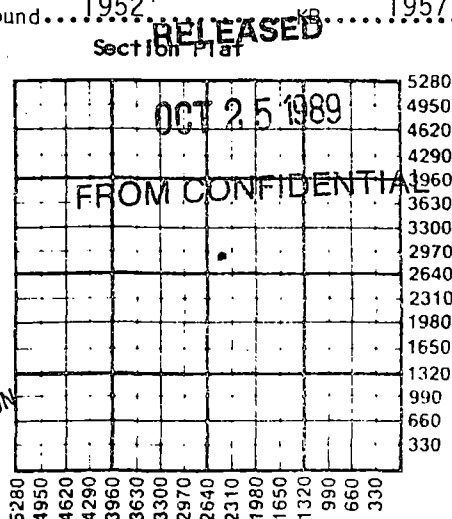

WATER SUPPLY INFORMATION  
Disposition of Produced Water: Disposal  
Docket # Repressuring

Questions on this portion of the ACO-1 call:  
Water Resources Board (913) 296-3717  
Source of Water:  
Division of Water Resources Permit #  
X Groundwater 3060 Ft North from Southeast Corner (Well) 2310 Ft West from Southeast Corner of Sec 2 Twp 24 Rge 14 East X West  
Surface Water Ft North from Southeast Corner (Stream, pond etc) Ft West from Southeast Corner Sec Twp Rge East West  
Other (explain) (purchased from city, R.W.D. #)

INSTRUCTIONS: This form shall be completed in triplicate and filed with the Kansas Corporation Commission, 200 Colorado Derby Building, Wichita, Kansas 67202, within 120 days of the spud date of any well. Rule 82-3-130, 82-3-107 and 82-3-106 apply. Information on side two of this form will be held confidential for a period of 12 months if requested in writing and submitted with the form. See rule 82-3-107 for confidentiality in excess of 12 months. One copy of all wireline logs and drillers time log shall be attached with this form. Submit CP-4 form with all plugged wells. Submit CP-111 form with all temporarily abandoned wells.

All requirements of the statutes, rules and regulations promulgated to regulate the oil and gas industry have been fully complied with and the statements herein are complete and correct to the best of my knowledge.

Signature *Colvin L. McNamee*

Title President Date 8/5/88

Subscribed and sworn to before me this 5 day of Aug 1988

Notary Public Jody Updegrave

Date Commission Expires 12-9-89

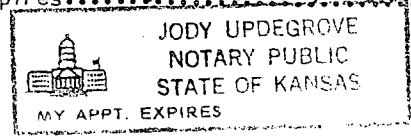

K.C.C. OFFICE USE ONLY  
Letter of Confidentiality Attached  
Wireline Log Received  
Drillers Timelog Received  
Distribution  
KCC SWD/Rep NGPA  
KGS Plug Other (Specify)  
8-29-88  
Form ACO-1 (5-86)

Sec. 2, Twp. 24 Rge. 14 E

Operator Name JFW, INC Lease Name Burke Well # 1

Sec. 2 Twp. 24 Rge. 14  East  West County Stafford

WELL LOG

INSTRUCTIONS: Show important tops and base of formations penetrated. Detail all cores. Report all drill stem tests giving interval tested, time tool open and closed, flowing and shut-in pressures, whether shut-in pressure reached static level, hydrostatic pressures, bottom hole temperature, fluid recovery, and flow rates if gas to surface during test. Attach extra sheet if more space is needed. Attach copy of log.

Drill Stem Tests Taken  Yes  No  
 Samples Sent to Geological Survey  Yes  No  
 Cores Taken  Yes  No

DST #1  
 3962-3991 IFP 96-114# fair blow  
 Conglomerate ICIP 366#  
 Times 30-60-45-90 FFP122-134 weak blow  
 FCIP 366#  
 IHP/FHp 2051/2022#

Recovery  
 150' muddy oil (25% mud, 75% oil)  
 60' slightly oil cut water  
 chlorides 85,000 P.P.M. temp. 113°

DST #23994-4-42 Miss- Cong 30-60-30-60  
 IFP 80-86# blow died ICIP 94# FFP 86-86# blow  
 died FCIP 86# IHP?FHP 2071/2036# temp 114°  
 Recovery- 10' drilling mud- few oil specks.

DST #3 4023-4040 Miss- Viola 30-60-30-60  
 IFP 78-80# blow died ICIP 84# FFP 80-80# blow  
 died. FCIP 82# IHP/FHP 2126/2078  
 Recovery- 5' drilling mud. temp 114°

Formation Description  
 Log  Sample

Name	Top	Bottom
Heebner	3462	(-1505)
Toronto	2482	(-1525)
Douglas Shale	3498	(-1541)
Brown Lime	3601	(-1644)
Lansing	3622	(-1665)
B/KC	3879	(-1922)
Conglomerate	3918	(-1961)
Mississippi	3998	(-2041)
Viola	4028	(-2071)
Simpson Shale	4126	(-2169)
Arbuckle	4175	(-2218)
Log Total depth	4220	(-2263)

RELEASED

OCT 25 1989

CASING RECORD  New  Used ~~FROM CONFIDENTIAL~~

Report all strings set-conductor, surface, intermediate, production, etc.

Purpose of String	Size Hole Drilled	Size Casing Set (in O.D.)	Weight Lbs/Ft.	Setting Depth	Type of Cement	#Sacks Used	Type and Percent Additives
Surface Casing	12 1/4"	8 5/8"	20#	278'	Com.	165sx	2% gal. & .3% cc.
Prod. Casing	7 7/8"	5 1/2"	14 & 15#	4121'		125sx	Howco 50/50. poz. 10% salt, 50% Halad 322 w/20 barrel salt flush & 300 gal

PERFORATION RECORD

Shots Per Foot	Specify Footage of Each Interval Perforated	Acid, Fracture, Shot, Cement Squeeze Record (Amount and Kind of Material Used)	Depth
3	3975-3978	10 bbl 7 1/2% DS FE acid frac. 20,000 gal. 80% foam N2 20/40 sand & 10,500 12/20 sand--displaced with 27,000 SCF N2	3975-3978

TUBING RECORD

Size	Set At	Packer at	Liner Run	Yes <input type="checkbox"/> No <input checked="" type="checkbox"/>
27/8	3993			

Date of First Production 7/1/88 Producing Method  Flowing  Pumping  Gas Lift  Other (explain).....

Estimated Production Per 24 Hours	Oil Bbls	Gas MCF	Water Bbls	Gas-Oil Ratio	Gravity
	12	3	6		

METHOD OF COMPLETION

Production Interval

Disposition of gas:  Vented  Open Hole  Perforation  
 Sold  Other (Specify) ..... 3975-3978  
 Used on Lease  Dually Completed .....  
 Commingled .....

Please keep this well information tight hole for as long as you can.