

STATE CORPORATION COMMISSION OF KANSAS
OIL & GAS CONSERVATION DIVISION
WELL COMPLETION OR RECOMPLETION FORM
ACO-1 WELL HISTORY
DESCRIPTION OF WELL AND LEASE

API No. 15-095-21,599-0000
County Kingman
SW NW NW Sec 5 Twp 27 Rge 8 East West

Operator: License # 6139
Name Jay C. Boyer
Address P.O. Box 511
City/State/Zip Hays, KS, 67601

4290 Ft North from Southeast Corner of Section
4950 Ft West from Southeast Corner of Section
(Note: Locate well in section plat below)

Purchaser

Lease Name Eberhart Well # 1
Field Name Wildcat

Operator Contact Person Jay C. Boyer
Phone (913) 625-6967

Producing Formation
Elevation: Ground 1665 KB 1673

Contractor: License # 5929
Name Duke Drilling Co., Inc.

Wellsite Geologist Robert E. O'Dell
Phone (316) 721-2175

Designate Type of Completion
X New Well Re-Entry Workover
Oil SWD Temp Abd
Gas Inj Delayed Comp.
X Dry Other (Core, Water Supply etc.)

If OWWO: old well info as follows:
Operator
Well Name
Comp. Date Old Total Depth

WELL HISTORY

Drilling Method:
X Mud Rotary Air Rotary Cable

1-10-89 1-14-89 1-14-89
Spud Date Date Reached TD Completion Date
3770'
Total Depth PBD

Amount of Surface Pipe Set and Cemented at 229 feet
Multiple Stage Cementing Collar Used? Yes No
If yes, show depth set feet
If alternate 2 completion, cement circulated from feet depth to w/ SX cmt
Cement Company Name United Cementing & Acid Co.
Invoice # 0114

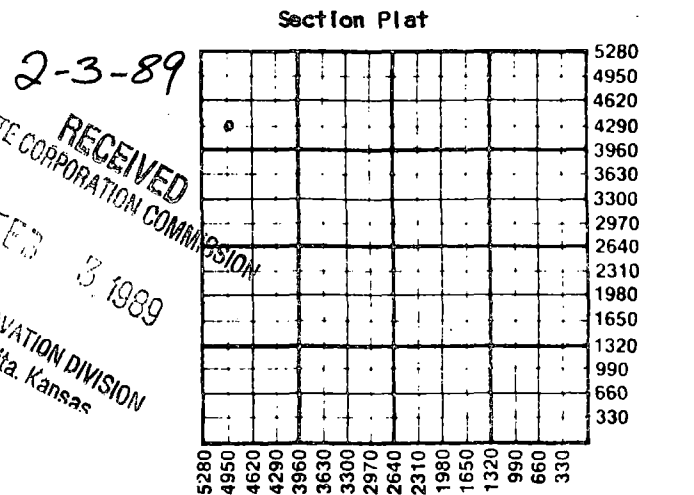

WATER SUPPLY INFORMATION
Disposition of Produced Water: Disposal
Docket # Repressuring

Questions on this portion of the ACO-1 call:
Water Resources Board (913) 296-3717
Source of Water:
Division of Water Resources Permit # J89-003
X Groundwater 4290 Ft North from Southeast Corner
(Well) 4950 Ft West from Southeast Corner of
Sec 5 Twp 27 Rge 8 East X West
Surface Water Ft North from Southeast Corner
(Stream, pond etc) Ft West from Southeast Corner
Sec Twp Rge East West
Other (explain)
(purchased from city, R.W.D. #)

INSTRUCTIONS: This form shall be completed in triplicate and filed with the Kansas Corporation Commission, 200 Colorado Derby Building, Wichita, Kansas 67202, within 120 days of the spud date of any well. Rule 82-3-130, 82-3-107 and 82-3-106 apply.
Information on side two of this form will be held confidential for a period of 12 months if requested in writing and submitted with this form. See rule 82-3-107 for confidentiality in excess of 12 months.
One copy of all wireline logs and drillers time log shall be attached with this form. Submit CP-4 form with all plugged wells. Submit CP-111 form with all temporarily abandoned wells.

All requirements of the statutes, rules and regulations promulgated to regulate the oil and gas industry have been fully complied with and the statements herein are complete and correct to the best of my knowledge.

Signature Jay C. Boyer
Title Operator Date 1-31-89

Subscribed and sworn to before me this 31st day of January 1989
Notary Public Arilla A. Mizell

Date Commission Expires

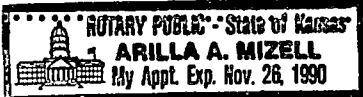

K.C.C. OFFICE USE ONLY
F Letter of Confidentiality Attached
C Wireline Log Received
C Drillers Timelog Received
Distribution
KCC SWD/Rep NGPA
KGS Plug Other (Specify)
1-3-89

Sec. 5 Twp 27 Rge 8 E

Operator Name ... Jay C. Boyer ... Lease Name ... Eberhart ... Well # ... 1

Sec ... 5 ... Twp ... 27 ... Rge ... 8 ... East West ... County ... Kingman

WELL LOG

INSTRUCTIONS: Show important tops and base of formations penetrated. Detail all cores. Report all drill stem tests giving interval tested, time tool open and closed, flowing and shut-in pressures, whether shut-in pressure reached static level, hydrostatic pressures, bottom hole temperature, fluid recovery, and flow rates if gas to surface during test. Attach extra sheet if more space is needed. Attach copy of log.

Drill Stem Tests Taken [] Yes [X] No
Samples Sent to Geological Survey [X] Yes [] No
Cores Taken [] Yes [X] No

Formation Description
[] Log [X] Sample

Table with 3 columns: Name, Top, Bottom. Rows include Heebner, Brown Lime, Lansing, Stark, Hushpuckney, TD.

CASING RECORD [X] New [] Used
Report all strings set-conductor, surface, intermediate, production, etc.

Table with 8 columns: Purpose of String, Size Hole Drilled, Size Casing Set (in O.D.), Weight Lbs/Ft., Setting Depth, Type of Cement, #Sacks Used, Type and Percent Additives.

PERFORATION RECORD and Acid, Fracture, Shot, Cement Squeeze Record. Columns include Shots Per Foot, Specify Footage of Each Interval Perforated, (Amount and Kind of Material Used), Depth.

TUBING RECORD. Columns include Size, Set At, Packer at, Liner Run [] Yes [] No.

Date of First Production | Producing Method [] Flowing [] Pumping [] Gas Lift [] Other (explain).....

Table for Estimated Production. Columns: Oil (Bbls), Gas (MCF), Water (Bbls), Gas-Oil Ratio (CFPB), Gravity.

METHOD OF COMPLETION | Production Interval

Disposition of gas: [] Vented [] Sold [] Used on Lease [] Open Hole [] Perforation [] Other (Specify) [] Dually Completed [] Commingled

