

Give All Information Completely
Make Required Affidavit
Mail or Deliver Report to:
Conservation Division
State Corporation Commission
211 No. Broadway
Wichita, Kansas

WELL PLUGGING RECORD

CLARK County. Sec. 35 Twp. 32S Rge. (E) 23 (W)

Location as "NE/CNW $\frac{1}{4}$ SW $\frac{1}{4}$ " or footage from lines 1260' SNL, 760' WEL SW/4

Lease Owner AMAREX, INC.

Lease Name ABELL Well No. 1-AA

Office Address SUITE 200, 200 N. HARVEY, OKLAHOMA CITY, OKLA. 73102

Character of Well (completed as Oil, Gas or Dry Hole) OIL

Date well completed 12 19 66

Application for plugging filed 6/23 19 72

Application for plugging approved 6/ 19 72

Plugging commenced 6/25 19 72

Plugging completed 6/25 19 72

Reason for abandonment of well or producing formation

LAND SHIFT, UNABLE TO PRODUCE WELL

If a producing well is abandoned, date of last production 6/19 19 72

Was permission obtained from the Conservation Division or its agents before plugging was commenced? YES

NORTH

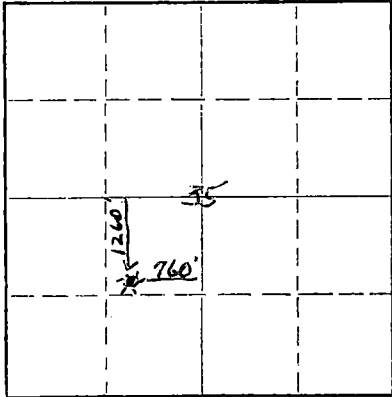

Locate well correctly on above Section Plat

Name of Conservation Agent who supervised plugging of this well ED EYES

Producing formation KS CITY/LANSING Depth to top 4457 Bottom 4461 Total Depth of Well 4524 Feet

Show depth and thickness of all water, oil and gas formations.

OIL, GAS OR WATER RECORDS

CASING RECORD

Table with 7 columns: FORMATION, CONTENT, FROM, TO, SIZE, PUT IN, PULLED OUT. The table is currently empty.

Describe in detail the manner in which the well was plugged, indicating where the mud fluid was placed and the method or methods used in introducing it into the hole. If cement or other plugs were used, state the character of same and depth placed, from _____ feet to _____ feet for each plug set.

25 SX COMMON CEMENT @ 4524'
40 SX COMMON CEMENT DOWN 4 1/2" CASING - 600' - 0'
120 SX COMMON CEMENT BETWEEN 4 1/2" AND 8 5/8" CASING - 600' - 0'

RECEIVED
STATE CORPORATION COMMISSION
JUL 6 1972
CONSERVATION DIVISION
Wichita, Kansas

(If additional description is necessary, use BACK of this sheet)
Name of Plugging Contractor SARGENT CASING PULLING SERVICE
Address LIBERAL, KANSAS 67901

STATE OF KANSAS, COUNTY OF SEWARD, ss.
I, B. A. CLIFFT (employee of ~~owner~~ ~~operator~~) of the above-described

well, being first duly sworn on oath, says: That I have knowledge of the facts, statements, and matters herein contained and the log of the above-described well as filed and that the same are true and correct. So help me God.

(Signature) B. A. Cliff
B. A. CLIFFT
Box 1257, LIBERAL, KANSAS 67901
(Address)

SUBSCRIBED AND SWORN to before me this 3RD day of JULY, 19 72

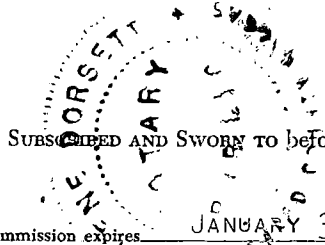

Joleene Dorsett
JOLEENE DORSETT Notary Public.

My commission expires JANUARY 31, 1975

GABBERT-JONES, INC.
 WICHITA, KANSAS
 DRILLERS' WELL LOG

RECEIVED
 STATE CORPORATION COMMISSION
 JUN 27 1972
 CONSERVATION DIVISION
 Wichita, Kansas

Well #1AA
 1260' SNL & 760' WEL SW/4
 Section 35-32S-23W
 Clark County, Kansas

Commenced: November 29, 1966
 Completed: December 9, 1966

OPERATOR - Amarillo Natural Gas Company

DEPTH		FORMATION	REMARKS
From	To		
0	55	Sand and clay	
55	122	Red bed	
122	148	Sand	
148	205	Red bed	
205	230	Lime	
230	304	Red bed and shale	Ran 12 joints of 13-3/8" casing set @ 304' w/300 sacks cement
304	608	Shale and red bed	Ran 19 joints of 8-5/8" casing set @ 608' w/325 sacks cement
608	1800	Shale	
1800	4404	Shale and lime	
4404	4525	Lime	
4525	TD		Ran 142 joints of 4-1/2" casing set @ 4524' w/150 sacks cement

I, E. E. HALL, certify this is a correct copy of the Drillers' Log for the well drilled in the 1260' SNL & 760' WEL SW/4, Section 35-32S-23W, Clark County, Kansas, to the best of my knowledge and belief.

E. E. Hall

E. E. HALL

STATE OF KANSAS)
)SS
 COUNTY OF SEDGWICK)

Before me, the undersigned, a Notary Public within and for said County and State, on this 13th day of December, 1966, personally appeared E. E. HALL, to me personally known to be the identical person who executed the within and foregoing instrument and acknowledged to me that he executed the same as his free and voluntary act and deed for the uses and purposes therein set forth.

IN WITNESS WHEREOF, I have hereunto set my hand and official seal the day and year last above written.

Barbara J. Layton
 Barbara J. Layton, Notary Public

My Commission Expires February 1, 1968.