

FOR KCC USE:

FORM C-1 7/91

EFFECTIVE DATE: 4-2-97

FORM MUST BE TYPED

DISTRICT # 2

State of Kansas

FORM MUST BE SIGNED

SGA? Yes... No

NOTICE OF INTENTION TO DRILL

ALL BLANKS MUST BE FILLED

Must be approved by the K.C.C. five (5) days prior to commencing well

Expected Spud Date 03 26 1997
month day year

Spot C N/2 SW Sec 20 Twp 27 S Rg 9 East West

OPERATOR: License # 5058
Name: Griggs Oil, Inc.
Address: 100 N. Main, Suite 1010
City/State/Zip: Wichita, KS 67202
Contact Person: Jim Collins
Phone: 316-267-7779

1980 feet from South / North line of Section
1320 feet from East / West line of Section
IS SECTION REGULAR IRREGULAR?

CONTRACTOR: License #: 5142
Name: Sterling Drilling

(NOTE: Locate well on the Section Plat on Reverse Side)
County: Kingman

Well Drilled For: Well Class: Type Equipment:
Oil Enh Rec Infield Mud Rotary
 Gas Storage Pool Ext. Air Rotary
OWWO Disposal Wildcat Cable
Seismic; # of Holes Other

Lease Name: Boswell Well #: 1-20
Field Name: Wildcat

If OWWO: old well information as follows:
Operator:
Well Name:
Comp. Date: Old Total Depth

Is this a Prorated/Spaced Field? yes no
Nearest Formation(s): Indian Cave

Directional, Deviated or Horizontal wellbore? yes no

Ground Surface Elevation: 1739 est. feet MSL

If yes, true vertical depth:

Water well within one-quarter mile: yes no
Public water supply well within one mile: yes no

Bottom Hole Location:

Depth to bottom of fresh water: 160
Depth to bottom of usable water: 180

AFFIDAVIT

The undersigned hereby affirms that the drilling, completion and eventual plugging of this well will comply with K.S.A. 55-101, et. seq.

It is agreed that the following minimum requirements will be met:

- 1. Notify the appropriate district office prior to spudding of well;
- 2. A copy of the approved notice of intent to drill shall be posted on each drilling rig;
- 3. The minimum amount of surface pipe as specified below shall be set by circulating cement to the top; in all cases surface pipe shall be set through all unconsolidated materials plus a minimum of 20 feet into the underlying formation;
- 4. If the well is dry hole, an agreement between the operator and the district office on plug length and placement is necessary prior to plugging;
- 5. The appropriate district office will be notified before well is either plugged or production casing is cemented in;
- 6. IF AN ALTERNATE II COMPLETION, PRODUCTION PIPE SHALL BE CEMENTED FROM BELOW ANY USABLE WATER TO SURFACE WITHIN 120 DAYS OF SPUD DATE. IN ALL CASES, NOTIFY DISTRICT OFFICE PRIOR TO ANY CEMENTING.

I hereby certify that the statements made herein are true and to the best of my knowledge and belief.

Date: 3-5-97 Signature of Operator or Agent: Jim Collins Title: Vice President

FOR KCC USE:
API # 15- 095-217210000
Conductor pipe required NONE feet
Minimum surface pipe required 200 feet per Alt. (1)
Approved by: JK 3-28-97
This authorization expires: 9-28-97
(This authorization void if drilling not started within 6 months of effective date.)
Spud date: Agent:

3-6-97
RECEIVED
KANSAS CORP COMM
1997 MAR - 6 P 1:15 PM

REMEMBER TO:

- File Drill Pit Application (form CDP-1) with Intent to Drill;
- File Completion Form ACO-1 within 120 days of spud date;
- File acreage attribution plat according to field proration orders;
- Notify appropriate district office 48 hours prior to workover or re-entry;
- Submit plugging report (CP-4) after plugging is completed;
- Obtain written approval before disposing or injecting salt water.

Mail to: Conservation Division, 200 Colorado Derby Building, 202 W. First St., Wichita, Kansas 67202-1286.

IN ALL CASES PLOT THE INTENDED WELL ON THE PLAT BELOW

PLAT OF ACREAGE ATTRIBUTABLE TO A WELL IN A PRORATED OR SPACED FIELD

If the intended well is in a prorated or spaced field, please fully complete this side of the form. If the intended well is in a prorated or spaced field complete the plat below showing that the well will be properly located in relationship to other wells producing from the common source of supply. Please show all the wells within 1 mile of the boundaries of the proposed acreage attribution unit for gas wells and within 1/2 mile of the boundaries of the proposed acreage attribution unit for oil wells.

API NO. 15- _____
 OPERATOR Griggs Oil, Inc.
 LEASE Boswell
 WELL NUMBER 1-20
 FIELD Wildcat

LOCATION OF WELL: COUNTY Kingman
1980 feet from south/north line of section
1320 feet from east/west line of section
 SECTION 20 TWP 27S RG 9W

NUMBER OF ACRES ATTRIBUTABLE TO WELL 40
 QTR/QTR/QTR OF ACREAGE C - N/2 - _____

IS SECTION X REGULAR or _____ IRREGULAR
IF SECTION IS IRREGULAR, LOCATE WELL FROM NEAREST CORNER BOUNDARY.

Section corner used: _____ NE _____ NW _____ SE X SW
PLAT

(Show location of the well and shade attributable acreage for prorated or spaced wells.)
 (Show footage to the nearest lease or unit boundary line.)

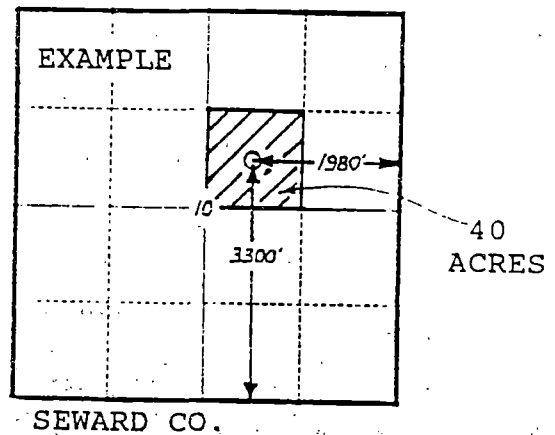
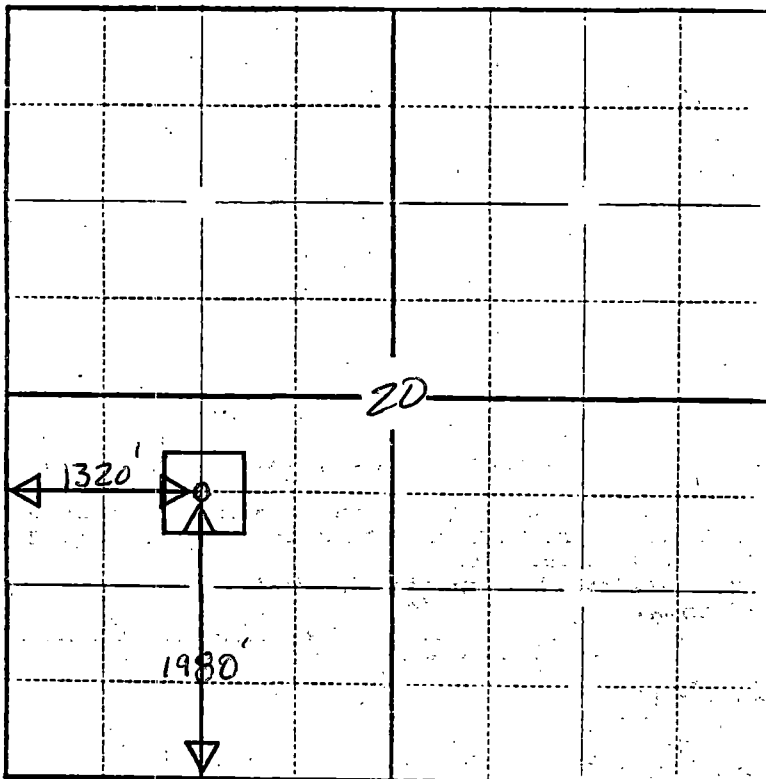

In plotting the proposed location of the well, you must show:

- 1) The manner in which you are using the depicted plat by identifying section lines, i.e. 1 section, 1 section with 8 surrounding sections, 4 sections, etc.;
- 2) the distance of the proposed drilling location from the section's south/north and east/west lines; and
- 3) the distance to the nearest lease or unit boundary line.