

STATE OF KANSAS
STATE CORPORATION COMMISSION

WELL PLUGGING RECORD

FORMATION PLUGGING RECORD

Give All Information Completely
Make Required Affidavit
Mail or Deliver Report to:
Conservation Division
State Corporation Commission
800 Pitting Building
Wichita, Kansas

Strike out upper line
when reporting plugging
of formations.

Stafford County, Sec. 1 Twp 24 Rge. 11 (W)

Location as "NE 1/4 NW 1/4 SW 1/4" or footage from lines. SE Corner
Lease Owner Thos. H. Allan et al
Lease Name Volker Well No. 1
Office Address 921 Union National Bank Bldg., Wichita 2, Kansas
Character of Well (completed as Oil, Gas or Dry Hole) Oil
Date well completed January 27 19 42
Application for plugging filed November 9 19 46
Application for plugging approved November 13 19 46
Plugging commenced November 25 19 46
Plugging completed November 25 19 46
Reason for abandonment of well or producing formation Oil Exhausted
If a producing well is abandoned, date of last production August 18 19 46
Was permission obtained from the Conservation Division or its agents before plugging was commenced? Yes

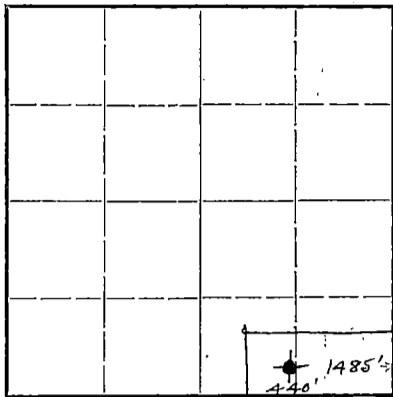

Locate well correctly on above
Section Plat

Name of Conservation Agent who supervised plugging of this well H. W. Kerr
Producing formation Depth to top Bottom Total Depth of Well 3742 Feet
Show depth and thickness of all water, oil and gas formations.

OIL, GAS OR WATER RECORDS

CASING RECORD

Formation	Content	From	To	Size	Put In	Pulled Out
				5 1/2	3722'	2969'

Describe in detail the manner in which the well was plugged, indicating where the mud fluid was placed and the method or methods used in introducing it into the hold. If cement or other plugs were used, state the character of same and depth placed, from feet to feet for each plug set.

3744 to 3710 6 sacks cement
3710 to 250 Mud
250 to 15 35 sacks cement and mud on top
15 to Surface 10 sacks cement

DEC 26 1946

pd
12/26/46
Ha

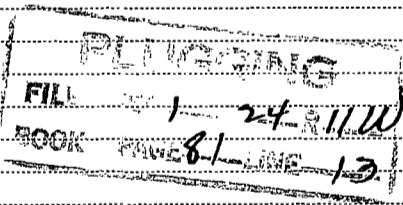

(If additional description is necessary, use BACK of this sheet)

Correspondence regarding this well should be addressed to Thos. H. Allan
Address 921 Union National Bank Building, Wichita 2, Kansas

STATE OF KANSAS, COUNTY OF SEDGWICK, ss.

Thos. H. Allan (employee of owner) or (owner or operator) of the above-described well,
being first duly sworn on oath, says: That I have knowledge of the facts, statements, and matters herein contained and the log of the above-described well as filed and that the same are true and correct. So help me God.

(Signature) Thos. H. Allan

921 Union Nat'l Bk. Bldg., Wichita 2, Kansas
(Address)

SUBSCRIBED AND SWORN to before me this 17th day of December, 19 46

Orie M. Stewart
Notary Public.

My commission expires June 14, 1950

ALLAN ET AL.
Volker No. 1

SEC. 1 T. 24 R. 11 W
SE SW SE
440' N. 1485' W. SE cor.

Total Depth. 3742
Comm. 12-26-41 Comp. 1-27-42
Shot or Treated.
Contractor. Thos. H. Allan.
Issued. 3-14-42

County Stafford.

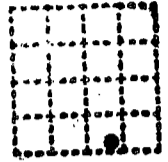

CASING.

85/8" 258' cemented.
5 1/2" 3722' cemented.

Elevation.

Pumped Temp.

Production, Pot. 717 B.

Figures Indicate Bottom of Formations.

300 BW

brick red grit	492	Misener sand - oil saturated	3706
anhydrite	504	chert white saturated	3709
red shale	820	green shale	3715
shale blue, anhydrite, dolomite etc.	1726	Viola coarse crystalline limestone	3722
Ft. Riley limestone	1810	Total Depth of Rotary.	
Florence Flint - chert and fusulinids	1844	crystalline limestone	3722- 3726
shale and limestone	2110	chert	3730
red shale	2120	cherty dolomite, oil stained	3733
porous oolitic Neva lime	2160	chert white	3737
shale with occasional limestone	2808	cherty dolomite soft oil saturated Pay	3742
sand	2833	Total Depth.	
shale	2850	Swabbed 15 bbls/hr - 1/3 water	
Topoka limestone	2900	Treated with 2000 gal acid.	
limestone and shale	3200	Pumped Temporary Potential of	
sandstone	3226	717 oil - 300 water	
shale	3314		
lime brown	3322		
shale	3336		
Lansing limestone	3364		
shale	3370		
limestone	3402		
shale	3408		
limestone	3432		
cherty limestone	3442		
shale	3470		
limestone and shale	3520		
limestone	3562		
shale	3574		
lime	3580		
shale	3594		
lime	3634		
shale red	3646		
lime	3656		
shale	3673		
conglomerate	3681		
Kinderhook green shale	3690		

FILE
BOOK
1 24-1100
81-11-13

