

STATE OF KANSAS
STATE CORPORATION COMMISSION

WELL PLUGGING RECORD

FORMATION PLUGGING RECORD

Give All Information Completely
Must be Reported to:
Conservation Division
State Corporation Commission
800 Bittling Building
Wichita, Kansas

OR

Strike out upper line
when reporting plugging
of formations.

Stafford County, Sec. 2 Twp. 24S Rge. 11 (E) 11 (W)

Location as "NE1/4NW1/4SW1/4" or footage from lines C N 1/2 SW 1/4 SE 1/4
Lease Owner Skelly Oil Company
Lease Name L. McNickle Well No. 2
Office Address Box 391, Hutchinson, Kansas
Character of Well (completed as Oil, Gas or Dry Hole) Oil well
Date well completed August 14 19 40
Application for plugging filed May 24 19 45
Application for plugging approved June 4 19 45
Plugging commenced July 13 19 45
Plugging completed July 21 19 45
Reason for abandonment of well or producing formation Depleted oil well
If a producing well is abandoned, date of last production April 29 19 45
Was permission obtained from the Conservation Division or its agents before plugging was commenced? Yes

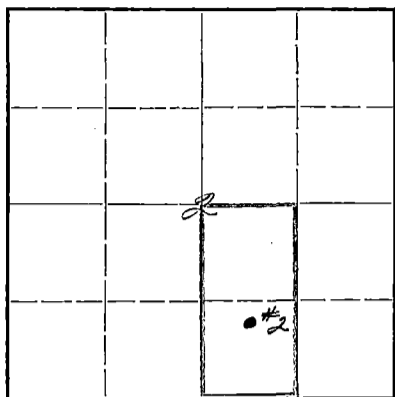

Locate well correctly on above
Section Plat

Name of Conservation Agent who supervised plugging of this well H. W. Kerr
Producing formation Viola Lime Depth to top 3689' Bottom 3758' Total Depth of Well 3760' Feet
Show depth and thickness of all water, oil and gas formations.

OIL, GAS OR WATER RECORDS

CASING RECORD

Formation	Content	From	To	Size	Put In	Pulled Out
Viola Lime	Oil	3689'	3713'	8-5/8"	252'	None
				5-1/2"	3718'3"	3078'

Describe in detail the manner in which the well was plugged, indicating where the mud fluid was placed and the method or methods used in introducing it into the hold. If cement or other plugs were used, state the character of same and depth placed, from.....feet to.....feet for each plug set.

10 sacks cement 3760' to 3700'
Mud laden fluid 3700' to 3680'
Wood plug & 10 sacks cement 3680' to 3630'
Mud laden fluid 3630' to 250'
Wood plug & 20 sacks cement 250' to 180'
Mud laden fluid 180' to 26'
Wood plug & 10 sacks cement 26' to 8'
Surface soil and rock 8' to 0'

PLUGGING
FILE NO. 2-24-1112
BOOK PAGE 14 LINES 1

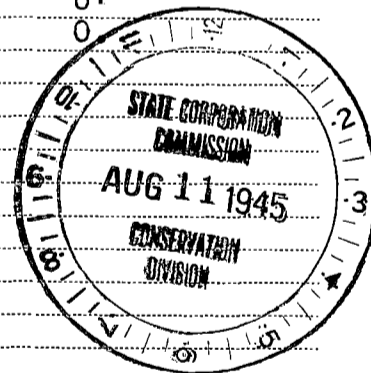

(If additional description is necessary, use BACK of this sheet)

Correspondence regarding this well should be addressed to Skelly Oil Company
Address Box 391, Hutchinson, Kansas

STATE OF KANSAS, COUNTY OF RENO, ss.
H. E. Wansley (employee of owner) of the above-described well,
being first duly sworn on oath, says: That I have knowledge of the facts, statements, and matters herein contained and the log of the above-described well as filed and that the same are true and correct. So help me God.

(Signature) [Signature]
Box 391, Hutchinson, Kansas (Address)

SUBSCRIBED AND SWORN to before me this 10th day of August, 19 45

My commission expires April 7, 1947.

[Signature] Notary Public.

SKELLY OIL COMPANY

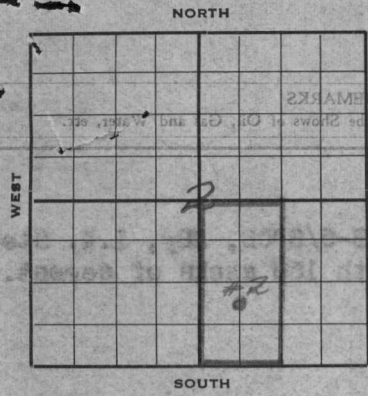

Well Record

Lease Name and No. L. McNickle #19530 Well No. 2 Elev. 1804' DF

Lease Description W/2 SE/4, Section 2-248-117
Stafford County, Kansas

Location made July 18, 1940 by Floyd Kent

_____ feet from North line _____ feet from East line W/2 SE/4
990 feet from South line 660 feet from West line _____ of _____

Rig com'd July 19, 1940 Rig comp'd July 21, 1940 Drlg. com'd July 23, 1940 Drlg. comp'd Aug. 12, 1940

Rig Contractor Rig erected by drilling contractor

Drilling Contractor Bodine Drilling Company

Rotary Drilling from Top to 3694' Cable Tool Drilling from 3694' to 3760'

Commenced Producing August 14, 1940 Initial Prod. before shot or acid Flowed 2 1/2" tbg. 3 bbls. oil/hr Bbls.
Initial Prod. after shot or acid 4944 (Indicated productivity) Bbls.
by BH pressure method) Established 24 hr. S.G.C. pot.
of 3000 barrels oil. Cu. ft.

Dry Gas Well Press _____ Volume Gauged 1,940 M cu.ft. Cu. ft.

Casing Head Gas Pressure _____ Volume _____ Cu. ft.

Braden Head (8-5/8" x 5-1/2" OD) Gas Pressure _____ Volume _____ Cu. ft.

Braden Head (_____) Gas Pressure _____ Volume _____ Cu. ft.

PRODUCING FORMATION Viola Line (Name) Top 3689' Bottom 3758' TOTAL DEPTH 3760'

CASING RECORD

Size	Wt.	Thds.	Where Set	PULLED OUT			LEFT IN			KIND	Cond'n	CEMENTING	
				Jts.	Feet	In.	Jts.	Feet	In.			Sacks Used	Method Employed
8-5/8" OD	28/	8	257				9	252	0	Lapweld	"C"	150	Halliburton
5-1/2" OD	17/	8RT	3690				113	3718	3	Seamless	"A"	100	Halliburton
(8-5/8" casing set 7' in cellar and 5 1/2" casing set to derrick floor)													
(Used one 5 1/2" Baker Combination Guide & Float Shoe)													

Liner Set at _____ Length _____ Perforated at _____

Liner Set at _____ Length _____ Perforated at _____

Packet Set at _____ Size and Kind _____

Packet Set at _____ Size and Kind _____



SHOT OR ACID TREATMENT RECORD

	FIRST	SECOND	THIRD	FOURTH
Date	<u>August 14, 1940</u>			
Acid Used	<u>8000</u>	Gals.	Gals.	Gals.
Size Shot	<u>2 1/2"</u>	Gals. Qts.	Gals. Qts.	Gals. Qts.
Shot Between	<u>3690</u> Ft. and <u>3760</u> Ft.	Ft. and	Ft. and	Ft. and
Size of Shell				
Put in by (Co.)	<u>Morgan Co.</u>			
Length anchor				
Distance below Cas'g				
Damage to Casing or Casing Shoulder	<u>None</u>			

SIGNIFICANT GEOLOGICAL FORMATIONS

NAME	Top	Bottom	GAS		OIL		REMARKS
			From	To	From	To	
<u>Lensing Line</u>	<u>3328</u>						
<u>Viola Line</u>	<u>3685</u>				<u>3689</u>	<u>3713</u>	<u>Pay formation</u>
					<u>3740</u>	<u>3758</u>	<u>Pay formation</u>

CLEANING OUT RECORDS

	DATE COMMENCED	DATE COMPLETED	PROD. BEFORE	PROD. AFTER	REMARKS
1st					See Reverse for other details.
2nd					" " " " "
3rd					" " " " "
4th					" " " " "

PLUGGING BACK AND DEEPENING RECORDS

	Date Commenced	Date Completed	No. Feet Plugged Back or Deepened	Prod. Before	Prod. After	REMARKS
1st						See Reverse for other details.
2nd						" " " " "
3rd						" " " " "
4th						" " " " "

(See Reverse for Record of Formation)

RECORD OF FORMATIONS

FORMATION	Well Record	TOP	BOTTOM	REMARKS
Surface soil	Well No. 10	0	10	Indicate Casing Points, Describe Shows of Oil, Gas and Water, etc.
Sand and clay		10	140	
Red bed		140	265	
Red bed		265	600	
Shale		600	760	
Anhydrite		760	815	
Red bed		815	870	
Shale and shells		870	980	
Salt		980	1155	
Shale		1155	1210	
Grey shale and shells		1210	1425	
Lime and shale		1425	1685	
Lime		1685	1760	
Lime and shale		1760	1805	
Sandy lime		1805	1850	
Shale		1850	1865	
Shale and shells		1865	2035	
Red and grey shale		2035	2180	
Lime and shale		2180	2260	
Shale and shells		2260	2320	
Shale		2320	2375	
Lime		2375	2430	
Lime and shale		2430	2775	
Lime		2775	2845	

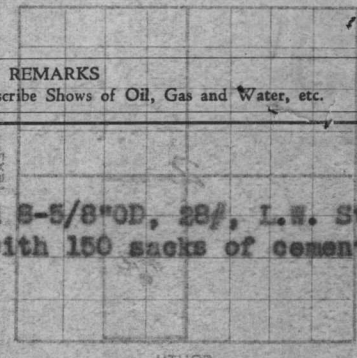

FORMATION	Well Record	TOP	BOTTOM	REMARKS
Lime and shale		2845	2950	Producing Formation (Name)
Lime		2950	3145	
Broken lime and shale		3145	3290	
Grey and red shale		3290	3328	
Lime and shale		3328	3455	
Lime		3455	3525	
Lime and shale		3525	3620	
Lime		3620	3650	
Shale		3650	3685	
Soft sandy, finely crystalline dolomite		3685	3689	

Drilled 7-7/8" hole to 3694'

Set and cemented 5-1/2" OD, 17#, SS casing at 3690' with 100 sacks of cement. Finished cementing at 6:30 AM, 8/5/40 and while shut down waiting on cement to set, standardized rig and rigged up cable tools. Finished rigging up, bailed the hole down and drilled cement to 3670'. On August 9th, fresh water, drilled cement plug to bottom and cement job tested OK.

FORMATION	Well Record	TOP	BOTTOM	REMARKS
Medium soft, crystalline cherty dolomite		3694	3699	Some porosity and saturation - oil and gas showing up thru hole loaded with water.
Same		3699	3713	
Medium soft, cherty crystalline dolomite		3713	3717	
Same		3717	3726	
Medium hard grey chert with little dolomite		3726	3729	
Medium soft brown dolomite with little chert		3729	3732	
Same		3732	3735	
Medium soft cherty dolomite		3735	3740	
White chert and crystalline dolomite		3740	3745	
Same		3745	3755	
Same		3755	3760	Bottom 2' hard

TOTAL DEPTH - 3760'

Stopped drilling on August 12, 1940. Tore down tools and started to run 2 1/2" tubing, had 23 joints in hole and elevators failed to hold and dropped 23 joints. On August 13th fished out tubing and ran and set 2 1/2" tubing at 3758'.

DATE COMMENCED	DATE COMPLETED	PROD. BEFORE	PROD. AFTER	REMARKS
				See Reverse for other details
				" " " " " "
				" " " " " "
				" " " " " "

DATE COMMENCED	DATE COMPLETED	PROD. BEFORE	PROD. AFTER	REMARKS
				See Reverse for other details
				" " " " " "
				" " " " " "
				" " " " " "

ACID TREATMENT NO. 1 - Between 3690' and 3760'

Treatment put in by Morgan Acid Company, 8/14/40, using 8000 gallons of Morgan acid and 150 barrels of oil to fill hole and flush tubing.

TIME	CP	TP	REMARKS:
9:10 AM			Filled hole with 115 barrels of oil then started acid in.
9:25 "	425#	30#	1200 gallons of acid in hole
9:35 "	425#	30#	2600 gallons of acid in hole
9:45 "	425#	30#	4200 gallons of acid in hole
9:53 "	300#	30#	5400 gallons of acid in hole
10:01 "	200#	25#	6500 gallons of acid in hole
10:07 "	100#	25#	7200 gallons of acid in hole
10:13 "	100#	25#	8000 gallons of acid in hole then started oil in to flush
11:00 "	25#	10#	Flushed hole with 35 barrels of oil to complete treatment.

After acid treatment, left well shut in for 2 hours then ran tubing swab 4 times and well started flowing, flowed thru 2 3/4" tubing 1 hour and 5 minutes. 142 1/2 barrels of cut oil and acid water, then shut in to take potential test.

The well was left shut in until August 17th waiting for S.C.C. umpire.

On August 17th, took potential test by bottom hole pressure method, flowed thru 2 3/4" tubing 8 hours, 263.20 barrels of oil and no water. CP-880# TP-570#, which indicated 24 hour State Corporation Commission potential of 3000 barrels, effective 8/16/40 due to delay in umpire starting potential. This potential allowed 48 barrels per day for the remainder of August, 1940. Gas gauged 1,940 M cu.ft. thru 32/64" choke.

SLOPE TEST DATA

Depth	Angle (Degs.)	Horiz.	Vert.
250'	0		
500'	1/2	2.2	.0
750'	1/2	2.2	.0
1000'	1/2	2.2	.0
1250'	1/2	2.2	.0
1500'	1/2	2.2	.0
1750'	1/2	2.2	.0
2000'	1/2	2.2	.0
2500'	1/2	2.2	.0
2750'	1/2	2.2	.0
3000'	1/2	2.2	.0
3250'	3/4	3.3	.0
3550'	1/2	2.2	.0
Total Deflections		27.5	.0

CASING TALLY

	5-1/2"OD	5-1/2"OD	5-1/2"OD
	34.45	32.81	32.68
	32.24	32.81	32.59
	33.42	33.16	32.73
	32.81	32.64	32.72
	33.35	31.40	32.78
	32.79	32.88	31.75
	32.77	29.28	32.95
	32.88	32.56	32.77
	31.70	33.43	33.13
	32.20	31.11	33.12
	32.92	32.96	32.77
	32.79	32.20	32.34
	33.20	33.00	32.94
	33.02	32.59	32.22
	33.03	33.12	32.83
	32.72	33.33	33.12
	33.08	33.02	33.05
	31.95	32.45	31.01
	32.86	33.00	35.70
	33.18	32.85	33.22
8-5/8"OD	33.08	33.44	33.43
	32.92	33.18	31.92
27 10	33.16	32.89	32.62
28 9	32.95	32.92	32.07
27 6	30.54	32.64	33.04
28 6	33.02	32.78	32.58
26 2	32.83	32.88	33.20
28 0	32.95	33.01	31.23
28 8	32.72	32.80	31.77
24 11	32.86	33.15	33.33
30 8	32.71	32.65	33.36
	32.71	32.86	32.30
	32.52	32.84	32.82
	32.77	33.30	10.75
	32.88	32.85	
	32.71	32.75	
	32.93	33.26	
	33.26	33.09	
	33.08	33.05	
	32.77	32.78	

252' 0"

3718' 3"

Set 7' in cellar

Handwritten notes: 14 1, 5 54 117

Vertical stamp: 15-185-10138-0000