

SIDE ONE

STATE CORPORATION COMMISSION OF KANSAS  
OIL & GAS CONSERVATION DIVISION  
WELL COMPLETION OR RECOMPLETION FORM  
ACO-1 WELL HISTORY  
DESCRIPTION OF WELL AND LEASE

API NO. 15-095-21607-0000  
County Kingman  
C SE Sec. 7 Twp. 28S Rge. 10 East  
X West

Operator: License # 3711  
Name Shepler & Thomas, Inc.  
Address P.O. Box 1162  
City/State/Zip Liberal, KS 67905-1162

1320 Ft North from Southeast Corner of Section  
1320 Ft West from Southeast Corner of Section  
(Note: Locate well in section plat below)

Purchaser N/A

Lease Name Hageman Well # 1-7

Operator Contact Person R. F. Burke  
Phone (316) 624-0750

Field Name N/A

Producing Formation N/A

Elevation: Grounds 1760 KB 1766

Contractor: License # 5840  
Name Brandt Drilling Company

Well Site Geologist Lynn Tucker  
Phone

Designate Type of Completion  
 New Well  Re-Entry  Workover  
 Oil  SWD  Temp Abd  
 Gas  Inj  Delayed Comp.  
 Dry  Other (Core, Water Supply, etc.)

If O.W.O. of old well info as follows:  
Operator  
Well Name  
Comp. Date Old Total Depth

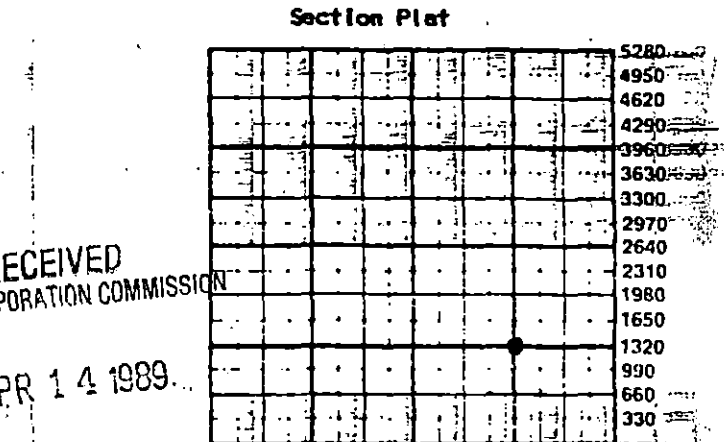

RECEIVED  
STATE CORPORATION COMMISSION  
APR 14 1989  
CONSERVATION DIVISION  
Wichita, Kansas

WELL HISTORY  
Drilling Method:  Mud Rotary  Air Rotary  Cable  
3-21-89 3-24-89 N/A 3-25-89  
Spud Date Date Reached TD Completion Date  
2700 0  
Total Depth PBTD  
Amount of Surface Pipe Set and Cemented at 225 feet  
Multiple Stage Cementing Collar Used? Yes  No  
If yes, show depth set feet  
If alternate 2 completion, cement circulated from feet depth to w/ SX cmt  
Cement Company Name  
Invoice #

WATER SUPPLY INFORMATION  
Disposition of Produced Water: Disposal  
Docket # Repressuring

Questions on this portion of the ACO-1 call:  
Water Resources Board (913) 296-3717  
Source of Water:  
Division of Water Resources Permit # T89-164  
 Groundwater 1320 Ft North from Southeast Corner  
(Well) 1320 Ft West from Southeast Corner of  
7 Sec 28S Twp 10 Rge East  West  
Surface Water Ft North from Southeast Corner  
(Stream, pond etc) Ft West from Southeast Corner  
Sec Twp Rge East West  
Other (explain)  
(purchased from city, R.W.D. #)

INSTRUCTIONS: This form shall be completed in triplicate and filed with the Kansas Corporation Commission, 200 Colorado Derby Building, Wichita, Kansas 67202, within 120 days of the spud date of any well. Rule 82-3-130, 82-3-107 and 82-3-106 apply.  
Information on side two of this form will be held confidential for a period of 12 months if requested in writing and submitted with the form. See rule 82-3-107 for confidentiality in excess of 12 months.  
One copy of all wireline logs and drillers time log shall be attached with this form. Submit CP-4 form with all plugged wells. Submit CP-111 form with all temporarily abandoned wells.

All requirements of the statutes, rules and regulations promulgated to regulate the oil and gas industry have been fully complied with and the statements herein are complete and correct to the best of my knowledge.

Signature R. F. BURKE  
Title Agent Date 4/12/89

Subscribed and sworn to before me this 12th day of April 1989  
Notary Public JODY PHELPS  
Date Commission Expires January 28, 1995

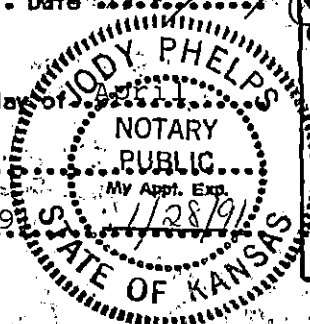

K.C.C. OFFICE USE ONLY  
 Letter of Confidentiality Attached  
 Wireline Log Received  
 Drillers Time Log Received  
Distribution  
 KCC  SWD/Rep  NGPA  
 KGS  Plug  Other  
(Specify)  
4-14-89  
Form ACO-1 (5-86)

Sec. 7, Twp. 28S, Rge. 10E

Operator Name ..... Shepler & Thomas, Inc. Lease Name ..... Hageman ..... Well # ..... 1-7  
 Sec. .... 7 ... Twp. .... 28S ... Rge. .... 10 ...  East  West County ..... Kingman

RELEASED

MAY 0 8 1990

WELL LOG

FROM CONFIDENTIAL

INSTRUCTIONS: Show important tops and base of formations penetrated. Detail all cores. Report all drill stem tests giving interval tested, time tool open and closed, flowing and shut-in pressures, whether shut-in pressure reached static level, hydrostatic pressures, bottom hole temperature, fluid recovery, and flow rates if gas to surface during test. Attach extra sheet if more space is needed. Attach copy of log.

Drill Stem Tests Taken  Yes  No  
 Samples Sent to Geological Survey  Yes  No  
 Cores Taken  Yes  No

Formation Description  
 Log  Sample

Name	Top	Bottom
Indian Cave	2496	

CASING RECORD <input type="checkbox"/> New <input type="checkbox"/> Used							
Report all strings set-conductor, surface, intermediate, production, etc.							
Purpose of String	Size Hole Drilled	Size Casing Set (In. O.D.)	Weight Lbs/Ft.	Setting Depth	Type of Cement	#Sacks Used	Type and Percent Additives
Surface	12 1/4	8 5/8	24#	225	60/40 poz	135	2% gel, 3% CC
PERFORATION RECORD <input checked="" type="checkbox"/> N/A				Acid, Fracture, Shot, Cement Squeeze Record			
Shots Per Foot	Specify Footage of Each Interval Perforated			(Amount and Kind of Material Used)		Depth	
TUBING RECORD				Size	Set At	Packer at	Liner Run <input type="checkbox"/> Yes <input type="checkbox"/> No
Date of First Production				Producing Method			
N/A				<input type="checkbox"/> Flowing <input type="checkbox"/> Pumping <input type="checkbox"/> Gas Lift <input type="checkbox"/> Other (explain).....			
Estimated Production Per 24 Hours	Oil	Gas	Water	Gas-Oil Ratio	Gravity		
	N/A						
	Bbls	MCF	Bbls	CFPB			

METHOD OF COMPLETION

Production Interval

Disposition of gas:  Vented  Open Hole  Perforation  
 Sold  Other (Specify) ..... N/A  
 Used on Lease  Dually Completed  Commingled