

STATE CORPORATION COMMISSION OF KANSAS
OIL & GAS CONSERVATION DIVISION
WELL COMPLETION OR RECOMPLETION FORM
ACO-1 WELL HISTORY
DESCRIPTION OF WELL AND LEASE

API NO. 15-095-21,600-0000
County Kingman
East
Apprx ... G. SW. Sec. 4. Twp. 28S. Rge. 10. X West

Operator: License # 3711
Name Shepler & Thomas, Inc.
Address P.O. Box 1162
City/State/Zip Liberal, KS 67905-1162

1440
4084 Ft North from Southeast Corner of Section
Ft West from Southeast Corner of Section
(Note: Locate well in section plat below)

Purchaser N/A

Lease Name Renner Well # 1-4

Operator Contact Person R. F. Burke
Phone (316) 624-0750

Field Name N/A

Producing Formation N/A

Contractor: License # 5940
Name Brandt Drilling

Elevation: Ground 1720 KB 1724

Wellsite Geologist Lynn Tucker
Phone

Designate Type of Completion
X New Well Re-Entry Workover
Off SWD Temp Abd
Gas Inj Delayed Comp.
X Dry Other (Core, Water Supply etc.)

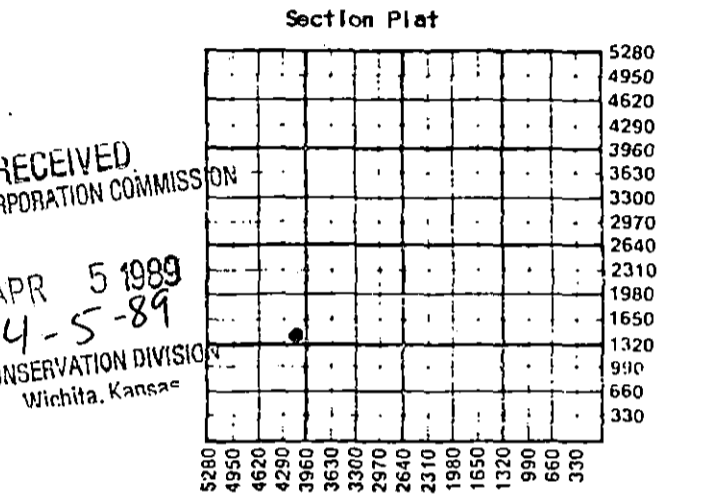

If OWO: old well info as follows:
Operator
Well Name
Comp. Date Old Total Depth

WATER SUPPLY INFORMATION
Disposition of Produced Water: Disposal
Docket # Repressuring

WELL HISTORY
Drilling Method: X Mud Rotary Air Rotary Cable
3-10-89 3-13-89 N/A 3-13-89
Spud Date Date Reached TD Completion Date
2600 2600
Total Depth PBDT
Amount of Surface Pipe Set and Cemented at 225 feet
Multiple Stage Cementing Collar Used? Yes X No
If yes, show depth set feet
If alternate 2 completion, cement circulated from feet depth to W/ SX cmt
Cement Company Name
Invoice #

Questions on this portion of the ACO-1 call:
Water Resources Board (913) 296-3717
Source of Water:
Division of Water Resources Permit # T89-145
X Groundwater 1440 Ft North from Southeast Corner
(Well) 4084 Ft West from Southeast Corner of
4 Sec 28S Twp 10 Rge East X West
Surface Water Ft North from Southeast Corner
(Stream, pond etc) Ft West from Southeast Corner
Sec Twp Rge East West
Other (explain)
(purchased from city, R.W.D. #)

INSTRUCTIONS: This form shall be completed in triplicate and filed with the Kansas Corporation Commission, 200 Colorado Derby Building, Wichita, Kansas 67202, within 120 days of the spud date of any well. Rule 82-3-130, 82-3-107 and 82-3-106 apply.
Information on side two of this form will be held confidential for a period of 12 months if requested in writing and submitted with the form. See rule 82-3-107 for confidentiality in excess of 12 months.
One copy of all wireline logs and drillers time log shall be attached with this form. Submit CP-4 form with all plugged wells. Submit CP-111 form with all temporarily abandoned wells.

All requirements of the statutes, rules and regulations promulgated to regulate the oil and gas industry have been fully complied with and the statements herein are complete and correct to the best of my knowledge.

Signature R. F. BURKE
Title Agent Date 4/4/89

Subscribed and sworn to before me this 4th day of April 1989
Notary Public JODY PHELPS
Date Commission Expires January 28, 1991

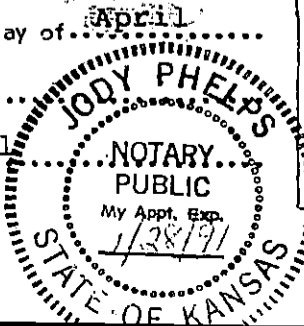

K.C.C. OFFICE USE ONLY
F Letter of Confidentiality Attached
C Wireline Log Received
C Drillers Timelog Received
Distribution
KCC SWD/Rep NGPA
KGS Plug Other (Specify)
4-5-89
Form ACO-1 (5-86)

Sec. 4, Twp. 28Rge. 10W

Operator Name Shepler & Thomas, Inc. Lease Name Renner Well # 144

Sec. 4 Twp. 28S Rge. 10 East West

County Kingman **RELEASED**

MAY 08 1990

WELL LOG

INSTRUCTIONS: Show important tops and base of formations penetrated. Detail all cores. Report all drill stem tests giving interval tested, time tool open and closed, flowing and shut-in pressures, whether shut-in pressure reached static level, hydrostatic pressures, bottom hole temperature, fluid recovery, and flow rates if gas to surface during test. Attach extra sheet if more space is needed. Attach copy of log.

FROM CONFIDENTIAL

Drill Stem Tests Taken Yes No
 Samples Sent to Geological Survey Yes No
 Cores Taken Yes No

Formation Description
 Log Sample

Name	Top	Bottom
Indian Cave	2536	2548

CASING RECORD <input type="checkbox"/> New <input type="checkbox"/> Used							
Report all strings set-conductor, surface, intermediate, production, etc.							
Purpose of String	Size Hole Drilled	Size Casing Set (In O.D.)	Weight Lbs/Ft.	Setting Depth	Type of Cement	#Sacks Used	Type and Percent Additives
Surface	12 1/4	8 5/8	24#	225	60/40 pox	135	3% CC
PERFORATION RECORD <input type="checkbox"/> N/A				Acid, Fracture, Shot, Cement Squeeze Record			
Shots Per Foot	Specify Footage of Each Interval Perforated			(Amount and Kind of Material Used)		Depth	
TUBING RECORD				Liner Run <input type="checkbox"/> Yes <input type="checkbox"/> No			
Size	Set At	Packer at					
N/A							
Date of First Production	Producing Method						
N/A	<input type="checkbox"/> Flowing <input type="checkbox"/> Pumping <input type="checkbox"/> Gas Lift <input type="checkbox"/> Other (explain).....						
Estimated Production Per 24 Hours	Oil	Gas	Water	Gas-Oil Ratio	Gravity		
	Bbls	MCF	Bbls	CFPB			

METHOD OF COMPLETION

Production Interval

Disposition of gas: Vented Open Hole Perforation
 Sold Other (Specify) Dually Completed
 Used on Lease Commingled

N/A