

STATE OF KANSAS
STATE CORPORATION COMMISSION

FILE COPY

WELL PLUGGING RECORD

Give All Information Completely
Make Required Affidavit
Mail or Deliver Report to
Conservation Division
State Corporation Comm.
245 North Water
Wichita, KS 67202

Edwards County. Sec. 29 Twp. 24S Rge. 17W E/W
Location as "NE/CNW $\frac{1}{4}$ SW $\frac{1}{4}$ " or footage from lines
990' FSL, 660' FEL NE/4
Lease Owner F.G. Holl
Lease Name Cross"B" Well No. 2-29
Office Address 6427 E. Kellogg

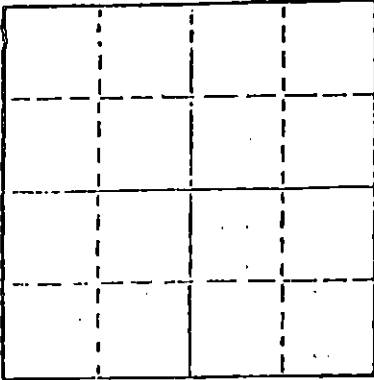

Locate well correctly on above
Section Plot

Character of Well (Completed as Oil, Gas or Dry Hole) dry hole
Date Well completed 7-9-78 19
Application for plugging filed 7-9-78 19
Application for plugging approved 7-9-78 19
Plugging commenced 7-9-78 19
Plugging completed 7-9-78 19
Reason for abandonment of well or producing formation _____

If a producing well is abandoned, date of last production 19 _____

Was permission obtained from the Conservation Division or its agents before plugging was commenced? yes

Name of Conservation Agent who supervised plugging of this well Bill Owen
Producing formation _____ Depth to top _____ Bottom _____ Total Depth of Well 4594
Show depth and thickness of all water, oil and gas formations.

OIL, GAS OR WATER RECORDS

CASING RECORD

FORMATION	CONTENT	FROM	TO	SIZE	PUT IN	PULLED OUT
Surface		0		8 5/8"		0

Describe in detail the manner in which the well was plugged, indicating where the mud fluid was placed and the method or methods used in introducing it into the hold. If cement or other plugs were used, state the character of same and depth placed, from _____ feet to _____ feet for each plug set.

RECEIVED
STATE CORPORATION COMMISSION

FEB 25 1979

CONSERVATION DIVISION
Wichita, Kansas

plug & 50 sx @ 600'
plug & 35 sx @ 260'
bridge plug & 12 sx @ 40'
2 sx @ rathole
2 sx @ mousehole
finish @ 11:00 a.m. 7-9-78

2-23-79

(If additional description is necessary, use BACK of this sheet)

Name of Plugging Contractor Halliburton Pratt, Kansas 67124

STATE OF Kansas COUNTY OF Sedgwick, ss.
Timothy E. Brandt (employee of owner) or (owner or operator)
of the above-described well, being first duly sworn on oath, says: That I have knowledge of the facts, statements, and matters herein contained and the log of the above-described well as filed and that the same are true and correct. So help me God.

(Signature) [Signature]
1104 Douglas Bldg. Wichita, Kansas
(Address)

SUBSCRIBED AND SWORN TO before me this 12th day of July, 19 78

My commission expires February 29, 1980

Barbara June Brandt
Barbara June Brandt Notary Public.

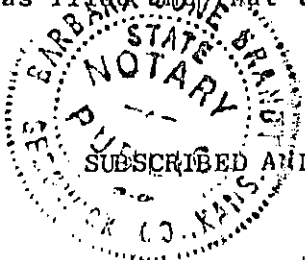

IMPORTANT
 Kans. Geo. Survey request
 samples on this well.

KANSAS DRILLERS LOG

S. 29 T. 24 R. 17 ^W
 Loc. 090' FSL & 660' FEL NE
 County Edwards

API No. 15 — 047 — 20,337-0000
 County Number

Operator
F. G. Holl

Address
6427 East Kellogg Wichita, Kansas 67207

Well No. # 2-29 Lease Name J. H. Cross "B"

Footage Location
990 feet from (S) line 660 feet from (E) line

Principal Contractor Brandt Drilling Company Geologist Bill G. Ree

Spud Date June 30, 1978 Total Depth 4594 P.B.T.D.

Date Completed July 8, 1978 Oil Purchaser

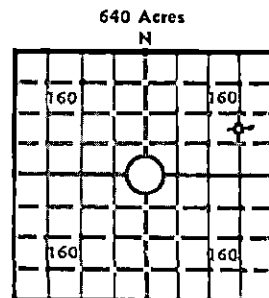

Locate well correctly
 Elev.: Gr. 2124
 DF 2134 KB 2136

CASING RECORD

Report of all strings set — surface, intermediate, production, etc.

Purpose of string	Size hole drilled	Size casing set (in O.D.)	Weight lbs/ft.	Setting depth	Type cement	Sacks	Type and percent additives
Surface	12 1/4"	8 5/8	28#	263 KB	common	175	3% CaCl ₂ ; 2% Gel

LINER RECORD

Top, ft.	Bottom, ft.	Sacks cement

PERFORATION RECORD

Shots per ft.	Size & type	Depth interval

TUBING RECORD

Size	Setting depth	Packer set at

ACID, FRACTURE, SHOT, CEMENT SQUEEZE RECORD

Amount and kind of material used	Depth interval treated

RECEIVED
 STATE CORPORATION COMMISSION

FEB 22 1979

INITIAL PRODUCTION

CONSERVATION DIVISION
 Wichita, Kansas

Date of first production Producing method (flowing, pumping, gas lift, etc.)

RATE OF PRODUCTION PER 24 HOURS	Oil	Gas	Water	Gas-oil ratio
	bbls.	MCF	bbls.	CFPB

Disposition of gas (vented, used on lease or sold) Producing interval(s)

INSTRUCTIONS: As provided in KCC Rule 82-2-125, within 90 days after completion of a well, one completed copy of this Drillers Log shall be transmitted to the State Geological Survey of Kansas, 4150 Monroe Street, Wichita, Kansas 67209. Copies of this form are available from the Conservation Division, State Corporation Commission, 3830 So. Meridian (P.O. Box 17027), Wichita, Kansas 66217. Phone AC 316-522-2206. If confidential custody is desired, please note Rule 82-2-125. Drillers Logs will be on open file in the Oil and Gas Division, State Geological Survey of Kansas, Lawrence, Kansas 66044.

Operator F. G. Holl		DESIGNATE TYPE OF COMP.: OIL, GAS, DRY HOLE, SWDW, ETC.:
Well No. 2-29	Lease Name CROSS	Dry Hole
S 29 T 24 R 17 ^X / _W		

WELL LOG

Show all important zones of porosity and contents thereof; cored intervals, and all drill-stem tests, including depth interval tested, cushion used, time tool open, flowing and shut-in pressures, and recoveries.

SHOW GEOLOGICAL MARKERS, LOGS RUN, OR OTHER DESCRIPTIVE INFORMATION.

FORMATION DESCRIPTION, CONTENTS, ETC.	TOP	BOTTOM	NAME	DEPTH
<p>Laterolog - Gamma Ray - Neutron Compensated Density - Caliper</p> <p>DST # 1 4370-4440 30-30-60-30 Fair Blow increasing to good blow on second opening.</p> <p>210 feet of gas in pipe. 65 feet of slight oil cout mud</p> <p>IFF 104/104 ISIP 159 FFP 112/112 FSIP 169 IHP 2247 FHP 2217</p> <p>DST # 2 4477-4491 30-30-60-30 Weak blow increasing to fair steady blow.</p> <p>125 feet of slightly oil cut muddy water. 240 feet of salt water.</p> <p>IFF 81/112 ISIP 1294 FFP 193/203 FSIP 1194 IHP 2287 FHP 2217</p>			<p>Heebner 3798 Douglas 3828 Brown Lime 3923 Lansing 3933 B KC 4237 Cherokee 4373 Cherokee Sd. 4420 Mississippian 4476 Kinderhook 4519 Kinderhook Sd. (Missing) Viola 4587 RDT 4594</p>	

USE ADDITIONAL SHEETS, IF NECESSARY, TO COMPLETE WELL RECORD.

Date Received	<p align="center"><i>Elwyn H. Nagel</i> Elwyn H. Nagel Signature Geologist Title February 20, 1979 Date</p>
---------------	---