

STATE CORPORATION COMMISSION OF KANSAS
OIL & GAS CONSERVATION DIVISION
WELL COMPLETION OR RECOMPLETION FORM
ACO-1 WELL HISTORY
DESCRIPTION OF WELL AND LEASE

API NO. 15-015-23,137-0000
County... Butler
SW/4 SE/4 SW/4 35 28S 6W East
..... Sec..... Twp..... Rge..... East

KCC
4-25-16

Operator: License # 5120
Name Range Oil Company, Inc.
Address 125 N. Market, Suite 1120
City/State/Zip Wichita, Kansas 67202

330 Ft North from Southeast Corner of Section
3630 Ft West from Southeast Corner of Section
(Note: Locate well in section plat below)

Purchaser.....

Lease Name Frank Well # 1

Operator Contact Person John M. Washburn
Phone 316-265-6231

Field Name.....

Producing Formation.....

Contractor: License # 5302
Name Red Tiger Drilling Company

Elevation: Ground 1451 KB 1456

Wellsite Geologist Tim Lauer
Phone (316) 265-6231

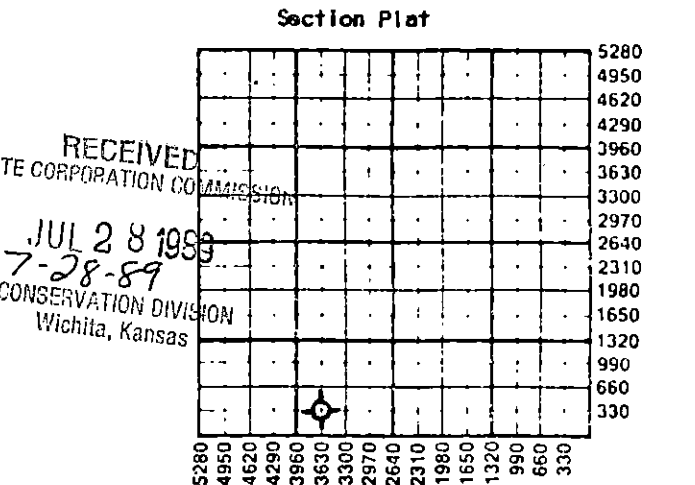

Designate Type of Completion
 New Well Re-Entry Workover
 Oil SWD Temp Abd
 Gas Inj Delayed Comp.
 Dry Other (Core, Water Supply etc.)
If OWNO: old well info as follows:
Operator.....
Well Name.....
Comp. Date..... Old Total Depth.....

WATER SUPPLY INFORMATION
Disposition of Produced Water: Disposal
Docket # Repressuring

WELL HISTORY
Drilling Method:
 Mud Rotary Air Rotary Cable
7/11/89 7/22/89 7/22/89
Spud Date Date Reached TD Completion Date
2,931'
Total Depth PBTD

Questions on this portion of the ACO-1 call:
Water Resources Board (913) 296-3717
Source of Water:
Division of Water Resources Permit #.....
 Groundwater..... Ft North from Southeast Corner
(Well) Ft West from Southeast Corner of
Sec Twp Rge East West
 Surface Water: 2900 Ft North from Southeast Corner
(Stream, pond etc) 2800 Ft West from Southeast Corner
Sec 3 Twp 29S Rge 6 East West
Oran Need, Miami, Oklahoma 74354
 Other (explain).....
(purchased from city, R.W.D. #)

Amount of Surface Pipe Set and Cemented at 218 feet
Multiple Stage Cementing Collar Used? Yes No
If yes, show depth set..... feet
If alternate 2 completion, cement circulated
from..... feet depth to..... w/..... SX cmt
Cement Company Name.....
Invoice #.....
A/I/D Dry

INSTRUCTIONS: This form shall be completed in triplicate and filed with the Kansas Corporation Commission, 200 Colorado Derby Building, Wichita, Kansas 67202, within 120 days of the spud date of any well. Rule 82-3-130, 82-3-107 and 82-3-106, apply.
Information on side two of this form will be held confidential for a period of 12 months if requested in writing and submitted with the form. See rule 82-3-107 for confidentiality in excess of 12 months.
One copy of all wireline logs and drillers time log shall be attached with this form. Submit CP-4 form with all plugged wells. Submit CP-111 form with all temporarily abandoned wells.

All requirements of the statutes, rules and regulations promulgated to regulate the oil and gas industry have been fully complied with and the statements herein are complete and correct to the best of my knowledge.

Signature John M. Washburn
Title Vice President Date 7-27-89

Subscribed and sworn to before me this 27th day of July 1989
Notary Public David T. Jervis

Date Commission Expires.....

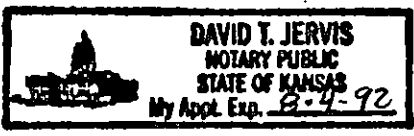

K-C.C. OFFICE USE ONLY
F Letter of Confidentiality Attached
C Wireline Log Received
C Drillers Timelog Received
Distribution
 KCC SWD/Rep NGPA
 KGS Plug Other
(Specify)
Form ACO-1 (5-86)

Sec 35 Twp. 29S Rge. 6W

Operator Name Range Oil Company, Inc. Lease Name Frank Well # 1

Sec. 35 Twp. 28S Rge. 6E East West County Butler

WELL LOG

INSTRUCTIONS: Show important tops and base of formations penetrated. Detail all cores. Report all drill stem tests giving interval tested, time tool open and closed, flowing and shut-in pressures, whether shut-in pressure reached static level, hydrostatic pressures, bottom hole temperature, fluid recovery, and flow rates if gas to surface during test. Attach extra sheet if more space is needed. Attach copy of log.

Drill Stem Tests Taken Yes No
 Samples Sent to Geological Survey Yes No
 Cores Taken Yes No

Formation Description
 Log Sample

DST #1 - 2883'-2895', 30-30-60-60. Blow; weak.
 Rec: 140' SOSMW (1% oil - 58,000ppm).
 IFP 55-55. ISIP 884. FFP 110-110.
 FSIP 884.

Name	Top	Bottom
Lansing	1789'	(-333')
Base Lansing	2076'	(-620')
Kansas City	2194'	(-738')
Base Kansas City	2394'	(-938')
Marmaton	2446'	(-990')
Peru	2463'	(-1007')
Cherokee	2639'	(-1183')
Bartlesville Zone	2873'	(-1417')
Mississippian	2881'	(-1425')
Miss. Dolomite	2890'	(-1434')
RTD	2931'	(-1475')

CASING RECORD <input checked="" type="checkbox"/> New <input type="checkbox"/> Used							
Report all strings set-conductor, surface, intermediate, production, etc.							
Purpose of String	Size Hole Drilled	Size Casing Set (In O.D.)	Weight Lbs/Ft.	Setting Depth	Type of Cement	#Sacks Used	Type and Percent Additives
Surface	11"	8 5/8"		218'	Common	85	3%CC

PERFORATION RECORD		Acid, Fracture, Shot, Cement Squeeze Record	
Shots Per Foot	Specify Footage of Each Interval Perforated	(Amount and Kind of Material Used)	Depth

TUBING RECORD	Size	Set At	Packer at	Liner Run <input type="checkbox"/> Yes <input type="checkbox"/> No

Date of First Production	Producing Method				
	<input type="checkbox"/> Flowing <input type="checkbox"/> Pumping <input type="checkbox"/> Gas Lift <input type="checkbox"/> Other (explain).....				
Estimated Production Per 24 Hours	Oil	Gas	Water	Gas-Oil Ratio	Gravity
	Bbls	MCF	Bbls	CFPB	

METHOD OF COMPLETION

Production Interval

Disposition of gas: Vented Open Hole Perforation
 Sold Other (Specify)
 Used on Lease Dually Completed
 Commingled

