

STATE CORPORATION COMMISSION OF KANSAS  
OIL & GAS CONSERVATION DIVISION

WELL COMPLETION OR RECOMPLETION FORM  
ACO-1 WELL HISTORY

DESCRIPTION OF WELL AND LEASE

Operator: license # 5430  
name ENERGY THREE, INC.  
address P. O. Box 1505  
City/State/Zip GREAT BEND, KANSAS 67530

Operator Contact Person DOUGLAS MEYER  
Phone AC316-792-5968

Contractor: license # 5840  
name BRANDT DRILLING CO., INC.

Wellsite Geologist STEPHEN MILLER  
Phone AC316-264-7433

Designate Type of Completion  
 New Well  Re-Entry  Workover  
 Oil  SWD  Temp Abd  Delayed Comp.  
 Gas  Inj  Other (Core, Water Supply etc.)  
 Dry

If OWWO: old well info as follows:  
Operator  
Well Name  
Comp. Date Old Total Depth

WELL HISTORY

Drilling Method:  Mud Rotary  Air Rotary  Cable  
8-13-84 8-20-84 9-28-84  
Spud Date Date Reached TD Completion Date  
4380 4010  
Total Depth PBT  
Amount of Surface Pipe Set and Cemented at 215 feet  
Multiple Stage Cementing Collar Used?  Yes  No  
If Yes, Show Depth Set feet  
If alternate 2 completion, cement circulated from feet depth to w/ SX cmt

API NO. 15- 095-21,471-0000  
County KINGMAN  
CENT. NW NE Sec 2 Twp 28S Rge 7 X W  
4620 Ft North from Southeast Corner of Section  
1980 Ft West from Southeast Corner of Section  
(Note: locate well in section plat below)

Lease Name BERGMAN Well# 1  
Field Name  
Producing Formation N/A  
Elevation: Ground 1561 KB 1568

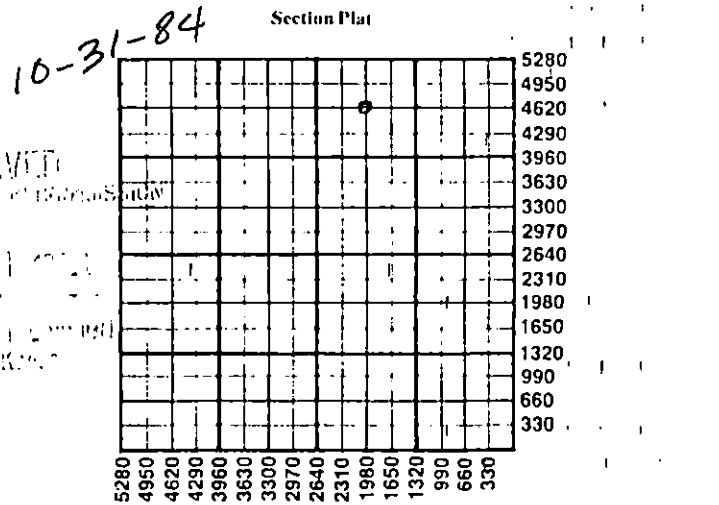

WATER SUPPLY INFORMATION

Source of Water:  
Division of Water Resources Permit #  
 Groundwater. Ft North From Southeast Corner at (Well) Ft. West From Southeast Corner  
Sec Twp Rge  East  West  
 Surface Water. Ft North From Southeast Corner at (Stream, Pond etc.). Ft West From Southeast Corn  
Sec Twp Rge  East  West  
 Other (explain) CITY OF KINGMAN, KANSAS  
(purchased from city, R.W.D.#)

Disposition of Produced Water:  Disposal  Repressuring  
Docket #

INSTRUCTIONS: This form shall be completed in duplicate and filed with the Kansas Corporation Commission, 200 Colorado Derby Building Wichita, Kansas 67202, within 90 days after completion or recompletion of any well. Rules 82-3-130 and 82-3-107 apply.

Information on side two of this form will be held confidential for a period of 12 months if requested in writing and submitted with the form. See rule 82-3-107 for confidentiality in excess of 12 months.

One copy of all wireline logs and drillers time log shall be attached with this form. Submit CP-4 form with all plugged wells. Submit CP-111 form with all temporarily abandoned wells.

All requirements of the statutes, rules, and regulations promulgated to regulate the oil and gas industry have been fully complied with and the statements herein are complete and correct to the best of my knowledge.

Signature Douglas P. Meyer  
Title EXECUTIVE VICE-PRESIDENT Date 10-30-84

Subscribed and sworn to before me this 30th day of OCTOBER 1984

Notary Public Howard D. Ewert  
Date Commission Expires 11-15-84

K.C.C. OFFICE USE ONLY  
 Letter of Confidentiality Attached  
 Wireline Log Received  
 Drillers Timelog Received  
Distribution  
 KCC  SWD/Rep  NGPA  
 KGS  Plug  Other (Specify)

Operator Name **ENERGY THREE, INC.** Lease Name **BERGMAN** Well# **1** SEC. **2** TWP. **28S** RGE. **7**  East  West

**WELL LOG**

**INSTRUCTIONS:** Show important tops and base of formations penetrated. Detail all cores. Report all drill stem tests giving interval tested, time tool open and closed, flowing and shut-in pressures, whether shut-in pressure reached static level, hydrostatic pressures, bottom hole temperature, fluid recovery, and flow rates if gas to surface during test. Attach extra sheet if more space is needed. Attach copy of log.

Drill Stem Tests Taken  Yes  No  
 Samples Sent to Geological Survey  Yes  No  
 Cores Taken  Yes  No

Formation Description  
 Log  Sample

DST # 1: FROM 3910' TO 3924'  
 TIMES = 45 - 60 - 45 - 90  
 GAS TO SURFACE IN 6 MINUTES. STABILIZED 2ND FLOW PERIOD @ 359,000 CU. FT. PER DAY RATE. RECOVERY = 90% WATER CUT MUD AND 180' VERY SLIGHTLY MUD CUT WATER.  
 INITIAL FLOW PRESSURE = 138 - 170  
 FINAL FLOW PRESSURE = 180 - 191  
 INITIAL SHUTIN PRESS. = 1468 #  
 FINAL SHUTIN PRESS. = 1457 #

Name	Top	Bottom
HEEBNER	2947	(-1379)
BROWN LIME	3185	(-1617)
LANSING	3200	(-1632)
STARK SHALE	3553	(-1985)
SWOPE	3559	(-1991)
MISSISSIPPI	3904	(-2336)
KINDERHOOK SHALE	4164	(-2596)
VIOLA	4276	(-2708)
SIMPSON SAND	4301	(-2733)
LOG T.D.	4374'	

DST # 2: FROM 3924' TO 3934'  
 TIMES = 45 - 60 - 45 - 90  
 GAS TO SURFACE IN 4 1/2 MINUTES. STABILIZED 2ND FLOW PERIOD @ 366,000 CU. FT. PER DAY RATE. RECOVERED 105' MUDDY WATER.  
 INITIAL FLOW PRESSURE = 127 - 127  
 FINAL FLOW PRESSURE = 127 - 138  
 INITIAL SHUTIN PRESS. = 1457 #  
 FINAL SHUTIN PRESS. = 1447 #

RELEASED

JAN 17 1986

FROM CONFIDENTIAL

**CASING RECORD**  new  used

Report all strings set - conductor, surface, intermediate, production, etc.

Purpose of string	size hole drilled	size casing set (in O.D.)	weight lbs/ft.	setting depth	type of cement	# sacks used	type and percent additives
SURFACE	12 1/4"	8 5/8"	20#	215	60/40	150	3% C.C.
PRODUCTION	7 7/8"	4 1/2"	10.5#	4029'	POZMIX SUREFIL	250	2% GEL

**PERFORATION RECORD**

**Acid, Fracture, Shot, Cement Squeeze Record**

shots per foot	specify footage of each interval perforated	(amount and kind of material used)	Depth
4	3905' - 3907' & 3914' - 3919'	2000 GAL. 10% FE	

**TUBING RECORD**

size set at packer at Liner Run  Yes  No

Date of First Production	Producing method				
TEMP. ABAND.	<input type="checkbox"/> flowing	<input type="checkbox"/> pumping	<input type="checkbox"/> gas lift	<input type="checkbox"/> Other (explain)	
Estimated Production Per 24 Hours	Oil	Gas	Water	Gas-Oil Ratio	Gravity
	Bbls	MCF	Bbls	CFPB	

**METHOD OF COMPLETION**

**PRODUCTION INTERVAL**

Disposition of gas:  vented  sold  used on lease  
 open hole  perforation  other (specify)  
 Dually Completed.  Commingled

RECORDED TO 442 - 2821 1/2' 10/27/85

BEFORE THE STATE CORPORATION COMMISSION  
OF THE STATE OF KANSAS

BEFORE COMMISSIONERS: MICHAEL LENNEN, CHAIRMAN  
MARGALEE WRIGHT  
KEITH R. HENLEY

IN THE MATTER OF THE APPLICATION OF	)	DOCKET NO. NP 38597
ENERGY THREE, INC.	)	
FOR A NEW POOL DETERMINATION PURSUANT	)	CONSERVATION DIVISION
TO K.A.R. 82-3-102 ON ITS BERGMAN	)	
#1.	)	LICENSE NO. 5430

ORDER

THE ABOVE-CAPTIONED MATTER COMES ON FOR CONSIDERATION AND DETERMINATION BY THE STATE CORPORATION COMMISSION OF THE STATE OF KANSAS. BEING FULLY ADVISED IN THE PREMISES, THE COMMISSION FINDS AND CONCLUDES THAT:

1. ON MARCH 22, 1985, ENERGY THREE, INC. FILED AN APPLICATION FOR NEW POOL DETERMINATION FOR ITS BERGMAN #1 LOCATED IN THE NE QUARTER OF SECTION 2, TOWNSHIP 28 SOUTH, RANGE 7 WEST, KINGMAN COUNTY, KANSAS.

2. THE NOMENCLATURE COMMITTEE HAS RECOMMENDED THAT SUCH APPLICATION BE GRANTED BASED UPON ITS FINDING THAT THE WELL QUALIFIES AS A DISCOVERY WELL DRILLED IN A NEW POOL, BECAUSE THE DISTANCE BETWEEN THE EXISTING PRODUCING WELL AND THE SUBJECT WELL IS GREATER THAN 1/2 MILE.

3. THE CONSERVATION DIVISION CONCURS WITH THE RECOMMENDATION OF THE NOMENCLATURE COMMITTEE.

4. THE COMMISSION HAS REVIEWED THE RECORD PRESENTED BY THE NOMENCLATURE COMMITTEE AND THE CONSERVATION DIVISION AND HEREBY ADOPTS SUCH RECOMMENDATIONS.

5. THE FIRST PRODUCTION OF GAS FROM THE POOL(S) IS NOT AVAILABLE AS THE WELL IS IN A SHUT-IN STATUS.

IT IS, THEREFORE, BY THE COMMISSION ORDERED THAT:

1. THE NEW POOL(S) FROM WHICH APPLICANT'S WELL PRODUCES BE DESIGNATED THE MISSISSIPPI COMMON SOURCE(S) OF SUPPLY, LOCATED IN THE CP&W, SOUTH FIELD;

2. THE COMMISSION FURTHER FINDS THAT THE DATE OF FIRST PRODUCTION OF GAS FROM SUCH NEW POOL(S) WAS NOT AVAILABLE AS THE WELL IS IN A SHUT-IN STATUS.

3. APPLICANT'S BERGMAN #1 LOCATED IN THE NE QUARTER OF SECTION 2, TOWNSHIP 28 SOUTH, RANGE 7 WEST, KINGMAN COUNTY, KANSAS IS HEREBY GRANTED A NEW POOL DETERMINATION.

BY THE COMMISSION IT IS SO ORDERED.

LENNEN, CHAIRMAN; WRIGHT, COMMISSIONER; HENLEY, COMMISSIONER.

DATE \_\_\_\_\_  
APR 24 1985

*Judith McConnell*  
\_\_\_\_\_  
JUDITH MCCONNELL  
EXECUTIVE SECRETARY

*June 1984*

