

WELL PLUGGING RECORD 15-155-02660-000

Give All Information Completely
Make Required Affidavit
Mail or Deliver Report to:
Conservation Division
State Corporation Commission
212 No. Market
Wichita, Kansas

Reno County, Sec. 26 Twp. 23S Rge. 4 (E) W (W)
Location as "NE/CNW/SW" or footage from lines C NW NE
Lease Owner S. & R. Oil Co.
Lease Name E. Krehbiel, O
Tulsa, Oklahoma Well No. 3
Office Address P O Box 682
Character of Well (completed as Oil, Gas or Dry Hole) Oil Well
Date well completed 8-11-19 34
Application for plugging filed Jan. Dec 31 19 69
Application for plugging approved Jan. 2 19 69
Plugging commenced Jan. 9 19 69
Plugging completed Jan. 18 19 69
Reason for abandonment of well or producing formation Depletion

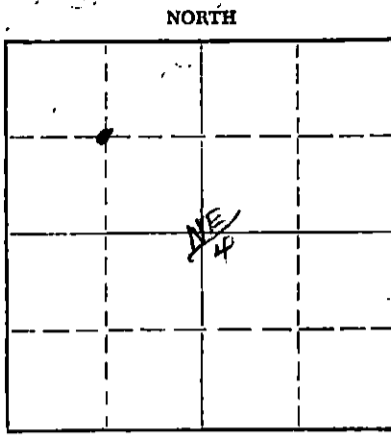

Locate well correctly on above Section Plat

If a producing well is abandoned, date of last production 19
Was permission obtained from the Conservation Division or its agents before plugging was commenced? Yes

Name of Conservation Agent who supervised plugging of this well Gilbert Toman
Producing formation Chat Depth to top 3263 Bottom 3368 Total Depth of Well 3368 Feet
Show depth and thickness of all water, oil and gas formations.

OIL, GAS OR WATER RECORDS				CASING RECORD		
FORMATION	CONTENT	FROM	TO	SIZE	PUT IN	PULLED OUT
Chat		3263	3368	15 1/2"	251	--
				8 5/8"	3263	2456.40'

Describe in detail the manner in which the well was plugged, indicating where the mud fluid was placed and the method or methods used in introducing it into the hole. If cement or other plugs were used, state the character of same and depth placed, from feet to feet for each plug set.

Sanded back to 3250' and dumped 7 sacks of cement. Shot pipe off at 2456.40'. Pulled pipe and mudded hole to 210'. Set rock bridge from 210' to 200' and finished filling hole with 6 yards of ready mix cement.

RECEIVED
STATE CORPORATION COMMISSION
FEB 26 1969
CONSERVATION DIVISION
Wichita, Kansas

(If additional description is necessary, use BACK of this sheet)
Name of Plugging Contractor Bert Self
Address Hutchinson, Kans.

STATE OF Kans. COUNTY OF Reno, ss.
Employee (employee of owner) or (owner or operator) of the above-described well, being first duly sworn on oath, says: That I have knowledge of the facts, statements, and matters herein contained and the log of the above-described well as filed and that the same are true and correct. So help me God.

(Signature) Bert Self
R. R. #4, Hutchinson, Kans.
(Address)

SUBSCRIBED AND SWORN TO before me this 21st day of January, 19 69
October 18, 1969
Notary Public.

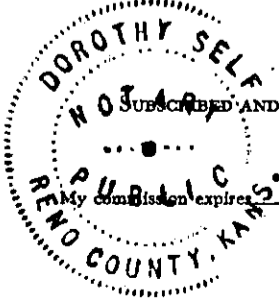

15-155-02660-0000 R

*NOTE: Date of completion is date at which drilling and cleanout operations are finished. Tools may be kept at well to produce by swabbing, agitation, etc; when finally removed operations succeeding date of completion should be described in job report, Form 0013.

Form 02037-A 20th 7-4-35

OLSON - SHELL (COMPANY) WEEKLY DRILLING REPORT COMPLETION From 8-14 To 9-25 19 34	LEASE E. KRIG SURVEY C NW NE Sec. 25 T. 23S R. 4W LOCATION Parish Co. RENO STATE KANSAS DISTRICT BURRTON 1469'.
--	--

Elevation: Derrick Floor	1469	Ground	
Type of Rig	122' Steel Rotary	Rig Contractor	
Rig Commenced	8-10-34	Completed	8-11-34
Rotary Tools from	0 to 3263	Contractor	Olson Drlg. Co.
Commenced	8-15-34	Completed	9-4-34
Cable Tools from	3263 to 3368	Contractor	Olson Drlg. Co.
Commenced	9-10-34	Completed*	9-24-34

PRODUCING STRATA
(Note: State contents of all producing strata, oil, gas, or water, giving fluid level etc.)

TOP	BOTTOM	NAME	REMARKS
3251	3368	Chat	7 Mil. gas @ 3290' 14,700,000 gas @ 3312, 15,200,000 @ 3329, 1035# rock pressure. Sho oil & gas 3342-58'.
TD	3368	Chat	

ACID TREATMENT OR SHOT RECORD

DATE	PRODUCTION		AMOUNT OF SHOT OR ACID	FROM	TO	REMARKS
	BEFORE	AFTER				

CASING LINER AND TUBING RECORD
(Note: Show only casing left in well.)

SIZE (O. D.)	WEIGHT	THREADS	MAKE	Set or Cemented	BOTTOM	TOP IF LINER	PACKER RECORD		REMARKS (New, S. H., Sack, Cement, etc.) (Type of Screen, Choke)
							SET AT	MAKE	
15 1/2 7 5 3/16				Cem Cem Set	251 3263 3322				100 sax. 250 sax. Lead shoe.

PRODUCTION RECORD
(Note: Give all production data of special interest.)

DATE	OIL BARRELS	GAS M. CUBIC FEET	WATER BARRELS	HOURS	METHOD	PRESSURES		REMARKS
						CASING	TUBING	
9-25-34	223		Sho	24	Flow			Pot'l test.
			No further	test.				

GRAVITY 34 @ 70 ROCK PRESSURE

CORRECT

APPROVED

EXPLOITATION ENGINEER

SUPERINTENDENT

RECEIVED
STATE CORPORATION COMMISSION
JAN 2 1969
CONSERVATION DIVISION
Wichita, Kansas

OLSON - SHELL
WEEKLY DRILG. REPORT

E. KREHBIEL | 1. 3
Survey: C NW NE SEC. 26-23S-4W
Location: 660' NL: 660' WL
State of Kansas, Reno County
Burton District.

R

Date	Depth		Formation	Remarks
	From	To		
8-8-34				Location.
8-9-34				Digging ponds & cellar.
8-10-34				Building derrick.
&				
8-11-34				Moving in rotary tools.
8-12-34				
8-13-34				Rigging up rotary tools.
&				
8-14-34				SPUD 8-15-34.
				Olson Drlg. Co., Steam Rty.
8-15-34	0	160	Sand	
	160	200	Shale	
	200	224	Shale & shells	
8-16-34	224	251	Shale & shells	15 1/2" cem 251' w 100 sax.
8-17-34	TD	251	Shale & shells	Waiting on cement to set.
8-18-34	251	290	Shale	
	290	318	Sdy shale	
	318	345	Shale	
	345	420	Shale & shells	
	420	490	Anhydrite & salt	
	490	620	Shale & shells	
8-19-34	620	650	Bkn lime & shale	
	650	930	Shale & shells	
8-20-34	930	940	Shale	
	940	962	Bkn lime	
	962	1254	Shale & shells	
8-21-34	1254	1600	Shale & shells	
8-22-34	1600	1828	Shale & shells	
	1828	1885	Shale & shells	
8-23-34	1885	1960	Shale & shells	
	1960	2028	Lime	
	2028	2074	Shale & shells	
8-24-34	2074	2116	Lime	
	2116	2154	Shale & shells	
	2154	2211	Shale & shells	
8-25-34	2211	2273	Shale & bkn lime	
	2273	2345	Shale	
	2345	2370	Lime	
8-26-34	2370	2394	Hard lime	
	2394	2500	Shale & shells	Syfo 2500' - 0°.
	2500	2528	Lime & shale breccia	
8-27-34	2528	2563	Shale & shells	
	2563	2608	Shale & lime	
	2608	2641	Lime	
8-28-34	2641	2768	Lime & shale	
8-29-34	2768	2845	Shale & shells	
8-30-34	2845	2940	Lime	
	2940	3040	Lime & shale	
8-31-34	3040	3073	Shale & shells	3072 = 3078 S.L.C.
	3073	3102	Shale & bkn lime	
	3102	3176	Shale & lime	
9-1-34	3176	3191	Shale & shells	
	3191	3251	V. C. shale	TOP CHAT 3251'.
	3251	3267	Chat	
	3267 =	3263	S.L.C.	
9-4-34	TD	3263	Chat	7" cem 3263' w 250 sax.
9-5-34				
to	TD	3263	Chat	WOCS & RUST.
9-8-34				
9-9-34	TD	3263	Chat	WOCS & RUST.
9-10-34	TD	3263	Chat	Bail mud.

OLSON - SHELL

E. KREHBIEL NO. 3 (OILT'D)

Date	Depth		Formation	Remarks
	From	To		
9-11-34	3263	3320	Chat	7 Mil Gas at 3290'. 14,700,000 GAS @ 3312'.
	3320	3329	Chat	15,200,000 GAS @ 3329'. 1035# rock pressure.
9-12-34 to	TD	3329	Chat	Prepare to run casing.
9-14-34				
9-15-34	TD	3329	Chat	Running 5 3/16" casing.
9-16-34 &	TD	3329	Chat	Working with pipe.
9-17-34				
9-18-34	3329	3340	Chat	
9-19-34	TD	3340	Chat	Reaming hole.
9-20-34	3340	3365	Chat	SHO OIL & GAS 3342-58'.
9-21-34	TD	3365	Chat	Gas broke in - prep to mud well.
9-22-34	TD	3365	Chat	Fishing for tools.
9-23-34	3365	3368	Chat	Shut off o.k.
9-24-34	TD	3368	Chat	Prep to take potential test.
9-25-34	TD	3368	Chat	Flow 223 oil & SHO WTR 24 hr. potential test end 11AM 9-25-34.

COMPLETE 9-24-34.