

STATE OF KANSAS
STATE CORPORATION COMMISSION

WELL PLUGGING RECORD

OR
FORMATION PLUGGING RECORD

Strike out upper line
when reporting plug-
ging off formations.

Give All Information Completely
Make Required Affidavit
Mail or Deliver Report to:
Conservation Division
State Corporation Commission
800 Bittling Building
Wichita, Kansas

NORTH

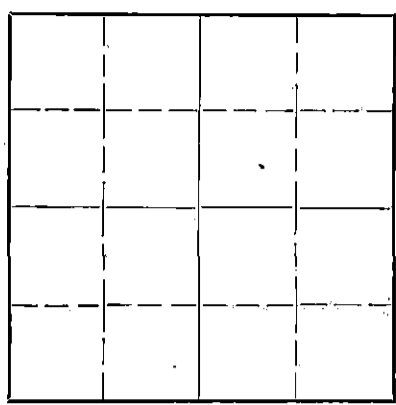

Locate well correctly on above
Section Flat

Stafford County, Sec. 14 Twp. 24 S Rge. 11 W (E) (W)
Location as "NE 1/4 NW 1/4 SW 1/4" or footage from lines SW NW SE
Lease Owner The Pure Oil Company
Lease Name John Krey Well No. 9
Office Address P. O. Box 271 - Tulas, Oklahoma
Character of Well (completed as Oil, Gas or Dry Hole) Oil
Date well completed October 5, 1938
Application for plugging filed April 8, 1946
Application for plugging approved April 10, 1946
Plugging commenced December 14, 1946
Plugging completed December 22, 1946
Reason for abandonment of well or producing formation Oil depleted
If a producing well is abandoned, date of last production April 1, 1946
Was permission obtained from the Conservation Division or its agents before plugging was com-
menced? Yes

Name of Conservation Agent who supervised plugging of this well Herb. Kerr
Producing formation Misener Depth to top 3791 Bottom 3798 Total Depth of Well 3798 Feet
Show depth and thickness of all water, oil and gas formations.

OIL, GAS OR WATER RECORDS

CASING RECORD

Formation	Content	From	To	Size	Put In	Pulled Out
Misener	Oil	3791	3798	10"	259'	None
				7"	3784'	2718'

Describe in detail the manner in which the well was plugged, indicating where the mud fluid was placed and the method or methods used in introducing it into the hold. If cement or other plugs were used, state the character of same and depth placed, from _____ feet to _____ feet for each plug set.

Dumped 8 sax cement in bottom of hole at 3798' - Filled hole with water and shot 7" O. D. Casing into @ 2700'. 89 joints of 7" casing was pulled for a total of 2718'. Filled hole with mud from bottom to 250'. Set 10' rock bridge from 250' to 240'. Dumped 15 sacks Victor Cement on top of rock at 240', filled with mud from 240' to 20', filled with cement from 20' to top of 10" casing for cap.

14 24 11 W
55 7

STATE CORPORATION COMMISSION
JAN 25 1947

(If additional description is necessary, use BACK of this sheet)

Correspondence regarding this well should be addressed to C. W. Burger
Address: Star Route B - Hominy, Oklahoma

1-25-1947

STATE OF Oklahoma, COUNTY OF Osage, ss.
C. W. Burger (employee of owner) or (owner or operator) of the above-described well,

being first duly sworn on oath, says: That I have knowledge of the facts, statements, and matters herein contained and the log of the above-described well as filed and that the same are true and correct. So help me God.

(Signature) C. W. Burger

Star Route B - Hominy, Oklahoma (Address)

SUBSCRIBED AND SWORN to before me this 23rd day of January 7, 1947

Francis Lowrey
Notary Public

My commission expires Nov. 15, 1950

THE PURE OIL COMPANY
WELL LOG
 AND RELATED DATA

LOG			
TOP	BOTTOM	THICKNESS	FORMATION
0	165	165	Sand & red bed
165	285	120	Red bed
285	591	306	Surface Sand-red bed
591	875	284	red bed & shale
875	1513	638	Shale & shells
1513	1650	137	Broken Lime
1650	1860	210	Lime
1860	1895	35	Sand
1895	2030	135	Lime
2030	2105	75	Br.Lime & shale
2105	2115	10	Sand
2115	2205	90	Broken Lime
2205	2415	210	Br. Lime & shale
2415	2480	65	Lime
2480	2540	60	Br.Lime & shale
2540	2570	30	Sandy lime
2570	2583	13	Lime
2583	2675	92	Broken Lime
2675	2785	110	Br.Lime & shale
2785	2833	48	Lime
2833	2890	57	Br.Lime & shale
2890	2913	23	Broken Lime
2913	3052	139	Lime
3052	3194	142	Broken Lime
3194	3255	61	Lime
3255	3285	30	Broken Sand
3285	3336	51	Br.Lime & shale
3336	3386	50	Shale
3386	3397	11	Br.Lime & shale
3397	3598	201	Lime - Top of Lansing - 3400'
3598	3607	9	Br.Lime & shale
3607	3639	32	Lime
3639	3710	71	Br.Lime & shale
3710	3783	73	Shale
3783	3784	1	Hard sand - Top of Misner - 3783'
3784	3785	1	Soft Sand
3785	3801	16	Sand - 1st gas show 3791'
3801	3802	1	Chert
3802	3804	2	Sand & Chert
3804	3806	2	Chert - Total Depth

PLUGGED BACK
 3806 3802
 3' correction after taking out derrick floor and sub structure
 3802 = 3799 Total Depth
 Top Misner Sand corrected to 3780'

LEASE John Kray WELL NO. 9
 LEASE NO. 6492 ACRES 130 A.P. NO. 1005
 ELEVATION 1828 PRODUCING DIVISION Prod
 LOT 14 TWP. 24 S. RGE. 11 W.
 PRCT. Kansas SURVEY _____
 DIST. _____ COUNTY Stafford STATE Kansas

LOCATION

990 FEET NORTH OF SOUTH LINE
1654 FEET EAST OF WEST LINE
990 FEET SOUTH OF NORTH LINE
992 FEET WEST OF EAST LINE

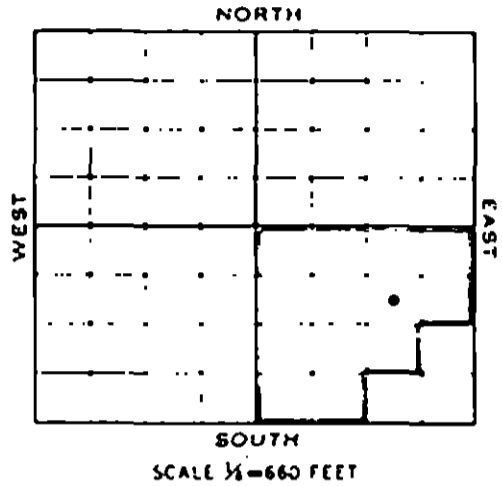

CASING RECORD

SIZE	WEIGHT	THREAD	MAKE	SET AT	REMARKS
10"	35	8	L.S.	259	
7"OD	22	10	S.S.	3784	

CASING CEMENTING RECORD

SIZE	SET AT	SACKS USED	GALLONS SET/FT	RESULTS
10"	259	275	0	Good
7"OD	3784	200	0	Good

LINER RECORD

SIZE	WEIGHT	LENGTH	NO JOINTS BLANK	NO JOINTS PERFORATED	SET AT

BRADENHEAD RECORD

MAKE	SIZE	TYPE	REMARKS

INITIAL TORPEDO RECORD

DATE	TOP OF SHOT	BOTTOM OF SHOT	NO. OTS.	REMARKS
10-6-38	3784	3802	5	

DRILLING COMMENCED 8-29-38
 DRILLING COMPLETED 10-5-38
 DRILLED WITH Rotary
 DRILLED IN WITH Standard
 FIRST 24 HRS. PRODUCTION - NATURAL _____ BBL.
 FIRST 24 HRS. PRODUCTION - AFTER SHOT flowed 2380 BBL.
 GRAVITY _____ TEMP. _____ GRADE _____
 GAS-ROCK PRESS. _____ LBS. VOLUME 11,084 CU FT
 DATE ABANDONED _____