

RECEIVED

For KCC Use:
Effective Date: 10-26-03
District #: 2
SGA? [] Yes [X] No

KANSAS CORPORATION COMMISSION
OIL & GAS CONSERVATION DIVISION

OCT 21 2003

Form C-1
September 1999

NOTICE OF INTENT TO DRILL KCC WICHITA

Form must be Typed
Form must be Signed
All blanks must be Filled

Must be approved by KCC five (5) days prior to commencing well

Expected Spud Date November 5, 2003
month day year

OPERATOR: License# 5214
Name: Lario Oil & Gas Company
Address: 301 South Market
City/State/Zip: Wichita, KS 67202
Contact Person: Jay G. Schweikert
Phone: 316-265-5611

CONTRACTOR: License# 5929
Name: Duke Drilling Co., Inc.

Well Drilled For: [X] Oil [] Enh Rec [] Infield [X] Mud Rotary
[] Gas [] Storage [] Pool Ext. [] Air Rotary
[] OWWO [] Disposal [X] Wildcat [] Cable
[] Seismic; # of Holes [] Other
[] Other

If OWWO: old well information as follows:
Operator:
Well Name:
Original Completion Date: Original Total Depth:
Directional, Deviated or Horizontal wellbore? [] Yes [X] No
If Yes, true vertical depth:
Bottom Hole Location:
KCC DKT #:

Spot SW NE SE Sec. 03 Twp. 28 S. R. 5
1650 feet from S N (circle one) Line of Section
990 feet from E W (circle one) Line of Section
Is SECTION [X] Regular [] Irregular?

(Note: Locate well on the Section Plat on reverse side)
County: Kingman
Lease Name: P. Brown "A" Well #: 2-3
Field Name: Wildcat
Is this a Prorated / Spaced Field? [] Yes [X] No
Target Formation(s): Mississippian
Nearest Lease or unit boundary: 990 ft
Ground Surface Elevation: 1427 feet MSL
Water well within one-quarter mile: [X] Yes [] No
Public water supply well within one mile: [] Yes [X] No
Depth to bottom of fresh water: 45 ft
Depth to bottom of usable water: 180 ft
Surface Pipe by Alternate: X 1 2
Length of Surface Pipe Planned to be set: 280 ft
Length of Conductor Pipe required: None
Projected Total Depth: 4000 ft
Formation at Total Depth: Mississippian
Water Source for Drilling Operations:
Well Farm Pond X Other
DWR Permit #:
(Note: Apply for Permit with DWR [])
Will Cores be taken? [] Yes [X] No
If Yes, proposed zone:

AFFIDAVIT

The undersigned hereby affirms that the drilling, completion and eventual plugging of this well will comply with K.S.A. 55-101, et. seq.
It is agreed that the following minimum requirements will be met:

- 1. Notify the appropriate district office prior to spudding of well;
2. A copy of the approved notice of intent to drill shall be posted on each drilling rig;
3. The minimum amount of surface pipe as specified below shall be set by circulating cement to the top; in all cases surface pipe shall be set through all unconsolidated materials plus a minimum of 20 feet into the underlying formation.
4. If the well is dry hole, an agreement between the operator and the district office on plug length and placement is necessary prior to plugging;
5. The appropriate district office will be notified before well is either plugged or production casing is cemented in;
6. If an ALTERNATE II COMPLETION, production pipe shall be cemented from below any usable water to surface within 120 days of spud date. In all cases, NOTIFY district office prior to any cementing.

I hereby certify that the statements made herein are true and to the best of my knowledge and belief.

Date: 10/20/03 Signature of Operator or Agent: Jay G. Schweikert Title: Operations Engineer

For KCC Use ONLY
API # 15 - 095-21854-00-00
Conductor pipe required: NONE feet
Minimum surface pipe required: 200' feet per Alt. 1 X
Approved by: DPW 10-21-03
This authorization expires: 4-21-04
(This authorization void if drilling not started within 6 months of effective date.)
Spud date: Agent:

Remember to:

- File Drill Pit Application (form CDP-1) with Intent to Drill;
- File Completion Form ACO-1 within 120 days of spud date;
- File acreage attribution plat according to field proration orders;
- Notify appropriate district office 48 hours prior to workover or re-entry;
- Submit plugging report (CP-4) after plugging is completed;
- Obtain written approval before disposing or injecting salt water.

3
28
5w

IN ALL CASES PLOT THE INTENDED WELL ON THE PLAT BELOW

Plat of acreage attributable to a well in a prorated or spaced field

If the intended well is in a prorated or spaced field, please fully complete this side of the form. If the intended well is in a prorated or spaced field complete the plat below showing that the well will be properly located in relationship to other wells producing from the common source of supply. Please show all the wells and within 1 mile of the boundaries of the proposed acreage attribution unit for gas wells and within 1/2 mile of the boundaries of the proposed acreage attribution unit for oil wells.

API No. 15 - _____
 Operator: Lario Oil & Gas Company
 Lease: P. Brown "A"
 Well Number: 2-3
 Field: Wildcat

Location of Well: County: Kingman

 1650 feet from (S) / N (circle one) Line of Section

 990 feet from (E) / W (circle one) Line of Section
 Sec. 03 Twp. 28 S. R. 5 East West

Number of Acres attributable to well: 80
 QTR / QTR / QTR of acreage: SW - NE - SE

Is Section Regular or _____ Irregular

If Section is Irregular, locate well from nearest corner boundary.
 Section corner used: ___NE ___NW ___SE ___SW

PLAT

*(Show location of the well and shade attributable acreage for prorated or spaced wells.)
 (Show footage to the nearest lease or unit boundary line.)*

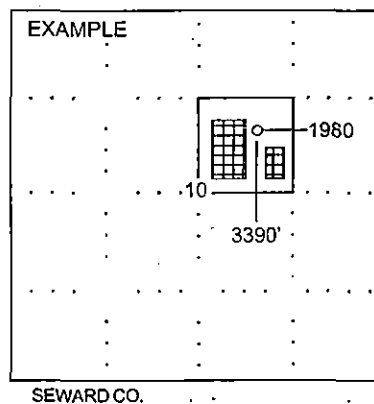
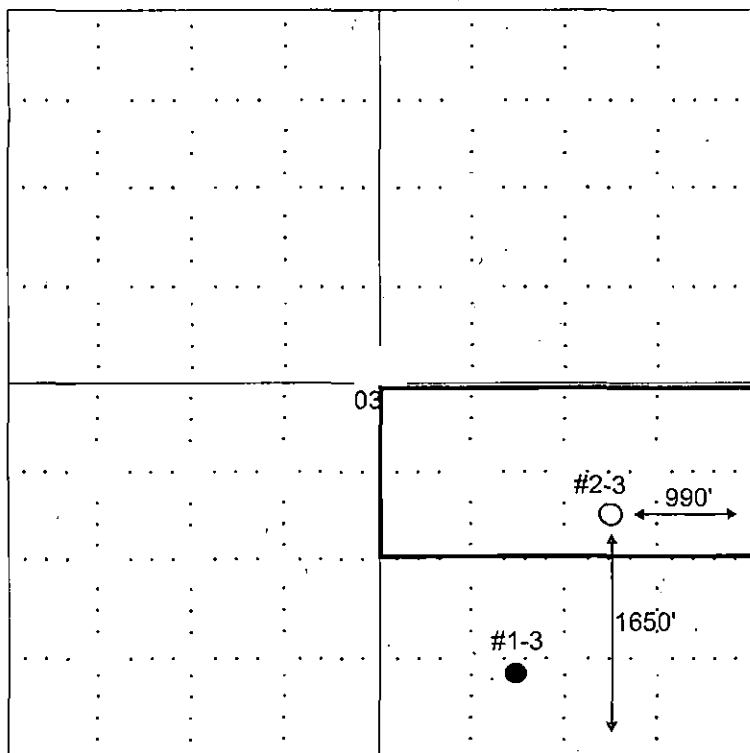

NOTE: In all cases locate the spot of the proposed drilling location.

In plotting the proposed location of the well, you must show:

1. The manner in which you are using the depicted plat by identifying section lines, i.e. 1 section, 1 section with 8 surrounding sections, 4 sections, etc.
2. The distance of the proposed drilling location from the section's south / north and east / west.
3. The distance to the nearest lease or unit boundary line.
4. If proposed location is located within a prorated or spaced field a certificate of acreage attribution plat must be attached: (CO-7 for oil wells; CG-8 for gas wells).