

"OWWO"

fax

FOR KCC USE:

FORM C-1 7/91

FORM MUST BE TYPED

FORM MUST BE SIGNED

ALL BLANKS MUST BE FILLED

EFFECTIVE DATE: 11-2-94
DISTRICT # 2
SEAT Yes No

State of Kansas
NOTICE OF INTENTION TO DRILL

Must be approved by the K.C.C. five (5) days prior to commencing well

Expected Spud Date Oct. 20, 1994
month day year

Spot East
NW SE Sec 27. Twp 28. S. Rg 6. X West

OPERATOR: License # 5428
Name: Graves Drilling Co., Inc.
Address: P.O. Box 8250
City/State/Zip: Wichita, KS 67208
Contact Person: Fredrick W. Stump
Phone: (316) 687-2777

1980' feet from South / West line of Section
1980' feet from East / West line of Section
IS SECTION X REGULAR IRREGULAR?

(NOTE: Locate well on the Section Plat on Reverse Side)
County: Kingman
Lease Name: Sowers Well #: 1
Field Name: Wildcat

CONTRACTOR: License #: 5929
Name: Duke Drilling Co., Inc.

Is this a Prorated/Spaced Field? yes X no
Target Formation(s): Mississippian
Nearest lease or unit boundary: 660'

Well Drilled For: Well Class: Type Equipment:
X Oil Enh Rec Infield X Mud Rotary
Gas Storage Pool Ext. Air Rotary
X OWVO Disposal X Wildcat Cable
Seismic; # of Holes Other

Ground Surface Elevation: 1480 feet HSL
Water well within one-quarter mile: yes X no
Public water supply well within one mile: yes X no
Depth to bottom of fresh water: 45'

If OWVO: old well information as follows:
Operator: Comet Petroleum Corp.
Well Name: Bolinger #1
Comp. Date: 11-29-69 Old Total Depth: 3997'

Depth to bottom of usable water: 180'
Surface Pipe by Alternate: 1 2
Length of Surface Pipe set: 250' set.
Length of Conductor pipe required: none
Projected Total Depth: 4050'

Directional, Deviated or Horizontal wellbore? yes X no
If yes, true vertical depth:
Bottom Hole Location:

Formation at Total Depth: Mississippi
Water Source for Drilling Operations:
well X farm pond other
DWR Permit #:
Will Cores Be Taken? yes X no
If yes, proposed zone:

AFFIDAVIT

The undersigned hereby affirms that the drilling, completion and eventual plugging of this well will comply with K.S.A. 55-101, et. seq.
It is agreed that the following minimum requirements will be met:

RECEIVED
OCT 07 1994
KANSAS

1. Notify the appropriate district office prior to spudding of well;
2. A copy of the approved notice of intent to drill shall be posted on each drilling rig;
3. The minimum amount of surface pipe as specified below shall be set by circulating cement to the top; in all cases surface pipe shall be set through all unconsolidated materials plus a minimum of 20 feet into the underlying formation;
4. If the well is dry hole, an agreement between the operator and the district office on plug length and placement is necessary prior to plugging;
5. The appropriate district office will be notified before well is either plugged or production casing is cemented in;
6. IF AN ALTERNATE IS COMPLETED, PRODUCTION PIPE SHALL BE CEMENTED FROM BELOW ANY USABLE WATER TO SURFACE WITHIN 120 DAYS OF SPUD DATE. IN ALL CASES, NOTIFY DISTRICT OFFICE PRIOR TO ANY CEMENTING.

I hereby certify that the statements made herein are true and to the best of my knowledge and belief.

Date: Oct. 4, 1994 Signature of Operator or Agent: Fredrick W. Stump Title: Exploration Mgr.

FOR KCC USE:

API # 15- 095-20188-00-02

Conductor pipe required NONE feet

Minimum surface pipe required 250' feet per Alt. OX

Approved by: CB 10-28-94

This authorization expires: 4-28-95

(This authorization void if drilling not started within 6 months of effective date.)

Spud date: Agent:

REMEMBER TO:

- File Drill Pit Application (form CDP-1) with Intent to Drill;
- File Completion Form ACO-1 within 120 days of spud date;
- File acreage attribution plat according to field proration orders;
- Notify appropriate district office 48 hours prior to workover or re-entry;
- Submit plugging report (CP-4) after plugging is completed;
- Obtain written approval before disposing or injecting salt water.

Mail to: Conservation Division, 200 Colorado Derby Building, 202 W. First St., Wichita, Kansas 67202-1286.

27
28
6

IN ALL CASES PLOT THE INTENDED WELL ON THE PLAT BELOW

PLAT OF ACREAGE ATTRIBUTABLE TO A WELL IN A PRORATED OR SPACED FIELD

If the intended well is in a prorated or spaced field, please fully complete this side of the form. If the intended well is in a prorated or spaced field complete the plat below showing that the well will be properly located in relationship to other wells producing from the common source of supply. Please show all the wells within 1 mile of the boundaries of the proposed acreage attribution unit for gas wells and within 1/2 mile of the boundaries of the proposed acreage attribution unit for oil wells.

API NO. 15- _____
OPERATOR Graves Drilling Co., Inc.
LEASE Sowers
WELL NUMBER 1
FIELD Wildcat

LOCATION OF WELL: COUNTY Kingman
1980 feet from south/~~north~~ line of section
1980 feet from east/~~west~~ line of section
SECTION 27 TWP 28S RG 6W

NUMBER OF ACRES ATTRIBUTABLE TO WELL 40
QTR/QTR/QTR OF ACREAGE C - NW - SE

IS SECTION x REGULAR or IRREGULAR
IF SECTION IS IRREGULAR, LOCATE WELL FROM NEAREST CORNER BOUNDARY.

Section corner used: NE NW SE SW

PLAT

(Show location of the well and shade attributable acreage for prorated or spaced wells.)
(Show footage to the nearest lease or unit boundary line.)

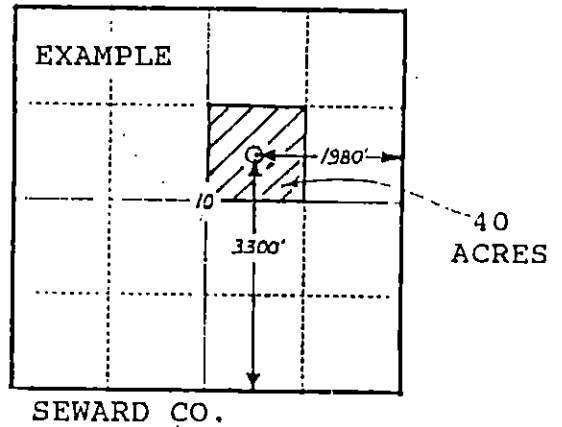
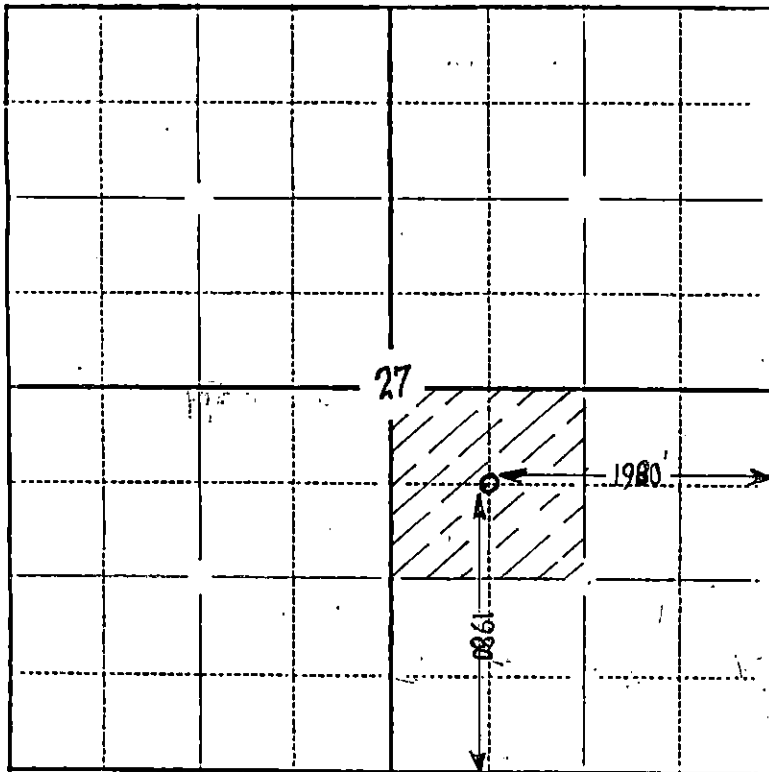

In plotting the proposed location of the well, you must show:

- 1) The manner in which you are using the depicted plat by identifying section lines, i.e. 1 section, 1 section with 8 surrounding sections, 4 sections, etc.;
- 2) the distance of the proposed drilling location from the section's south/north and east/west lines; and
- 3) the distance to the nearest lease or unit boundary line.