

OWWO

For KCC Use: 3-29-03  
Effective Date: 3-29-03  
District #: 2  
SGA?  Yes  No

KANSAS CORPORATION COMMISSION  
OIL & GAS CONSERVATION DIVISION  
**NOTICE OF INTENT TO DRILL**

Form C-1  
September 1999  
Form must be Typed  
Form must be Signed  
All blanks must be Filled

Must be approved by KCC five (5) days prior to commencing well

Expected Spud Date April 24, 2003  
month day year

OPERATOR: License# 5214  
Name: Lario Oil & Gas Company  
Address: 301 South Market  
City/State/Zip: Wichita, KS 67202  
Contact Person: Jay G. Schweikert  
Phone: 316-265-5611

CONTRACTOR: License# 5929  
Name: Duke Drilling Co., Inc.

Well Drilled For:  Oil  Enh Rec  Infield  Mud Rotary  
 Gas  Storage  Pool Ext.  Air Rotary  
 OWWO  Disposal  Wildcat  Cable  
 Seismic; # of Holes  Other  
 Other

If OWWO: old well information as follows:  
Operator: Graves Drilling Co.  
Well Name: Jones #1  
Original Completion Date: 6/05/91 Original Total Depth: 3870

Directional, Deviated or Horizontal wellbore?  Yes  No  
If Yes, true vertical depth: \_\_\_\_\_  
Bottom Hole Location: \_\_\_\_\_  
KCC DKT #: \_\_\_\_\_

RECEIVED

MAR 21 2003

**KCC WICHITA AFFIDAVIT**

The undersigned hereby affirms that the drilling, completion and eventual plugging of this well will comply with K.S.A. 55-101, et. seq.  
It is agreed that the following minimum requirements will be met:

1. Notify the appropriate district office **prior** to spudding of well;
2. A copy of the approved notice of intent to drill **shall be** posted on each drilling rig;
3. The minimum amount of surface pipe as specified below **shall be set** by circulating cement to the top; in all cases surface pipe **shall be set** through all unconsolidated materials plus a minimum of 20 feet into the underlying formation.
4. If the well is dry hole, an agreement between the operator and the district office on plug length and placement is necessary **prior to plugging**;
5. The appropriate district office will be notified before well is either plugged or production casing is cemented in;
6. If an ALTERNATE II COMPLETION, production pipe shall be cemented from below any usable water to surface within **120 days** of spud date. **In all cases, NOTIFY district office** prior to any cementing.

I hereby certify that the statements made herein are true and to the best of my knowledge and belief.

Date: 03/20/03 Signature of Operator or Agent: Jay G. Schweikert Title: Operations Engineer  
Jay G. Schweikert

For KCC Use ONLY  
API # 15 - 095-21646-00-01  
Conductor pipe required NONE feet  
Minimum surface pipe required 257 feet per Alt. 1 2  
Approved by: RJP 3-24-03  
This authorization expires: 9-24-03  
(This authorization void if drilling not started within 6 months of effective date.)  
Spud date: \_\_\_\_\_ Agent: \_\_\_\_\_

Spot  East  
NW - NW - NE Sec. 12 Twp. 28 S. R. 5  West  
330 feet from S / N (circle one) Line of Section  
2310 feet from E / W (circle one) Line of Section  
Is SECTION  Regular  Irregular?

(Note: Locate well on the Section Plat on reverse side)

County: Kingman  
Lease Name: Robert Jones Well #: 1-12 RE  
Field Name: Broadway

Is this a Prorated / Spaced Field?  Yes  No  
Target Formation(s): Mississippian

Nearest Lease or unit boundary: 330 ft  
Ground Surface Elevation: 1406 feet MSL

Water well within one-quarter mile:  Yes  No  
Public water supply well within one mile:  Yes  No

Depth to bottom of fresh water: 45 ft  
Depth to bottom of usable water: 180 ft

Surface Pipe by Alternate: 1 2  
Length of Surface Pipe Planned to be set: 257 in place ok

Length of Conductor Pipe required: NONE  
Projected Total Depth: 3870 ft

Formation at Total Depth: Mississippian  
Water Source for Drilling Operations:  
Well \_\_\_\_\_ Farm Pond \_\_\_\_\_ Other X

DWR Permit #: \_\_\_\_\_  
(Note: Apply for Permit with DWR )

Will Cores be taken?  Yes  No  
If Yes, proposed zone: \_\_\_\_\_

- Remember to:
- File Drill Pit Application (form CDP-1) with Intent to Drill;
  - File Completion Form ACO-1 within 120 days of spud date;
  - File acreage attribution plat according to field proration orders;
  - Notify appropriate district office 48 hours prior to workover or re-entry;
  - Submit plugging report (CP-4) after plugging is completed;
  - Obtain written approval before disposing or injecting salt water.

12 28 54

**IN ALL CASES PLOT THE INTENDED WELL ON THE PLAT BELOW**

*Plat of acreage attributable to a well in a prorated or spaced field*

*If the intended well is in a prorated or spaced field, please fully complete this side of the form. If the intended well is in a prorated or spaced field complete the plat below showing that the well will be properly located in relationship to other wells producing from the common source of supply. Please show all the wells and within 1 mile of the boundaries of the proposed acreage attribution unit for gas wells and within 1/2 mile of the boundaries of the proposed acreage attribution unit for oil wells.*

API No. 15 - \_\_\_\_\_  
 Operator: Lario Oil & Gas Company  
 Lease: Robert Jones  
 Well Number: 1-12 RE  
 Field: Broadway

Location of Well: County: Kingman  
 \_\_\_\_\_ 330 \_\_\_\_\_ feet from S N (circle one) Line of Section  
 \_\_\_\_\_ 2310 \_\_\_\_\_ feet from E / W (circle one) Line of Section  
 Sec. 12 Twp. 28 S. R. 5  East  West

Number of Acres attributable to well: 160  
 QTR / QTR / QTR of acreage: NW - NW - NE

Is Section  Regular or \_\_\_\_\_ Irregular  
**If Section is Irregular, locate well from nearest corner boundary.**  
 Section corner used:    NE    NW    SE    SW

**PLAT**

*(Show location of the well and shade attributable acreage for prorated or spaced wells.)  
 (Show footage to the nearest lease or unit boundary line.)*

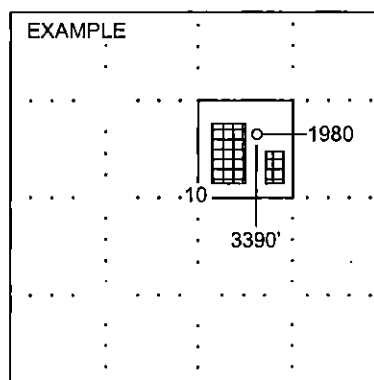
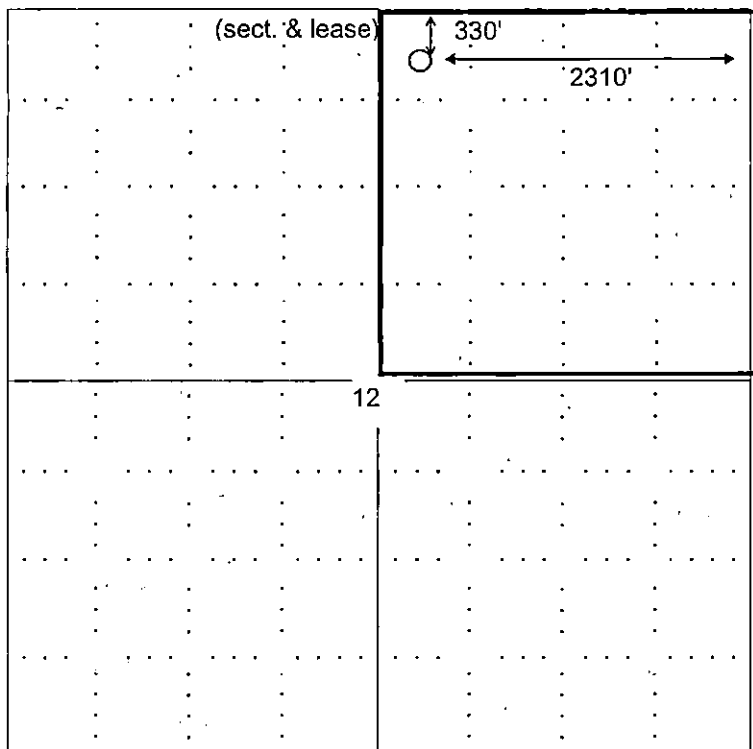

**NOTE: In all cases locate the spot of the proposed drilling location.**

**In plotting the proposed location of the well, you must show:**

1. The manner in which you are using the depicted plat by identifying section lines, i.e. 1 section, 1 section with 8 surrounding sections, 4 sections, etc.
2. The distance of the proposed drilling location from the section's south / north and east / west.
3. The distance to the nearest lease or unit boundary line.
4. If proposed location is located within a prorated or spaced field a certificate of acreage attribution plat must be attached: (C0-7 for oil wells; CG-8 for gas wells).