

EFFECTIVE DATE: 2-21-2000
DISTRICT # 2
SGA? YES NO

State of Kansas
NOTICE OF INTENTION TO DRILL

FORM MUST BE TYPED
FORM MUST BE SIGNED
ALL BLANKS MUST BE FILLED

Must be approved by the K.C.C. five (5) days prior to commencing well

EXPECTED SPUD DATE February 21, 2000
month day year

Spot 225' E of
NW NW NW Sec. 13 Twp 28 S R 5 W

OPERATOR: License #: 5428
Name: Graves Drilling Co., Inc.
Address: P.O. Box 8250
City/State/Zip: Wichita, KS 67208
Contact Person: Fredrick W. Stump
Phone: (316) 687-2777

330 feet from North Line of Section
555 feet from West Line of Section
IS SECTION REGULAR IRREGULAR?
(Note: Locate well on the Section Plat on Reverse Side)
County: KINGMAN
Lease Name: GOWIN WELL #: 1
Field Name: VINITA POOL

CONTRACTOR: License #: 5929
Name: Duke Drilling Company

Is this a Prorated/Spaced Field: Yes No
Target Formation(s): Mississippian
Nearest Lease or Unit Boundary: 330'
Ground Surface Elevation: @1384 feet MSL
Water well within one-quarter mile: Yes No
Public water supply well within one mile: Yes No
Depth to bottom of fresh water: 70'
Depth to bottom of usable water: 180'
Surface Pipe by Alternate: 1 2
Length of Surface Pipe Planned to be set: 240'
Length of Conductor pipe required: NONE
Projected Total Depth: 3900'
Formation at Total Depth: Mississippi

Well Drilled For: Well Class: Type Equipment:
 Oil Enh Rec Infield Mud Rotary
 Gas Storage Pool Ext. Air Rotary
 OWWO Disposal Wildcat Cable
 Seismic # of Holes Other

Water Source for Drilling Operations:
well farm pond other

If OWWO: old well information as follows:
Operator: _____
Well Name: _____
Comp. Date: _____ Old Total Depth _____

DWR Permit #: _____
Will Cores Be Taken? Yes No
If yes, proposed zone: _____

Directional, Deviated or Horizontal wellbore? Yes No
if yes, true vertical depth: _____
Bottom Hole Location: _____

AFFIDAVIT

The undersigned hereby affirms that the drilling, completion and eventual plugging of this well will comply with K.S.A. 55-101, et. seq.
It is agreed that the following minimum requirements will be met:

1. Notify the appropriate district office prior to spudding of well;
 2. A copy of the approved notice of intent to drill shall be posted on each drilling rig;
 3. The minimum amount of surface pipe as specified below shall be set by circulating cement to the top: in all cases surface pipe shall be set through all unconsolidated materials plus a minimum of 20 feet into the underlying formation;
 4. If the well is dry hole, an agreement between the operator and the district office on plug length and placement is necessary prior to plugging;
 5. The appropriate district office will be notified before well is either plugged or production casing is cemented in;
 6. IF AN ALTERNATE II COMPLETION. PRODUCTION PIPE SHALL BE CEMENTED FROM BELOW ANY USABLE WATER TO SURFACE WITHIN 120 DAYS OF SPUD DATE. IN ALL CASES, NOTIFY DISTRICT OFFICE PRIOR TO ANY CEMENTING.
- I hereby certify that the statements made herein are true and to the best of my knowledge and belief.

Date 2/14/00 Signature of Operator or Agent: Dolly S. Byers

Title: Agent

FOR KCC USE:	
API #15-	<u>095-21761 0000</u>
Conductor pipe required	<u>NONE</u> feet
Minimum surface pipe required	<u>200</u> ft per Alt. <input checked="" type="checkbox"/>
Approved by:	<u>JK 2-16-2000</u>
This authorization expires: <u>8-16-2000</u>	
(This authorization void if drilling not started within 6 months of effective date.)	
Spud date:	Agent: _____

REMEMBER TO:

- File Drill Pit Application (form CDP-1) with Intent to Drill;
- File Completion Form ACO-1 within 120 days of spud date;
- File acreage attribution plat according to field proration orders;
- Submit plugging report (CP-4) after plugging is completed;
- Obtain written approval before disposing or injecting salt water.

Mall to: Conservation Division, 130 S. Market, Wichita, KS 67202

RECEIVED
KANSAS CORPORATION COMMISSION

FEB 14 2000

CONSERVATION DIVISION
WICHITA, KS

13
28
5W

PLAT OF ACREAGE ATTRIBUTABLE TO A WELL IN A PRORATED OR SPACED FIELD

If the intended well is in a prorated or spaced field, please fully complete this side of the form.

If the intended well is in a prorated or spaced field complete the plat below showing that the well will be properly located in relationship to other wells producing from the common source of supply. Please show all the wells within 1 mile of the boundaries of the proposed acreage attribution unit for gas wells and within 1/2 mile of the boundaries of the proposed acreage attribution unit for oil wells.

API NO. 15 - _____
 OPERATOR Graves Drilling Co., Inc.
 LEASE GOWIN
 WELL NUMBER 1
 FIELD VINITA POOL

LOCATION OF WELL: COUNTY KINGMAN
 _____ 330 feet from North Line of Section
 _____ 555 feet from West Line of Section
 _____ Sec. 13 Twp 28 S R 5 W

NUMBER OF ACRES ATTRIBUTABLE TO WELL 10
 QTR/QTR/QTR OF ACREAGE NW NW NW

IS SECTION X REGULAR OR IRREGULAR
 IF SECTION IS IRREGULAR, LOCATE WELL FROM
NEAREST CORNER BOUNDARY.
 SECTION CORNER USED: NE NW SE SW

PLAT

(Show location of the well and shade attributable acreage for prorated or spaced wells.)
 (Show footage to the nearest lease or unit boundary line.)

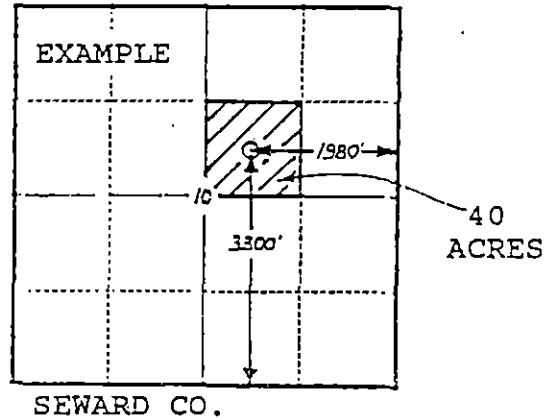
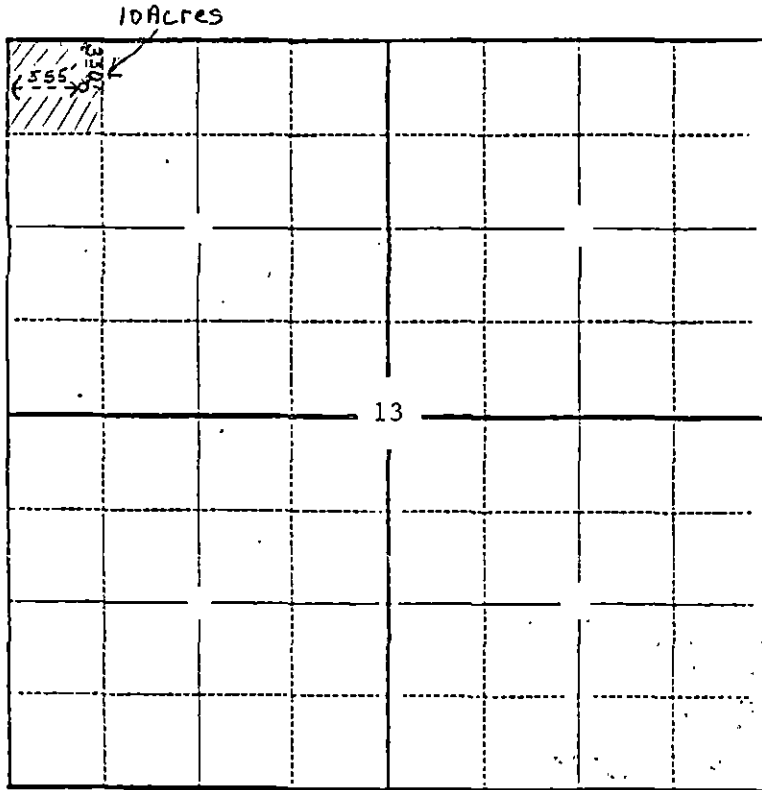

KINGMAN COUNTY

In plotting the proposed location of the well, you must show:

- 1) The manner in which you are using the depicted plat by identifying section lines, i.e. 1 section, 1 section with 8 surrounding sections, r sections, etc.:
- 2) The distance of the proposed drilling location from the section's south/north and east/west lines; and
- 3) The distance to the nearest lease or unit boundary line.