

EFFECTIVE DATE: 12-8-97

State of Kansas

FORM MUST BE TYPED

DISTRICT # 2

NOTICE OF INTENTION TO DRILL

FORM MUST BE SIGNED

SGA? X Yes... No

Must be approved by the K.C.C. five (5) days prior to commencing well.

ALL BLANKS MUST BE FILLED

Expected Spud Date 12 3 97
month day year

Spot NE - NW - SW. Sec 11. Twp 27. S, Rg 10. X East West

OPERATOR: License # 31739
Name: Iuka Carmi Development, LLC.
Address: P.O. Box 847
City/State/Zip: Pratt, Ks 67124
Contact Person: Ken Gates
Phone: (316) 672-2531

2310 feet from South / North line of Section
990 feet from East / West line of Section
IS SECTION X REGULAR IRREGULAR?

CONTRACTOR: License #: 30141
Name: Summit Drilling Co.

(NOTE: Locate well on the Section Plat on Reverse Side)
County: Kingman
Lease Name: Wingate Well #: 1
Field Name: Dresden
Is this a Prorated/Spaced Field? yes XX no
Target Formation(s): Towanda
Nearest lease or unit boundary: 330
Ground Surface Elevation: 1751 feet MSL
Water well within one-quarter mile: yes XX no
Public water supply well within one mile: yes XX no
Depth to bottom of fresh water: 150
Depth to bottom of usable water: 200
Surface Pipe by Alternate: X 1 250²
Length of Surface Pipe Planned to be set: 1750
Length of Conductor pipe required: 1750
Projected Total Depth: 1750
Formation at Total Depth: Towanda
Water Source for Drilling Operations:
XX well farm pond other

Well Drilled For: Well Class: Type Equipment:
XX Oil XX Gas XX OWWO XX Seismic; XX Other
X Enh Rec X Infield X Mud Rotary
X Storage X Pool Ext. X Air Rotary
X Disposal X Wildcat X Cable
X # of Holes X Other

If OWWO: old well information as follows:
Operator: Summit Drilling Co.
Well Name: Wingate
Comp. Date: 12-3-97 Old Total Depth 1750

Directional, Deviated or Horizontal wellbore? yes XX no
If yes, true vertical depth: 1750
Bottom Hole Location: Kingman

Will Cores Be Taken?: yes no
If yes, proposed zone: Kingman

AFFIDAVIT

The undersigned hereby affirms that the drilling, completion and eventual plugging of this well will comply with K.S.A. 55-101, et. seq.

It is agreed that the following minimum requirements will be met:

- 1. Notify the appropriate district office prior to spudding of well;
- 2. A copy of the approved notice of intent to drill shall be posted on each drilling rig;
- 3. The minimum amount of surface pipe as specified below shall be set by circulating cement to the top; in all cases surface pipe shall be set through all unconsolidated materials plus a minimum of 20 feet into the underlying formation;
- 4. If the well is dry hole, an agreement between the operator and the district office on plug length and placement is necessary prior to plugging;
- 5. The appropriate district office will be notified before well is either plugged or production casing is cemented in;
- 6. IF AN ALTERNATE II COMPLETION, PRODUCTION PIPE SHALL BE CEMENTED FROM BELOW ANY USABLE WATER TO SURFACE WITHIN 120 DAYS OF SPUD DATE. IN ALL CASES, NOTIFY DISTRICT OFFICE PRIOR TO ANY CEMENTING.

I hereby certify that the statements made herein are true and to the best of my knowledge and belief.

Date: 12/2/97 Signature of Operator or Agent: Leigh Raymond Title: Exp. Manager

FOR KCC USE:
API # 15- 095-21740 0000
Conductor pipe required NONE feet
Minimum surface pipe required 220 feet per Alt. (1) X
Approved by: JK 12-3-97
This authorization expires: 6-3-98
(This authorization void if drilling not started within 6 months of effective date.)
Spud date: _____ Agent: _____

RECEIVED
KANSAS CORPORATION COMMISSION

DEC 02 1997

CONSERVATION DIVISION
WICHITA, KS

REMEMBER TO:

- File Drill Pit Application (form CDP-1) with Intent to Drill;
- File Completion Form ACO-1 within 120 days of spud date;
- File acreage attribution plat according to field proration orders;
- Notify appropriate district office 48 hours prior to workover or re-entry;
- Submit plugging report (CP-4) after plugging is completed;
- Obtain written approval before disposing or injecting salt water.

IN ALL CASES PLOT THE INTENDED WELL ON THE PLAT BELOW

PLAT OF ACREAGE ATTRIBUTABLE TO A WELL IN A PRORATED OR SPACED FIELD

If the intended well is in a prorated or spaced field, please fully complete this side of the form. If the intended well is in a prorated or spaced field complete the plat below showing that the well will be properly located in relationship to other wells producing from the common source of supply. Please show all the wells within 1 mile of the boundaries of the proposed acreage attribution unit for gas wells and within 1/2 mile of the boundaries of the proposed acreage attribution unit for oil wells.

API NO. 15- _____
 OPERATOR Iuka Carmi Development, LLC. LOCATION OF WELL: COUNTY Kingman
 LEASE Wingate 2130 feet from south/~~north~~ line of section
 WELL NUMBER 1 990 feet from east/~~west~~ line of section
 FIELD Dresden SECTION 11 TWP 27 RG 10w

NUMBER OF ACRES ATTRIBUTABLE TO WELL _____ IS SECTION XX REGULAR or _____ IRREGULAR
 QTR/QTR/QTR OF ACREAGE _____ IF SECTION IS IRREGULAR, LOCATE WELL FROM NEAREST
CORNER BOUNDARY.

Section corner used: _____ NE _____ NW _____ SE _____ SW

PLAT

(Show location of the well and shade attributable acreage for prorated or spaced wells.)
 (Show footage to the nearest lease or unit boundary line.)

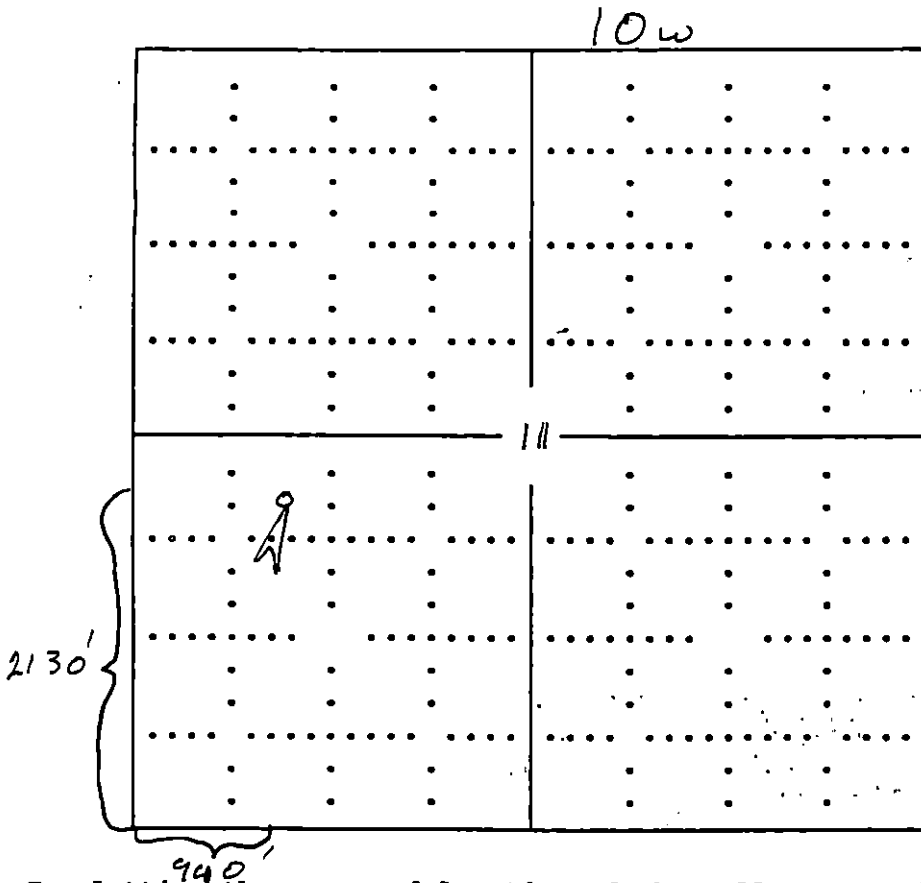

27s

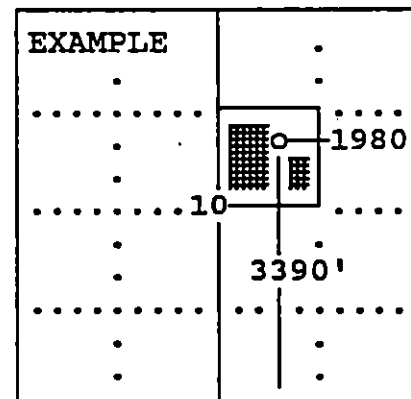

SEWARD CO.

In plotting the proposed location of the well, you must show:

- 1) The manner in which you are using the depicted plat by identifying section lines, i.e. 1 section, 1 section with 8 surrounding sections, 4 sections, etc.;
- 2) the distance of the proposed drilling location from the section's south/north and east/west; and
- 3) the distance to the nearest lease or unit boundary line.