

STATE OF KANSAS  
STATE CORPORATION COMMISSION

15-165-20831-0000

WELL PLUGGING RECORD

Give All Information Completely  
Make Required Affidavit  
Mail or Deliver Report to  
Conservation Division  
State Corporation Comm.  
245 North Water  
Wichita, KS 67202

Reno County, Sec. 34 Twp. 23S Rge. 4W E/W  
Location as "NE/CNW $\frac{1}{4}$ /SW $\frac{1}{4}$ " or footage from lines

NE SW NE

Lease Owner Western Drilling & Exploration, Inc.  
Lease Name Graber Well No. 2  
Office Address 439 Wheatland Place Wichita, Ks. 67235  
Character of Well (Completed as Oil, Gas or Dry Hole) Dry Hole

Date Well completed 10-21 19 81  
Application for plugging filed 10-21 19 81  
Application for plugging approved 10-21 19 81  
Plugging commenced 10-21 19 81  
Plugging completed 10-21 19 81

Reason for abandonment of well or producing formation Dry Hole

If a producing well is abandoned, date of last production 19

Was permission obtained from the Conservation Division or its agents before plugging was commenced? Yes

Name of Conservation Agent who supervised plugging of this well Gilbert Toman  
Producing formation \_\_\_\_\_ Depth to top \_\_\_\_\_ Bottom \_\_\_\_\_ Total Depth of Well \_\_\_\_\_  
Show depth and thickness of all water, oil and gas formations.

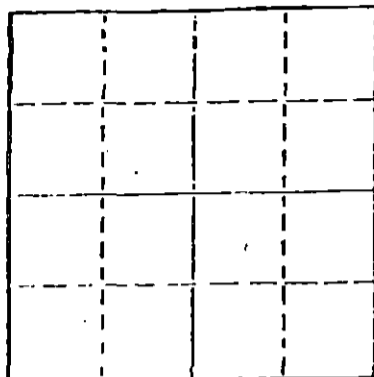

Locate well correctly on above Section Plot

OIL, GAS OR WATER RECORDS

CASING RECORD

FORMATION	CONTENT	FROM	TO	SIZE	PUT IN	PULLED OUT
Surface				8 5/8"	199'	in place
Surface				8 5/8"	597'	in place

Describe in detail the manner in which the well was plugged, indicating where the mud fluid was placed and the method or methods used in introducing it into the hold. If cement or other plugs were used, state the character of same and depth placed, from \_\_\_\_\_ feet to \_\_\_\_\_ feet for each plug set.

Plug #1 @ 580' 40 sacks cement  
Plug #2 @ 40' 10 sacks cement  
10 sacks cement in Rathole

(If additional description is necessary, use BACK of this sheet)

Name of Plugging Contractor Aspen Oil, Inc. Exploration 10-27-81

STATE OF Kansas COUNTY OF Sedgwick  
Stephanie Black (employee of Contractor, ss. ~~XXXXXX~~ or ~~XXXXXX~~)

of the above-described well, being first duly sworn on oath, says: That I have knowledge of the facts, statements, and matters herein contained and the log of the above-described well as filed and that the same are true and correct. So help me God.

(Signature) Stephanie R. Black  
7401 E. Kellogg #575 (Wichita, KS) 67207  
(Address)

SUBSCRIBED AND SWORN TO before me this 26th day of October, 1981

My commission expires July 19, 1983



Virginia Anne Shant  
Notary Public.

KANSAS

WELL COMPLETION REPORT AND DRILLER'S LOG

API No. 15 — Reno County — 155 — 20831-0000 Number

S. 34 T. 23S R. 4W E W  
Loc. \_\_\_\_\_  
County Reno

Operator Western Drilling & Exploration, Inc.

Address 439 Wheatland Place Wichita, Kansas 67235

Well No. #2 Lease Name Graber

Footage Location  
feet from (N) (S) line feet from (E) (W) line

Principal Contractor Aspen Oil, Inc. Exploration Geologist \_\_\_\_\_

Spud Date 10-4-81 Date Completed 10-21-81 Total Depth 3623' P.B.T.D. \_\_\_\_\_

Directional Deviation \_\_\_\_\_ Oil and/or Gas Purchaser \_\_\_\_\_

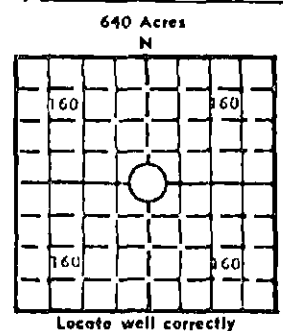

Elev.: Gr. \_\_\_\_\_  
DF \_\_\_\_\_ KB \_\_\_\_\_

CASING RECORD

Report of all strings set — surface, intermediate, production, etc.

Purpose of string	Size hole drilled	Size casing set (in O.D.)	Weight lbs/ft.	Setting depth	Type cement	Sacks	Type and percent additives
Surface	15"	10 3/4"		199'	common	200	3% c.c.
Surface	9 7/8"	8 5/8"		597'	common	125	3% c.c.
Production	7 7/8"			Plugged Hole			

LINER RECORD

PERFORATION RECORD

Top, ft.	Bottom, ft.	Sacks cement	Shots per ft.	Size & type	Depth interval

TUBING RECORD

Size	Setting depth	Packer set at

ACID, FRACTURE, SHOT, CEMENT SQUEEZE RECORD

Amount and kind of material used	Depth interval treated

INITIAL PRODUCTION

Date of first production		Producing method (flowing, pumping, gas lift, etc.)			
RATE OF PRODUCTION PER 24 HOURS	Oil	Gas	Water	Gas-oil ratio	CFPD
	bbls.	MCF	bbls.		
Disposition of gas (vented, used on lease or sold)			Producing interval (s)		

RECEIVED  
STATE CORPORATION COMMISSION  
OCT 27 1981  
CONSERVATION DIVISION  
Wichita, Kansas

INSTRUCTIONS: As provided in KCC Rule 82-2-125, within 90 days after completion of a well, one completed copy of this Drillers Log shall be transmitted to the State Geological Survey of Kansas, 4150 Monroe Street, Wichita, Kansas 67209. Copies of this form are available from the Conservation Division, State Corporation Commission, 245 No. Water, Wichita, Kansas 67202. Phone AC 316-522-2206. If confidential custody is desired, please note Rule 82-2-125. Drillers Logs will be on an open file in the Oil and Gas Division, State Geological Survey of Kansas, Lawrence, Kansas 66044.

Operator Western Drilling & Exploration, Inc.		DESIGNATE TYPE OF COMP.: OIL, GAS, DRY HOLE, SWDW, ETC.:
Well No. #2	Lease Name Graber	
S 34 T 23S R 4W E W		

**WELL LOG**

Show all important zones of porosity and contents thereof; cored intervals, and all drill-stem tests, including depth interval tested, cushion used, time tool open, flowing and shut-in pressures, and recoveries.

SHOW GEOLOGICAL MARKERS, LOGS RUN, OR OTHER DESCRIPTIVE INFORMATION.

FORMATION DESCRIPTION, CONTENTS, ETC.	TOP	BOTTOM	NAME	DEPTH
Surface Hole	0'	144'		
Sand	144'	1090'		
Sand & Shale	1090'	2079'		
Shale & Lime	2079'	2239'		
Shale	2239'	2539'		
Lime & Shale	2539'	3298'		
Shale & Chert	3298'	3534'		
Shale	3534'	3590'		
Shale & Lime	3590'	3623'		

RECEIVED  
 STATE CORPORATION COMMISSION  
 OCT 27 1981  
 CONSERVATION DIVISION  
 Wichita Kansas

USE ADDITIONAL SHEETS, IF NECESSARY, TO COMPLETE WELL RECORD.

Date Received	Signature
	Title
	Date