

WELL PLUGGING RECORD

Give All Information Completely  
Make Required Affidavit  
Mail or Deliver Report to:  
Conservation Division  
State Corporation Commission  
211 No. Broadway  
Wichita, Kansas

Kingman County. Sec. 24 Twp. 28 Rge. (E) 8 (W)  
Location as "NE/CNW/SW" or footage from lines SE NE NE  
Lease Owner Excel Packing Co. Inc.  
Lease Name Garlisch Well No. 1  
Office Address 900 East 21st, Wichita, Kansas  
Character of Well (completed as Oil, Gas or Dry Hole) Dry Hole  
Date well completed December 17 1956  
Application for plugging filed December 17 1956  
Application for plugging approved December 17 1956  
Plugging commenced December 17 1956  
Plugging completed December 17 1956  
Reason for abandonment of well or producing formation Dry Hole

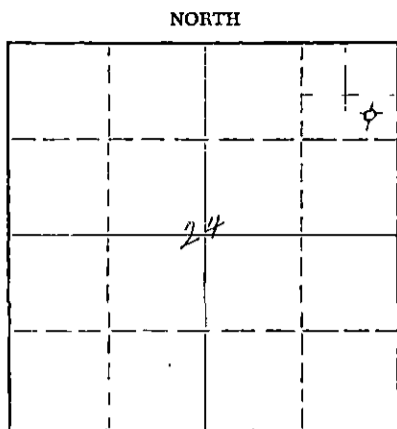

Locate well correctly on above Section Plat

If a producing well is abandoned, date of last production 19  
Was permission obtained from the Conservation Division or its agents before plugging was commenced? Yes

Name of Conservation Agent who supervised plugging of this well M. A. Rives R. M. Brandege  
Producing formation Depth to top Bottom Total Depth of Well 4192 Feet  
Show depth and thickness of all water, oil and gas formations.

OIL, GAS OR WATER RECORDS

CASING RECORD

FORMATION	CONTENT	FROM	TO	SIZE	PUT IN	PULLED OUT
				8 5/8"	155'	None

Describe in detail the manner in which the well was plugged, indicating where the mud fluid was placed and the method or methods used in introducing it into the hole. If cement or other plugs were used, state the character of same and depth placed, from feet to feet for each plug set.

4192 - 150 Heavy Rotary Mud  
150 - 100 Bridge, 1/2 sack hulls & 15 sacks cement  
100 - 40 Rotary Mud  
40 - Surface Bridge, 1/2 sack hulls & 10 sacks cement

RECEIVED  
STATE CORPORATION COMMISSION  
DEC 27 1956 12-27-56  
CONSERVATION DIVISION  
WICHITA, KANSAS

(If additional description is necessary, use BACK of this sheet)  
Name of Plugging Contractor Thos. H. Allan  
Address 925 Union Center, Wichita 2, Kansas

STATE OF KANSAS, COUNTY OF SEDGWICK, ss.  
Thos. H. Allan (employee of owner) or (owner or operator) of the above-described well, being first duly sworn on oath, says: That I have knowledge of the facts, statements, and matters herein contained and the log of the above-described well as filed and that the same are true and correct. So help me God.

(Signature) Thos. H. Allan  
925 Union Center, Wichita 2, Kansas  
(Address)

SUBSCRIBED AND SWORN TO before me this 20th day of December, 1956  
Ocie M. Stewart  
Notary Public.

My commission expires June 14, 1958

PLUGGING  
FILE SEC 24 T. 28 R. 8 W  
BOOK PAGE 127 LI E 3

15-095-00241-0000

8 Casing @ 155' - 150 Sx

EXCEL #1 GARLISCH  
SE NE NE 24-28-8W  
Kingman, County, Kansas  
COMM: 12/2/56 COMPL: 12/17/56  
CONTRACTOR: Tom Allan  
ELEV: 1630 RB

I.P. D & A

All Depths From Rotary Bushings

- 0 - 50 Sandy Soil
- 60 Yellow Clay
- 73 Sand
- 155 Red Beds
- 610 Red Shale
- 810 Shale Blue
- 1150 Salt & Shale
- 1380 Shale & Shells
- 1650 Lime
- 1875 Shale & Shells
- 1950 Shale
- 2150 Shale & Shells
- 2420 Shale
- 2750 Lime & Shale Beds
- 3114 Lime
- 3120 Black Shale
- 3150 Lime
- 3190 Shale
- 3210 Sand
- 3260 Shale
- 3330 Sand
- 3360 Shale
- 3820 Lime
- 3915 Shale & Shells
- 4071 Shale
- 4147 Chat
- 4175 Lime
- 4182 Dolomite
- 4192 (T.D.) Lime

FORMATION TOPS:

- 3114 Heebner
- 3360 Lansing
- 4071 Mississippi

I certify that the above is a true and correct copy of the well log on the above test.

Tom Allan

Subscribed and sworn to before me this 27th day of December, 1956

Oris M. Stewart  
Notary Public

My Commission expires June 14, 1958.

ED  
COMMISSION

DEC 27 1956

CONSERVATION DIVISION  
Wichita, Kansas

D.S.T. 4075-4090  
Gas to surface 6 min.  
180' GC Mud, 120' Muddy G C Water  
1455 BHP

D.S.T. 4091-4106  
Gas to surface in 23 min.  
180' GC Mud, 150' Muddy Water  
1520 BHP

Schlumberger Elec. Log @ 4192

PLUGGING  
FILE SEC 24 T. 28 R. 8W  
BOOK PAGE 127 LINE 3