

PLAT AND CERTIFICATION OF ACREAGE ATTRIBUTABLE TO AN OIL WELL

State Corporation Commission, Conservation Division
200 Colorado Derby Bldg. Wichita, Kansas 67202

*Rec'd
4-2-87*

OPERATOR Falcon Exploration Inc.

LOCATION OF WELL:

LEASE Linnebur

3630 feet from the S line
1650 feet from the E line
Of the _____ of Sec 11 T.29 R.1W

WELL NUMBER 1

FIELD Fenster Pool

COUNTY Sedgwick

*NUMBER OF ACRES
ATTRIBUTABLE TO WELL _____

DESCRIPTION OF ACREAGE:

PLAT

(Show location of Well and outline attributable acreage)
(Show footage to nearest lease or unit boundary line)

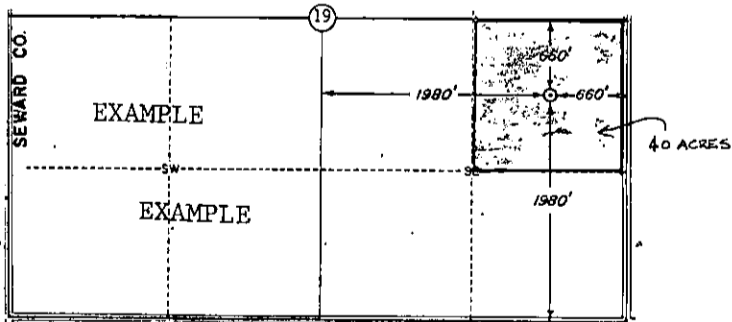
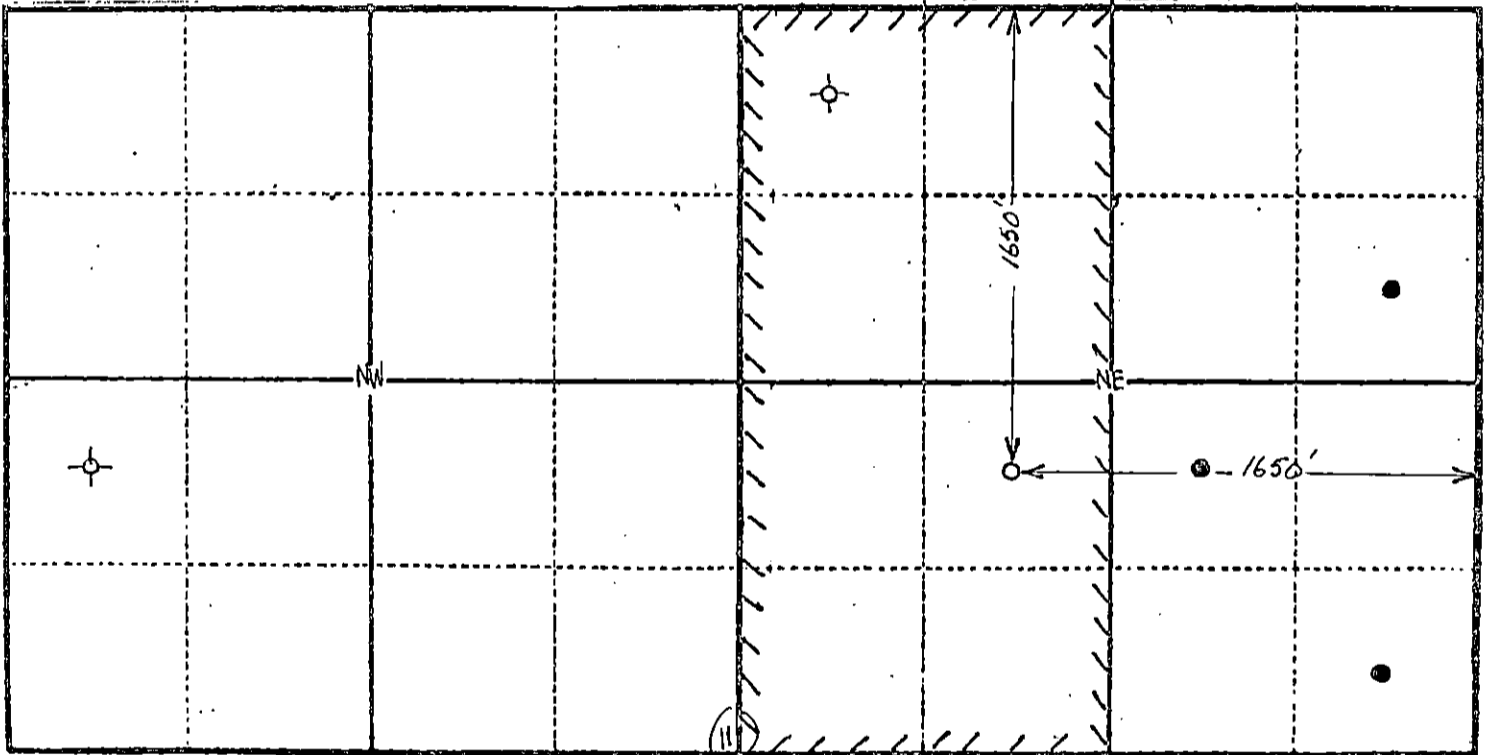

The undersigned hereby certifies that he is Micheal S. Mitchell, President for Falcon Exploration Inc., a duly authorized agent, that all information shown hereon is true and correct to the best of his knowledge and belief, and that all acreage claimed as attributable to the well named herein is held by production from that well.

Michael S. Mitchell

Suscribed and sworn to before me on this 2nd day of April, 19 87.

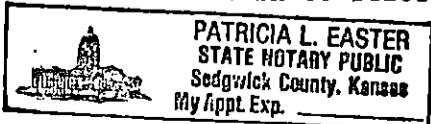

Patricia L. Easter
Notary Public

My Commission expires October 5, 1987