

STATE OF KANSAS
STATE CORPORATION COMMISSION

Give All Information Completely
Make Required Affidavit
Mail or Deliver Report to:-
Conservation Division,
State Corporation Commission
800 Biting Building
Wichita, Kansas

WELL PLUGGING RECORD
OR
FORMATION PLUGGING RECORD

Strike out upper line
when reporting plug-
ging off formations.

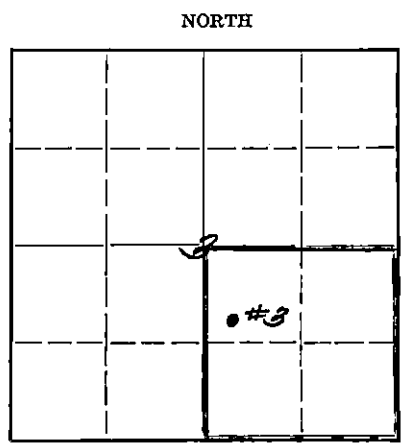

Locate well correctly on above
Section Plat

Reno County, Sec. 3 Twp. 24S. Rge. (E) 4 (W)
Location as "NE $\frac{1}{4}$ NW $\frac{1}{4}$ SW $\frac{1}{4}$ " or footage from lines SW $\frac{1}{4}$ NW $\frac{1}{4}$ SE $\frac{1}{4}$
Lease Owner Skelly Oil Company
Lease Name Obediah Chesshire Well No. 3
Office Address Box 391, Hutchinson, Kansas
Character of Well (completed as Oil, Gas or Dry Hole) Oil well
Date well completed January 3 19 37
Application for plugging filed April 1 19 43
Application for plugging approved April 5 19 43
Plugging commenced June 21 19 43
Plugging completed June 28 19 43
Reason for abandonment of well or producing formation Depleted oil well

If a producing well is abandoned, date of last production April 6 19 43
Was permission obtained from the Conservation Division or its agents before plugging was commenced? Yes

Name of Conservation Agent who supervised plugging of this well Ruel Durkee
Producing formation Mississippi Lime Depth to top 3316' Bottom 3370' Total Depth of Well 3373 Feet
Show depth and thickness of all water, oil and gas formations.

OIL, GAS OR WATER RECORDS

CASING RECORD

Formation	Content	From	To	Size	Put In	Pulled Out
Mississippi Lime	Gas	3300	3370 $\frac{1}{2}$	13" OD	495' 4"	None
" "	Oil	3336	3370 $\frac{1}{2}$	8-5/8" OD	3347' 10"	2970'

Describe in detail the manner in which the well was plugged, indicating where the mud fluid was placed and the method or methods used in introducing it into the hold. If cement or other plugs were used, state the character of same and depth placed, from _____ feet to _____ feet for each plug set.

Mud laden fluid with wood plug at 3315' 3373' to 3315'
81 sacks of cement 3315' to 3300'
Mud laden fluid 3300' to 300'
Wood plug at 300'
20 sacks of cement 300' to 280'
Mud laden fluid 280' to 10'
Wood plug at 10'
8 sacks of cement 10' to 4'
Surface soil and rock 4' to 0'

FILED 3 24 41
BUREAU PA 69 12

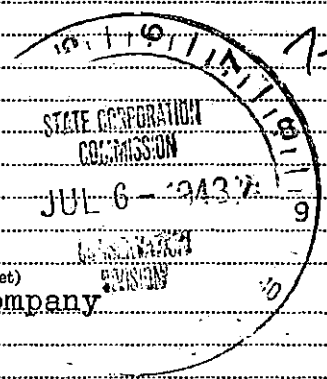

(If additional description is necessary, use BACK of this sheet)

Correspondence regarding this well should be addressed to Skelly Oil Company
Address Box 391, Hutchinson, Kansas

STATE OF KANSAS, COUNTY OF RENO, ss.

H. E. Wamsley (employee of owner or former owner) of the above-described well,
being first duly sworn on oath, says: That I have knowledge of the facts, statements, and matters herein contained and the log of the above-described well as filed and that the same are true and correct. So help me God.

(Signature) [Handwritten Signature]
Box 391, Hutchinson, Kansas (Address)

SUBSCRIBED AND SWORN to before me this 1st day of July, 19 43

August 4, 1945
My commission expires. [Handwritten Signature] Notary Public.

Left shut in until 7:00 PM, or 2 hours and 45 min., and on opening up, would not flow. Swabbed onto production Jan. 13, 1937, and at 3:10 PM started potential test. Following 24 hours flowed 649 barrels oil, no water, and gas gauged 650 M after 15 hours, and at end of 21 hours 3,170 M. Produced under proration with allowable of 84 barrels oil per day for remainder month of January.

Slope Test Data:

<u>Depth</u>	<u>Angle</u> (In deg.)	<u>Horiz.</u>	<u>Vert.</u>
400'	0	.0	.0
750	0	.0	.0
1000	1/2	2.3	.0
1250	1/2	2.3	.0
1500	1/2	2.3	.0
1750	1/2	2.3	.0
2000	0	.0	.0
2250	0	.0	.0
2500	1	4.4	.1
2750	1	4.4	.1
3000	1	4.4	.1
Total deflections		22.4'	.3'

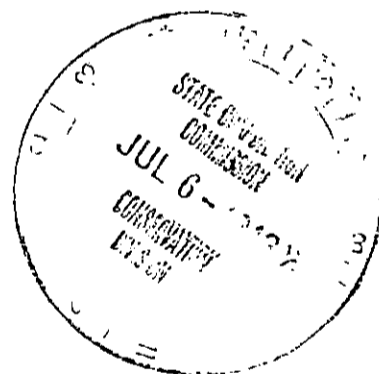

MATERIAL REPORT AND PLUGGING RECORD

Mail To: STATE CORPORATION COMMISSION
Conservation Division
800 Biting Building
Wichita, Kansas

NOTICE: All questions on this form must be answered.

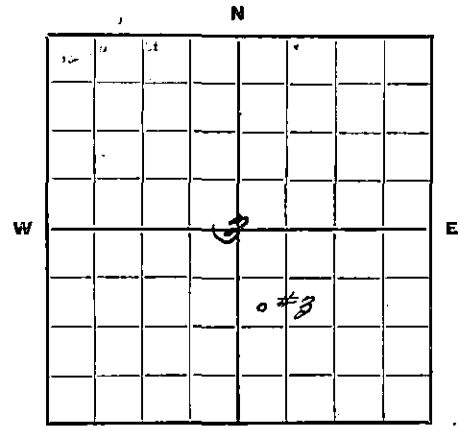

Locate well correctly.

Company Operating Skelly Oil Company
Office Address 210 Wolcott Building, Hutchinson, Kansas

County Reno Sec. 3 Twp. 24 S Rge. 4 W
Farm Name O. Chesshire Well No. 3 Field Burton
Well Location SW NW SE
Name of Producing Sand Mississippi Lime Total Depth 3373'
Commenced Plugging June 21, 1943 Finished June 28, 1943

DAILY AVERAGE PRODUCTION:

Initial Production: Oil 649 bbls. Gas 3,170,000 cu. ft. Water None
Production when Plugged: Oil 1 bbl. Gas None Water 400 bbls.

Estimated Total Remaining Reserves Attributable to Well at Time Abandoned None (hole loaded with water)

INFORMATION ON MATERIALS RECLAIMED FROM WELL CASING, TUBING AND ROD DATA

Description	Size	Recovered		Junk		Reusable		Disposition Made Or To Be Made Of Usable Material
		Ft.	Tons	Ft.	Tons	Ft.	Tons	
Casing	8-5/8"	2970'	47			2970'	47	Rerun in new well
Tubing	2-1/2"	3349'	10			3339'	11	" " " "
Rods	3/4"	3291'	2 1/2			3325'	2 1/2	" " " "

SURFACE EQUIPMENT

Quantity	Description	*Condition	Est. Tons	Disposition Made Or To Be Made Of Reclaimed Material
1	40 HP Weber comp. with clutch	Usable	2 1/2	To be used at another well
1	74' Steel Derrick	"	5	" " " " " "
1	Std. Rig Front Complete	"	8	" " " " " "
	Misc. line pipe & connections	"	1/2	To be used at other wells

* Usable, Usable with minor repairs, or junk.

Date: July 2, 1943 Signed: [Signature] Superintendent
(For Operating Co. Title)

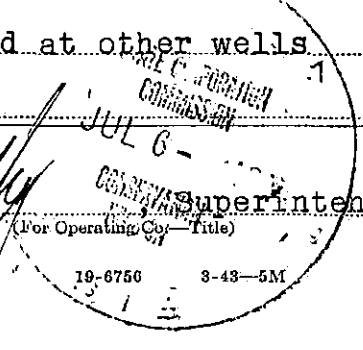

Handwritten notes:
3 3.4 4.0
6.9 12

It is very important that all questions on this form be answered, as this Department has been asked by the Petroleum Administration for War to supply data on well abandonments undertaken during the war.

This information is very essential in aiding the war effort; therefore, this Department is requiring this report to be mailed within 5 days after the abandonment of your well.

19-6756

SKELLY OIL COMPANY

Well Record

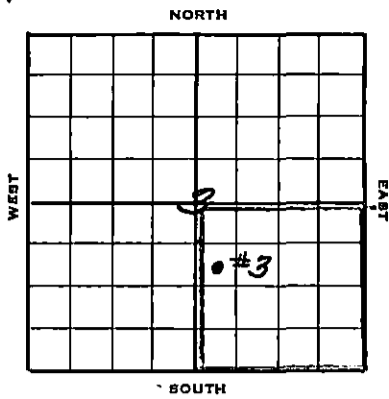

Lease Name and No. O. Chesshire (Roy. #158) Well No. 3 Elev. 1470 DF
 Lease Description SE/4 Section 3-24S-4W, Reno County, Kansas
(160 acres)
 Location made Oct. 9 1936 by H. V. Morse
990 feet from North line _____ feet from East line _____
 _____ feet from South line 330 feet from West line _____ of Lease

Work com'd. Nov. 10 1936 Rig comp'd Nov. 13 1936 Drlg. com'd. Nov. 17 1936 Drlg. comp'd Jan. 3 1937
 Rig Contractor Mahan, McCarty & Besse - Tulsa, Oklahoma
 Drilling Contractor Southern & Thurmond - Tulsa, Oklahoma
 Rotary Drilling from Top to 3320' Cable Tool Drilling from 3320' to 3373'
 Commenced Producing _____ 19 _____
 { Initial Prod. before shot or acid 4 BPH flowing Bbls.
 Initial Prod. after shot or acid 649 (Flowed in 24 hr. test) Bbls.
 Dry Gas Well Press. _____ Volume _____ Cu. ft.
 Casing Head Gas Pressure _____ Volume 3,170 M Cu. ft.
 Braden Head (13 1/2" OD 8-5/8") Gas Pressure _____ Volume _____ Cu. ft.
 Braden Head (3-5/8" OD x 2") Gas Pressure _____ Volume _____ Cu. ft.

PRODUCING FORMATION Mississippi Chert Top 3316 Bottom 3370 1/2' TOTAL DEPTH 3373'
 (Name)

CASING RECORD

Size	Wt.	Thds.	Where Set	PULLED OUT			LEFT IN			KIND	Cond'n	CEMENTING	
				Jts.	Feet	In.	Jts.	Feet	In.			Sacks Used	Method Employed
12-13/16" OD	40	8	495				25	495	4	Lapweld	"B"	500	Halliburton
8-5/8" OD	32	10	3316				109	3347	10	Seamless	"A"	165	"
The top of the 12-1/2" casing was 8' below derrick floor													

Liner Set at _____ Length _____ Perforated at _____
 Liner Set at _____ Length _____ Perforated at _____
 Packer Set at _____ Size and Kind _____
 Packer Set at _____ Size and Kind _____

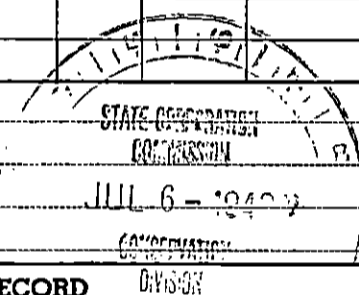

SHOT OR ACID TREATMENT RECORD

	FIRST	SECOND	THIRD	FOURTH
Date	Jan. 12, 1937			
Acid Used Size - Shot	4000 Gals. 2 1/2"			
Shot Between	3316 Ft. and 3373 Ft.	Ft. and Ft.	Ft. and Ft.	Ft. and Ft.
Size of Shell				
Put in by (Co.)	Dowell, Inc.			
Length anchor	" "X"			
Distance below Cas'g				
Damage to Casing or Casing Shoulder	None			

SIGNIFICANT GEOLOGICAL FORMATIONS

NAME	Top	Bottom	GAS		OIL		REMARKS
			From	To	From	To	
Mississippi Lime	3264						
" Chert	3275		3300	3370 1/2	3336	3370 1/2	Main body pay formation

CLEANING OUT RECORDS

	DATE COMMENCED	DATE COMPLETED	PROD. BEFORE	PROD. AFTER	REMARKS
1st					See Reverse for other details.
2nd					" " " " "
3rd					" " " " "
4th					" " " " "

PLUGGING BACK AND DEEPENING RECORDS

	Date Commenced	Date Completed	No. Feet Plugged Back or Deepened	Prod. Before	Prod. After	REMARKS
1st						See Reverse for other details.
2nd						" " " " "
3rd						" " " " "
4th						" " " " "

(See Reverse for Record of Formation)

RECORD OF FORMATIONS

FORMATION	TOP	BOTTOM	REMARKS Indicate Casing Points, Describe Shows of Oil, Gas and Water, etc.
Surface soil & sand	0	44	
Sand & clay	44	140	
Sand & shale	140	285	
Shale & Shells	285	372	
Shale, shells & sand	372	440	
Shale & shells	440	480	
Sand rock	480	505	Drilled to 505', reamed hole and ran and cemented 13" 10D" casing at 495' with 500 sacks - Halliburton process.
Shale & shells	505	760	
Red bed	760	779	
Shale & shells	779	870	
Shale, shells & red bed	870	953	
Shale & shells	953	1285	
Lime & shale	1285	1480	
Shale & shells	1480	1750	
Shale	1750	1825	
Shale & lime	1825	1870	
Lime	1870	2000	
Lime & shale	2000	2140	
Lime	2140	2740	
Lime & shale	2740	2808	
Lime	2808	2924	
Broken lime	2924	3061	
Lime	3061	3113	
Broken lime & shale	3113	3174	
Shale & lime	3174	3230	
Varigated shale	3230	3264	
Weathered gray & brown crystalline lime	3264	3270	Top Mississippi lime 3264'
Lime	3270	3276	Top Mississippi chert 3275'
Chert	3276	3300	
Med. soft gray chert	3300	3320	Show gas 3300-3320' Drilled to 3320' and ran and cemented 8-5/8" OD casing at 3316' with 165 sacks - Halliburton Process. Finished cement-int at 11:00 AM Dec. 14, 1936. Tore our rotary tools, moved in and rigged up cable tools. On Dec. 21st, had the hole bailed down and 8-5/8" casing tested OK. Drilled plug and cement job tested OK. Drilled ahead as follows: Gas gauged 2,370 M at 3320' and 5,420 M at 3325'.
Soft chert	3320	3325	Gas gauged 6,140 M at 3330' and was killed with mud and water.
Light gray chert & lime	3325	3330	
Light gray chert & lime	3330	3334	
Dense gray lime & chert with little shale	3334	3336	
Med. hard poroud brown & gray lime	3336	3339	Saturated. Show free oil. No gas inc.
Hard dense gray lime	3339	3344	No saturation or porosity.
Dense gray & brown cherty lime	3344	3349	No saturation
Dense gray lime with little chert	3349	3353	Oil stained. No saturation.
Gray crystalline lime with little chert	3353	3361	No saturation or porosity
Steel line correction	3361	3358	
Dense brown & gray cherty lime	3358	3365	No shows
Dense gray crystalline lime	3365	3367	Lost tools Dec. 29th and recovered Jan. 2nd.
Brown & gray lime	3367	3370½	Slight oil stain & porosity
Dense gray crystalline lime with little chert	3370½	3373	No shows. Stopped drilling Jan. 3, 1937 at depth 3373'. Ran 2" flow string tubing to 3336' and commenced swab to clean hole before acid treatment. Jan. 5th, flowed 2 hours into pits, then quit. Continued swab 11th, when again started flowing at rate 15 BPH into pits, gas gauged 2,650 M. Flowed in pits 5 hours until 3:00 PM, then switched into separator. At end of 18 hours, was flowing an est. 4 BPH. Jan. 12th, treated with acid as follows:

TOTAL DEPTH 3373'

Acid treatment No. 1, Jan. 12, 1937, by Dowell, Inc., using 4000 gal. of Dowell "X" acid solution and 326½ bbls. oil during treatment.

Time	CP	TP	
9:30 AM			Started oil in to kill well.
2:50 PM			Had 300 bbls. oil in hole. Well killed.
2:57	50#	0#	Started acid in tubing
3:10	200#	0#	Had 12.8 bbls. acid in hole. Acid on bottom.
3:16	160#	20" Vac.	" 24 " " " Shut down pumps.
3:38	170#	10" "	" 60 " " "
3:50	130#	20" "	" 84 " " "
3:56	100#	20" "	" 96 " " " (4000 gal.)
			Started oil in to flush tubing.
4:10	40#	50#	Had 15 bbls. oil in hole.
4:15	0#	0#	" 26½ " " " Shut in for acid to act.