

FOR KCC USE:

FORM C-1 7/91

EFFECTIVE DATE: 1-4-2000

FORM MUST BE TYPED

DISTRICT # 2

State of Kansas  
NOTICE OF INTENTION TO DRILL

FORM MUST BE SIGNED

SEAT: Yes No

Must be approved by the K.C.C. five (5) days prior to commencing well

ALL BLANKS MUST BE FILLED

Expected Spud Date August 16, 1999  
month day year

Spot NW Sec 36 Twp 28S Rg 8W East West

OPERATOR: License # 8740  
Name: BRAMWELL PETROLEUM, INC.  
Address: 15183 SW 25th Avenue  
City/State/Zip: Spivey, Kansas 67142-9074  
Contact Person: Donald Bramwell  
Phone: 316/532-2770

1320 feet from South/North line of Section  
1320 feet from East/West line of Section  
IS SECTION X REGULAR IRREGULAR?

CONTRACTOR: License # 5929  
Name: DUKE DRILLING CO., INC.

(NOTE: Locate well on the Section Plat on Reverse Side)  
County: Kingman  
Lease Name: SOUTHWEST COLLEGE Well #: 2

Well Drilled For: Well Class: Type Equipment:  
X Oil ... Enh Rec X Infield X Mud Rotary  
... Gas ... Storage ... Pool Ext. ... Air Rotary  
... OWD ... Disposal ... Wildcat ... Cable  
... Seismic; ... # of Holes ... Other

Field Name: ...  
Is this a Prorated/Spaced Field? ... yes X no  
Target Formation(s): Mississippi  
Nearest lease or unit boundary: 1320'  
Ground Surface Elevation: est. 1642 feet MSL  
Water well within one-quarter mile: ... yes X no  
Public water supply well within one mile: ... yes X no  
Depth to bottom of fresh water: 60' 140'  
Depth to bottom of usable water: 180'  
Surface Pipe by Alternate: X 1 2  
Length of Surface Pipe Planned to be set: 200'  
Length of Conductor pipe required: N/A  
Projected Total Depth: 4100'  
Formation at Total Depth: Mississippi  
Water Source for Drilling Operations: ... well ... farm pond X other

If OWD: old well information as follows:  
Operator: ...  
Well Name: ...  
Comp. Date: ... Old Total Depth

DWR Permit #: ...  
Will Cores Be Taken?: ... yes X no  
If yes, proposed zone: ...

Directional, Deviated or Horizontal wellbore? ... yes X no  
If yes, true vertical depth: ...  
Bottom Hole Location: ...

AFFIDAVIT

The undersigned hereby affirms that the drilling, completion and eventual plugging of this well will comply with K.S.A. 55-101, et. seq.  
It is agreed that the following minimum requirements will be met:

- 1. Notify the appropriate district office prior to spudding of well;
- 2. A copy of the approved notice of intent to drill shall be posted on each drilling rig;
- 3. The minimum amount of surface pipe as specified below shall be set by circulating cement to the top; in all cases surface pipe shall be set through all unconsolidated materials plus a minimum of 20 feet into the underlying formation;
- 4. If the well is dry hole, an agreement between the operator and the district office on plug length and placement is necessary prior to plugging;
- 5. The appropriate district office will be notified before well is either plugged or production casing is cemented in;
- 6. IF AN ALTERNATE II COMPLETION, PRODUCTION PIPE SHALL BE CEMENTED FROM BELOW ANY USABLE WATER TO SURFACE WITHIN 120 DAYS OF SPUD DATE. IN ALL CASES, NOTIFY DISTRICT OFFICE PRIOR TO ANY CEMENTING.

I hereby certify that the statements made herein are true and to the best of my knowledge and belief.

Date: 8/9/99 Signature of Operator or Agent: [Signature] Title: Agent

FOR KCC USE:  
API # 15- 095-217590000  
Conductor pipe required NONE feet  
Minimum surface pipe required 200 feet per Alt. 1 X  
Approved by: JK 12-30-99  
This authorization expires: 6-30-2000  
(This authorization void if drilling not started within 6 months of effective date.)  
Spud date: Agent:

RECEIVED  
KANSAS CORP. CO.  
1999 AUG 11 AM 11:42  
36  
28  
84

REMEMBER TO:

- File Drill Pit Application (form CDP-1) with Intent to Drill;
- File Completion Form ACO-1 within 120 days of spud date;
- File acreage attribution plat according to field proration orders;
- Notify appropriate district office 48 hours prior to workover or re-entry;
- Submit plugging report (CP-4) after plugging is completed;
- Obtain written approval before disposing or injecting salt water.

Mail to: Conservation Division, 200 Colorado Derby Building, 202 W. First St., Wichita, Kansas 67202-1284.

IN ALL CASES PLOT THE INTENDED WELL ON THE PLAT BELOW

**PLAT OF ACREAGE ATTRIBUTABLE TO A WELL IN A PRORATED OR SPACED FIELD**

If the intended well is in a prorated or spaced field, please fully complete this side of the form. If the intended well is in a prorated or spaced field complete the plat below showing that the well will be properly located in relationship to other wells producing from the common source of supply. Please show all the wells within 1 mile of the boundaries of the proposed acreage attribution unit for gas wells and within 1/2 mile of the boundaries of the proposed acreage attribution unit for oil wells.

API NO. 15- \_\_\_\_\_  
 OPERATOR \_\_\_\_\_  
 LEASE \_\_\_\_\_  
 WELL NUMBER \_\_\_\_\_  
 FIELD \_\_\_\_\_

LOCATION OF WELL: COUNTY \_\_\_\_\_  
 \_\_\_\_\_ feet from south/north line of section  
 \_\_\_\_\_ feet from east/west line of section  
 SECTION \_\_\_\_\_ TWP \_\_\_\_\_ RG \_\_\_\_\_

NUMBER OF ACRES ATTRIBUTABLE TO WELL \_\_\_\_\_  
 QTR/QTR/QTR OF ACREAGE \_\_\_\_\_ - \_\_\_\_\_ - \_\_\_\_\_

IS SECTION \_\_\_\_\_ REGULAR or \_\_\_\_\_ IRREGULAR  
IF SECTION IS IRREGULAR, LOCATE WELL FROM NEAREST CORNER BOUNDARY.

Section corner used: \_\_\_\_\_ NE \_\_\_\_\_ NW \_\_\_\_\_ SE \_\_\_\_\_ SW

**PLAT**

(Show location of the well and shade attributable acreage for prorated or spaced wells.)  
 (Show footage to the nearest lease or unit boundary line.)

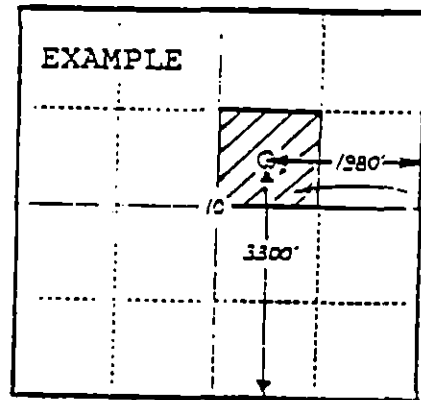
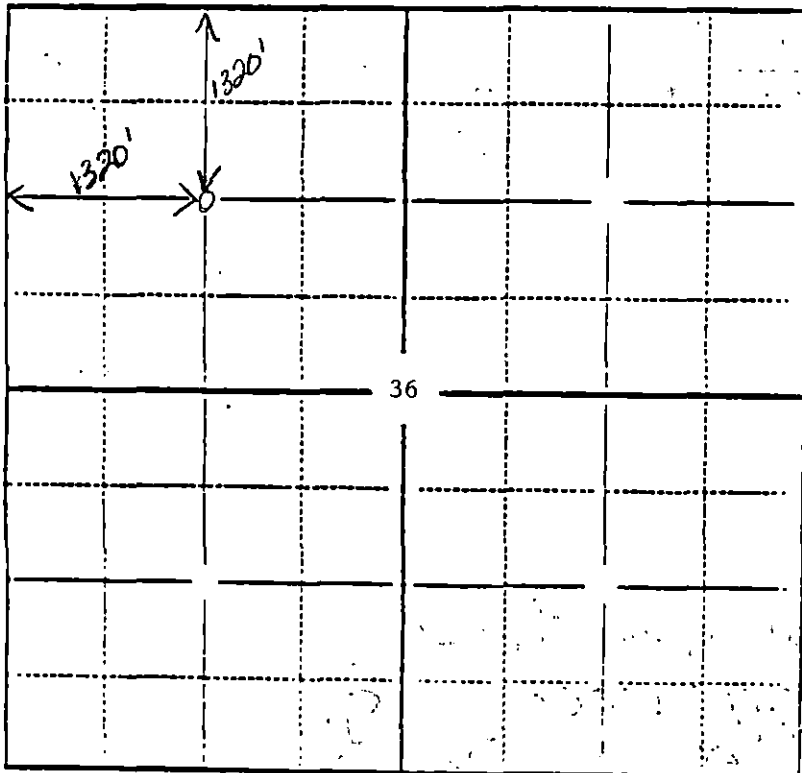

SEWARD CO.

KINGMAN COUNTY

In plotting the proposed location of the well, you must show:

- 1) The manner in which you are using the depicted plat by identifying section lines, i.e. 1 section, 1 section with 8 surrounding sections, 4 sections, etc.;
- 2) the distance of the proposed drilling location from the section's south/north and east/west lines; and
- 3) the distance to the nearest lease or unit boundary line.