

OWWO

RECEIVED  
KANSAS CORPORATION COMMISSION

For KCC Use:  
Effective Date: 1-19-03  
District #: 7  
SGA?  Yes  No

KANSAS CORPORATION COMMISSION  
OIL & GAS CONSERVATION DIVISION  
**NOTICE OF INTENT TO DRILL**

DEC 24 2002

Form C-1  
September 1999  
Form must be Typed  
Form must be Signed  
All blanks must be Filled

Must be approved by KCC five (5) days prior to commencing well

CONSERVATION DIVISION  
WICHITA, KS

Expected Spud Date January 8, 2003  
month day year

Spot Ap 90'w of  
SW SE Sec. 26 Twp. 28S S. R. 8  
 East  
 West  
660 feet from (S) 1 \* (circle one) Line of Section  
2070 feet from (E) 1 \* (circle one) Line of Section  
Is SECTION  Regular  Irregular?

OPERATOR: License# 5254  
Name: MIDCO EXPLORATION, INC.  
Address: 414 Plaza Drive, Suite 204  
City/State/Zip: Westmont, IL 60559  
Contact Person: Earl J. Joyce, Jr.  
Phone: (630) 655-2198

(Note: Locate well on the Section Plat on reverse side)

County: KINGMAN  
Lease Name: SIMONS Well #: #1 OWWO  
Field Name: GARLISCH SW

CONTRACTOR: License# 5123  
Name: Pickrell Drilling Co., Inc.

Is this a Prorated / Spaced Field?  Yes  No  
Target Formation(s): Mississippi

Well Drilled For: Well Class: Type Equipment:  
 Oil  Enh Rec  Infield  Mud Rotary  
 Gas  Storage  Pool Ext.  Air Rotary  
 OWWO  Disposal  Wildcat  Cable  
 Seismic; # of Holes  Other  
 Other

Nearest Lease or unit boundary: 570  
Ground Surface Elevation: 1638 feet MSL  
Water well within one-quarter mile:  Yes  No  
Public water supply well within one mile:  Yes  No  
Depth to bottom of fresh water: 100 65  
Depth to bottom of usable water: 200  
Surface Pipe by Alternate:  1 2

If OWWO: old well information as follows:  
Operator: MADIERA OIL 15-095-20177-00-00  
Well Name: #1 FAUST  
Original Completion Date: 10/69 Original Total Depth: 4500

Length of Surface Pipe Planned to be set: 244 existing  
Length of Conductor Pipe required: N/A  
Projected Total Depth: 4200  
Formation at Total Depth: MISSISSIPPI

Directional, Deviated or Horizontal wellbore?  Yes  No  
If Yes, true vertical depth: \_\_\_\_\_  
Bottom Hole Location: \_\_\_\_\_  
KCC DKT #: \_\_\_\_\_

Water Source for Drilling Operations:  
Well \_\_\_\_\_ Farm Pond  Other \_\_\_\_\_  
DWR Permit #: \_\_\_\_\_  
(Note: Apply for Permit with DWR )  
Will Cores be taken?  Yes  No  
If Yes, proposed zone: \_\_\_\_\_

**AFFIDAVIT**

The undersigned hereby affirms that the drilling, completion and eventual plugging of this well will comply with K.S.A. 55-101, et. seq.  
It is agreed that the following minimum requirements will be met:

1. Notify the appropriate district office *prior* to spudding of well;
2. A copy of the approved notice of intent to drill *shall be* posted on each drilling rig;
3. The minimum amount of surface pipe as specified below *shall be set* by circulating cement to the top; in all cases surface pipe *shall be set* through all unconsolidated materials plus a minimum of 20 feet into the underlying formation.
4. If the well is dry hole, an agreement between the operator and the district office on plug length and placement is necessary *prior to plugging*;
5. The appropriate district office will be notified before well is either plugged or production casing is cemented in;
6. If an ALTERNATE II COMPLETION, production pipe shall be cemented from below any usable water to surface within *120 days* of spud date. *In all cases, NOTIFY district office* prior to any cementing.

I hereby certify that the statements made herein are true and to the best of my knowledge and belief.

Date: 12/23/02 Signature of Operator or Agent: [Signature] Title: Vice-President

For KCC Use ONLY  
API # 15 - 095-20177-00-01  
Conductor pipe required NONE feet  
Minimum surface pipe required 244 feet per Alt. 1  
Approved by: RJP 1.14.03  
This authorization expires: 7.14.03  
(This authorization void if drilling not started within 6 months of effective date.)  
Spud date: \_\_\_\_\_ Agent: \_\_\_\_\_

- Remember to:
- File Drill Pit Application (form CDP-1) with Intent to Drill;
  - File Completion Form ACO-1 within 120 days of spud date;
  - File acreage attribution plat according to field proration orders;
  - Notify appropriate district office 48 hours prior to workover or re-entry;
  - Submit plugging report (CP-4) after plugging is completed;
  - Obtain written approval before disposing or injecting salt water.

26  
28  
8w

**IN ALL CASES PLOT THE INTENDED WELL ON THE PLAT BELOW**

*Plat of acreage attributable to a well in a prorated or spaced field*

*If the intended well is in a prorated or spaced field, please fully complete this side of the form. If the intended well is in a prorated or spaced field complete the plat below showing that the well will be properly located in relationship to other wells producing from the common source of supply. Please show all the wells and within 1 mile of the boundaries of the proposed acreage attribution unit for gas wells and within 1/2 mile of the boundaries of the proposed acreage attribution unit for oil wells.*

API No. 15 - \_\_\_\_\_

Operator: \_\_\_\_\_

Lease: \_\_\_\_\_

Well Number: \_\_\_\_\_

Field: \_\_\_\_\_

Number of Acres attributable to well: \_\_\_\_\_

QTR / QTR / QTR of acreage: \_\_\_\_\_ - \_\_\_\_\_ - \_\_\_\_\_

Location of Well: County: \_\_\_\_\_

\_\_\_\_\_ feet from S / N (circle one) Line of Section

\_\_\_\_\_ feet from E / W (circle one) Line of Section

Sec. \_\_\_\_\_ Twp. \_\_\_\_\_ S. R. \_\_\_\_\_  East  West

Is Section \_\_\_\_\_ Regular or \_\_\_\_\_ Irregular

**If Section is Irregular, locate well from nearest corner boundary.**

Section corner used: \_\_\_NE \_\_\_NW \_\_\_SE \_\_\_SW

**PLAT**

*(Show location of the well and shade attributable acreage for prorated or spaced wells.)*

*(Show footage to the nearest lease or unit boundary line.)*

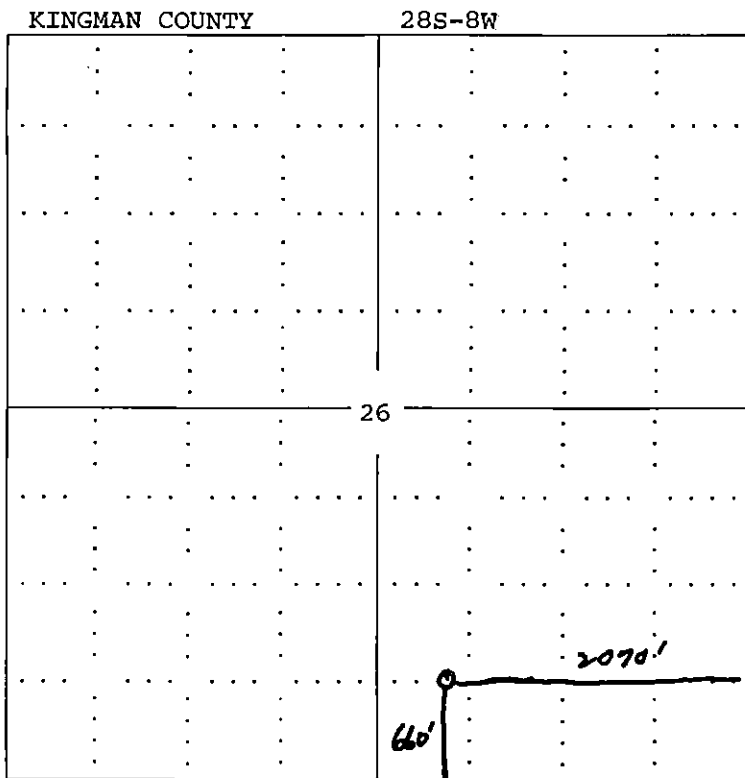

**RECEIVED**  
KANSAS CORPORATION COMMISSION

DEC 24 2002

CONSERVATION DIVISION  
WICHITA, KS

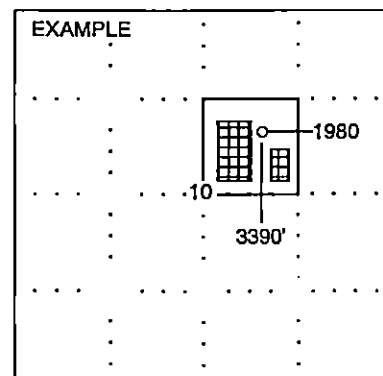

SEWARD CO.

**NOTE: In all cases locate the spot of the proposed drilling location.**

**In plotting the proposed location of the well, you must show:**

1. The manner in which you are using the depicted plat by identifying section lines, i.e. 1 section, 1 section with 8 surrounding sections, 4 sections, etc.
2. The distance of the proposed drilling location from the section's south / north and east / west.
3. The distance to the nearest lease or unit boundary line.
4. If proposed location is located within a prorated or spaced field a certificate of acreage attribution plat must be attached: (CO-7 for oil wells; CG-8 for gas wells).