

STATE OF KANSAS
STATE CORPORATION COMMISSION

WELL PLUGGING RECORD

Give All Information Completely
Make Required Affidavit
Mail or Deliver Report to
Conservation Division
State Corporation Comm.
245 North Water
Wichita, KS 67202

Kingman County, Sec. 28 Twp. 29S Rge. 8W 1/4/W
Location as "NE/CNW $\frac{1}{4}$ /SW $\frac{1}{4}$ " or footage from lines
1300' FEL; 680' FSL of SE/4
Lease Owner Gear Petroleum Company
Lease Name Molitor "B" Well No. 1
Office Address 1325 Vickers KSB&T Building, Wichita, Ks. 67202
Character of Well (Completed as Oil, Gas or Dry Hole) D & A
Date Well completed June 8, 1978
Application for plugging filed June 8, 1978
Application for plugging approved June 8, 1978
Plugging commenced June 9, 1978
Plugging completed June 9, 1978
Reason for abandonment of well or producing formation D & A

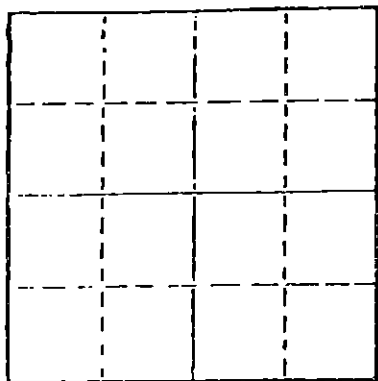

Locate well correctly on above Section Plot

If a producing well is abandoned, date of last production 19

Was permission obtained from the Conservation Division or its agents before plugging was commenced? Yes

Name of Conservation Agent who supervised plugging of this well Jasper H. Metz
Producing formation _____ Depth to top _____ Bottom _____ Total Depth of Well 4,247'
Show depth and thickness of all water, oil and gas formations.

OIL, GAS OR WATER RECORDS

CASING RECORD

FORMATION	CONTENT	FROM	TO	SIZE	PUT IN	PULLED OUT
				8 5/8"	204.41'	-0-

Describe in detail the manner in which the well was plugged, indicating where the mud fluid was placed and the method or methods used in introducing it into the hold. If cement or other plugs were used, state the character of same and depth placed, from _____ feet to _____ feet for each plug set.

Plug @ 210' w/40 sx cement
Plug @ 40' w/12 sx cement
3 sx cement in rathole

RECEIVED
STATE CORPORATION COMMISSION

JUN 14 1978 OLE-14-78

CONSERVATION DIVISION
Wichita, Kansas

(If additional description is necessary, use BACK of this sheet)

Name of Plugging Contractor Red Tiger Drilling Company
1720 KSB&T Building, Wichita, Kansas 67202

STATE OF Kansas COUNTY OF Sedgwick, ss. contractor
Gloria Fawcett (employee of ~~xxxxxxx~~)

of the above-described well, being first duly sworn on oath, says: That I have knowledge of the facts, statements, and matters herein contained and the log of the above-described well as filed and that the same are true and correct. So help me God.

(Signature) Gloria Fawcett
1720 KSB&T Building, Wichita, Kansas 67202
(Address)

SUBSCRIBED AND SWORN TO before me this 12th day of June, 1978.

My commission expires _____

Joyce A. Hagermann
Notary Public.

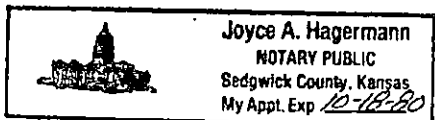

KANSAS DRILLERS LOG

S. 28 T. 29 R. 8W ^E/_W
 Loc. 680' FSL & 1300' FEL
SE/4
 County Kingman

API No. 15 — 095 — 20,728
 County Number

Operator
Gear Petroleum Co., Inc.

Address
300 Sutton Place, Wichita, Kansas 67202

Well No. 1 Lease Name Molitor "B"

Footage Location
680 feet from CRX (S) line 1300 feet from (E) CRX line

Principal Contractor Red Tiger Drilling Co. Geologist Phil Hart

Spud Date 6-1-78 Total Depth 4247 P.B.T.D.

Date Completed 6-9-78 Oil Purchaser N/A

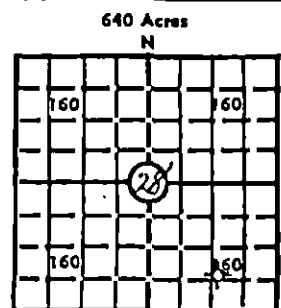

Locate well correctly
 Elev.: Gr. 1596
 DF _____ KB 1601

CASING RECORD

Report of all strings set — surface, intermediate, production, etc.

Purpose of string	Size hole drilled	Size casing set (in O.D.)	Weight lbs/ft.	Setting depth	Type cement	Sacks	Type and percent additives
Surface	12 1/4"	8 5/8	28	208	Common	175	2% Gel, 3% Gel

LINER RECORD

PERFORATION RECORD

Top, ft.	Bottom, ft.	Sacks cement	Shots per ft.	Size & type	Depth interval

TUBING RECORD

Size	Setting depth	Packer set at

ACID, FRACTURE, SHOT, CEMENT SQUEEZE RECORD

Amount and kind of material used	Depth interval treated

INITIAL PRODUCTION

Date of first production		Producing method (flowing, pumping, gas lift, etc.)			
RATE OF PRODUCTION PER 24 HOURS	Oil	Gas	Water	Gas-oil ratio	
	bbls.	MCF	bbls.		
Disposition of gas (vented, used on lease or sold)			Producing interval(s)		

RECEIVED
 STATE CORPORATION COMMISSION
 CFPB
 MAR 25 1994
 CONSERVATION DIVISION
 Wichita, Kansas

INSTRUCTIONS: As provided in KCC Rule 82-2-125, within 90 days after completion of a well, one completed copy of this Drillers Log shall be submitted to the State Geological Survey of Kansas, 4150 Monroe Street, Wichita, Kansas 67209. Copies of this form are available from the Conservation Division, State Corporation Commission, 3830 So. Meridian (P.O. Box 17027), Wichita, Kansas 66217. Phone AC 316-522-2206. If confidential custody is desired, please note Rule 82-2-125. Drillers Logs will be on an open file in the Oil and Gas Division, State Geological Survey of Kansas, Lawrence, Kansas 66044.

DESIGNATE TYPE OF COMP.: OIL, GAS, DRY HOLE, SWDW, ETC.:

Operator
Gear Petroleum Co., Inc.

Well No.

1

Lease Name

Molitor "B"

Dry Hole

S 28 - T 29 R 8 ²⁵ W

WELL LOG

Show all important zones of porosity and contents thereof; cored intervals, and all drill-stem tests, including depth interval tested, cushion used, time tool open, flowing and shut-in pressures, and recoveries.

SHOW GEOLOGICAL MARKERS, LOGS RUN, OR OTHER DESCRIPTIVE INFORMATION.

FORMATION DESCRIPTION, CONTENTS, ETC.	TOP	BOTTOM	NAME	DEPTH
NO DST'S			<u>SAMPLE TOPS</u>	
			Winfield	1524 +77
			Fort Riley	1648 -47
			Indian Cave	2268 -667
			Wabaunsee	2314 -713
			Tarkio	2462 -801
			Heebner	3236 -1635
			2' hi to A.G. Hill #1 Higgins	
			Lansing	3453 -1852
			10' hi to A. G. Hill #1 Higgin	
			Stark	3863 -2262
			15' hi to A. G. Hill #1 Higgin	
			B/KC	3948 -2347
			Cherokee	4141 -2540
		RTD	4247 -2646	

USE ADDITIONAL SHEETS, IF NECESSARY, TO COMPLETE WELL RECORD.

Date Received

Jim Thatcher
Engineer

Signature

Title

5/28/81

Date

RECEIVED
STATE CORPORATION COMMISSION

MAR 25 1994

CONSERVATION DIVISION
Wichita, Kansas

DRILLERS LOG

No. 1 Molitor "B"

CASING RECORD:	COMPANY:	Gear Petroleum Company	DESCRIPTION:
8 5/8" @ 208' w/175 sx cement	CONTRACTOR:	Red Tiger Drilling Company	1300' FEL; 680' FSL of SE/4 Sec. 28-T29S-R8W Kingman County, Kansas
	COMMENCED:	June 1, 1978	
	COMPLETED:	June 8, 1978	
TOTAL DEPTH: 4,247'			ELEVATION: 1,596' GR

<u>FORMATION</u>	<u>FROM</u>	<u>TO</u>	<u>REMARKS</u>
Sand & Red Bed Shale	0	255	
Shale & Lime	255	860	
Lime	860	2670	
Shale & Lime	2670	2930	
Lime & Shale	2930	3190	
Shale & Lime	3190	3540	
Lime & Shale	3540	3670	
Lime	3670	3815	
RTD	3815	4247	

I certify that this is a true and correct copy of the above log to the best of my knowledge.

RED TIGER DRILLING COMPANY

Gloria Fawcett
Gloria Fawcett

Subscribed and sworn to before me this 12th day of June, 1978.

Joyce A. Hagermann
Notary Public

RECEIVED
STATE CORPORATION COMMISSION
JUN 14 1978
CONSERVATION DIVISION
Wichita, Kansas

 **Joyce A. Hagermann**
NOTARY PUBLIC
Sedgwick County, Kansas
My Appt. Exp. 10-12-80