

FOR KCS USE:

FORM C-1 7/91

FORM MUST BE TYPED

FORM MUST BE SIGNED

ALL BLANKS MUST BE FILLED

EFFECTIVE DATE: 4-27-94

State of Kansas

DISTRICT # 2
SEA7 Yes No

NOTICE OF INTENTION TO DRILL

Must be approved by the K.C.C. five (5) days prior to commencing well

Expected Spud Date April 15, 1994
month day year

Spot NE NW Sec 4 Twp 29 S, Rg 7 XX East West

OPERATOR: License # 5205
Name: MID-CONTINENT ENERGY CORPORATION
Address: 155 N. Market, Suite 950
City/State/Zip: Wichita, KS 67202
Contact Person: Bradley R. Buehler
Phone: 316-265-9501

660' feet from XXXX / North line of Section
1980' feet from XXXX / West line of Section

IS SECTION XX REGULAR IRREGULAR?

(NOTE: Locate well on the Section Plat on Reverse Side)

County: Kingman
Lease Name: LAYMAN Well #: #1 OWWO
Field Name: ALAMEDA

CONTRACTOR: License #: 5929
Name: Duke Drilling Co., Inc.

Is this a Prorated/Spaced Field? yes no
Target Formation(s): Mississippi
Nearest lease or unit boundary: 660'

Ground Surface Elevation: 1610 feet MSL

Water well within one-quarter mile: yes no

Public water supply well within one mile: yes no

Depth to bottom of fresh water:

Depth to bottom of usable water:

Surface Pipe by Alternate: XX 1 2

Length of Surface Pipe set: 211'

Length of Conductor pipe required:

Projected Total Depth: 4090'

Formation at Total Depth: MISS

Water Source for Drilling Operations: well farm pond other

DWR Permit #:

Will Cores Be Taken? yes XX no

If yes, proposed zone:

Well Drilled For: Well Class: Type Equipment:
Oil Enh Rec Infield XX Mud Rotary
XX Gas Storage XX Pool Ext. Air Rotary
XX OWWO Disposal Wildcat Cable
Seismic: # of Holes Other

If OWWO: old well information as follows:
Operator: Pickrell Drilling
Well Name: #1 Goenner "B"
Comp. Date: 8/7/74 Old Total Depth 4090'

15-095-20351

Directional, Deviated or Horizontal wellbore? yes no

If yes, true vertical depth:

Bottom Hole Location:

AFFIDAVIT

The undersigned hereby affirms that the drilling, completion and eventual plugging of this well shall be in accordance with K.S.A. 55-101, et. seq.

It is agreed that the following minimum requirements will be met:

- 1. Notify the appropriate district office prior to spudding of well;
- 2. A copy of the approved notice of intent to drill shall be posted on each drilling site;
- 3. The minimum amount of surface pipe as specified below shall be set by circulating to the top; in all cases surface pipe shall be set through all unconsolidated materials plus a minimum of 20 feet into the underlying formation;
- 4. If the well is dry hole, an agreement between the operator and the district office on plugging and placement is necessary prior to plugging;
- 5. The appropriate district office will be notified before well is either plugged or production casing is cemented in;
- 6. IF AN ALTERNATE IS COMPLETION, PRODUCTION PIPE SHALL BE CEMENTED FROM BELOW ANY USABLE WATER TO SURFACE WITHIN 120 DAYS OF SPUD DATE. IN ALL CASES, NOTIFY DISTRICT OFFICE PRIOR TO ANY CEMENTING.

I hereby certify that the statements made herein are true and to the best of my knowledge and belief.

Date: 3-28-94 Signature of Operator or Agent: Bradley R. Buehler Title: Vice Pres.

STATE OF KANSAS RECEIVED CONSERVATION COMMISSION APR 01 1994

FOR KCS USE:
API # 15- 095-20351-00-01
Conductor pipe required NONE feet
Minimum surface pipe required 211 feet per Alt. (X)
Approved by: CB 4-22-94
This authorization expires: 10-22-94
(This authorization void if drilling not started within 6 months of effective date.)
Spud date: Agent:

REMEMBER TO:

- File Drill Pit Application (form CDP-1) with Intent to Drill;
- File Completion Form AMS-1 within 120 days of spud date;
- File acreage attribution plan according to field prorator orders;
- Notify appropriate district office 48 hours prior to workover or re-entry;
- Submit plugging report (CP-4) after plugging is completed;
- Obtain written approval before disposing or injecting salt water.

Mail to: Conservation Division, 200 Colorado Derby Building, 202 W. First St., Wichita, Kansas 67202-1286.

4
29
7

IN ALL CASES PLOT THE INTENDED WELL ON THE PLAT BELOW

PLAT OF ACREAGE ATTRIBUTABLE TO A WELL IN A PRORATED OR SPACED FIELD

If the intended well is in a prorated or spaced field, please fully complete this side of the form. If the intended well is in a prorated or spaced field complete the plat below showing that the well will be properly located in relationship to other wells producing from the common source of supply. Please show all the wells within 1 mile of the boundaries of the proposed acreage attribution unit for gas wells and within 1/2 mile of the boundaries of the proposed acreage attribution unit for oil wells.

API NO. 15- _____

OPERATOR MID-CONTINENT ENERGY CORPORATION
 LEASE LAYMAN
 WELL NUMBER #1 OWVO
 FIELD ALAMEDA

LOCATION OF WELL: COUNTY KINGMAN
660' feet from ~~south~~ north line of section
1980' feet from ~~east~~ west line of section
 SECTION 4 TWP 29S RG 7W

NUMBER OF ACRES ATTRIBUTABLE TO WELL _____
 QTR/QTR/QTR OF ACREAGE _____

IS SECTION XXX REGULAR or _____ IRREGULAR
IF SECTION IS IRREGULAR, LOCATE WELL FROM NEAREST
CORNER BOUNDARY.

Section corner used: _____ NE _____ NW _____ SE _____ SW
 PLAT

(Show location of the well and shade attributable acreage for prorated or spaced wells.)
 (Show footage to the nearest lease or unit boundary line.)

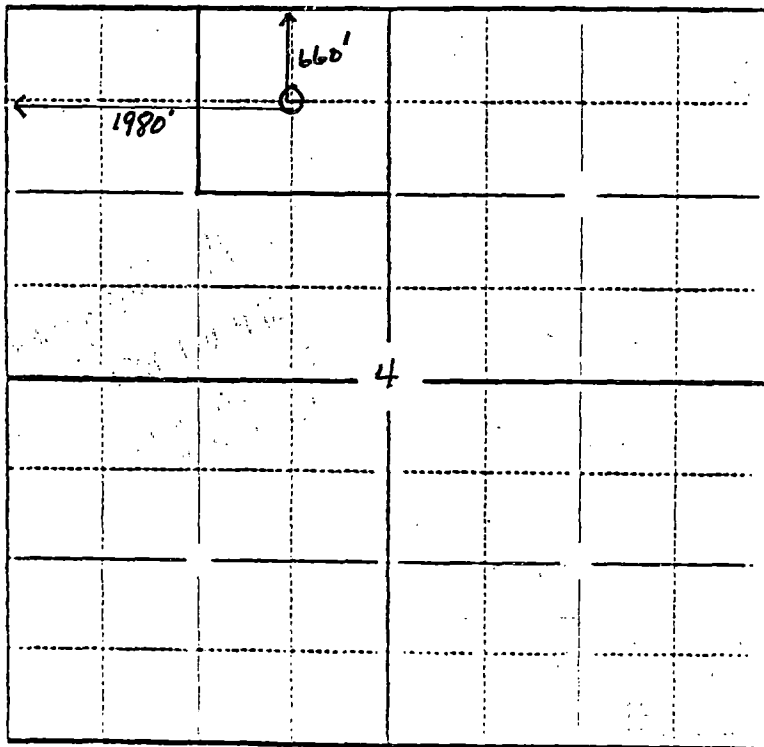

KINGMAN CO.

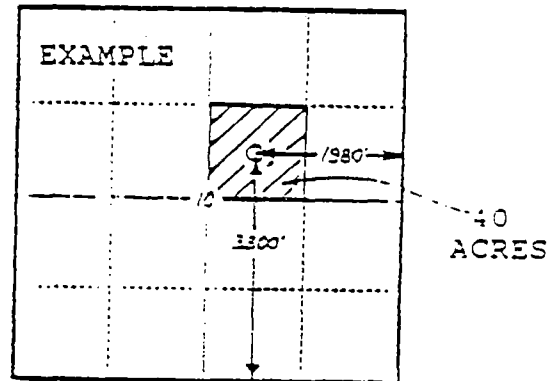

SEWARD CO.

In plotting the proposed location of the well, you must show:

- 1) The manner in which you are using the depicted plat by identifying section lines, i.e. 1 section, 1 section with 8 surrounding sections, 4 sections, etc.;
- 2) the distance of the proposed drilling location from the section's south/north and east/west lines; and
- 3) the distance to the nearest lease or unit boundary line.