

STATE CORPORATION COMMISSION OF KANSAS  
OIL & GAS CONSERVATION DIVISION  
WELL COMPLETION OR RECOMPLETION FORM  
ACO-1 WELL HISTORY  
DESCRIPTION OF WELL AND LEASE

S

API NO. 15-063-21-087-00-00  
County Gove  
NW NW NW Sec. 11 Twp. 15S Rge. 28 East  
X West

Operator: License # 5063  
Energy Exploration, Inc.  
Name  
Address 1002 S. Broadway  
Wichita, Kansas 67211  
City/State/Zip

4950 Ft. West from Southeast Corner of Section  
4950 Ft. West from East Corner of Section  
(Note: Locate well in section plat below)

Purchaser NA

Lease Name BENTLEY Well # 1

Operator Contact Person Brad Lehl  
Phone 316-267-7336

Field Name N/A

Producing Formation NA

Contractor: License # 5883  
Warrior Drilling Co.

Elevation: Ground 2557 KB 2564

Wellsite Geologist Kevin L. Howard  
Phone 316/267-7336

Designate Type of Completion  
XX New Well Re-Entry Workover  
Oil SWD Temp Abd  
Gas Inj Delayed Comp.  
XX Dry Other (Core, Water Supply etc.)

If OWNO: old well info as follows:  
Operator N/A  
Well Name  
Comp. Date Old Total Depth

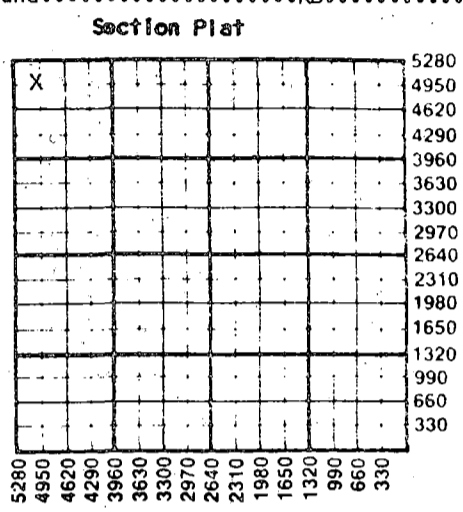

WATER SUPPLY INFORMATION  
Disposition of Produced Water: Disposal  
Docket # Repressuring

WELL HISTORY

Drilling Method:  
XX Mud Rotary Air Rotary Cable  
1-23-87... 1-30-87... 1-30-87...  
Spud Date Date Reached TD Completion Date  
4400' NA  
Total Depth PBTD

Amount of Surface Pipe Set and Cemented at 310'  
Multiple Stage Cementing Collar Used? Yes X No  
If yes, show depth set NA feet  
If alternate 2 completion, cement circulated from feet depth to w/SX cmt  
Cement Company Name  
Invoice #

Questions on this portion of the ACO-1 call:  
Water Resources Board (913) 296-3717  
Source of Water:  
Division of Water Resources Permit #  
X Groundwater Ft North from Southeast Corner (Well) Ft West from Southeast Corner of SW/4 Sec 4 Twp 15S Rge 28 West  
Mark Coberly Gove, Ks. 67736  
Surface Water Ft North from Southeast Corner (Stream, pond etc) Ft West from Southeast Corner Sec Twp Rge East West  
Other (explain) (purchased from city, R.W.D. #)

INSTRUCTIONS: This form shall be completed in triplicate and filed with the Kansas Corporation Commission, 200 Colorado Derby Building, Wichita, Kansas 67202, within 120 days of the spud date of any well. Rule 82-3-130, 82-3-107 and 82-3-106 apply. Information on side two of this form will be held confidential for a period of 12 months if requested in writing and submitted with the form. See rule 82-3-107 for confidentiality in excess of 12 months. One copy of all wireline logs and drillers time log shall be attached with this form. Submit CP-4 form with all plugged wells. Submit CP-111 form with all temporarily abandoned wells.

All requirements of the statutes, rules and regulations promulgated to regulate the oil and gas industry have been fully complied with and the statements herein are complete and correct to the best of my knowledge.

Signature Joseph D. Mace  
Title President Date 2-13-87

Subscribed and sworn to before me this 13th day of February 1987  
Notary Public Cheryl L. Idleman  
Date Commission Expires 1-30-89

K.C.C. OFFICE USE ONLY  
F Letter of Confidentiality Attached  
C Wireline Log Received  
C Drillers Timelog Received  
Distribution  
KCC SWD/Rep NGPA  
KGS Plug Other  
(Specify)  
STATE CORPORATION COMMISSION

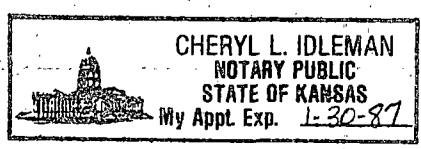

Form ACO-1 (5-86) 8 1987  
2-18-87  
CONSERVATION DIVISION  
Wichita, Kansas

Sec. 11, Twp. 15S, Rge. 28W

SIDE TWO

Operator Name ..... Energy Exploration, Inc. .... Lease Name ..... Bentley ..... Well # ..... 1 .....

Sec ..... 11 ..... Twp ..... 15S ..... Rge ..... 28 .....  East  West County ..... Gove .....

WELL LOG

INSTRUCTIONS: Show important tops and base of formations penetrated. Detail all cores. Report all drill stem tests giving interval tested, time tool open and closed, flowing and shut-in pressures, whether shut-in pressure reached static level, hydrostatic pressures, bottom hole temperature, fluid recovery, and flow rates if gas to surface during test. Attach extra sheet if more space is needed. Attach copy of log.

Drill Stem Tests Taken	<input checked="" type="checkbox"/> Yes	<input type="checkbox"/> No	Formation Description <input checked="" type="checkbox"/> Log <input checked="" type="checkbox"/> Sample
Samples Sent to Geological Survey	<input checked="" type="checkbox"/> Yes	<input type="checkbox"/> No	
Cores Taken	<input type="checkbox"/> Yes	<input checked="" type="checkbox"/> No	
	Name	Top	Bottom
	Formation	Sample	Log
DST #1 (Lns. J) 3975-3995, 30-60-60-60, Rec. 120' GIP, 35' OCM, IHP 2015, IFP 21-21, ISIP 701, FFP 32-32, FSIP 604, FHP 1971, Temp. 116°	Anhydrite	2003 +561	1996 +568
	Heebner	3716 -1152	3711 -1147
	Lansing	3754 -1190	3750 -1186
	Stark Shale	4002 -1438	3998 -1434
DST #2 (Lns. K) 3993-4027, 30-60-60-60, Rec. 60' GIP, 50' SOWCM (70% M, 20% W, 5% O, 5% G), 21,000 chl., 10' free oil, IHP 2036, IFP 32-32, ISIP 851, FFP 43-43, FSIP 776, FHP 2015, Temp. 116°	BKC	4068 -1504	4064 -1500
	Marmaton	4096 -1532	4096 -1532
	Altmont	4127 -1563	4116 -1552
	Pawnee	4172 -1608	4172 -1608
	Myric Station	4218 -1654	4218 -1654
	Fort Scott	4258 -1694	4254 -1690
	Cherokee Shale	4284 -1720	4280 -1716
	Mississippi	4365 -1801	4365 -1801
	Surface Clay	0	430
	Shale	430	2003
	Anhydrite	2003	3041
	Shale	3041	3355
	Lime/Shale	3355	3630
	Shale/Lime	3630	4068

CASING RECORD  New  Used Lime 4068 4400' RTD  
Report all strings set-conductor, surface, intermediate, production, etc.

Purpose of String	Size Hole Drilled	Size Casing Set (in O.D.)	Weight Lbs/Ft.	Setting Depth	Type of Cement	#Sacks Used	Type and Percent Additives
Surface	12 1/4"	8 5/8"	20#	310'	60/40	200	3% cc. 2% gel

Shots Per Foot	Specify Footage of Each Interval Perforated	Acid, Fracture, Shot, Cement Squeeze Record (Amount and Kind of Material Used)	Depth

TUBING RECORD Size Set At Packer at Liner Run  Yes  No

Date of First Production Producing Method  Flowing  Pumping  Gas Lift  Other (explain).....

Estimated Production Per 24 Hours	Oil Bbls	Gas MCF	Water Bbls	Gas-Oil Ratio	Gravity

METHOD OF COMPLETION Production Interval  
Disposition of gas:  Vented  Open Hole  Perforation  
 Sold  Other (Specify) .....  
 Used on Lease  Dually Completed  Commingled .....