

STATE CORPORATION COMMISSION OF KANSAS
OIL & GAS CONSERVATION DIVISION
WELL COMPLETION OR RECOMPLETION FORM
ACO-1 WELL HISTORY
DESCRIPTION OF WELL AND LEASE

API No. 15-15-063-20,962-8-00-01
County.....Gove
NW NE SW 24 14s 30 East
.....Sec.....Twp.....Rge.....xx West

Operator: License # 4842
Name Martin Petroleum, Inc.
Address PO Box 47610
..... Wichita, KS 67201
City/State/Zip

2310' Ft North from Southeast Corner of Section
3630' Ft West from Southeast Corner of Section
(Note: Locate well in section plat below)

Purchaser.....N/A.....

Lease Name.....OWWO Kinderknecht.....Well #.....1-24
Field Name.....Lundgren North.....

Operator Contact Person Roger L. Martin
Phone 316-682-0038.....

Producing Formation.....n/a.....
Elevation: Ground.....2676'.....KB.....2683'.....

Contractor: License # 5104
Name Blue Goose Drilling.....

Wellsite Geologist..... Roger L. Martin
Phone..... 316-682-0038.....

Designate Type of Completion
___ New Well ___ xx Re-Entry ___ Workover
___ Oil ___ SWD ___ Temp Abd
___ Gas ___ Inj ___ Delayed Comp.
XXX Dry ___ Other (Core, Water Supply etc.)

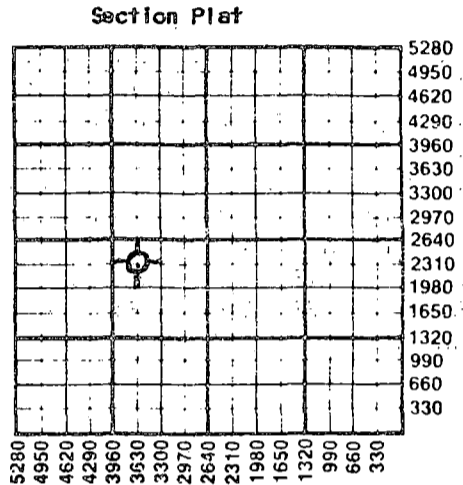

If OWWO: old well info as follows:
Operator White & Ellis Drilling.....
Well Name Kinderknecht #1.....
Comp. Date 9-3-85.....Old Total Depth.....
RTD 4418' LTD 4425'

WATER SUPPLY INFORMATION

Disposition of Produced Water: ___ Disposal
Docket # ___ Repressuring

WELL HISTORY

Drilling Method:
___ Mud Rotary ___ Air Rotary ___ Cable
..... 5-2-87..... 5-11-87..... 5-11-87.....
Spud Date Date Reached TD Completion Date
..... 4016'..... 4400'.....
Total Depth PBD

Questions on this portion of the ACO-1 call:
Water Resources Board (913) 296-3717
Source of Water:
Division of Water Resources Permit #.....
xx Groundwater.....Ft North from Southeast Corner
(Well)Ft West from Southeast Corner of
Sec Twp Rge East West
___ Surface Water.....Ft North from Southeast Corner
(Stream,pond etc).....Ft West from Southeast Corner
Sec Twp Rge East West
from Leroy Zerr, Grinnell, Kansas
___ Other (explain).....
(purchased from city, R.W.D. #)

Amount of Surface Pipe Set and Cemented at.....302.....feet
Multiple Stage Cementing Collar Used? ___ Yes ___ No
If yes, show depth set.....feet
If alternate 2 completion, cement circulated
from.....feet depth to.....w/.....SX cmt
Cement Company Name

INSTRUCTIONS: This form shall be completed in triplicate and filed with the Kansas Corporation Commission, 200 Colorado Derby Building, Wichita, Kansas 67202, within 120 days of the spud date of any well. Rule 82-3-130, 82-3-107 and 82-3-106 apply. Information on side two of this form will be held confidential for a period of 12 months if requested in writing and submitted with the form. See rule 82-3-107 for confidentiality in excess of 12 months. One copy of all wireline logs and drillers time log shall be attached with this form. Submit CP-4 form with all plugged wells. Submit CP-111 form with all temporarily abandoned wells.

All requirements of the statutes, rules and regulations promulgated to regulate the oil and gas industry have been fully complied with and the statements herein are complete and correct to the best of my knowledge.

Signature Roger L. Martin
Title.....President..... Date 5-27-87.....

Subscribed and sworn to before me this 27th day of May 1987
Notary Public..... J.A. Martin.....

Date Commission Expires..... 8-10-88.....

K.C.C. OFFICE USE ONLY
F ___ Letter of Confidentiality Attached
C ___ Wireline Log Received
C ___ Drillers Time Log Received
Distribution
KCC ___ SWD/Rep ___ NGPA
KGS ___ Plug ___ Other
RECEIVED
STATE CORPORATION COMMISSION
JUN 8 1987

J.A. Martin
NOTARY PUBLIC
State of Kansas
MY APPT. EXPIRES

JUN 19 1987

CONSERVATION DIVISION
Wichita, Kansas

Form ACO-1 (5-86)
CONSERVATION DIVISION
Wichita, Kansas

6-8-87

Sec: 24 Twp. 14 Rge. 30 W

SIDE TWO

Operator Name Martin Petroleum, Inc. Lease Name. OWD Kinderknecht Well # 1-24

Sec. 24 Twp. 14s Rge. 30 East West County..... Gove

WELL LOG

INSTRUCTIONS: Show important tops and base of formations penetrated. Detail all cores. Report all drill stem tests giving interval tested, time tool open and closed, flowing and shut-in pressures, whether shut-in pressure reached static level, hydrostatic pressures, bottom hole temperature, fluid recovery, and flow rates if gas to surface during test. Attach extra sheet if more space is needed. Attach copy of log.

Drill Stem Tests Taken Yes No
 Samples Sent to Geological Survey Yes No
 Cores Taken Yes No

Formation Description
 Log Sample

D.S.T. #1 3984' - 4016' Lans/KC "K" Zone
 Times: 30-45-90-60 1st Flow: Weak blow, building to good blow: 1/2 to 7/2" 2nd Flow: Weak blow, building to fair blow: 1/2 to 4".
 Recovery: 90' gas in pipe 15' Clean gassy oil
 16' oil & gas cut mud, 62' Oil & gas cut muddy water
 248' slightly muddy water to water 341' total fluid
 ISIP: 955 IFP: 54-64 IHP: 1976
 FSIP: 955 FFP: 102-162 FHP: 1965
 BHT: 121

| Name | Top | Bottom |
|-----------------|-------------|--------|
| Anhydrite | 2103' + 580 | |
| B/Anhydrite | 2136' + 547 | |
| Topeka | 3474' - 791 | |
| Heebner | 3702' -1019 | |
| Toronto | 3723' -1040 | |
| Lansing | 3739' -1056 | |
| Muncie Creek SH | 3895' -1212 | |
| Stark | 3987' -1304 | |
| K Zone | 3995' -1312 | |
| RTD | 4016' | |

| CASING RECORD <input type="checkbox"/> New <input type="checkbox"/> Used | | | | | | | |
|---|-------------------|---------------------------|----------------|---------------|----------------|-------------|----------------------------|
| Report all strings set-conductor, surface, intermediate, production, etc. | | | | | | | |
| Purpose of String | Size Hole Drilled | Size Casing Set (in O.D.) | Weight Lbs/Ft. | Setting Depth | Type of Cement | #Sacks Used | Type and Percent Additives |
| surface | | 8 5/8" | | 302 | 60/40 Poz | 300 | 2% gel 3% CaCl |
| | | | | | | | |
| | | | | | | | |

| PERFORATION RECORD | | Acid, Fracture, Shot, Cement Squeeze Record | |
|--------------------|---|---|-------|
| Shots Per Foot | Specify Footage of Each Interval Perforated | (Amount and Kind of Material Used) | Depth |
| | | | |
| | | | |
| | | | |

| TUBING RECORD | | Size | Set At | Packer at | Liner Run | <input type="checkbox"/> Yes <input type="checkbox"/> No |
|--------------------------|--|------|--------|-----------|-----------|--|
| Date of First Production | Producing Method <input type="checkbox"/> Flowing <input type="checkbox"/> Pumping <input type="checkbox"/> Gas Lift <input type="checkbox"/> Other (explain)..... | | | | | |

| Estimated Production Per 24 Hours | Oil | Gas | Water | Gas-Oil Ratio | Gravity |
|-----------------------------------|------|-----|-------|---------------|---------|
| | Bbls | MCF | Bbls | CFPB | |
| | | | | | |

METHOD OF COMPLETION

Production Interval

Disposition of gas: Vented Open Hole Perforation
 Sold Other (Specify)
 Used on Lease Dually Completed
 Commingled

PHONE: 483-2627

ALLIED CEMENTING COMPANY, INC.

P. O. BOX 31
RUSSELL, KANSAS 67665

TO: Martin Petroleum Inc.
P. O. Box 47610
Wichita, Kansas 67201

INVOICE NO. 48726
PURCHASE ORDER NO. _____
LEASE NAME Kinderknecht 1
DATE May 11, 1987

SERVICE AND MATERIALS AS FOLLOWS:

| | | |
|--------------------------|---------------|-----------|
| Common 110 sks @\$5.00 | \$ 550.00 | |
| Pozmxi 75 sks @\$2.10 | 157.50 | |
| Gel 4 sks @\$6.75 | 27.00 | |
| Chloride 5 sks. @\$20.00 | <u>100.00</u> | \$ 834.50 |

| | | |
|---|--------------|---------------|
| Handling 185 sks @\$0.75 | 138.75 | |
| Mileage (50) 185 sks @\$0.02c per sk per mi | 185.00 | |
| Plugging | 360.00 | |
| 1 plug | <u>20.00</u> | <u>703.75</u> |

| | | |
|------------------|-------|-------------|
| 20 sks. @2110' | | |
| 100sks. @1200' | | |
| 40 sks. @ 350' | | |
| 10 sks. @ 40' | | |
| 15 sks. in R. H. | | |
| | Total | \$ 1,538.25 |

307.65
1230.60

RECEIVED
STATE CORPORATION COMMISSION

THANK YOU

JUN 8 1987

All Prices Are Net, Payable 20th. of Month Following Date of Invoice. % of 1% Charged Thereafter

Handling 185

CONSERVATION DIVISION

Wichita, Kansas

75 138.7