

STATE CORPORATION COMMISSION OF KANSAS  
OIL & GAS CONSERVATION DIVISION  
WELL COMPLETION OR RECOMPLETION FORM  
ACO-1 WELL HISTORY  
DESCRIPTION OF WELL AND LEASE

Operator: License # 6839  
Name WACO, INC.  
Address 2225 E. 21st  
Wichita, Kansas  
City/State/Zip 67214

Purchaser Continental Oil Company  
Ponca City, Oklahoma

Operator Contact Person Mike Hanson  
Phone (316) 463-6785

Contractor: License # 5107  
Name H-30

Wellsite Geologist Lee Poulsen  
Phone (316) 262-0392

Designate Type of Completion  
 New Well  Re-Entry  Workover  
 Oil  SWD  Temp Abd  
 Gas  Inj  Delayed Comp.  
 Dry  Other (Core, Water Supply etc.)

If **OWWO**: old well info as follows:  
Operator .....  
Well Name .....  
Comp. Date ..... Old Total Depth.....

WELL HISTORY

Drilling Method:  Mud Rotary  Air Rotary  Cable  
9-14-79 9-19-79 11-08-79  
Spud Date Date Reached TD Completion Date  
3355 .....  
Total Depth PBDT

Amount of Surface Pipe Set and Cemented at 456 feet  
Multiple Stage Cementing Collar Used?  Yes  No  
If yes, show depth set 460 feet  
If alternate 2 completion, cement circulated  
from 0 feet depth to 456 w/ 350 SX cmt  
Cement Company Name Halliburton  
Invoice # N/A

API NO. 15-155-20, 1612-0000  
County RENO  
N2. SE 4 Sec. 7 Twp 24S Rge. 4 East  
1980 Ft North from Southeast Corner of Section  
660 Ft West from Southeast Corner of Section  
60990  
(Note: Locate well in section plat below)

Lease Name H. Bogner Well # 2

Field Name Burrton

Producing Formation Mississippian-Osage

Elevation: Ground 1480 KB 1485

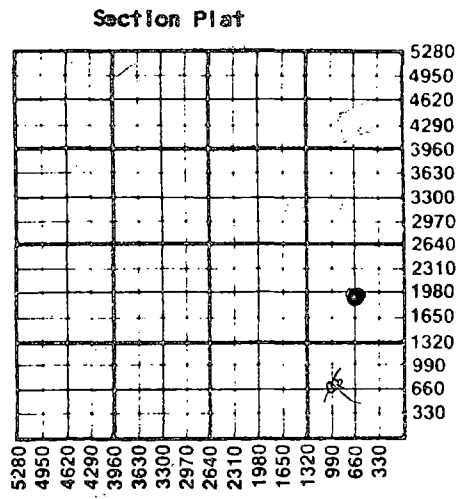

WATER SUPPLY INFORMATION

Disposition of Produced Water:  Disposal  
Docket # .....  Repressuring

Questions on this portion of the ACO-1 call:  
Water Resources Board (913) 296-3717

Source of Water:  
Division of Water Resources Permit #.....  
 Groundwater.....Ft North from Southeast Corner  
(Well) .....Ft West from Southeast Corner of  
Sec Twp Rge East West  
 Surface Water.....Ft North from Southeast Corner  
(Stream, pond etc).....Ft West from Southeast Corner  
Sec Twp Rge East West  
 Other (explain) Not Available  
(purchased from city, R.W.D. #)

INSTRUCTIONS: This form shall be completed in triplicate and filed with the Kansas Corporation Commission, 200 Colorado Derby Building, Wichita, Kansas 67202, within 120 days of the spud date of any well. Rule 82-3-130, 82-3-107 and 82-3-106 apply.  
Information on side two of this form will be held confidential for a period of 12 months if requested in writing and submitted with the form. See rule 82-3-107 for confidentiality in excess of 12 months.  
One copy of all wireline logs and drillers time log shall be attached with this form. Submit CP-4 form with all plugged wells. Submit CP-111 form with all temporarily abandoned wells.

All requirements of the statutes, rules and regulations promulgated to regulate the oil and gas industry have been fully complied with and the statements herein are complete and correct to the best of my knowledge.

Signature [Signature]  
Title President Date 7-17-80

Subscribed and sworn to before me this 17th day of July  
1980  
Notary Public Evelyn P. Horton  
Date Commission Expires Nov. 13, 1988

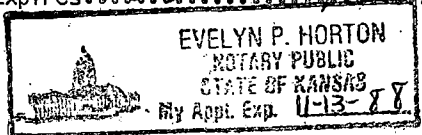

K.C.C. OFFICE USE ONLY  
F Letter of Confidentiality Attached  
C Wireline Log Received  
C Drillers Timelog Received  
Distribution  
 KCC  SWD/Rep  NGPA  
 KGS  Plug  Other  
**RECEIVED**  
STATE CORPORATION COMMISSION  
JUL 1 1987  
Form ACO-1 (5-86)

CONSERVATION DIVISION  
Wichita, Kansas  
CONSERVATION DIVISION  
Wichita, Kansas

Sec. 7, Twp. 24 Rge. 4

3-20-87

Operator Name WOCO, INC. Lease Name H. Bogner Well # 2

Sec. 7 Twp. 24 Rge. 4  East  West County RENO

WELL LOG

INSTRUCTIONS: Show important tops and base of formations penetrated. Detail all cores. Report all drill stem tests giving interval tested, time tool open and closed, flowing and shut-in pressures, whether shut-in pressure reached static level, hydrostatic pressures, bottom hole temperature, fluid recovery, and flow rates if gas to surface during test. Attach extra sheet if more space is needed. Attach copy of log.

Drill Stem Tests Taken  Yes  No  
 Samples Sent to Geological Survey  Yes  No  
 Cores Taken  Yes  No

Formation Description

Log  Sample

Name Top Bottom

BROWN LIME 2607  
 LANSING 2631  
 Kansas City 2845  
 Base-Kansas City 3054  
 Mississippian 3318  
 OSA9E 3353  
 RTD 3355

CASING RECORD <input checked="" type="checkbox"/> New <input type="checkbox"/> Used							
Report all strings set-conductor, surface, intermediate, production, etc.							
Purpose of String	Size Hole Drilled	Size Casing Set (in O.D.)	Weight Lbs/Ft.	Setting Depth	Type of Cement	#Sacks Used	Type and Percent Additives
Surface	12 7/8	8 7/8	28	4516	Common	350	5% GR, 3% CA, 1% SB
Production		5 1/2	14 1/2	3353	SK	150	
PERFORATION RECORD				Acid, Fracture, Shot, Cement Squeeze Record (Amount and Kind of Material Used)			
Shots Per Foot	Specify Footage of Each Interval Perforated					Depth	
	OPEN HOLE			Pressure 790		3360	
				10,000 lbs. SAND			
				500 BBBS. SALT-WATER			
TUBING RECORD				Liner Run <input type="checkbox"/> Yes <input type="checkbox"/> No			
Size	Set At	Packer at					
2 1/2	3356						
Date of First Production		Producing Method					
		<input type="checkbox"/> Flowing <input checked="" type="checkbox"/> Pumping <input type="checkbox"/> Gas Lift <input type="checkbox"/> Other (explain).....					
Estimated Production Per 24 Hours	Oil Bbls	Gas MCF	Water Bbls	Gas-Oil Ratio	Gravity		
	0	0	480		30		

METHOD OF COMPLETION

Production Interval

Disposition of gas:  Vented  Open Hole  Perforation  
 Sold  Other (Specify) .....  
 Used on Lease  Dually Completed  Commingled