

For KCC Use: Effective Date: 11-7-01 District #: 2 SGA?  Yes  No

KANSAS CORPORATION COMMISSION OIL & GAS CONSERVATION DIVISION

NOTICE OF INTENT TO DRILL

Must be approved by KCC five (5) days prior to commencing well

Form C-1 September 1999 Form must be Typed Form must be Signed All blanks must be Filled

Expected Spud Date: October 15, 2001

Spot: 30 29 7 W. East  West  SW SW - SE Sec. 30 Twp. 29 S. R. 7 feet from S / ~~XX~~ (circle one) Line of Section 330 feet from E / ~~XX~~ (circle one) Line of Section 2310 Is SECTION  Regular  Irregular?

OPERATOR: License# 8740 Name: Bramwell Petroleum, Inc. Address: 15183 SW 25 Ave City/State/Zip: Spivey, KS 67142 Contact Person: Don Bramwell Phone: 620-532-2770 CONTRACTOR: License# company tools Name: \_\_\_\_\_

(Note: Locate well on the Section Plat on reverse side) County: Kingman Lease Name: Wilson Well #: 3 Field Name: Spivey Grabs Is this a Protected / Spaced Field?  Yes  No Target Formation(s): Mississippi Nearest Lease or unit boundary: 330 ft Ground Surface Elevation: to be reported 1 day before Water well within one-quarter mile:  Yes  No Public water supply well within one mile:  Yes  No Depth to bottom of fresh water: 90 ft Depth to bottom of usable water: 90 ft 180' Surface Pipe by Alternate: 1 2 Length of Surface Pipe Planned to be set: 200 ft Length of Conductor Pipe required: n/a Projected Total Depth: 4200 ft Formation at Total Depth: Mississippi Water Source for Drilling Operations: Well  Farm Pond  Other \_\_\_\_\_ DWR Permit #: \_\_\_\_\_

Well Drilled For:  Oil  Gas  OAWO  Seismic; # of Holes \_\_\_\_\_ Other \_\_\_\_\_ Well Class:  Enh Rec  Storage  Disposal  Other \_\_\_\_\_ Type Equipment:  Infield  Pool Ext  Wildcat  Other \_\_\_\_\_  Mud Rotary  Air Rotary  Cable

If OWWO: old well information as follows: Operator: \_\_\_\_\_ Well Name: \_\_\_\_\_ Original Completion Date: \_\_\_\_\_ Original Total Depth: \_\_\_\_\_

Directional, Deviated or Horizontal wellbore?  Yes  No

If Yes, true vertical depth: \_\_\_\_\_

Bottom Hole Location: \_\_\_\_\_

KCC DKT #: \_\_\_\_\_

AFFIDAVIT

RECEIVED

SEP 18 2001

KCC WICHITA

The undersigned hereby affirms that the drilling, completion and eventual plugging of this well will comply with K.S.A. 55-101, et. seq. It is agreed that the following minimum requirements will be met:

- 1. Notify the appropriate district office prior to spudding of well;
2. A copy of the approved notice of intent to drill shall be posted on each drilling rig;
3. The minimum amount of surface pipe as specified below shall be set by circulating cement to the top; in all cases surface pipe shall be set through all unconsolidated materials plus a minimum of 20 feet into the underlying formation.
4. If the well is dry hole, an agreement between the operator and the district office on plug length and placement is necessary prior to plugging;
5. The appropriate district office will be notified before well is either plugged or production casing is cemented in;
6. If an ALTERNATE II COMPLETION, production pipe shall be cemented from below any usable water to surface within 120 days of spud date. In all cases, NOTIFY district office prior to any cementing.

I hereby certify that the statements made herein are true and to the best of my knowledge and belief.

Date: 9-17-01 Signature of Operator or Agent: Don Bramwell Title: President

For KCC Use ONLY API # 15: 095-21804-0000 Conductor pipe required: NONE feet Minimum surface pipe required: 200' feet per Alt.  Approved by: DPW 11-2-01 This authorization expires: 5-2-02 (This authorization void if drilling not started within 6 months of effective date.) Spud date: \_\_\_\_\_ Agent: \_\_\_\_\_

Remember to:

- File Drill Pit Application (form CDP-1) with Intent to Drill;
- File Completion Form ACC-1 within 120 days of spud date;
- File acreage attribution plat according to field proration orders;
- Notify appropriate district office 48 hours prior to workover or re-entry;
- Submit plugging report (CP-4) after plugging is completed;
- Obtain written approval before disposing or injecting salt water.

30 29 7 W

Mail to: KCC - Conservation Division, 130 S. Market - Room 2076, Wichita, Kansas 67202

RECEIVED

SEP 21 2001 09-21-01 KCC WICHITA

Side Two

IN ALL CASES PLOT THE INTENDED WELL ON THE PLAT BELOW

Plat of acreage attributable to a well in a prorated or spaced field

If the intended well is in a prorated or spaced field, please fully complete this side of the form. If the intended well is in a prorated or spaced field complete the plat below showing that the well will be properly located in relationship to other wells producing from the common source of supply. Please show all the wells and within 1 mile of the boundaries of the proposed acreage attribution unit for gas wells and within 1/2 mile of the boundaries of the proposed acreage attribution unit for oil wells.

API No. 15 - \_\_\_\_\_
Operator: Bramwell Petroleum, Inc
Lease: Wilson
Well Number: #3
Field: Spivey Grabs
Number of Acres attributable to well: \_\_\_\_\_
QTR / QTR / QTR of acreage: \_\_\_\_\_

Location of Well: County: Kingman
330 feet from S /XX(circle one) Line of Section
2310 feet from E /XX(circle one) Line of Section
Sec. 30 Twp. 29 S. R. 7
is Section X Regular or \_\_\_\_\_ irregular
If Section is irregular, locate well from nearest corner boundary.
Section corner used: \_\_\_\_\_ NE \_\_\_\_\_ NW \_\_\_\_\_ SE \_\_\_\_\_ SW

PLAT

(Show location of the well and shade attributable acreage for prorated or spaced wells.)
(Show footage to the nearest lease or unit boundary line.)

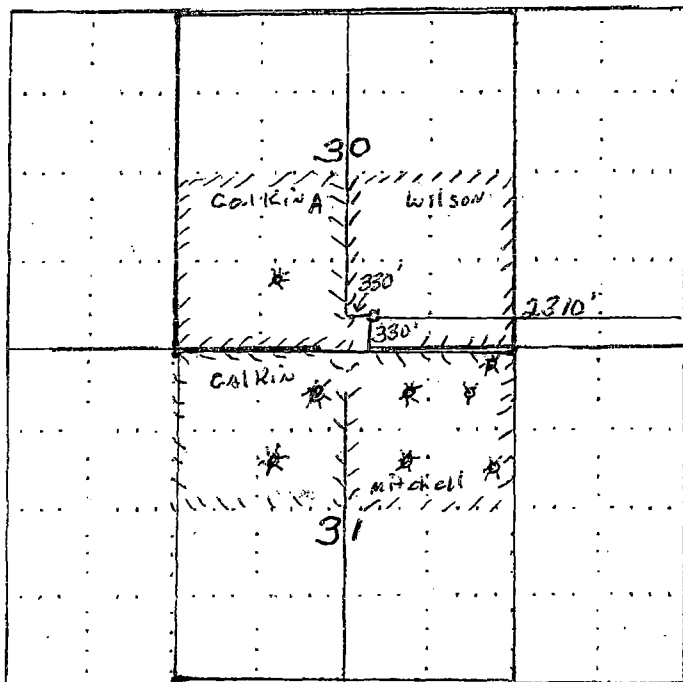

RECEIVED
SEP 18 2001
KCC WICHITA

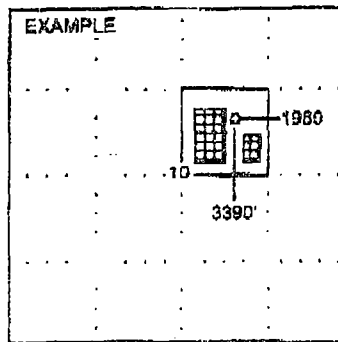

NOTE: In all cases locate the spot of the proposed drilling location.

In plotting the proposed location of the well, you must show:

- 1. The manner in which you are using the depicted plat by identifying section lines, i.e. 1 section, 1 section with 8 surrounding sections, 4 sections, etc.
2. The distance of the proposed drilling location from the section's south / north and east / west.
3. The distance to the nearest lease or unit boundary line.
4. If proposed location is located within a prorated or spaced field a certificate of acreage attribution plat must be attached: (CO-7 for oil wells; CG-8 for gas wells).

RECEIVED

SEP 21 2001

KCC WICHITA