

STATE CORPORATION COMMISSION OF KANSAS
OIL & GAS CONSERVATION DIVISION
WELL COMPLETION OR RECOMPLETION FORM
ACO-1 WELL HISTORY
DESCRIPTION OF WELL AND LEASE

API NO. 15-055-20,820-0000

County... Finney

SE SE SE Sec. 28 Twp. 24 Rge. 34 East
X West

330 Ft North from Southeast Corner of Section
330 Ft West from Southeast Corner of Section
(Note: Locate well in section plat below)

Lease Name... Brown "B" Well #... 1-28

Field Name... Wildcat Brounkel

Producing Formation... Morrow Sand

Elevation: Ground... 2960 KB... 2970

Operator: License # 5003
Name McCoy Petroleum Corporation
Address 110 S. Main, Suite 500
City/State/Zip Wichita, Kansas 67202

Purchaser Koch Oil Company
Wichita, Kansas

Operator Contact Person John Roger McCoy
Phone (316) 265-9697

Contractor: License # 5658
Name Sweetman Drilling, Inc.

Wellsite Geologist John Hastings
Phone (316) 265-9697

Designate Type of Completion
X New Well Re-Entry Workover
X Oil SWD Temp Abd
Gas Inj Delayed Comp
Dry Other (Core, Water Supply etc.)

If OWWO: old well info as follows:
Operator
Well Name
Comp. Date Old Total Depth

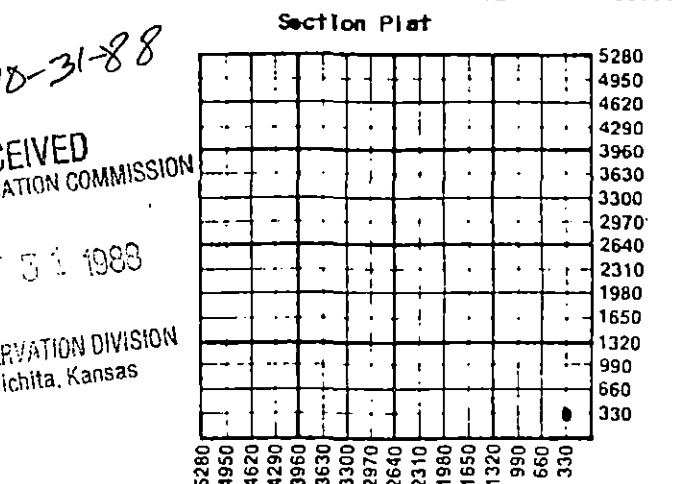

WATER SUPPLY INFORMATION
Disposition of Produced Water: Disposal
Docket # Repressuring

Questions on this portion of the ACO-1 call:
Water Resources Board (913) 296-3717
Source of Water:
Division of Water Resources Permit # T88-478
X Groundwater... 330... Ft North from Southeast Corner
(Well) .. 200... Ft West from Southeast Corner of
Sec 28 Twp 24 Rge 34 East X West
Surface Water... Ft North from Southeast Corner
(Stream, pond etc)... Ft West from Southeast Corner
Sec Twp Rge East West
Other (explain) (purchased from city, R.W.D. #)

WELL HISTORY

Drilling Method:
X Mud Rotary Air Rotary Cable
9-23-88 10-4-88 10-21-88
Spud Date Date Reached TD Completion Date
5075' 5021'
Total Depth PBTD
Amount of Surface Pipe Set and Cemented at 1898 feet
Multiple Stage Cementing Collar Used? X Yes No
If yes, show depth set 3158' feet
If alternate 2 completion, cement circulated
from... feet depth to... w/... SX cmt
Cement Company Name
Invoice # AFI

INSTRUCTIONS: This form shall be completed in triplicate and filed with the Kansas Corporation Commission, 200 Colorado Derby Building, Wichita, Kansas 67202, within 120 days of the spud date of any well. Rule 82-3-130, 82-3-107 and 82-3-106 apply. Information on side two of this form will be held confidential for a period of 12 months if requested in writing and submitted with the form. See rule 82-3-107 for confidentiality in excess of 12 months. One copy of all wireline logs and drillers time log shall be attached with this form. Submit CP-4 form with all plugged wells. Submit CP-111 form with all temporarily abandoned wells.

All requirements of the statutes, rules and regulations promulgated to regulate the oil and gas industry have been fully complied with and the statements herein are complete and correct to the best of my knowledge.

Signature John Roger McCoy
Title President Date 10-21-88

Subscribed and sworn to before me this 25th day of October 1988...
Notary Public Deborah Ann Paulus

Date Commission Expires January 8, 1992

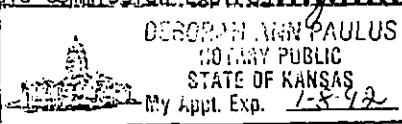

K.C.C. OFFICE USE ONLY
F Letter of Confidentiality Attached
C Wireline Log Received
C Drillers Timelog Received
Distribution
KCC SWD/Rep NGPA
KGS Plug Other
(Specify)
10-31-88
Form ACO-1 (5-86)

RECEIVED
STATE CORPORATION COMMISSION

OCT 31 1988

CONSERVATION DIVISION
Wichita, Kansas

Sec 28, Twp 24, Rge 34 East

Operator Name **McCoy Petroleum Corporation** Lease Name **Brown "B"** Well # **1-28**

RELEASED

Sec. **28** Twp. **24S** Rge. **34** County **Finney**

MAR 07 1990

WELL LOG

FROM CONFIDENTIAL

INSTRUCTIONS: Show important tops and base of formations penetrated. Detail all cores. Report all drill stem tests giving interval tested, time tool open and closed, flowing and shut-in pressures, whether shut-in pressure reached static level, hydrostatic pressures, bottom hole temperature, fluid recovery, and flow rates if gas to surface during test. Attach extra sheet if more space is needed. Attach copy of log.

Drill Stem Tests Taken Yes No
 Samples Sent to Geological Survey Yes No
 Cores Taken Yes No

Formation Description
 Log Sample

DST #1 4722 - 4800' (Morrow Sand)
 Open 30", S.I. 45", Open 60", S.I. 60"
 Strong blow.

Recovered 2784' of total fluid as follows:
 479' of gas cut oil (top 180' grinds out 20% gas, 55% oil, 15% water, 10% mud; next 279' grinds out 20% gas, 65% oil, 10% water, 5% mud)
 558' of heavily oil cut water (top 279' grinds out 50% gas, 20% oil, 30% water; next 279' grinds out 20% gas, 30% oil, 50% water)
 93' of gassy oil cut water (grinds out 30% gas, 10% oil, 60% water)
 1694' of salt water (87,000 ppm chlorides)
 ISIP 1231# FSIP 1231#
 FP 80-1231# 1231-1231#

Name	Top	Bottom
ELECTRIC LOG TOPS		
Winfield	2526	(+ 444)
Council Grove	2744	(+ 226)
Wabaunsee	3172	(- 202)
Heebner	3777	(- 807)
Toronto	3192	(- 822)
Lansing	3820	(- 850)
Stark	4248	(-1272)
Marmaton	4364	(-1394)
Pawnee	4444	(-1474)
Fort Scott	4485	(-1515)
Cherokee	4491	(-1521)
Atoka	4671	(-1701)
Morrow Shale	4728	(-1758)
Morrow Sand	4773	(-1803)
St. Genevieve	4848	(-1878)
St. Louis	4891	(-1921)
St. Louis "C" Zone	4977	(-2007)
Log Total Depth	5073	(-2103)

DST #2 4973 - 4997' (St. Louis "C" Zone)
 Open 30", S.I. 45", Open 60", S.I. 60"
 Weak steady blow throughout test.
 Recovered 10' of oil spotted mud and 190' of muddy water (32,000 ppm chlorides).
 ISIP 1263# FSIP 1231#
 FP 54-54# 108-108#

CASING RECORD New Used
 Report all strings set-conductor, surface, intermediate, production, etc.

Purpose of String	Size Hole Drilled	Size Casing Set (In O.D.)	Weight Lbs/Ft.	Setting Depth	Type of Cement	#Sacks Used	Type and Percent Additives
DV Tool				3158'	Light Prem	60	
Surface	12-1/4"	8-5/8"	24#	1898'	Light Premium	575	2%cc # Flocele
Production		5-1/2"	15.5#	5071'	Thixset	175	2%cc # Flocele 3%KCL # Flocele

Shots Per Foot	Specify Footage of Each Interval Perforated	Acid, Fracture, Shot, Cement Squeeze Record (Amount and Kind of Material Used)	Depth
2	4774-4776'	None	

TUBING RECORD Size **2-7/8"** Set At **4770'** Packer at _____ Liner Run Yes No

Date of First Production **19-21-88** Producing Method Flowing Pumping Gas Lift Other (explain).....

Estimated Production Per 24 Hours	Oil Bbls	Gas MCF	Water Bbls	Gas-Oil Ratio	Gravity
	48.35		67		

METHOD OF COMPLETION Production Interval

Disposition of gas: Vented Open Hole Perforation Sold Other (Specify) **Morrow Sand**
 Used on Lease Dully Completed **4774-4776'**
 Conmingled