

STATE CORPORATION COMMISSION OF KANSAS
OIL & GAS CONSERVATION DIVISION
WELL COMPLETION OR RECOMPLETION FORM
ACO-1 WELL HISTORY
DESCRIPTION OF WELL AND LEASE

API NO. 15-083-21-253-0000
County.....Hodgeman
C NE SW Sec 8 Twp 24S Rge 24 East
..... West

Operator: License # 4704
Name True Oil Company
Address P. O. Box 2360
City/State/Zip Casper, WY 82602

1980 Ft North from Southeast Corner of Section
3300 Ft West from Southeast Corner of Section
(Note: Locate well in section plat below)

Purchaser.....

Lease Name.....Charles Well # 23-8

Operator Contact Person C. F. Pickard
Phone 307-266-0230

Field Name.....Wildcat

Producing Formation.....N/A

Contractor: License # 4708
Name True Drilling Company

Elevation: Ground.....2502 KB 2516 KC-R, LL

Wellsite Geologist Roger Matson
Phone 303-741-1231

Designate Type of Completion
X New Well Re-Entry Workover
X Oil-PLUGGED SWD Temp Abd
Gas Inj Delayed Comp.
Dry Other (Core, Water Supply etc.)

If OWNED: old well info as follows:
Operator
Well Name
Comp. Date Old Total Depth

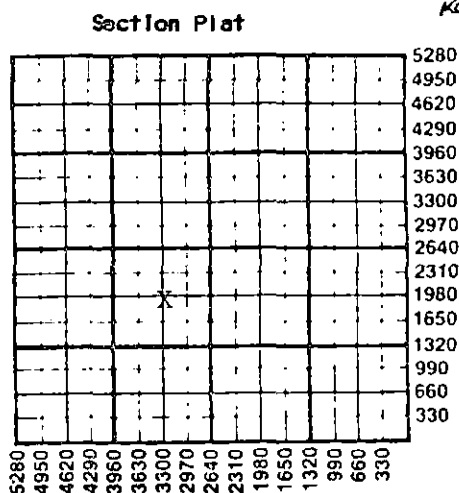

WATER SUPPLY INFORMATION

Disposition of Produced Water: Disposal
Docket # N/A Repressuring

Questions on this portion of the ACO-1 call:
Water Resources Board (913) 296-3717

Source of Water:
Division of Water Resources Permit #

Groundwater.....Ft North from Southeast Corner
(Well)Ft West from Southeast Corner of
Sec Twp Rge East West

Surface Water.....Ft North from Southeast Corner
(Stream, pond etc).....Ft West from Southeast Corner
Sec Twp Rge East West

Other (explain) Private landowner - water well
(purchased from city, R.W.D. #)

WELL HISTORY

Drilling Method:
X Mud Rotary Air Rotary Cable
7/10/86 7/18/86 7/19/86
Spud Date Date Reached TD Completion Date
4875 None
Total Depth PBTD

Amount of Surface Pipe Set and Cemented at 505 feet
Multiple Stage Cementing Collar Used? Yes No
If yes, show depth set feet
If alternate 2 completion, cement circulated
from feet depth to w/ SX cmt
Cement Company Name Halliburton
Invoice #

INSTRUCTIONS: This form shall be completed in triplicate and filed with the Kansas Corporation Commission, 200 Colorado Derby Building, Wichita, Kansas 67202, within 120 days of the spud date of any well. Rule 82-3-130, 82-3-107 and 82-3-106 apply. Information on side two of this form will be held confidential for a period of 12 months if requested in writing and submitted with the form. See rule 82-3-107 for confidentiality in excess of 12 months. One copy of all wireline logs and drillers time log shall be attached with this form. Submit CP-4 form with all plugged wells. Submit CP-111 form with all temporarily abandoned wells.

All requirements of the statutes, rules and regulations promulgated to regulate the oil and gas industry have been fully complied with and the statements herein are complete and correct to the best of my knowledge.

Signature C. F. Pickard
Title Engineer Date July 21, 1986

Subscribed and sworn to before me this 21 day of July 1986
Notary Public
Date Commission Expires

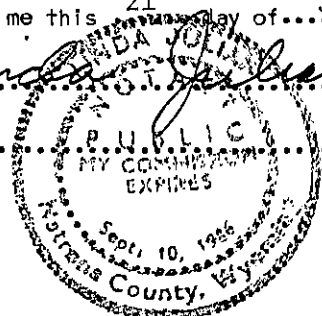

K.C.C. OFFICE USE ONLY
F Letter of Confidentiality Attached
C Wireline Log Received
C Drillers Timelog Received
Distribution
KCC SWD/Rep NGPA
KGS Plug Other
RECEIVED
STATE CORPORATION COMMISSION
CONB. DIV. WICHITA, KS

Operator Name True Oil Company Lease Name Charles Well # 23-8

Sec. 8 Twp. 24S Rge. 24 East West County Hodgeman

WELL LOG

INSTRUCTIONS: Show important tops and base of formations penetrated. Detail all cores. Report all drill stem tests giving interval tested, time tool open and closed, flowing and shut-in pressures, whether shut-in pressure reached static level, hydrostatic pressures, bottom hole temperature, fluid recovery, and flow rates if gas to surface during test. Attach extra sheet if more space is needed. Attach copy of log.

Drill Stem Tests Taken Yes No
 Samples Sent to Geological Survey Yes No
 Cores Taken Yes No

Formation Description
 Log Sample

Name	Top	Bottom
Blaine	1148	
Stone Corral	1682	
Wellington Anhydrite	2109	
Herington	2604	
Neva	3132	
Topeka	3595	
Heebner	4068	
Lansing	4162	
Kansas City	4340	
Marmaton	4571	
Cherokee	4684	
Chert	4774	
Mississippian	4794	
Dolomite	4828	

CASING RECORD <input type="checkbox"/> New <input type="checkbox"/> Used							
Report all strings set-conductor, surface, intermediate, production, etc.							
Purpose of String	Size Hole Drilled	Size Casing Set (in O.D.)	Weight Lbs/Ft.	Setting Depth	Type of Cement	#Sacks Used	Type and Percent Additives
Surface	12"	8-5/8"	24#	505	Lite Poz	175 100	3% CaCl
PERFORATION RECORD				Acid, Fracture, Shot, Cement Squeeze Record			
Shots Per Foot	Specify Footage of Each Interval Perforated			(Amount and Kind of Material Used)		Depth	
TUBING RECORD				Liner Run <input type="checkbox"/> Yes <input type="checkbox"/> No			
Date of First Production		Producing Method <input type="checkbox"/> Flowing <input type="checkbox"/> Pumping <input type="checkbox"/> Gas Lift <input type="checkbox"/> Other (explain)					
Estimated Production Per 24 Hours	Oil	Gas	Water	Gas-Oil Ratio	Gravity		
	Bbls	MCF	Bbls	CFPB			

METHOD OF COMPLETION

Production Interval

Disposition of gas: Vented Open Hole Perforation
 Sold Other (Specify)
 Used on Lease Dually Completed
 Comingled