

CARD MUST BE TYPED

State of Kansas

CARD MUST BE SIGNED

NOTICE OF INTENTION TO DRILL

(see rules on reverse side)

Expected Spud Date... March 27, 1987  
month day year

API Number 15-095-20,521-0001

OPERATOR: License # 5003  
Name McCoy Petroleum Corporation  
Address 110 S. Main, Suite 500  
City/State/Zip Wichita, Kansas 67202  
Contact Person Roger McCoy  
Phone 265-9697

SE NE NE Sec. 16 Twp. 30 S, Rg. 7 West  
4290 Ft. from South Line of Section  
330 Ft. from East Line of Section

(Note: Locate well on Section Plat on reverse side)

CONTRACTOR: License # 5429  
Name Hayes Well Service  
City/State Attica, Kansas

Nearest lease or unit boundary line 330 feet  
County Kingman  
Lease Name Helen Well # 1  
Ground surface elevation 1446 feet MSL

Well Drilled For: Well Class: Type Equipment:  
X Oil Storage X Infield X Mud Rotary  
X Gas Inj Pool Ext Air Rotary  
X OWWO Expl Wildcat Cable

Domestic well within 330 feet: yes X no  
Municipal well within one mile: yes X no  
Depth to bottom of fresh water 72  
Depth to bottom of usable water 311  
Surface pipe by Alternate: 1 X 2  
Surface pipe set @ 311 w/250 sx

If OWWO: old well info as follows:

Operator McCoy Petroleum Company  
Well Name #1 Simon  
Comp Date 9-26-76 Old Total Depth 4160

Conductor pipe required  
Projected Total Depth 4160 feet  
Formation Mississippian

I certify that well will comply with K.S.A. 55-101, et seq., plus eventually plugging hole to KCC specifications.

Date 3-19-87 Signature of Operator or Agent Roger McCoy Title President

For KCC Use:

Conductor Pipe Required feet; Minimum Surface Pipe Required 311 feet per Alt.  
This Authorization Expires 9-20-87 Approved By 3-20-87

Handwritten signatures and initials at the bottom right of the document.

Must be filed with the K.C.C. five (5) days prior to commencing well  
 This card void if drilling not started within six (6) months of date received by K.C.C.

Important procedures to follow:

A Regular Section of Land  
 1 Mile = 5,280 Ft.

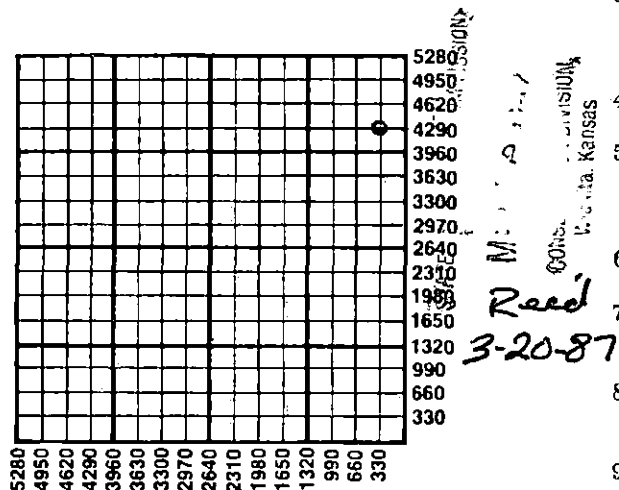

1. Notify District office before setting surface casing.
2. Set surface casing by circulating cement to the top.
3. File completion forms ACO-1 with K.C.C. within 120 days of well spud date, following instructions on ACO-1, side 1, and including copies of wireline logs.
4. Notify District office 48 hours prior to old well workover or re-entry.
5. Prior to filing Intent, prepare a proposed plugging plan in case well is D & A, then obtain approval of plan when calling district office prior to setting surface pipe.
6. Submit plugging report (CP-4) to K. C. C. after plugging is completed.
7. Obtain an approved injection docket number before disposing of salt water.
8. Notify K.C.C. within 10 days when injection commences or terminates.
9. If an alternate 2 completion, cement in the production pipe from below any usable water to surface within 120 days of spud date.

State Corporation Commission of Kansas  
 Conservation Division  
 200 Colorado Derby Building  
 Wichita, Kansas 67202-1212  
 (316) 263-3238