

For KCC Use: Effective Date: 7-20-03 District # 2 SGA?  Yes  No

KANSAS CORPORATION COMMISSION OIL & GAS CONSERVATION DIVISION

<sup>first</sup> CORRECTED

Form C-1 December 2002 Form must be Typed Form must be Signed All blanks must be Filled

NOTICE OF INTENT TO DRILL

Must be approved by KCC five (5) days prior to commencing well \*\*\*CORRECTION\*\*\*

Expected Spud Date August 25, 2003 month day year

\* Spot 70' E of SW SW SE Sec. 19 Twp. 30 S. R. 6  East  West 330 feet from  N /  S Line of Section \* 2240 feet from  E /  W Line of Section Is SECTION  Regular  Irregular?

OPERATOR: License# 30357 Name: MKJ OIL COMPANY, L.L.C. Address: 705 East Ninth Street City/State/Zip: Harper, Kansas 67058 Contact Person: Marland Bergman Phone: 620/896-2333

(Note: Locate well on the Section Plat on reverse side) County: Kingman Lease Name: Bergman Well #: 2 Field Name: Rieda

CONTRACTOR: License# 5929 Name: DUKE DRILLING CO., INC.

Is this a Prorated / Spaced Field?  Yes  No Target Information(s): Simpson

Well Drilled For: Well Class: Type Equipment:  Oil  Enh Rec  Infield  Mud Rotary  Gas  Storage  Pool Ext.  Air Rotary  OWO  Disposal  Wildcat  Cable  Seismic; # of Holes  Other  Other

Nearest Lease or unit boundary: 330 Ground Surface Elevation: 1481 feet MSL

If OWWO: old well information as follows: Operator: Well Name: Original Completion Date: Original Total Depth:

Water well within one-quarter mile:  Yes  No Public water supply well within one mile:  Yes  No

Directional, Deviated or Horizontal wellbore?  Yes  No

Depth to bottom of fresh water: 150' Depth to bottom of usable water: 180'

If Yes, true vertical depth: Bottom Hole Location: KCC DKT #:

Surface Pipe by Alternate:  1  2 Length of Surface Pipe Planned to be set: 200+

Original Completion Date: Original Total Depth:

Length of Conductor Pipe required: None Projected Total Depth: 4600'

Directional, Deviated or Horizontal wellbore?  Yes  No

Formation at Total Depth: Simpson Water Source for Drilling Operations:  Well  Farm Pond  Other

Directional, Deviated or Horizontal wellbore?  Yes  No

DWR Permit #: (Note: Apply for Permit with DWR )

Directional, Deviated or Horizontal wellbore?  Yes  No

Will Cores be taken?  Yes  No

Directional, Deviated or Horizontal wellbore?  Yes  No

If Yes, proposed zone:

\* Was: 135' E of SWSW SE, 2175' FWL Is: 70' E of SWSW SE, 2240' FWL

AFFIDAVIT

RECEIVED KANSAS CORPORATION COMMISSION

AUG 11 2003

The undersigned hereby affirms that the drilling, completion and eventual plugging of this well will comply with K.S.A. 55 et. seq. It is agreed that the following minimum requirements will be met:

CONSERVATION DIVISION WICHITA, KS

- 1. Notify the appropriate district office prior to spudding of well;
2. A copy of the approved notice of intent to drill shall be posted on each drilling rig;
3. The minimum amount of surface pipe as specified below shall be set by circulating cement to the top; in all cases surface pipe shall be set through all unconsolidated materials plus a minimum of 20 feet into the underlying formation.
4. If the well is dry hole, an agreement between the operator and the district office on plug length and placement is necessary prior to plugging;
5. The appropriate district office will be notified before well is either plugged or production casing is cemented in;
6. If an ALTERNATE II COMPLETION, production pipe shall be cemented from below any usable water to surface within 120 days of spud date. Or pursuant to Appendix "B" - Eastern Kansas surface casing order #133,891-C, which applies to the KCC District 3 area, alternate II cementing must be completed within 30 days of the spud date or the well shall be plugged. In all cases, NOTIFY district office prior to any cementing.

I hereby certify that the statements made herein are true and to the best of my knowledge and belief.

Date: August 11, 2003 Signature of Operator or Agent: Sally S. Byers Title: Agent

Remember to:

- File Drill Pit Application (form CDP-1) with Intent to Drill;
- File Completion Form ACO-1 within 120 days of spud date;
- File acreage attribution plat according to field proration orders;
- Notify appropriate district office 48 hours prior to workover or re-entry;
- Submit plugging report (CP-4) after plugging is completed;
- Obtain written approval before disposing or injecting salt water.
- If this permit has expired (See: authorized expiration date) please check the box below and return to the address below.

Well Not Drilled - Permit Expired Signature of Operator or Agent: Date:

For KCC Use ONLY API # 15 - 095-21845-00-00 Conductor pipe required None feet Minimum surface pipe required 200 feet per Alt. (1) Approved by: RJP 7-15-03 REP 8-14-03 This authorization expires: 1-15-04 (This authorization void if drilling not started within 6 months of effective date.) Spud date: Agent:

Mall to: KCC - Conservation Division, 130 S. Market - Room 2078, Wichita, Kansas 67202

19 30 60

**IN ALL CASES PLOT THE INTENDED WELL ON THE PLAT BELOW**

*Plat of acreage attributable to a well in a prorated or spaced field*

*If the intended well is in a prorated or spaced field, please fully complete this side of the form. If the intended well is in a prorated or spaced field complete the plat below showing that the well will be properly located in relationship to other wells producing from the common source of supply. Please show all the wells and within 1 mile of the boundaries of the proposed acreage attribution unit for gas wells and within 1/2 mile of the boundaries of the proposed acreage attribution unit for oil wells.*

API No. 15 - \_\_\_\_\_  
 Operator: MKJ OIL COMPANY, L.L.C.  
 Lease: Bergman  
 Well Number: 2  
 Field: Rieda

Number of Acres attributable to well: \_\_\_\_\_  
 QTR / QTR / QTR of acreage: SW - SW - SE

Location of Well: County: Kingman  
330 feet from  N /  S Line of Section  
2240 feet from  E /  W Line of Section  
 Sec. 19 Twp. 30 S. R. 6  East  West

Is Section:  Regular or  Irregular

If Section is Irregular, locate well from nearest corner boundary.  
 Section corner used:  NE  NW  SE  SW

**PLAT**

*(Show location of the well and shade attributable acreage for prorated or spaced wells.)  
 (Show footage to the nearest lease or unit boundary line.)*

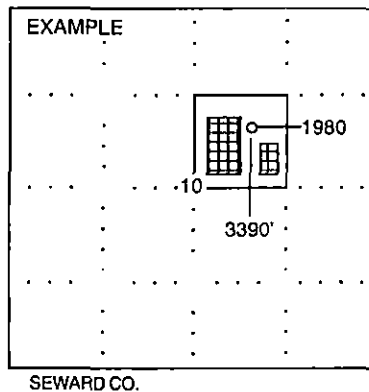
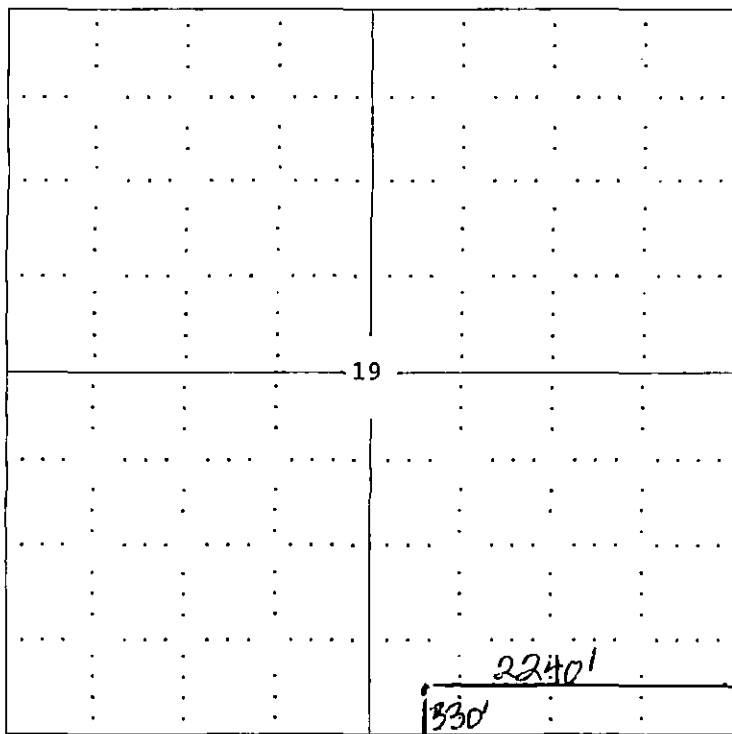

**NOTE: In all cases locate the spot of the proposed drilling location.**

**KINGMAN COUNTY:**

**In plotting the proposed location of the well, you must show:**

1. The manner in which you are using the depicted plat by identifying section lines, i.e. 1 section, 1 section with 8 surrounding sections, 4 sections, etc.
2. The distance of the proposed drilling location from the section's south / north and east / west.
3. The distance to the nearest lease or unit boundary line.
4. If proposed location is located within a prorated or spaced field a certificate of acreage attribution plat must be attached: (CO-7 for oil wells; CG-8 for gas wells).