

FOR KCC USE:

FORM C-1 7/91

EFFECTIVE DATE: 6-3-94

State of Kansas
NOTICE OF INTENTION TO DRILL

FORM MUST BE TYPED
FORM MUST BE SIGNED
ALL BLANKS MUST BE FILLED

DISTRICT # 2
SGA7. Yes No

Must be approved by the K.C.C. five (5) days prior to commencing well

Expected Spud Date June 5 1996
month day year

Spot SE East
C. 31 NE. Sec. 31 Twp 30 S, Rg 7 X West

OPERATOR: License # 9408
Name: Trans. Pacific Oil Corporation
Address: 100 N. Main, Ste. 1000
City/State/Zip: Wichita, KS 67202
Contact Person: Alan Banta
Phone: (316) 262-3596

3300-3775 feet from South line of Section
-660 560 feet from East line of Section
IS SECTION X REGULAR IRREGULAR?

(NOTE: Locate well on the Section Plat on Reverse Side)
County: Kingman
Lease Name: Shelley Well #: 1-31
Field Name: Hostetler

CONTRACTOR: License #: 5123
Name: Pickrell Drilling Co., Inc

Is this a Prorated/Spaced Field? yes X no
Target Formation(s): Simpson
Nearest lease or unit boundary: 660'
Ground Surface Elevation: 1630 Est. feet MSL
Water well within one-quarter mile: yes X no
Public water supply well within one mile: yes X no
Depth to bottom of fresh water: 105'
Depth to bottom of usable water: 180'
Surface Pipe by Alternate: X 1 2
Length of Surface Pipe Planned to be set: 250'
Length of Conductor pipe required: None
Projected Total Depth: 4800'
Formation at Total Depth: Simpson
Water Source for Drilling Operations:
 Well farm pond X other
DWR Permit #: _____
Will Cores Be Taken?: yes X no
If yes, proposed zone: _____

Well Drilled For: Well Class: Type Equipment:
X Oil ... Enh Rec ... Infield X Mud Rotary
X Gas ... Storage X Pool Ext. ... Air Rotary
... OWD ... Disposal ... Wildcat ... Cable
... Seismic; ... # of Holes ... Other
... Other
If OWD: old well information as follows:
Operator: _____
Well Name: _____
Comp. Date: _____ Old Total Depth _____

Directional, Deviated or Horizontal wellbore? yes X no
If yes, true vertical depth: _____
Bottom Hole Location: _____

* Prorated on MISS: SPIVEY GRABS ORDER AFFIDAVIT

The undersigned hereby affirms that the drilling, completion and eventual plugging of this well will comply with K.S.A. 55-101, et. seq.
It is agreed that the following minimum requirements will be met:

1. Notify the appropriate district office prior to spudding of well;
2. A copy of the approved notice of intent to drill shall be posted on each drilling rig;
3. The minimum amount of surface pipe as specified below shall be set by circulating cement to the top of the underlying formation; surface pipe shall be set through all unconsolidated materials plus a minimum of 20 feet into the underlying formation;
4. If the well is dry hole, an agreement between the operator and the district office on plug length and placement is necessary prior to plugging;
5. The appropriate district office will be notified before well is either plugged or production casing is cemented in;
6. IF AN ALTERNATE II COMPLETION, PRODUCTION PIPE SHALL BE CEMENTED FROM BELOW ANY USABLE WATER TO SURFACE WITHIN 120 DAYS OF SPUD DATE. IN ALL CASES, NOTIFY DISTRICT OFFICE PRIOR TO ANY CEMENTING.

I hereby certify that the statements made herein are true and to the best of my knowledge and belief.

Date: 5/14/94 Signature of Operator or Agent: [Signature] Title: Area Pres.

FOR KCC USE:
API # 15- 095-217090000
Conductor pipe required NONE feet
Minimum surface pipe required 200 feet per Alt. (1) X
Approved by: DPW 5-28-94
This authorization expires: 11-28-94
(This authorization void if drilling not started within 6 months of effective date.)
Spud date: _____ Agent: _____

REMEMBER TO:

- File Drill Pit Application (form CDP-1) with Intent to Drill;
- File Completion Form ACO-1 within 120 days of spud date;
- File acreage attribution plat according to field proration orders;
- Notify appropriate district office 48 hours prior to workover or re-entry;
- Submit plugging report (CP-4) after plugging is completed;
- Obtain written approval before disposing or injecting salt water.

Mail to: Conservation Division, 200 Colorado Derby Building, 202 W. First St., Wichita, Kansas 67202-1286.

CORRECTED 10-7-97 *

RECEIVED
KANSAS CORPORATION COMMISSION

MAY 15 1996
5-15-96

CONSERVATION DIVISION
WICHITA, KANSAS

31
30
2w

IN ALL CASES PLOT THE INTENDED WELL ON THE PLAT BELOW.

PLAT OF ACREAGE ATTRIBUTABLE TO A WELL IN A PRORATED OR SPACED FIELD.

If the intended well is in a prorated or spaced field, please fully complete this side of the form. If the intended well is in a prorated or spaced field complete the plat below showing that the well will be properly located in relationship to other wells producing from the common source of supply. Please show all the wells within 1 mile of the boundaries of the proposed acreage attribution unit for gas wells and within 1/2 mile of the boundaries of the proposed acreage attribution unit for oil wells.

API NO. 15- _____
 OPERATOR Trans Pacific Oil Corporation
 LEASE Shelley
 WELL NUMBER #1-31
 FIELD Hostetler

LOCATION OF WELL: COUNTY Kingman
 3300 feet from south/north line of section
 660 feet from east/west line of section
 SECTION 31 TWP 30S RG 7W

NUMBER OF ACRES ATTRIBUTABLE TO WELL 40
 QTR/QTR/QTR OF ACREAGE _____ - SE - NE

IS SECTION X REGULAR or _____ IRREGULAR
IF SECTION IS IRREGULAR, LOCATE WELL FROM NEAREST CORNER BOUNDARY.

Section corner used: _____ NE _____ NW _____ SE _____ SW
 PLAT

(Show location of the well and shade attributable acreage for prorated or spaced wells.)
 (Show footage to the nearest lease or unit boundary line.)

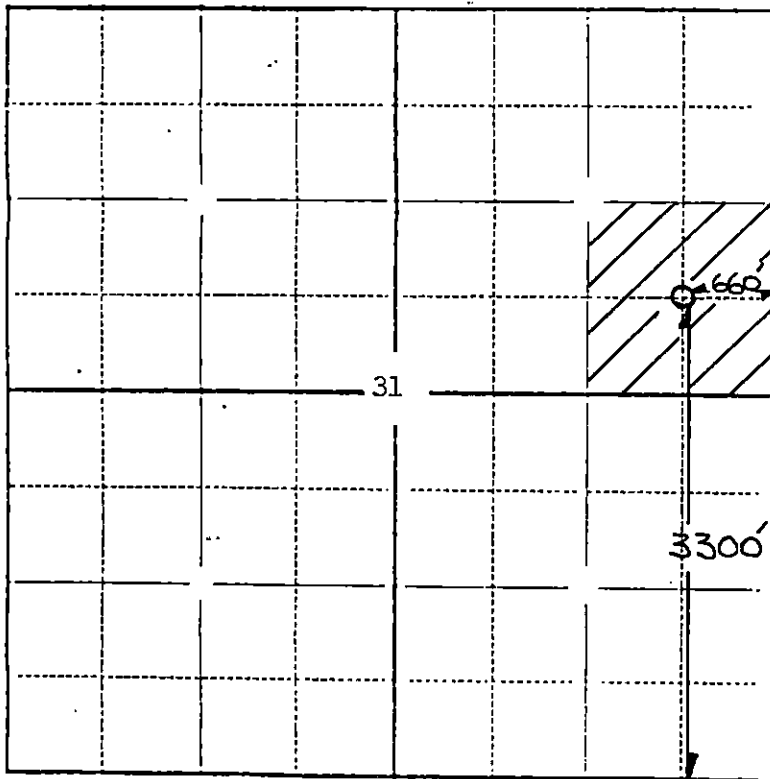

Kingman Co.

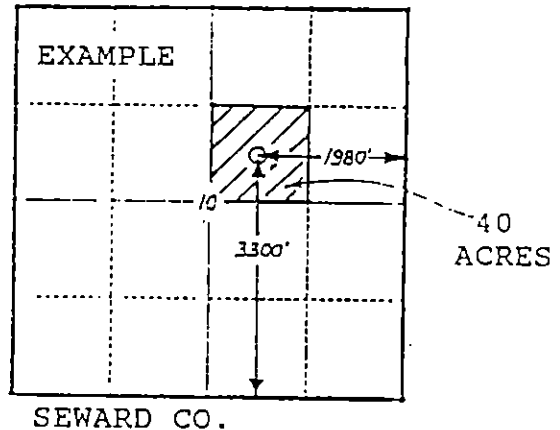

In plotting the proposed location of the well, you must show:

- 1) The manner in which you are using the depicted plat by identifying section lines, i.e. 1 section, 1 section with 8 surrounding sections, 4 sections, etc.;
- 2) the distance of the proposed drilling location from the section's south/north and east/west lines; and
- 3) the distance to the nearest lease or unit boundary line.

EFFECTIVE DATE: 6-3-96

State of Kansas

DISTRICT # 2

NOTICE OF INTENTION TO DRILL

SGA? Yes No

Must be approved by the K.C.C. five (5) days prior to commencing well

Expected Spud Date: May 31 1996
month day year

Spot Approx. SE NE Sec 31 Twp 30 S, Rg 7 East West

OPERATOR: License # 9408
Name: Trans Pacific Oil Corporation
Address: 100 N. Main, Ste. 1000
City/State/Zip: Wichita, KS 67202
Contact Person: Alan Banta
Phone: (316) 262-3596

* 3225' feet from South/North line of Section
* 560' feet from East/West line of Section
IS SECTION X REGULAR IRREGULAR

CONTRACTOR: License #: 5123
Name: Pickrell Drilling Co., Inc.

(NOTE: Locate well on the Section Plat on Reverse Side)
County: Kingman
Lease Name: Shelley Well #: 1-31
Field Name: Hostetler

Well Drilled For: Well Class: Type Equipment:
X Oil ... Enh Rec ... Infield X Mud Rotary
X Gas ... Storage X Pool Ext. ... Air Rotary
... OWWO ... Disposal ... Wildcat ... Cable
... Seismic; ... # of Holes ... Other

** Is this a Prorated/Spaced Field? X yes ... no
Target Formation(s): Simpson
Nearest lease or unit boundary: 660'
Ground Surface Elevation: 1629 feet MSL
Water well within one-quarter mile: ... yes X no
Public water supply well within one mile: ... yes X no
Depth to bottom of fresh water: 105'
Depth to bottom of usable water: 180'
Surface Pipe by Alternate: X 1 ... 2
Length of Surface Pipe Planned to be set: 268'
Length of Conductor pipe required: None
Projected Total Depth: 4768'
Formation at Total Depth: Simpson
Water Source for Drilling Operations: ... well X farm pond other

If OWWO: old well information as follows:
Operator: ...
Well Name: ...
Comp. Date: ... Old Total Depth

DWR Permit #: ...
Will Cores Be Taken?: ... yes X no
If yes, proposed zone: ...

Directional, Deviated or Horizontal wellbore? ... yes X no
If yes, true vertical depth: ...
Bottom Hole Location: ...

AFFIDAVIT

* WAS: 3300' FSL 660' FEL

The undersigned hereby affirms that the drilling, completion and eventual plugging of this well will comply with K.S.A. 55-101, et. seq.

It is agreed that the following minimum requirements will be met: ** PRORATED ON MISS: SPIVEY GRABS ORDER

- 1. Notify the appropriate district office prior to spudding of well;
- 2. A copy of the approved notice of intent to drill shall be posted on each drilling rig;
- 3. The minimum amount of surface pipe as specified below shall be set by circulating cement to the top; in all cases surface pipe shall be set through all unconsolidated materials plus a minimum of 20 feet into the underlying formation;
- 4. If the well is dry hole, an agreement between the operator and the district office on plug length and placement is necessary prior to plugging;
- 5. The appropriate district office will be notified before well is either plugged or production casing is cemented in;
- 6. IF AN ALTERNATE II COMPLETION, PRODUCTION PIPE SHALL BE CEMENTED FROM BELOW ANY USABLE WATER TO SURFACE WITHIN 120 DAYS OF SPUD DATE. IN ALL CASES, NOTIFY DISTRICT OFFICE PRIOR TO ANY CEMENTING.

I hereby certify that the statements made herein are true and to the best of my knowledge and belief.

Date: 10/6/97 Signature of Operator or Agent: [Signature] Title: VICE PRESIDENT

FOR KCC USE:
API # 15- 095-217090000
Conductor pipe required NONE feet
Minimum surface pipe required 200 feet per Alt. ① X
Approved by: CAR 10-7-97 JK/ORIG 5-28-96 DPW
This authorization expires: 11-28-96
(This authorization void if drilling not started within 6 months of effective date.)
Spud date: Agent:

REMEMBER TO:

- File Drill Pit Application (form CDP-1) with Intent to Drill;
- File Completion Form ACD-1 within 120 days of spud date;
- File acreage attribution plat according to field proration orders;
- Notify appropriate district office 48 hours prior to workover or re-entry;
- Submit plugging report (CP-4) after plugging is completed;
- Obtain written approval before disposing or injecting salt water.

Mail to: Conservation Division, 204 Colorado Derby Building, 202 W. First St., Wichita, Kansas 67202-1286.

31
30
725
MAY 15 1998
1997 OCT -7 A 11:59

IN ALL CASES PLOT THE INTENDED WELL ON THE PLAT BELOW

PLAT OF ACREAGE ATTRIBUTABLE TO A WELL IN A PRORATED OR SPACED FIELD

If the intended well is in a prorated or spaced field, please fully complete this side of the form. If the intended well is in a prorated or spaced field complete the plat below showing that the well will be properly located in relationship to other wells producing from the common source of supply. Please show all the wells within 1 mile of the boundaries of the proposed acreage attribution unit for gas wells and within 1/2 mile of the boundaries of the proposed acreage attribution unit for oil wells.

API NO. 15- _____
 OPERATOR Trans Pacific Oil Corporation
 LEASE Shelley
 WELL NUMBER #1-31
 FIELD Hostetler

LOCATION OF WELL: COUNTY Kingman
 3225' feet from South north line of section
 560' feet from East west line of section
 SECTION 31 TWP 30S RG 7W

NUMBER OF ACRES ATTRIBUTABLE TO WELL 40
 QTR/QTR/QTR OF ACREAGE _____ - SE - NE

IS SECTION X REGULAR or _____ IRREGULAR
IF SECTION IS IRREGULAR, LOCATE WELL FROM NEAREST CORNER BOUNDARY.

Section corner used: _____ NE _____ NW X SE _____ SW

PLAT

(Show location of the well and shade attributable acreage for prorated or spaced wells.)
 (Show footage to the nearest lease or unit boundary line.)

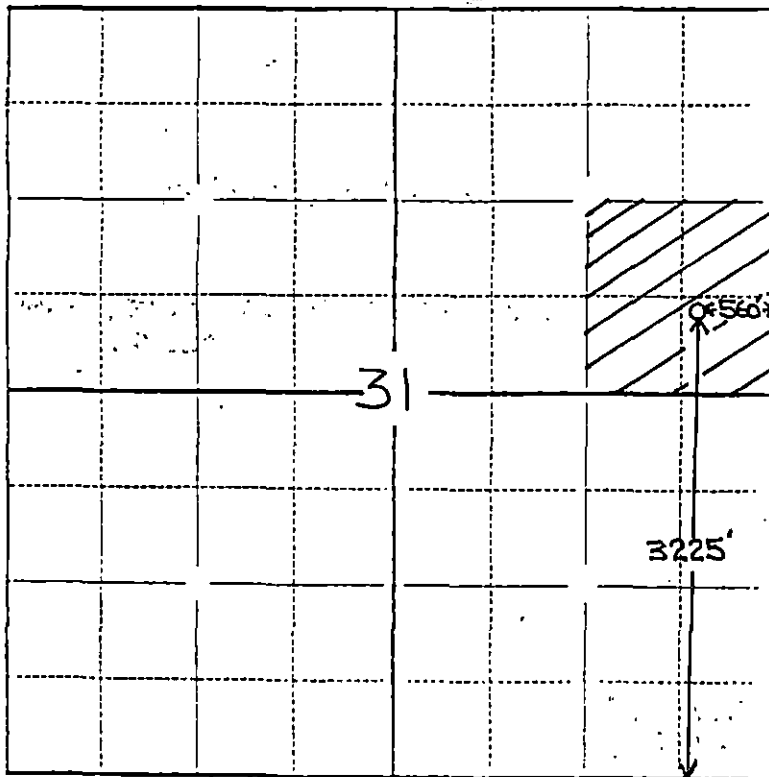

Kingman Co.

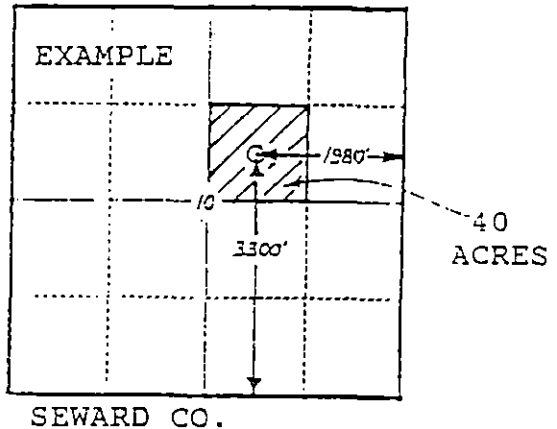

In plotting the proposed location of the well, you must show:

- 1) The manner in which you are using the depicted plat by identifying section lines, i.e. 1 section, 1 section with 8 surrounding sections, 4 sections, etc.;
- 2) the distance of the proposed drilling location from the section's south/north and east/west lines; and
- 3) the distance to the nearest lease or unit boundary line.