

NO. 10-2-91
EFFECTIVE DATE

"OWWO"

Must be approved by the K.C.C. five (5) days prior to commencing well

Expected Spud Date October 15 1991
month day year
SW NE
4 16 11 Sec 4 Twp 16 S, Rg 11 West

OPERATOR: License # 03154
Name: Larry Dolechek
Address: R.R. 1# Box 87
City/State/Zip: Wilson, Kansas 67490
Contact Person: Larry Dolechek
Phone: (913) 658 - 3528

2970 feet from South line of Section
2310 feet from East line of Section
(Note: Locate well on Section Plat on Reverse Side)

CONTRACTOR: License #: 03154
Name: Larry Dolechek
using my own equipment

County: Barton
Lease Name: Davidson Well #: 1
Field Name: Davidson

Well Drilled For: Well Class: Type Equipment:
 Oil ... Inj ... Infield Mud Rotary
... Gas ... Storage ... Pool Ext. ... Air Rotary
... OWWD ... Disposal ... Wildcat ... Cable
... Seismic; ... # of Holes Pulling Unit

Is this a Prorated Field? ... yes no
Target Formation(s): Arbuckle
Nearest lease or unit boundary: 330'
Ground Surface Elevation: 1845 feet MSL
Domestic well within 330 feet: ... yes no
Municipal well within one mile: ... yes no
Depth to bottom of fresh water: 320
Depth to bottom of usable water: 345
Surface Pipe by Alternate: 1 ... 2
Length of Surface Pipe Planned to be set: 365
Length of Conductor pipe required: ---
Projected Total Depth: 3341
Formation at Total Depth: Arbuckle
Water Source for Drilling Operations:
... well farm pond ... other

If OWWD: old well information as follows:
Operator: Syndicate O & G
Well Name: Poirano
Comp. Date: 12-17-30 Old Total Depth 3341

DWR Permit #: ---
Will Cores Be Taken?: ... yes no
If yes, proposed zone: ---

Directional, Deviated or Horizontal wellbore? ... yes no
If yes, total depth location: ---

AFFIDAVIT * 365' of surface pipe req. *

The undersigned hereby affirms that the drilling, completion and eventual plugging of this well will comply with K.S.A. 55-101, et. seq.

- It is agreed that the following minimum requirements will be met:
1. The appropriate district office shall be notified before setting surface pipe;
 2. The minimum amount of surface pipe as specified above shall be set by circulating cement to the top; in all cases surface pipe shall be set through all unconsolidated materials plus a minimum of 20 feet into the underlying formation;
 3. If the well is dry, a plugging proposal shall be submitted to the district office. An agreement between the operator and the district office on plug length and placement is necessary prior to plugging;
 4. The appropriate district office will be notified before well is either plugged or production casing is cemented in;
 5. If an Alternate II completion, production pipe shall be cemented from below any usable water to surface within 120 days of spud date. In all cases, notify district office prior to any cementing.

I hereby certify that the statements made herein are true and to the best of my knowledge and belief.
Date: Sept. 23 1991 Signature of Operator or Agent: Larry Dolechek Operator

FOR KCC USE:
API # 15-009-01,050-00-01
Conductor pipe required None feet
Minimum surface pipe required 365 feet per Alt. ①
Approved by: MDW 9-27-91
EFFECTIVE DATE: 10-2-91
This authorization expires: 3-27-92
(This authorization void if drilling not started within 6 months of effective date.)
Spud date: _____ Agent: _____

RECEIVED
STATE CORPORATION COMMISSION
SEP 24 1991
9-24-91
CONSERVATION DIVISION
Wichita, Kansas

RECEIVED
STATE CORPORATION COMMISSION
SEP 27 1991

- REMEMBER TO:
- File Drill Pit Application (form CDP-1) with Intent to Drill;
 - File Completion Form ACO-1 within 120 days of spud date;
 - File acreage attribution plat according to field proration orders;
 - Notify appropriate district office 48 hours prior to workover or re-entry;
 - Submit plugging report (CP-4) after plugging is completed;
 - Obtain written approval before disposing or injecting salt water.

H
16
1100

PLAT OF ACREAGE ATTRIBUTABLE TO A WELL

State Corporation Commission, Conservation Division
200 Colorado Derby Bldg. Wichita, Kansas 67202

OPERATOR Larry Dolechek LOCATION OF WELL:
 LEASE Davidson 2970 feet north of SE corner
 WELL NUMBER 2310 feet west of SE corner
 FIELD Davidson of Sec. 4 T 16 R 11 E/W
 COUNTY _____
 NO. OF ACRES ATTRIBUTABLE TO WELL 160 IS SECTION X REGULAR _____ IRREGULAR?
 DESCRIPTION OF ACREAGE Pasture IF IRREGULAR, LOCATE WELL FROM NEAREST CORNER BOUNDARY.

NOTE: If plat depicted is insufficient for your circumstances, you may attach your own scaled or surveyed plat.

PLAT

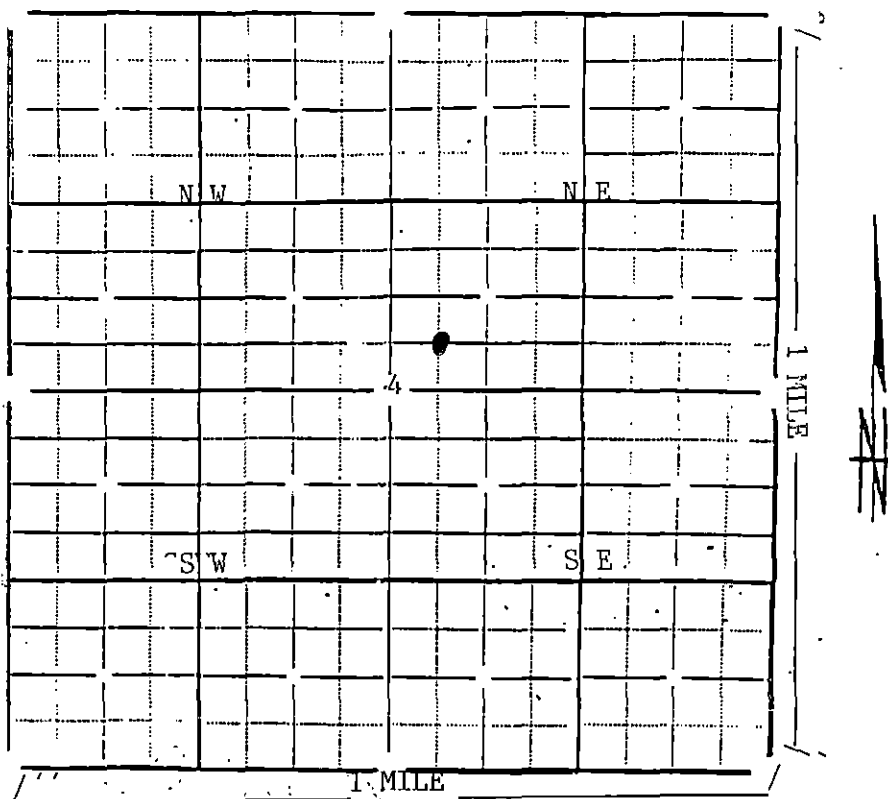

In plotting the proposed location of the well, you must show:

- 1) The manner in which you are using the depicted plat by identifying section lines, i.e. 1 section, 1 section with 8 surrounding partial sections, 4 sections, 16 sections, etc.;
- 2) the well's location relative to the location of other wells producing from the same common source of supply in adjoining drilling units, pursuant to K.A.R. 82-3-108, 82-3-207, 82-3-312, or special orders of the Commission;
- 3) the distance of the proposed drilling location from the section's east and south lines; and
- 4) the distance to the nearest lease or unit boundary line.

I hereby certify that the statements made herein are true and to the best of my knowledge and belief.

Signature of Operator or Agent Larry Dolechek
 Date September 23 1991 Title Owner/Operator (913) 658-3528