

STATE OF KANSAS
STATE CORPORATION COMMISSION

Give All Information Completely
Make Required Affidavit
Mail or Deliver Report to:
Conservation Division
State Corporation Commission
211 No. Broadway
Wichita, Kansas

WELL PLUGGING RECORD

15-029-06 286-0500

BARTON

County. Sec. 8 Twp. 16 Rge. 11 (E) W (W)

Location as "NE/CNW/SW" or footage from lines SW SE SE

Lease Owner PETROLEUM, INC.

Lease Name NEY

Well No. 2

Office Address Route 2, Great Bend, Kansas

Character of Well (completed as Oil, Gas or Dry Hole) Dry Hole

Date well completed August 30, 1957

Application for plugging filed September 3, 1957

Application for plugging approved September 4, 1957

Plugging commenced September 23, 1957

Plugging completed September 26, 1957

Reason for abandonment of well or producing formation
No Producing Zone

If a producing well is abandoned, date of last production None 19

Was permission obtained from the Conservation Division or its agents before plugging was commenced? Yes

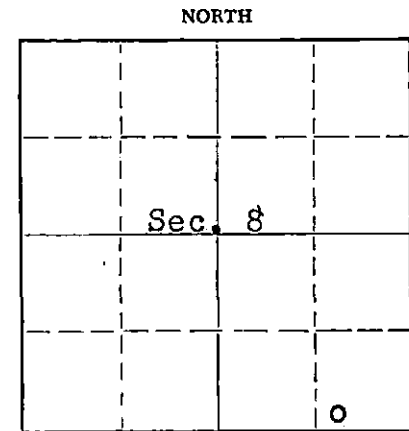

Locate well correctly on above Section Plat

Name of Conservation Agent who supervised plugging of this well R. M. Brundage, Hoisington, Kansas

Producing formation ----- Depth to top ----- Bottom ----- Total Depth of Well 3315 Feet

Show depth and thickness of all water, oil and gas formations.

OIL, GAS OR WATER RECORDS

CASING RECORD

FORMATION	CONTENT	FROM	TO	SIZE	PUT IN	PULLED OUT
Arbuckle	Water and little oil	3301'	3315'	8-5/8" 5-1/2"	248' 3301'	None 2850'

Describe in detail the manner in which the well was plugged, indicating where the mud fluid was placed and the method or methods used in introducing it into the hole. If cement or other plugs were used, state the character of same and depth placed, from _____ feet to _____ feet for each plug set.

Filled hole with crushed rock from 3315' to 3290' and placed 5 sacks cement on top of rock. Globe Oil Well Cementing Co. pumped 9 sacks Davis Gel (mud) on top of cement, followed by 75 sacks cement. Checked well the following morning and found cement 150' down, mudded up to 20' and made solid rock bridge followed by 5 sacks cement to base of well cellar.

(If additional description is necessary, use BACK of this sheet)

Name of Plugging Contractor Morgan Well Plugging Service

Address 102 West 18th Street, Hutchinson, Kansas

STATE OF KANSAS, COUNTY OF BARTON, ss.
Don Searle

(employee of owner) or (owner/contractor) of the above-described well, being first duly sworn on oath, says: That I have knowledge of the facts, statements, and matters herein contained and the log of the above-described well as filed and that the same are true and correct. So help me God.

(Signature)

Route 2, Great Bend, Kansas

(Address)

SUBSCRIBED AND SWORN TO before me this 26th day of September, 1957

[Signature]
Notary Public.

My commission expires July 11, 1960

RECEIVED
STATE CORPORATION COMMISSION

SEP 27 1957
9-27-57
CONSERVATION DIVISION
Wichita, Kansas
PLUGGING
FILE SEC 8 T 16 R 11W
BOOK PAGE 42 LINE 5

WELL LOG

15-009-06286-0000

COMPANY PETROLEUM, INCORPORATED

SEC. 8 T. 16S R. 11W

FARM NEY

NO. 2

LOC. SW, SE, SE

TOTAL DEPTH 3307'

COUNTY Barton Co., Kansas

COMM. August 13, 1957

COMP. August 21, 1957

CONTRACTOR GARVEY DRILLING COMPANY

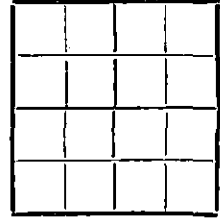

CASING 8 5/8" @ 248' W/150 sax.
5 1/2" @ 3301' W/75 wax.

ELEVATION 1838' KB

PRODUCTION Arbuckle

FIGURES INDICATE BOTTOM OF FORMATIONS

195	Clay, rock & sand
250	Shale & shells
710	Shale, shells & red bed
752	Anhydrite
1450	Shale & shells
1880	Lime & shab
2000	Lime
2160	Lime & shab
2425	Shale & shells
3040	Lime & shale
3307=	Lime
3307	T. D.

State of KANSAS }
County of BARTON } ss:

PLUGGING
FILE SEC. 8 T. 16 R. 11W
BOOK PAGE 42 LINE 5

SEP 27 1957
DIVISION
SAS

I, Verne A. Morris of Garvey Drilling Co.

upon oath state that the above and foregoing is a true and correct copy of the log of the #2 Ney well

Verne A. Morris

Subscribed and sworn to before me this 24th day of September 19 57

My Commission Expires: July 11, 1960

Jed L. Brown
NOTARY PUBLIC