

15-009-06475-0000

Strike out upper line when reporting plugging of formations.

Give All Information Completely
Make Required Affidavit
Mail or Deliver Report to:
Conservation Division
State Corporation Commission
800 Bitting Building
Wichita, Kansas

Barton County. Sec. 8 Twp. 16 Rge. (E) 11 (W)
Location as "NE $\frac{1}{4}$ NW $\frac{1}{4}$ SW $\frac{1}{4}$ " or footage from lines. NE SE NW
Lease Owner. National Cooperative Refinery Association Prod. Dept.
Lease Name. Muller Well No. 2
Office Address. Wichita, Kansas
Character of Well (completed as Oil, Gas or Dry Hole) Dry Hole
Date well completed April 7, 19 48
Application for plugging filed April 8, 19 48
Application for plugging approved April 14, 19 48
Plugging commenced April 8, 19 48
Plugging completed April 11, 19 48
Reason for abandonment of well or producing formation Dry Hole

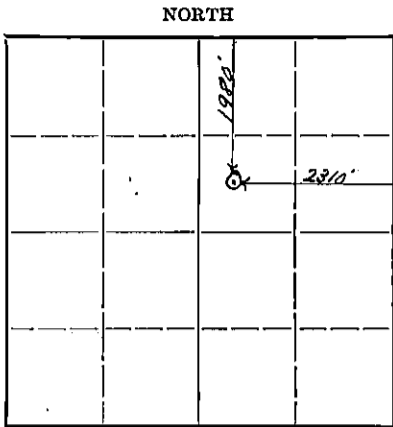

Locate well correctly on above Section Plat

If a producing well is abandoned, date of last production..... 19.....
Was permission obtained from the Conservation Division or its agents before plugging was commenced? Yes

Name of Conservation Agent who supervised plugging of this well C. D. Stough
Producing formation..... Depth to top..... Bottom..... Total Depth of Well 3315 Feet
Show depth and thickness of all water, oil and gas formations.

OIL, GAS OR WATER RECORDS

CASING RECORD

Formation	Content	From	To	Size	Put In	Pulled Out
				12 $\frac{1}{2}$ " csg.	421'	421'
				10 3/4"	708'	708'
				8 5/8"	2435'	2435'
				7"	3131'	3131'

Describe in detail the manner in which the well was plugged, indicating where the mud fluid was placed and the method or methods used in introducing it into the hold. If cement or other plugs were used, state the character of same and depth placed, from.....feet to.....feet for each plug set.

Mudded hole to 810', bridged, ran 25 sacks cement. Mudded to 250', bridged, ran 25 sacks cement. Mudded hole to 15' and sealed hole to base of cellar with 15 sacks of cement.

(If additional description is necessary, use BACK of this sheet)

Correspondence regarding this well should be addressed to National Cooperative Refinery Association Prod. Dept.
Address 820 Union National Bank Building
Wichita, Kansas

STATE OF Kansas, COUNTY OF Barton, SS.
Harry T. Black (employee of owner) or (~~owner~~) of the above-described well,

being first duly sworn on oath, says: That I have knowledge of the facts, statements, and matters herein contained and the log of the above-described well as filed and that the same are true and correct. So help me God.

(Signature) Harry T. Black
Claflin, Kansas (Address)

SUBSCRIBED AND SWORN to before me this 16 day of April, 19 48.

My commission expires February 5, 1951

Edmund Wojciak
Notary Public.

PLUGGING
FILE SEC 8 T 16 R 11W
BOOK PAGE 72 LINE 79

WELL LOG BUREAU KANSAS GEOLOGICAL SOCIETY
 412 Union National Bk. Bldg., Wichita, Kansas

15009-06475-0000

Company - N. C. R. A.
 Farm - Muller No. 2

SEC. 8 T. 16 R. 11W
 NE SE NW

Total Depth. 3315'
 Comm. 2-1-18 Comp. 4-7-48
 Shot or treated.
 Contractor.
 issued. 5-1-48

County. Barton
 KANSAS

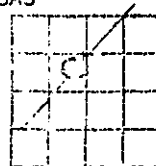

CASING:
 12 1/2" 421' 7" 2959 Reamed to 3131'
 10-3/4" 708'
 8-5/8" 2030' Reamed to 2435'

Elevation. _____

Production. Dry

Figures Indicate Bottom of Formations.

sand	325 - 340
sand	385 - 405
lime	700 - 730
salt	1120 - 1355
Hopeka lime	2605 - 2725
red rock	2925 - 2930
K. C. lime	2987
Conglomerate	3285
Arbuckle	3313 - 3315
Total Depth	

WATER RECORD:

4 BW at	240
HPW at	340
2-1/2 BW at	430
1-1/2 BW at	1690
1-1/2 BW at	1740
1 B: at	2585
5 BW at	2945
HPW at	3110
HPW at	3315

PLUGGING
 FILE SEC 8 T 16 R 11W
 PAGE 22 LINE 28